

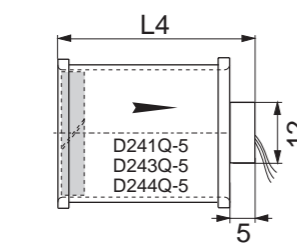

Axiallüfter
Axial Fans
Ventilateur Axial

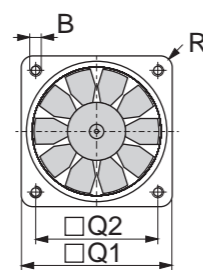
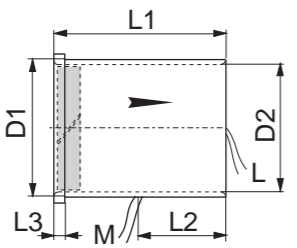
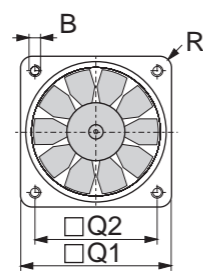
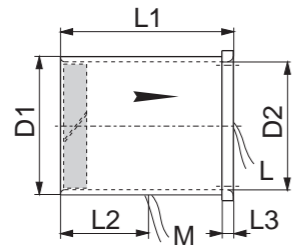
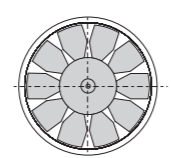
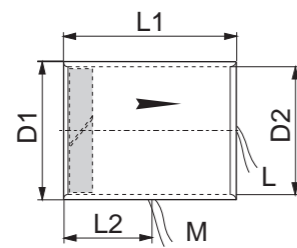
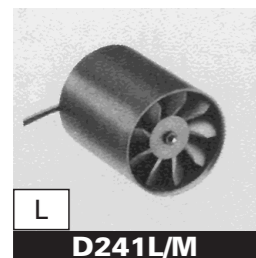

D240	mm	inch
D1	24	0.945
D2	22	0.866
L1	30	1.181
L2	15	0.590
L3	3	0.118
L4	35	1.380
B	2.6	0.102
Q1	28	1.102
Q2	22	0.866
R	2	0.079

D241, D243, D244 6 V DC

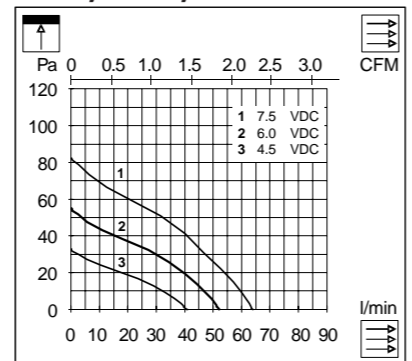

D241, D243, D244 12 V DC

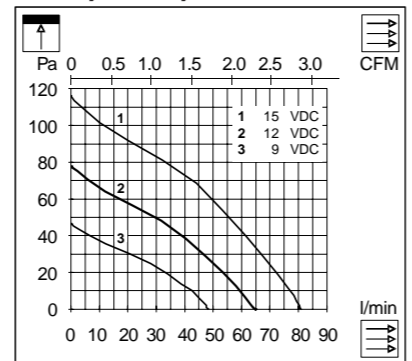

D241Q, D243Q, D244Q 6 V DC

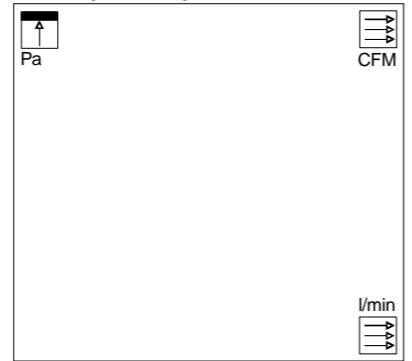

D241Q, D243Q, D244Q 12 V DC

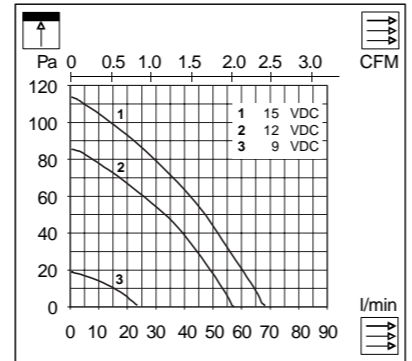

D240

Z 5948 - 201 A4 D240 0389 / 2000 1100 / 1000

Die D240Q-Baureihe ist mit elektronischem Motor, inklusive MICRONEL ASIC ausgerüstet (3 Litzen)
 – sehr lange Laufzeit
 – Spannungsbereich 5 – 16 V DC
 – Tachosignal
 – PWM (V DC unabhängige Rpm)
 – Strombegrenzung
 Option: 10 Litzen Ausgang mit weiteren Funktionen

The serie D240Q ist equipped with an electronic motor, including MICRONEL ASIC (3 leads)
 – Long life
 – voltage range 5 – 16 V DC
 – tach signal (speed indicator)
 – PWM (Rpm independent of V DC)
 – current limitation
 Option: 10 leads-version with further functions

La série D240Q est équipée d'un moteur électronique, ASIC MICRONEL inclus (3 fils)
 – Usage longue vie
 – gamme de tension 5 – 16 V DC
 – signal tach
 – PWM (Rpm indépendant du V DC)
 – limite de courant
 Option: version 10 fils avec fonctions supplémentaires

Types -1 -3 -4	D241/D243/D244	D241Q-5/D243Q-5/D244Q-5
U U _N V	6 12	12
U U V	4.5...7.5 9...15	5-16
I I _N mA	32 22	53
I I _{max} mA	40 28	64
I I _{block} A	0.22 0.14	0.88
P P _N W	0.19 0.26	0.64
rpm n min ⁻¹	12 100 14 400	14 500
V V̇ l/min; CFM	50/1.77 60/2.12	57/2.01
p p Pa	52 75	85
LpA LpA dB(A)	33 38	38
MTTF MTTF hr	4000 ++plus	30 000
T T °C/F	-20...+65 / -5...+150	-20...+65 / -5...+150
m m g/oz.	15/0.53	23/0.81
L/M L/M mm/inch	200/7.874	160/6.30
PPO PPO UL-94V-1	o.k.	o.k.
Aluminium Aluminium	-	-
o.k. o.k.	o.k.	o.k.
o.k. o.k.	-	o.k.
o.k. o.k.	-	-
o.k. o.k.	-	o.k.
o.k. o.k.	-	-
o.k. o.k.	-	-
o.k. o.k.	-	-

