

R13-273  H-0 2

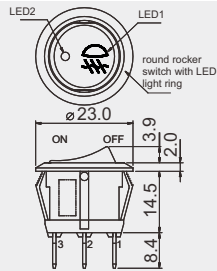

0 2  .187" SQ

20A 14V DC
10A 28V DC

FEATURES

- * MATERIAL: Frame & actuator is PC.
- * LED light ring always illuminated.
- * The graphic is laser marking.

Cut-out

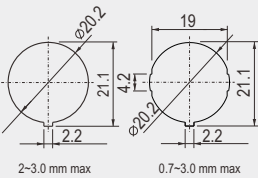

 0.7~3.0 mm max

FUNCTION

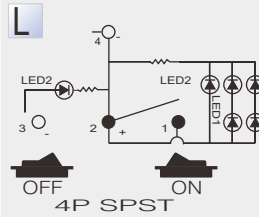
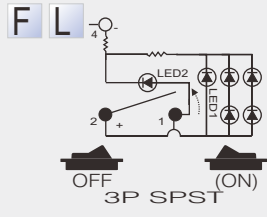
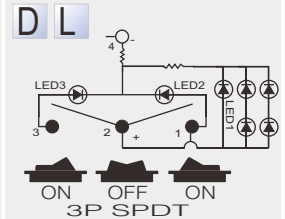
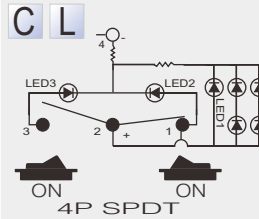
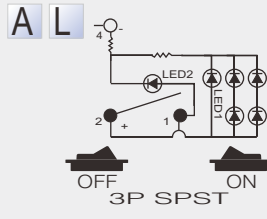

SWITCH FOR MASSAGE CHAIR

R13-928

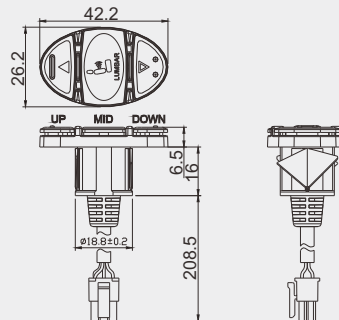

Rating

50mA 12V DC

Insulation resistance

DC 100V 100MΩ Min

Dielectric strength

AC 250V 1 minute

Cut out

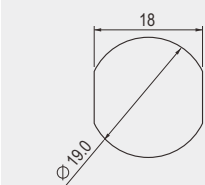

 0.7~5.0mm max

FEATURES

- * MATERIAL: Frame is PC. Actuator are PC.
- * 3 positions (up/mid/down) adjusted by actuators.
- * Graphic and customer logo in laser marking.
- * Visible symbols with backlight blue LED.
- * Switch function: 3 Sws (push on)+ 3 Blue LEDs (independent) always light on.

CIRCUIT DIAGRAM

