

Inductive sensors

IFT203

IFB3004BBPKG/M/V4A/US
 Inductive sensor
 Metal thread M12 x 1
 Connector
 Increased sensing range
 gold-plated contacts

Sensing range 4 mm [f]
 flush mountable

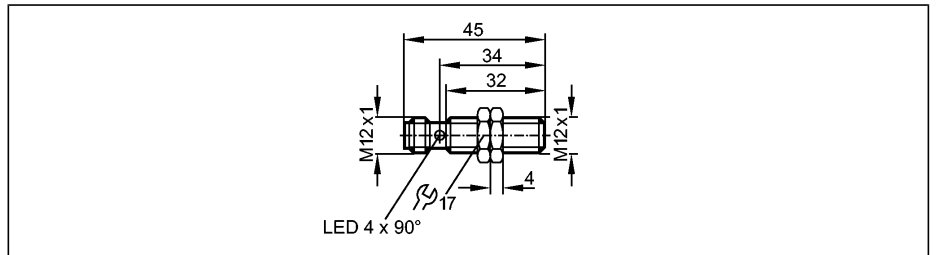

Made in Germany



Electrical design	
Output	
Operating voltage	[V]
Current rating	[mA]
Short-circuit protection	
Reverse polarity protection	
Overload protection	
Voltage drop	[V]
Leakage current	[mA]
Current consumption	[mA]
Operating distance	[mm]
Hysteresis	[% of Sr]
Switching frequency	[Hz]
Correction factors	
Ambient temperature	[°C]
Protection	
EMC	
MTTF	[Years]
Housing materials	
Function display	
Switching status	LED
Connection	
Weight	[kg]
Remarks	
Accessories (included)	

DC PNP	
normally open	
Operating voltage	10...36 DC
Current rating	100
Short-circuit protection	pulsed
Reverse polarity protection	yes
Overload protection	yes
Voltage drop	< 2.5
Leakage current	< 0.5
Current consumption	< 10 (24 V)
Operating distance	0...3.25
Hysteresis	1...20
Switching frequency	800
Correction factors	mild steel = 1 / stainless steel approx. 0.7 / brass approx. 0.5 / Al approx. 0.4 / Cu approx. 0.3
Ambient temperature	0...100
Protection	IP 68 / IP 69K ^{*)} , II
EMC	EN 61000-4-2 ESD: 4 kV CD / 8 kV AD EN 61000-4-3 HF radiated: 10 V/m (80...1000 MHz) EN 61000-4-4 Burst: 2 kV EN 61000-4-6 HF conducted: 10 V (0.15...80 MHz) EN 55011: class B
MTTF	1676
Housing materials	threaded sleeve: V4A (316S12); active face: PEEK (polyether ether ketone); lock nuts: high-grade stainless steel
Function display	
Switching status	yellow (4 x 90°)
Connection	M12 connector; gold-plated contacts
Weight	0.025
Remarks	^{*)} "COP"
Accessories (included)	2 lock nuts

Wiring

