

Inductive sensors special versions

IFRW 12P1501/S14L

dimension drawing

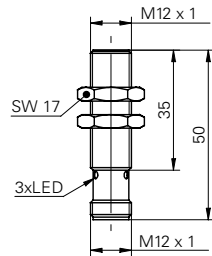

general data

| | |
|--------------------------------|----------------------------|
| mounting type | shielded |
| special type | welding and magnetic noise |
| nominal sensing distance S_n | 2 mm |
| hysteresis | 3 ... 20 % of S_r |
| output indicator | 3 port LED red |

electrical data

| | |
|-----------------------------|------------------------|
| switching frequency | < 1 kHz |
| voltage supply range +Vs | 10 ... 30 VDC |
| current consumption max. | 10 mA |
| output circuit | PNP make function (NO) |
| voltage drop V_d | < 1 VDC |
| output current | < 250 mA |
| short circuit protection | yes |
| reverse polarity protection | yes |

mechanical data

| | |
|-------------------------|-----------------------|
| type | cylindrical threaded |
| material (sensing face) | teflon coated |
| housing material | brass chromium plated |
| dimension | 12 mm |
| housing length | 50 mm |
| connection types | connector M12 |

ambient conditions

| | |
|-----------------------|----------------|
| operating temperature | -25 ... +75 °C |
| protection class | IP 67 |

photo



connection diagram



- immune to welding and magnetic noise of up to 90 mT