

Jan.1.2017 Copyright 2017 HIROSE ELECTRIC CO., LTD. All Rights Reserved.

COUNT	DESCRIPTION OF REVISIONS	BY	CHKD	DATE	COUNT	DESCRIPTION OF REVISIONS	BY	CHKD	DATE
△				..	△				..
△				..	△				..
△				..	△				..

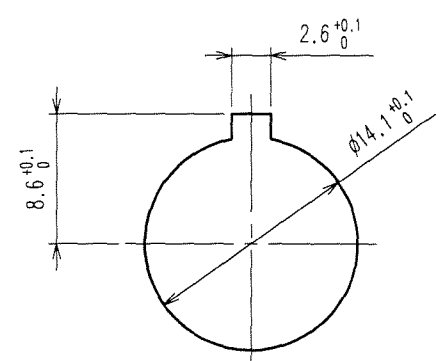
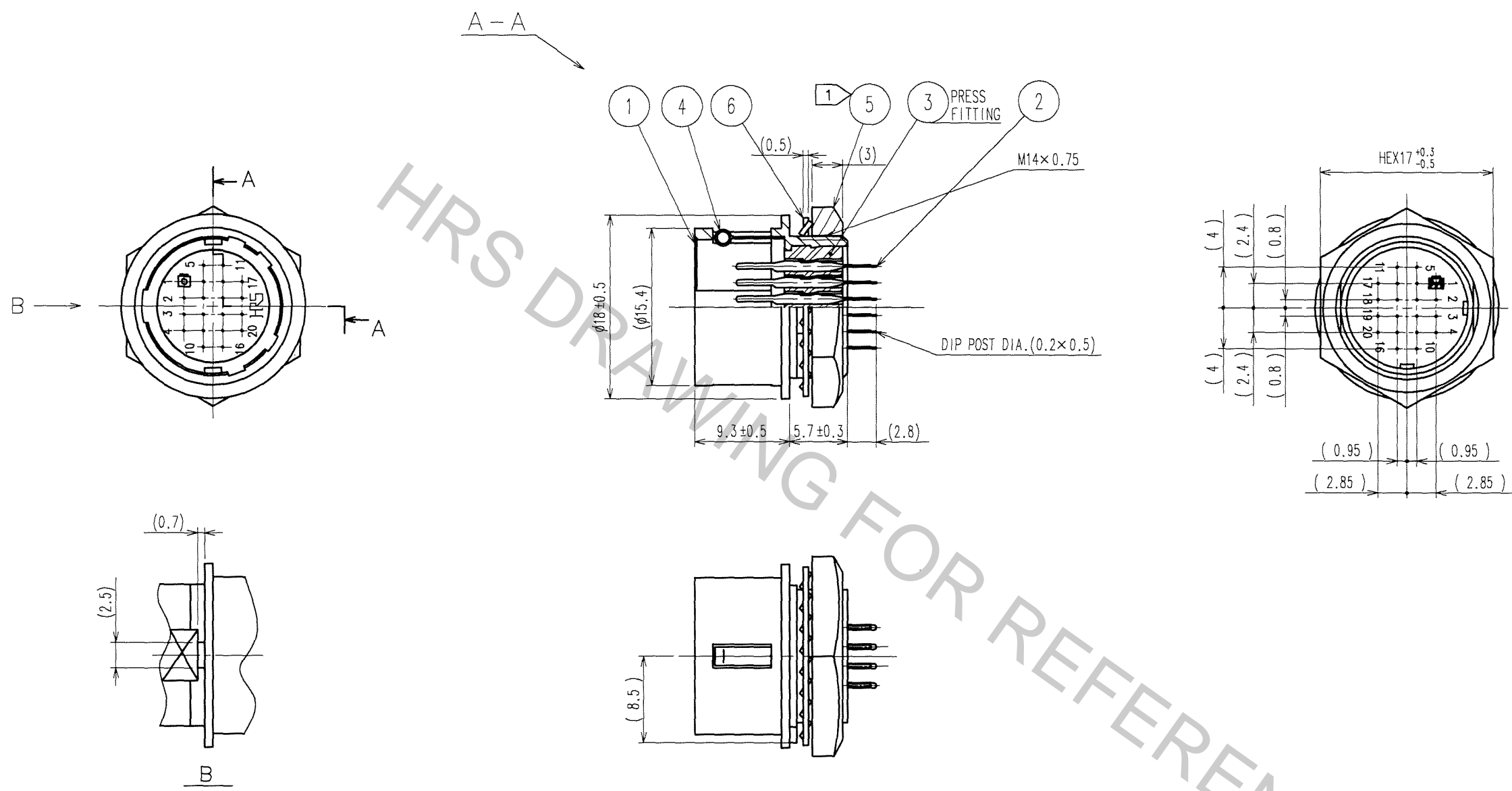

PANEL CUTOUT
(t = 0.8 TO 1.5)

NOTE ① THE RECOMMENDED CLAMP TORQUE, REF. NO. ⑤ : 2 TO 2.5N · m.
LOCTITE 242, HENKEL JAPAN OR EQUIVALENT IS RECOMMENDED TO PREVENT REF. NO. ⑤ FOR LOOSENING.

3	POLYBUTYLENE TEREPHTHALATE (BLACK)	UL94V-0	6	PHOSPHOR BRONZE	NICKEL PLATING
2	PHOSPHOR BRONZE	SILVER PLATING 2μ m min.	5	BRASS	NICKEL PLATING
1	ZINC ALLOY	MATTE FINISH NICKLE PLATED	4	STAINLESS STEEL	
NO.	MATERIAL	FINISH, REMARKS	NO.	MATERIAL	FINISH, REMARKS

CODE NO. (OLD)	CL	DRAWN	DESIGNED	CHECKED	APPROVED	RELEASED
		M. Sato	T. Nozui	M. Sato	M. Sato	
		07.03.15	07.03.20	07.03.20	07.03.20	

SCALE	2 : 1	DRAWING NO.	EDC3-023956-73	PART NO.	HR10A-13R-20PB(73)
UNITS	mm	CODE NO.	CL110-0708-0-73		1/1
		HRS HIROSE ELECTRIC CO., LTD			

TO
R