

GE 40 ES

Lubricant	Regular relubrication – grease
Design (sliding contact surface combination)	Steel/steel
Sealing solution	-

Dimensions

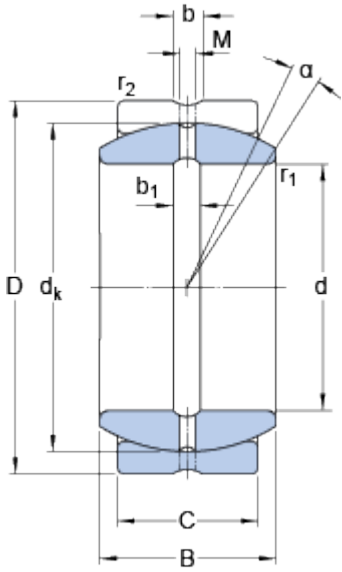

d	40	mm
D	62	mm
B	28	mm
C	22	mm
α	7	°
d_k	53	mm
b	3.9	mm
b_1	3.9	mm
M	2.5	mm
r_1	min. 0.6	mm
r_2	min. 1	mm

Abutment dimensions

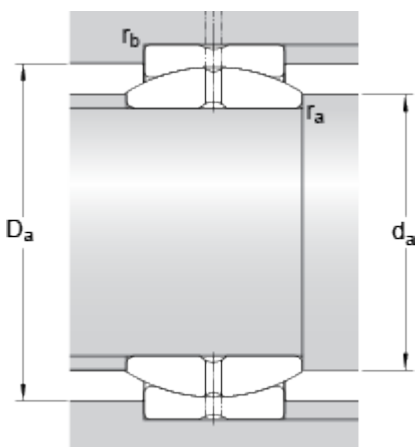

d_a	min. 43.6	mm
d_a	max. 45	mm
D_a	min. 50.3	mm
D_a	max. 57.8	mm
r_a	max. 0.6	mm

r_b max. **1**

mm

Calculation data

Basic dynamic load rating	C	100	kN
Basic static load rating	C ₀	500	kN
Specific dynamic load factor	K	100	N/mm ²
Specific static load factor	K ₀	500	N/mm ²
Material constant	K _M	330	

Mass

Mass plain bearing		0.32	kg
--------------------	--	-------------	----
