

Safety isolating transformer, IPoo

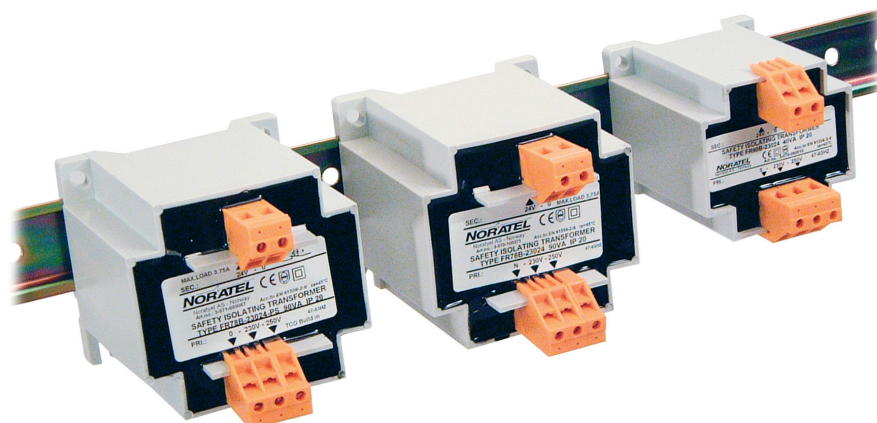

Type FR & FR-PS

Single-phase safety isolating transformer designed and tested according to EN61558-2-6. The construction is produced with modern technology and satisfies ever-increasing requirements of service life and reliability. The FR transformers have separate insulated windings, are moulded in self-extinguishing polyurethane and capsulated in plastic.

For fixed installation, simple and easy assembly in cabinets or switchboards. Produced according to DnV, Lloyds register of shipping and Bureau Veritas regulations which include 45°C ambient temperature. Insulation class II, double isolated.

Applications:

Industrial safety isolating transformer designed for installation in processing industry and switch-boards. Suitable for SELV installations which require safety isolating transformer approved according to the CE directives.

All FR60B, FR78B and FR84B models are supplied with integrated optional DIN-rail mounting system (35mm DIN-rail).

Custom designed models on request.

Type	Dimensions (mm)						Wt (Kg)
	A	B	C	E	F	G	
FR60B	68	63	95	50	56	4,4x5	0,9
FR78B	85	79	103	63	70	5x8	1,7
FR84B	90	84	110	68	76	5x7	2,3
FR96B	105	89	115	70	89	6x8	3,2
FR96C	130	115	119	87	105	8x10	4,4
FR120B	130	115	137	87	105	8x10	5,9

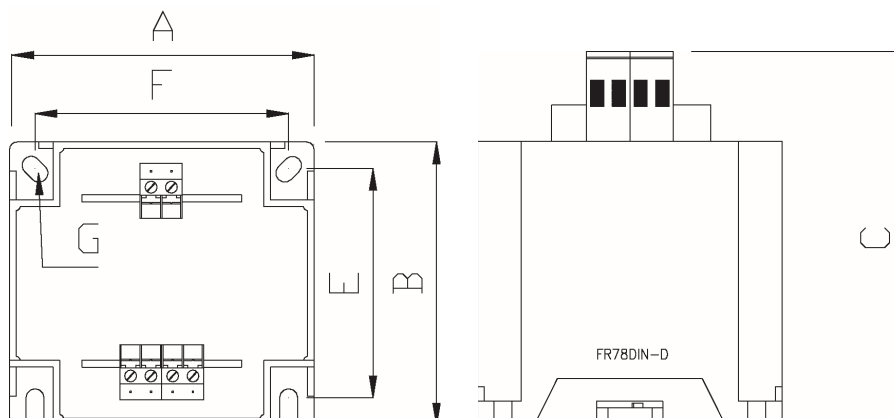

Technical specifications

- Input voltage: 230-250 V
380-400-415-440 V
- Frequency: 47-63 Hz
- Output voltage: 12 V, 24 V, 2x24 V
- According to: EN61558-2-6
- Test/insulating voltage: 4/5,2kV AC RMS
- Construction class: II
- Insulation class: B (130°C)
- Ambient temp. (t_a): 45°C
- Degree of protection: IP20

The FR transformers must be protected against short circuit and overload with separate fuse arrangement. Information on losses and short-circuit currents on page I-18 & I-19

All FR-PS models are short circuit and overload protected with built in PTC fuse.

Type	Voltage Sec. (V)	Current Sec. (A)	Power (VA)	Art. no.
230-250/12V				
FR60B-23012	12	3,3	40	3-071-060040
FR78B-23012	12	7,5	90	3-071-078050
FR84B-23012	12	10,8	130	3-071-084100
FR96B-23012	12	15	180	3-071-096140
FR96C-23012	12	20,8	250	3-071-096150
230-250/24V				
FR60B-23024	24	1,7	40	3-070-060010
FR78B-23024	24	3,8	90	3-070-100371
FR84B-23024	24	5,4	130	3-070-100372
FR96B-23024	24	7,5	180	3-071-096160
FR96C-23024	24	10,4	250	3-070-100374
FR120B-23024	24	16,7	400	3-071-120070
380-400-415-440/24V				
FR60B-38024	24	1,7	40	3-071-060050
FR78B-38024	24	3,8	90	3-070-078010
FR84B-38024	24	5,4	130	3-070-100671
FR96B-38024	24	7,5	180	3-071-096170
FR96C-38024	24	10,4	250	3-071-096180
FR120B-38024	24	16,7	400	3-071-120090

Type	Spenning Sek. (V)	Strøm Sek. (A)	Effekt (VA)	Art. nr.
230-250/24V				
FR60B-23024-PS	24	1,7	40	3-071-000066
FR78B-23024-PS	24	3,8	90	3-071-000067
FR84B-23024-PS	24	5,4	130	3-071-000068
230-250/2x24V				
FR78B-2302424-PS	2x24	2x1,8	2x45	3-070-060010

Wiring diagram

