

FIX-TR

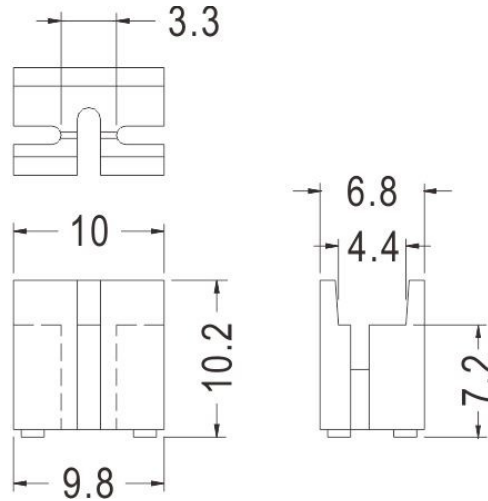

- ◆ MATERIAL: NYLON 66 (UL)
- ◆ FLAME CLASS: 94V-2
- ◆ COLOR: BLACK
- ◆ UNIT: mm
- ◆ APPLICATION: TO 220



PART NO
FIX-TR-1

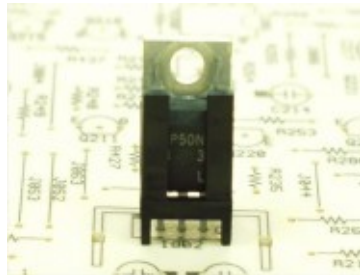

- ◆ MATERIAL: NYLON 66 (UL)
- ◆ FLAME CLASS: 94V-2
- ◆ COLOR: BLACK
- ◆ UNIT: mm
- ◆ APPLICATION: TO 220

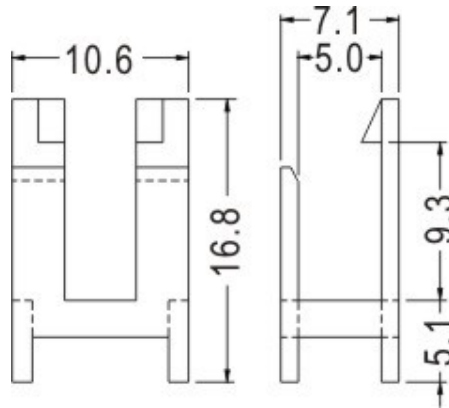

PART NO
FIX-TR-5

