

VARIANTS

MODEL	P/No.	VERSION	DIM A
MS1 X/S	CL19192	A	2.1
MS1 X/SB	CL19192B	B	2.1
MS1 X/A	CL19194	1/4" TAGS	2.1
MS1 X/S1	CL19191	A	1.1
MS1 X/A1	CL19193	1/4" TAGS	1.1
MS1 X2P/A1	CL191930	1/4" TAGS	1.1
MS1 X/A1 WHITE	CL191931	1/4" TAGS	1.1

USES INSULATING BOOT CL1928

RECOMMENDED PANEL
CUT-OUT SIZE

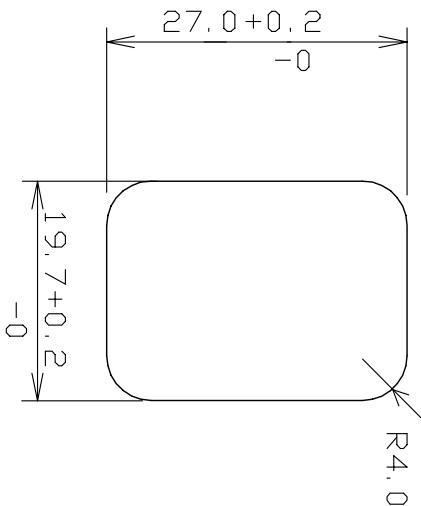

NOTE:
MODELS S1/A1 SUITABLE FOR PANEL
THICKNESS 0.8mm TO 1.1mm.
MODELS S/A SUITABLE FOR PANEL
THICKNESS 1.0mm TO 2.1mm.

ISS.	AMEND	DATE
1	REDRAWN	1/3/90
7	ERROR CORRECT	6/7/95
8	CL191930 ADD	24/2/98
9	30.5 WAS 30.8	15/12/98
10	MS1X/SB ADDED	26/3/99
11	CORRECTIONS	30/4/99
12	30.3 WAS 30.5	27/3/01
13	FINS REMOVED	8/1/02
14	ENECE17 ADD	7/3/03
15	REMOVE CSA RoHS+	16/06/08

OMITTED ON
2 POLE

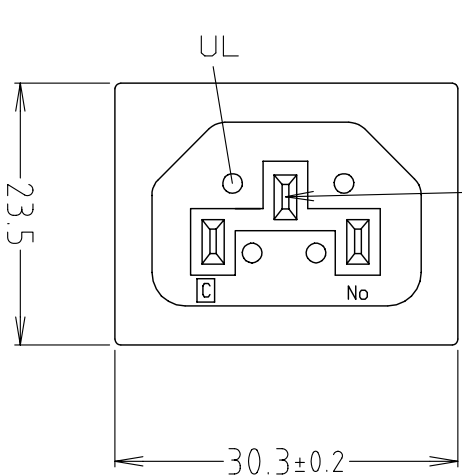

APPROVED
UL

APPROVED ENCE17 FOR ALL EC COUNTRIES.

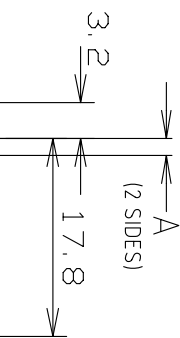

SOLDER TAG VERSIONS MS1 X/S
0.5mm THK X3 (VERSION A)
0.8mm THK X3 (VERSION B)

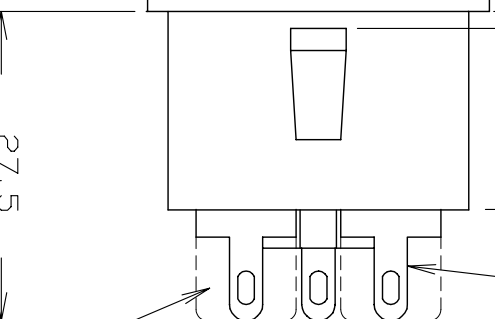

FASTON TAG VERSIONS MS1 X/A
1/4" TAGS 0.8mm THK

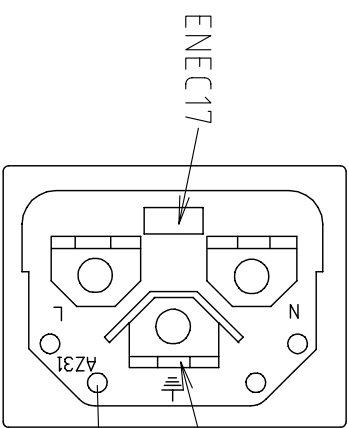

OMITTED ON
2 POLE

± AZ31

ROHS
COMPLIANT

Tolerance

NO DEC. PLACE ±
1 DEC. PLACE ± 0.20
2 DEC. PLACE ±
DIA. HOLES ±
ANGLES ± 1/2°
UNLESS
OTHERWISE STATED

WHERE USED F.R.

SCALE N.T.S.

DIMENSIONS IN MILLIMETERS UNLESS OTHERWISE STATED. WORK TO DIMENSIONS. DO NOT SCALE DRAWING. 3rd ANGLE PROJECTION. REMOVE BURRS. IF IN DOUBT ASK.

Cliff Electronic Components Limited

76 Holmehorpe Ave., Holmehorpe Ind Estate,
Redhill, Surrey, RH1 2PF, England.

Tel: 01737-771375 Fax: 01737-766012

MATERIAL POLYAMIDE UL 94 HB / BRASS

FINISH AS MOULDED / NI PLATED

DRAWN C.A.M.J. APPD. RWT

TITLE AC INLET MS1 X SNAP IN TYPE

DRWG. No. **CL 19192**

FORM: A4DRWG