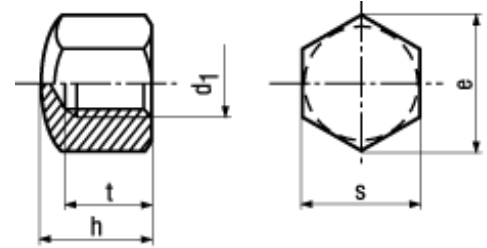

DIN 917

6

**BN 154****Hex cap nuts**

low type

Steel 6

zinc plated blue

M3: not included in DIN 917, M10; M12: wrench size according to ISO on request

Article#	d <sub>1</sub>	e min.	h	s	t min.	t max.
1429647	M3	6,08	5	5,5	3	3,4
1093290	M4	7,66	5,5	7	4,16	4,64
1093304	M5	8,79	7	8	4,96	5,44
1093312	M6	11,05	9	10	6,71	7,29
1093320	M8	14,38	12	13	9,21	9,79
1093339	M10	18,9	14	17	10,65	11,35
1093347	M12	21,1	16	19	13,15	13,85
1429655	M16	26,75	20	24	16,65	17,35
1429663	M20	32,95	25	30	20,58	21,42
1429671	M24	39,55	30	36	23,58	24,42