

DIN 7331 A

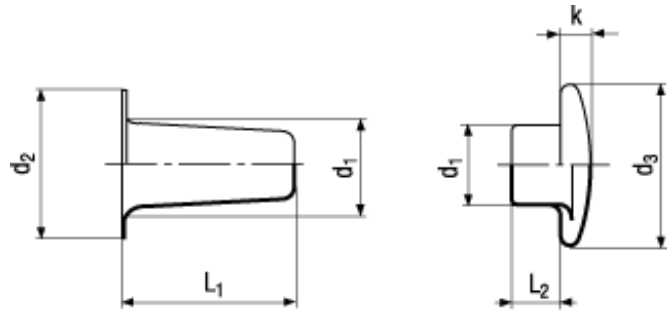

<b>BN 946</b>
<b>Compression rivets</b>
two parts
Steel
nickel plated
<ul style="list-style-type: none"> <li>• ~UNI 9064 A</li> <li>• ~UNI 9064 C</li> <li>• ~CSN 022387-8</li> </ul>

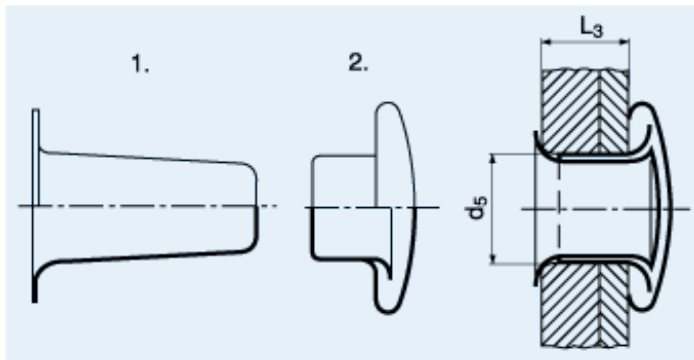
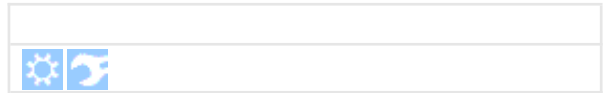

- 1. Riveting part (BN 945)
- 2. Head part (BN 946)
- L3: clamping range
- d5: hole diameter

Depending on the material elasticity used on the elements to be assembled, deviations relating to the indicated assembly lengths are possible.

Article#	d <sub>1</sub>	d <sub>3</sub>	k~	L <sub>2</sub> ~
1371258	3	6	1,2	3
1371266		7	1,2	3
1371274	4	7	1,6	4
1371290		9	1,6	4
1371304		11	1,6	4
1371312		13	1,6	4
1371320	5	10	2	5
1371339		12	2	5
1371347	6	12	2,4	6