

CONFIGURAZIONE POLARIZZAZIONI
POLARIZATION CONFIGURATION

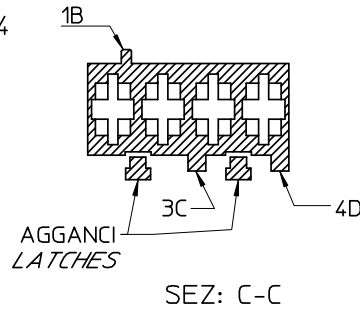

NOTE:

- USATO CON TERMINALE 94518-0XXX E 94549-0XXX
- SPECIFICA DI RIFERIMENTO PER IL CONNETTORE PS-94550-001
- PER CARATTERISTICHE DI CRIMPATURA RIF. SD-94518-005 E SD-94549-001
- FORZA DI DISACCOPIAMENTO CONNETTORE (TRAZIONANDO DAI CAVI SENZA AZIONARE L'AGGANCI): 60 N MIN.
- SPESSORE MINIMO PARETI CONNETTORE 0.40 mm.

NOTE:

- USED WITH TERMINALS 94518-0XXX AND 94549-0XXX
- REFER TO PS-94550-001 FOR CONNECTOR SPECIFICATION
- REFER TO SD-94518-005 AND SD-94549-001 FOR CRIMPING CHARACTERISTICS
- CONNECTOR DISENGAGEMENT FORCE (PULLING BY THE WIRES, WITHOUT ACTUATING THE LATCH): 60 N MIN.
- MINIMUM CONNECTOR WALL THICKNESS 0.40 mm.

PACKAGING: 1800 pcs in carton box
CONFEZIONE: Box da 1800 Pz.

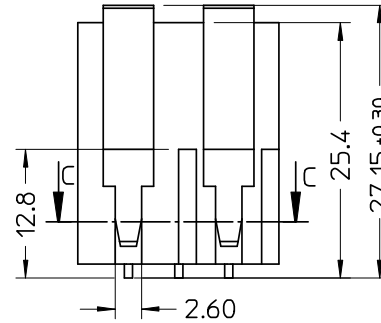
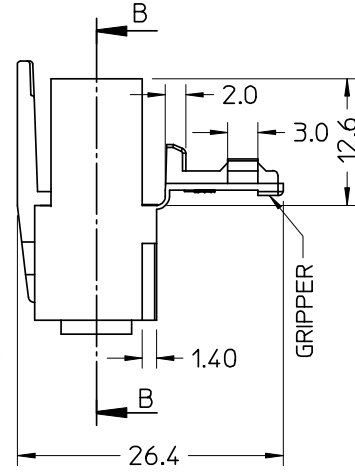
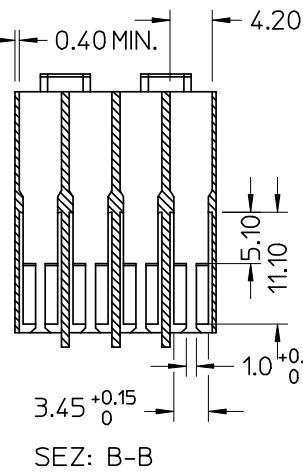
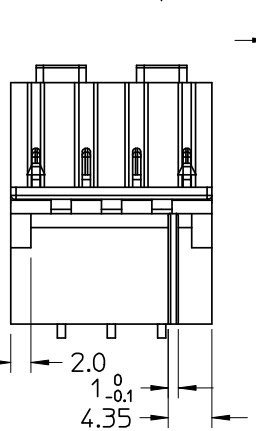

P/N	MATERIAL / COLOR
94550-8004	NYLON 6.6 V2 NATURAL
* 94550-9004	NYLON 6.6 V0 NATURAL
94550-4004	NYLON 6.6 GWT 750°C sec. IEC 60335-1 TEST METHOD IEC 60695-2-11 NATURAL
94550-3084	NYLON 6.6 BLACK NO-FLAME HOT WIRE IGNITION TEST

* AGENCY RECOGNIZATIONS
CSA (file LR19980)
UL (file E-29179)

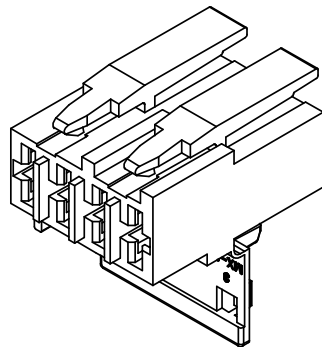
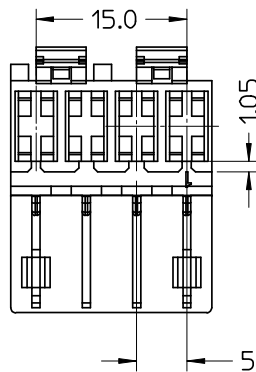

SPQ =1800 Std. Descr: "HSG W/SEC LOCK AND LATC 4CKT _____ COLOR"

EC NO: Z2008-0047 DRWN: FGOTTARD 2007/09/18 CHKD: LSANTISSA 2007/09/19 APPR: GZUIN 2007/11/05	QUALITY SYMBOLS	GENERAL TOLERANCES (UNLESS SPECIFIED)	SCALE 2:1	DESIGN UNITS METRIC	FIRST ANGLE PROJECTION	REVISE ON CAD ONLY
		mm	INCH	DIMENSION STYLE MM ONLY	TITLE HSG 4 CKT WITH SEC. LOCK AND EXTERNAL LATCH MOLEX MOLEX INCORPORATED	
		4 PLACES ± --- ± ---	3 PLACES ± --- ± ---	DRAWN BY DATE FGOTTARD 2002/06/27		
	A3	DESCRIPTION	ANGULAR ± 2 °	CHECKED BY DATE MTESTAGU 2002/06/27	APPROVED BY DATE GZUIN 2002/06/27	MATERIAL NO. SEE TABLE
REV		DRAFT WHERE APPLICABLE MUST REMAIN WITHIN DIMENSIONS	THIS DRAWING CONTAINS INFORMATION THAT IS PROPRIETARY TO MOLEX INCORPORATED AND SHOULD NOT BE USED WITHOUT WRITTEN PERMISSION		SHEET NO. 1 OF 1	A3