

81513516-Base mounted



- ✓ Conform to the Low Voltage Directive
- ✓ Can be used without enclosure according to IEC 664-1 pollution group III

Symbol

Pneumatic connection Push-in connection for semi-rigid tubing (NFE 49100) mm

Pneumatic connection Tapped BSP via connector	-
Protection IEC 529	IP 54
Permissible fluid: air, inert gases and liquids	✓
Adjustment of switching pressure (* adjusted to 0,3) bar	2 →8
Hysteresis at 1 bar bar	0,5
Hysteresis at 2 bars bar	0,6
Hysteresis at 4 bars bar	0,8
Hysteresis at 6 bars bar	1
Max. hysteresis 200 mb	-
Max. hysteresis 250 mb	-
Pressure to break	-
Mechanical life (operations)	10 ⁶
Operating temperature (°C)	-10 + 70
Weight (g)	56

Breaking capacity (V resistive)

Wire cross-section ²	0,75
Standard electrical contact	V4 83 170 4 I W2
Approvals UL and cUL	MH15213 (R)

Dimension Diagram : 81 513 516 - 81 513 510 - 81 513 521

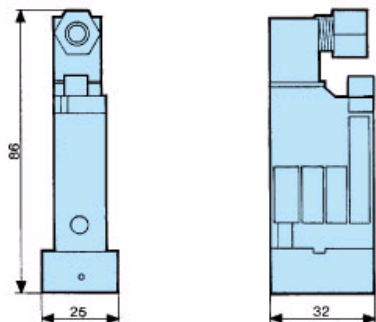

: Pressure operated

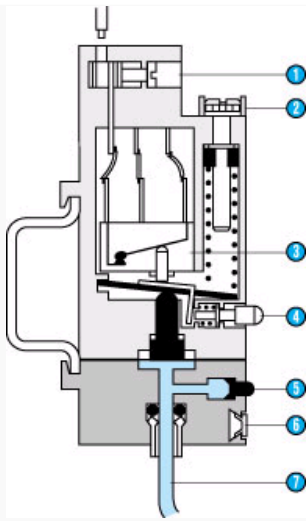

N°	Legend
1	Electrical output - common - normally closed contact - normally open contact
2	Adjustment of switching pressure 1 to 8 bars
3	Standard microswitch 5 A - 220 V
4	Manual override
5	Pneumatic indicator
6	Marking tag
7	Pneumatic signal

Curves : Electrical life

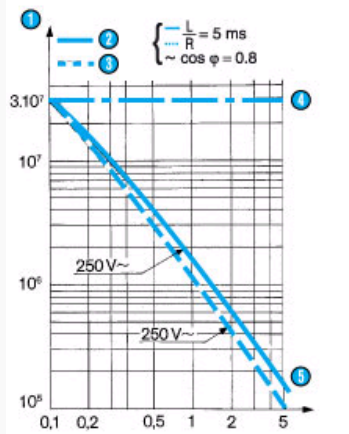

N°	Legend
1	Number of cycles
2	Resistive circuit
3	Inductive circuit
4	Mechanical life
5	Current in Amps

: 81 513 510 - 81 513 521 - 81 513 516



N°	Legend
1	Common
4	NO contact

