

444 LED Double Flash/Multi-Tone Sounder Combination

NEW



Base Mounting



Wall mounting

- Multi-Tone Sounder in combination with LED Double Flash
- Sound output adjustable up to 110 dB
- 32 tones for a diverse range of applications
- 3 Tones can be triggered externally
- Optical and audible signal can be triggered separately

TECHNICAL SPECIFICATIONS:

| | |
|------------------------------------|--|
| Dimensions (D x W x Ht): | 152 mm x 109 mm x 112.5 mm |
| Housing: | PC/ABS-Blend |
| Dome: | PC, transparent |
| Connection: | Screwable connection with wire protection max. 1.5 mm ² |
| Starting consumption: | < 500 mA at 24 V |
| Cable entry: | Membrane for cable diameter max. 13 mm |
| Fixing: | Wall, base and ceiling mounting |
| Life duration: | Up to 50,000 hrs (LED Double Flash) |
| Flash frequency: | c. 1 Hz |
| Tone types and frequencies: | selectable via DIP switch, see table on opposite page |



Life duration up to 50,000 hrs

ORDER SPECIFICATIONS:

| | 24 V = | 115 V ~ | 230 V ~ |
|-----------------------------|-------------------|-------------------|-------------------|
| Current consumption Optical | 100 mA | 55 mA | 30 mA |
| Audible | 60 mA | 30 mA | 30 mA |
| red | 444 100 75 | 444 100 67 | 444 100 68 |
| yellow | 444 300 75 | 444 300 67 | 444 300 68 |

Available from 1st Quarter 2009

ACCESSORIES:

Cable gland M 20 x 1.5 mm **975 444 01**
(for cable pull relief)

ADDITIONAL INFORMATION:

The various options for mounting (wall, base or ceiling) ensure the best possible visibility of the LED double flash and an optimal sound output.

QUICK AND SIMPLE MOUNTING

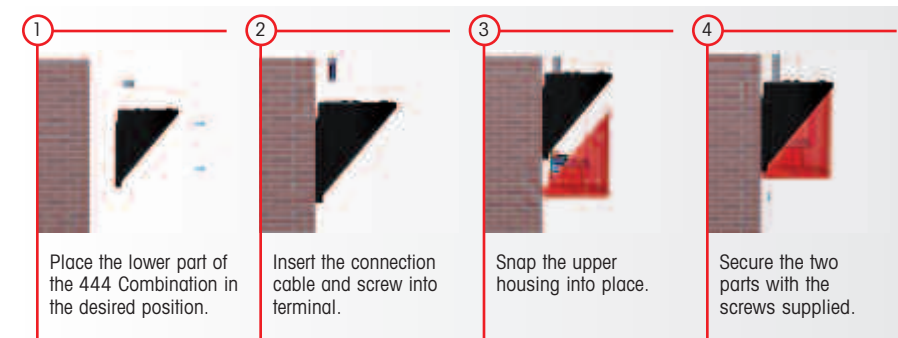

TECHNICAL DIAGRAMS:

see page 263

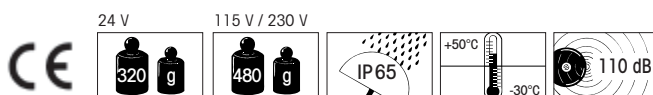

444 LED Double Flash/Multi-Tone Sounder Combination

The LED Double Flash/Multi-Tone Sounder 444 offers a large choice of international signal tones for the widest spectrum of applications.



🎵 TONE TYPES AND FREQUENCIES:

| Tone 1 | Tone type | Frequency | Description | Use | Tone 2 | Tone 3 |
|--------|-------------|--------------|---|--------------------------------------|---------------|---------------|
| 1 | continuous | 200 | | BS 5839-1:2002, VDS | 440 Hz cont. | 554 Hz cont. |
| 2 | rising | 800 & 970 | 7 Hz | | 14 | 800 Hz cont. |
| 3 | rising | 800 & 970 | 1 Hz | | 14 | 800 Hz cont. |
| 4 | continuous | 2850 | | | 14 | 9 |
| 5 | rising | 2400 to 2850 | 7 Hz | VDS | 4 | 2400 Hz cont. |
| 6 | rising | 2400 to 2850 | 1 Hz | | 4 | 2400 Hz cont. |
| 7 | rising | 500 to 1200 | 3 s, then 0.5s OFF (then repeat) | | 14 | 8 |
| 8 | falling | 1200 to 500 | 1 Hz | VDS | 14 | 7 |
| 9 | alternating | 2400 & 2850 | 2 Hz | | 4 | 2400 Hz cont. |
| 10 | pulse | 970 | 0.5 Hz (1s On/1s Off) | BS 5839 Part 1 1988 | 14 | 800 Hz cont. |
| 11 | alternating | 800 & 970 | 1 Hz | BS 5839 Part 1 1988 | 14 | 800 Hz cont. |
| 12 | pulse | 2850 | 0. Hz | | 4 | 22 |
| 13 | pulse | 970 | | 0,25s On/1s Off | 14 | 800 Hz cont. |
| 14 | continuous | 970 | | BS 5839-1: 2002 PFEER - Toxic gas | 10 | 8 |
| 15 | alternating | 554 & 440 | | France NFS | 14 | 800 Hz cont. |
| 16 | pulse | 660 | 150 ms On / 150 ms Off | Swedish | 16 | 14 |
| 17 | pulse | 660 | 1.8s On / 1.8s Off | Swedish | 17 | 14 |
| 18 | pulse | 660 | 6.5s On / 13s Off | Swedish | 18 | 14 |
| 19 | continuous | 660 | | Swedish | 19 | 31 |
| 20 | alternating | 554 & 440 | 0.5 Hz | | 20 | 19 |
| 21 | pulse | 660 | 1 Hz | Swedish | 21 | 4 |
| 22 | pulse | 2850 | 150 ms On / 100 ms Off | GB | 14 | 4 |
| 23 | rising | 800 to 970 | 50 Hz (low) | BS 5839 Part 1 1988 | 14 | 800 Hz cont. |
| 24 | rising | 2400 to 2850 | 50 Hz (high) | | 4 | 2400 Hz cont. |
| 25 | pulse | 970 | 3 x 500 ms ON / 500ms OFF / 1.5s silence, then repeat (low) | ISO 8201 US Temporal | 26 | 14 |
| 26 | pulse | 2850 | 3 x 500 ms ON / 500 ms OFF / 1.5s silence, then repeat (high) | ISO 8201 US Temporal | 25 | 4 |
| 27 | continuous | 4000 | | | 27 | 6 |
| 28 | rising | 2000 to 2850 | 7Hz | | 2000 Hz cont. | 4 |
| 29 | alternating | 988 & 645 | 2Hz | | 988 Hz cont. | 645 Hz cont. |
| 30 | alternating | 510 & 610 | 2Hz | | 510 Hz cont. | 610 Hz cont. |
| 31 | alternating | 800 & 970 | 2Hz | 5839-1:2002 | 800 cont. | 14 |
| 32 | alternating | 800 & 1200 | 1Hz | | 800 cont. | 1200 Hz cont. |



LED EVS/Multi-Tone Sounder Combination

- Multi-Tone Sounder in combination with LED EVS signal
- Random sequence of light signals prevents acclimatisation effect
- 32 tones for a diverse range of applications
- Sound output adjustable up to 114 dB
- 3 tones can be triggered externally
- Optical and audible signal can be triggered separately



Base mounting



The „EVS“ light effect ensures a maximum attention-grabbing effect

TECHNICAL SPECIFICATIONS:

| | | | |
|-----------------------------|--|--|--|
| Dimensions (W x H x D): | 152 mm x 109 mm x 113 mm | | |
| Housing: | PC/ABS-Blend | | |
| Dome: | PC, transparent | | |
| Connection: | Screwable connection with wire protection max. 2.5 mm ² | | |
| Cable entry: | Membrane for cable diameter max. 13 mm | | |
| Starting consumption: | < 500 mA at 24 V | | |
| Fixing: | Wall, base and ceiling mounting | | |
| Life duration: | Up to 50,000 hrs (LED EVS) | | |
| Tone types and frequencies: | Selectable via DIP switch, see table on page 34 | | |



ORDER SPECIFICATIONS:

| | | | | |
|---------------------|--------------------|-------------------|-------------------|-------------------|
| Voltage | | 24 V = | 115 V = | 230 V ~ |
| Current consumption | LED EVS | 280 mA | 55 mA | 30 mA |
| | Multi-Tone Sounder | 60 mA | 30 mA | 30 mA |
| red | | 444 110 75 | 444 110 67 | 444 110 68 |
| yellow | | 444 310 75 | 444 310 67 | 444 310 68 |

Available: 2nd Quarter 2010.

ACCESSORIES:

| | |
|---|-------------------|
| Cable gland M 20 x 1.5 mm (for cable pull relief) | 975 444 01 |
|---|-------------------|

TONE TYPES AND FREQUENCIES:

See table on page 34

ADDITIONAL INFORMATION:

* EVS = Enhanced Visibility System (see page 28)

Increased safety in schools

WERMA has conducted an intensive study on the use of "signal devices for violent incident warning", holding numerous discussions with teachers as well as drawing on the advice of experts. Building on this knowledge and on the recommendation of the Expert Committee, the **optical-audible combination 444** has been specially developed for use in schools.

This signal device combines the attention-grabbing LED EVS signal with a loud 114 dB multi-tone sounder and can definitely not fail to achieve the desired warning effect. Pupils and teachers can be warned as clearly and rapidly as possible in the event of a violent incident.

