

Technical data sheet

Cable gland, EX area, PG thread

Art.-Nr. 2050056



Cable gland with EG design type approval certificate for products and protection systems for use in accordance with the regulations in explosion-hazard area. Directive 94/9/EC.
 EC design type approval certificate number: PTB 99 ATEX 3112X and ... 3113X.
 With PG connection thread according to IEC 423.
 Robust cap-nut cable gland with large sealing area, as well as strain relief and torsion protection for high sealing demands.
 Sealing ring of chloroprene/nitrile rubber, moulded sealing, so no connection thread sealing ring needed, VDE-tested.
 Protection rating IP 68 at 5 bar.



PA Polyamide

Master data

Item No.	2050056
Type	VTEC EX PG16 SW
Description 1	Cable gland, EX area
Dimension	PG16
Colour	Black
Material	Polyamide
Material symbol	PA
Smallest sales unit	25,00 pcs
Weight	1,38 kg/100 pcs.

Technical specifications

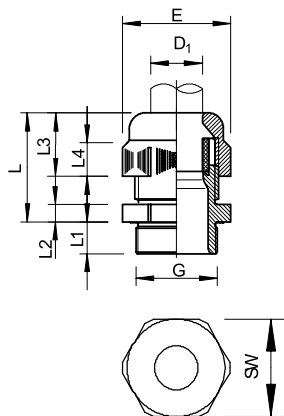

Dimension L min.	25,00 mm
Dimension L max.	33,00 mm
Dimension L1	10,00 mm
Dimension L2	6,00 mm
Dimension L3	19,00 mm
SW	27,00 mm
Version	Straight
Type of seal	Sealing ring
Bend protection	<input checked="" type="checkbox"/>
Sealing range D	7,00 - 14,00 mm
explosion-proof	<input checked="" type="checkbox"/>
Flat cable threaded connection	<input checked="" type="checkbox"/>
For Ex zone	Ex area 22
For Ex zone dust	22
Thread	Pg 16
Thread type	PG
Thread length	10,00 mm
Thread increase	1,50 mm
Nominal thread size	16,00
Glass-fibre reinforced	<input checked="" type="checkbox"/>
Halogen-free	<input checked="" type="checkbox"/>
Multiple sealing insert	<input checked="" type="checkbox"/>
With locknut	<input checked="" type="checkbox"/>
Impact resistant	<input checked="" type="checkbox"/>

Technical data sheet

Cable gland, EX area, PG thread

Art.-Nr. 2050056



Technical specifications

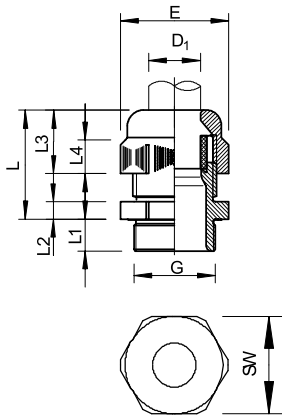

Hexagonal corner dimension	30,00 mm
Protection rating	IP68
Splittable gland	<input checked="" type="checkbox"/>
max. permitted ambient temperature	-20,00 - 70,00 °C
Strain relief option	<input checked="" type="checkbox"/>