



PROFIBUS Field Attachable Connectors

0976 PFC 101



M12 Female (Screw Terminals)

Field attachable connector, M12 female connector with threaded joint, shieldable, assembling with screw terminals 0976 PFC 101: 5 poles, B coding.

– especially suitable for Profibus signal cable 0975 254 000/... M –

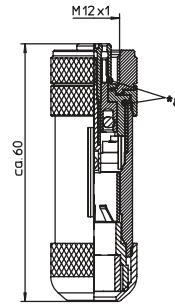

*a O-Ring

0976 PFC 102



M12 Female (Spring-Type Terminals)

Field attachable connector, M12 female connector with threaded joint, shieldable, assembling with spring-type terminals 0976 PFC 102: 4 poles, B coding.

– especially suitable for Profibus signal cable 0975 254 000/...M Profibus signals –

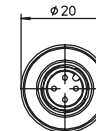
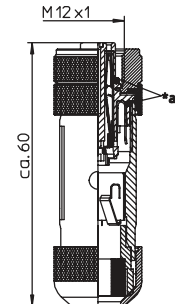

*a O-Ring

Pin Assignment

M12 - 4 Poles (B-Code)



M12 - 5 Poles (B-Code)





Be Certain with Belden

PROFIBUS Field Attachable Connectors

0976 PFC 101 | 0976 PFC 102

Technical Data

Environmental

Degree of protection IP 67 / NEMA 6P
 Operating temperature range -25°C (-13°F) / +90°C (+194°F)

Mechanical

Housing / Molded body GD-ZnAl, pre-coppered and nickel-plated
 Insert PBT
 Contact 0976 PFC 101: CuZn, pre-coppered, CuSnZn
 0976 PFC 102: Stainless steel, silver-plated, gold plated
 Receptacle shell CuZn, nickel-plated
 Shield sleeve CuBe, tin-plated
 O-ring FKM
 Mode of connection 0976 PFC 101: screw terminals
 0976 PFC 102: spring-type terminals
 Connectable conductor 0976 PFC 101: max. 0.75 mm²
 0976 PFC 102: 0.14-0.50 mm², 0.14 mm² with terminal pin sleeve

Electrical

Contact resistance ≤ 5 mΩ
 Nominal current at 40°C 4 A
 Nominal voltage 4 poles 120 V
 5 poles 60 V
 0976 PMC 102: 32 V
 Rated voltage 4 poles 125 V
 5 poles 63 V
 Test voltage 4 poles 1.5 kV eff. / 60 s
 5 poles 1.0 kV eff. / 60 s
 0976 PMC 102: 0.65 kV eff. / 60 s
 Insulation resistance > 10⁹ Ω
 Pollution degree 3

Part Number	Pins	Screw Joint for Cable	
0976 PFC 101	5B	Ø 4.0-9.0 mm	
0976 PFC 102	4B	Ø 4.0-9.0 mm	