

All proprietary rights reserved by MTA Sp.A. - This drawing shall not be reproduced, or in any way utilized, for the manufacture of the component or unit herein illustrated and must not be released to other parties, without written consent. Any infringement will be legally pursued.

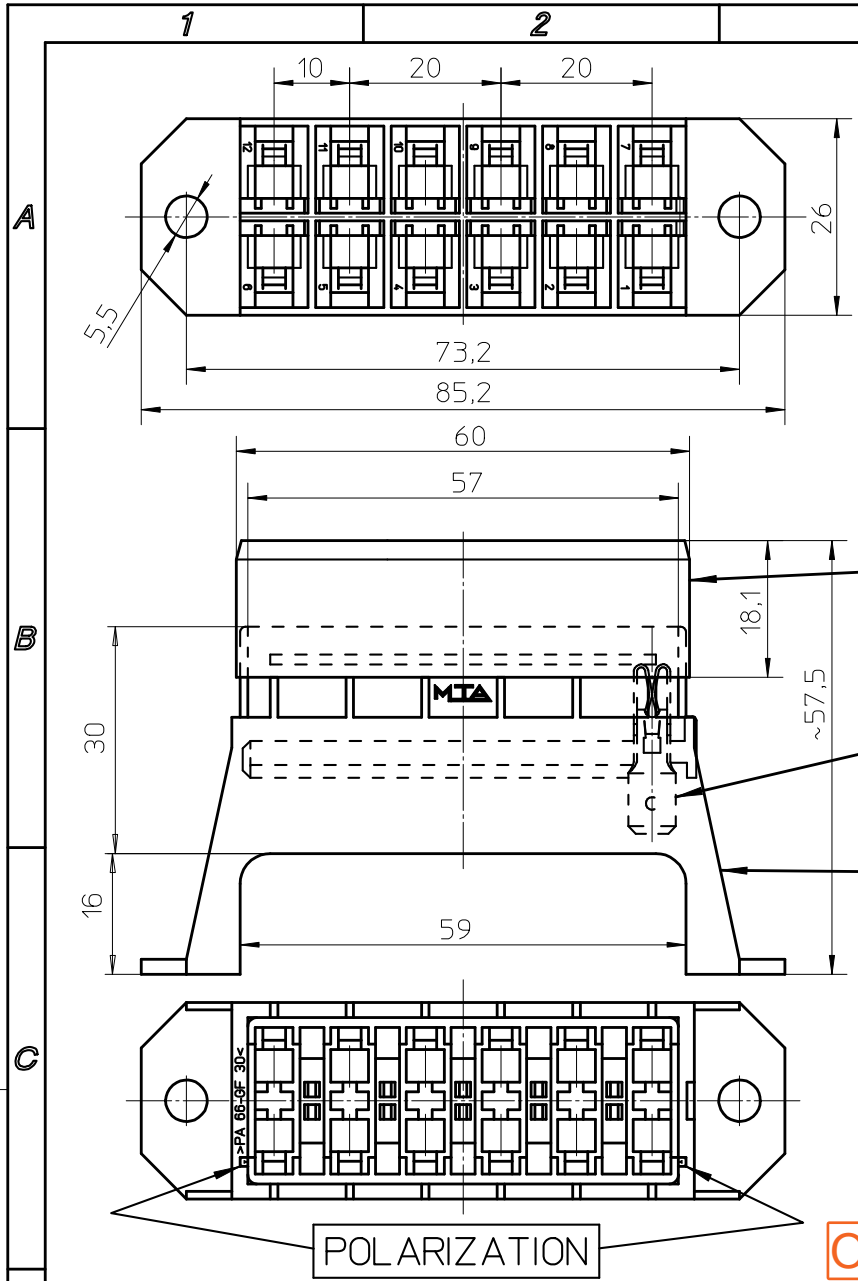

OPERATING FEATURES		
FEATURE	UNIT	VALUE
V max	V	32
T. min - T. max	°C	-30 / +85
* I Global Continuous	A	100
IP	IEC 529	22

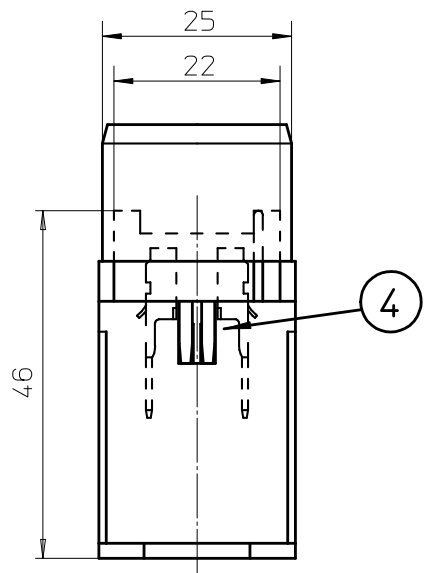

*APPLICATION WITH GLOBAL CURRENT HIGHER THAN THE INDICATED ONE, HAVE TO BE VERIFIED AND AUDITED ONE BY ONE

ONLY FOR REFERENCE

4	2	SECONDARY LOCK	PA 66 V2 - YELLOW COLOR
3	8	MALE TERMINAL	CuSn Tin Plated
2	1	COVER	PC V2 - TRANSPARENT
1	1	BODY 4 WAY	PA 66-GF30 HB - BLACK COLOR
Pos.	Q.ty	DENOMINATION	MATERIAL

MTA		MTA P/N	0100560/20		Denom. FUSE BOX UNIVAL AXIAL 6WAY	
		Draw No.	B0-002.014A		Used for	
Rel. Level	APPROVED		Draw for	CLIENT		Relevant Standard
Date	Name	Scale	Weight(g)	Lin.Tol.±	Ang.Tol.±	Material SEE TABLE
Draft	28/12/1995	L. BASSI	1:1	0.3		Coating SEE TABLE
Chk	28/12/1995	L. BASSI				
PQApp	30/07/2008	R.GONZALEZ	A4	Dimensions in (mm)	Sheet 1/1	Color SEE TABLE
App.	30/07/2008	M.CORBANI				

4	LATERAL HOLES REMOVED				
No.	Reason for Revision	Date	30/07/2008	Name	S.BEDUSCHI