

Series: SMD-PLCC2

Colour: green

Sloan Part No.: SMD-GPLCC-02

Electrical and Optical Characteristics (T_A = 25°C)

Chip		Lens	Absolute Maximum Ratings				Electro-Optical-Data's at 20mA					Viewing Angle 2 θ ½ (deg)	
Emitted Colour	Peak Wavelength λ _p (nm)		Δλ (nm)	Pd (mW)	I _f (mA)	Peak I _f (mA)	Forward Voltage V _F (V)		Luminous Intensity I _v (mcd)				
	min.	max.					min.	max.	min.	typ.	max.		
green	500	505	water clear	-	95	25	*150	3.0	3.2	355	600	-	120°

*Peak Forward Current (1/10 Duty Cycle, 0.1ms Pulse Width)

Absolute Maximum Ratings (T_A = 25°C)

Reverse Voltage	5V
Reverse Current (V _R = 5V)	≤5μA
Operating Temperature Range	- 40°C ~ +85°C
Storage Temperature Range	- 40°C ~ +85°C

2000pcs. / reel

Package Dimensions

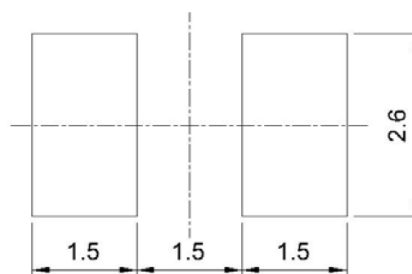
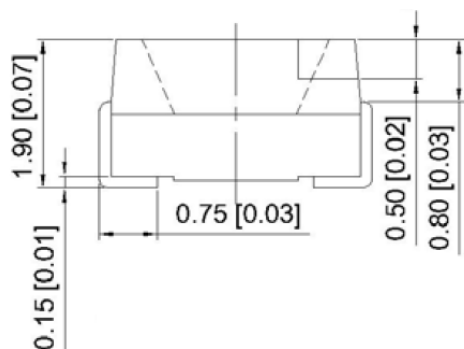
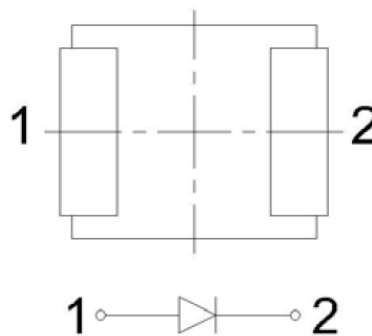
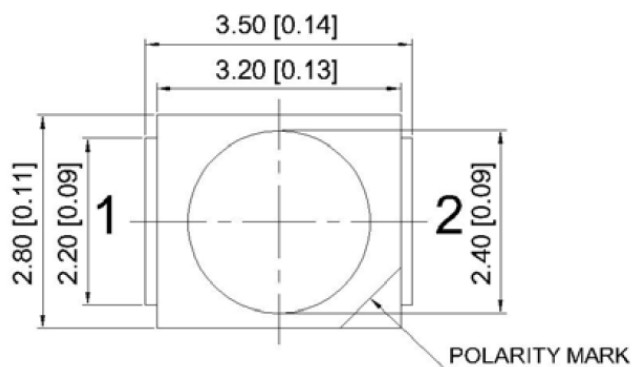

1. All dimensions are in millimetres.
2. Tolerance is ±0.25mm unless otherwise specified.
3. Specifications are subject to change without notice.

Electrical and Optical Characteristics (T_A = 25°C)

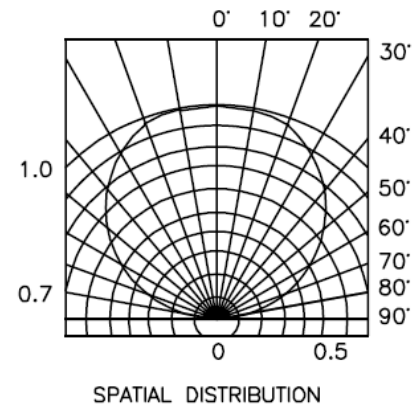
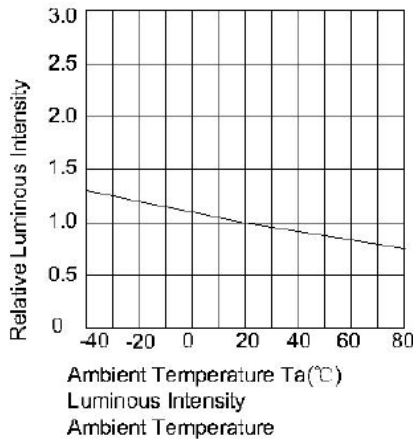
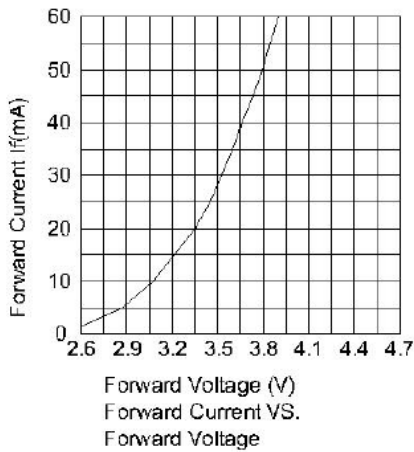
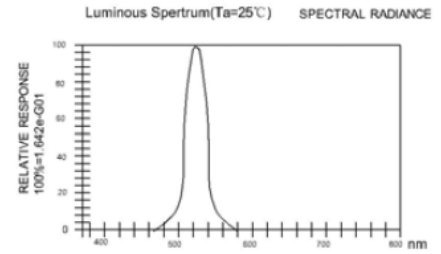
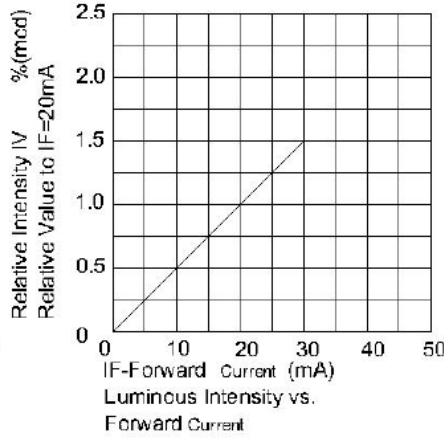
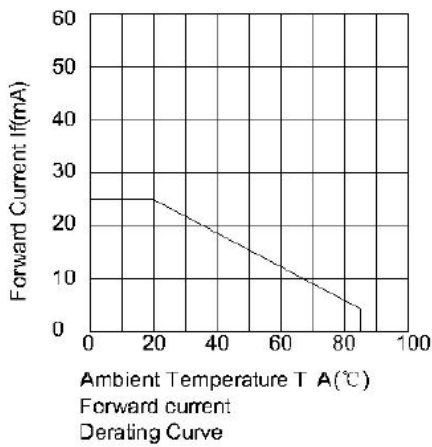

Soldering

SMT Reflow Soldering Instructions

Number of reflow process shall be less than 2 times and cooling process to normal temperatures is required between first and second soldering process.

