

Type  
**186000**

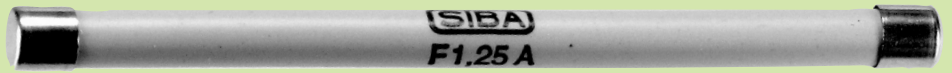

Type  
**187000**

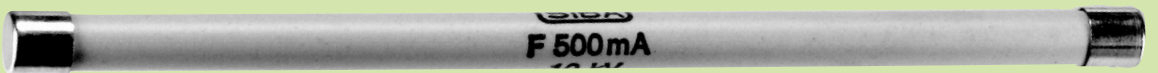

Zeit/Strom-Kennlinien  
Time-Current Characteristics

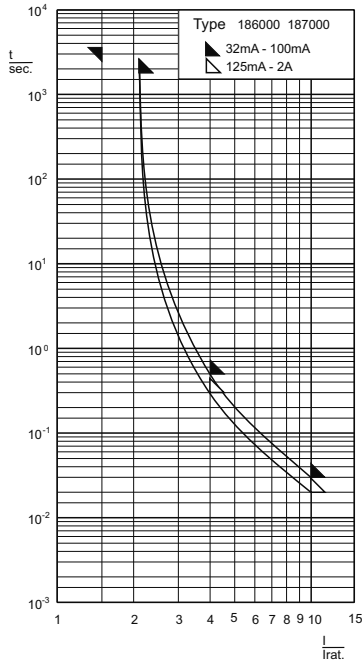

Abmessungen  
Dimensions

186000

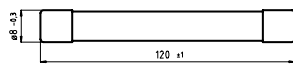

187000

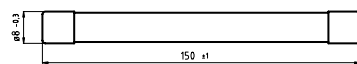

**Aufbau / Construction**

Keramikrohr / ceramic tube

undurchsichtig / non-transparent

Kontaktkappen / end caps

Messing, vernickelt / brass, nickel-plated

**Zubehör / Related Products**

Halter / holder

siehe Seite 85 / see page 85

**Schmelzeitgrenzwerte / Fusing time limits**

Bemessungsstrom Rated Current	1,5 I <sub>n</sub>		2,1 I <sub>n</sub>		4 I <sub>n</sub>		10 I <sub>n</sub>	
	min.	max.	min.	max.	min.	max.	min.	max.
32 mA - 100 mA	1 h	-	-	30 min	-	500 ms	-	30 ms
125 mA - 4 A (Type 186000)	1 h	-	-	30 min	-	300 ms	-	20 ms
125 mA - 2 A (Type 187000)	1 h	-	-	30 min	-	300 ms	-	20 ms

DIN 41683 DIN 41684	<b>8 x 120 mm</b> <b>8 x 150 mm</b>	6 kV 10 kV	M mittelträge / med. time-lag F flink / quick acting
------------------------	--	---------------	---

Artikel-Nr. Article-no.	Artikel-Nr. Article-no.	Bemessungs- strom Rated Current	Bemessungs- Ausschaltvermögen Rated Breaking Capacity	Spannungsfall 186000 Voltage Drop	Spannungs- fall 187000 Voltage Drop	Charakte- ristik Characte- ristics
				mV max.	mV max.	
8 x 120 mm	8 x 150 mm					
186000.0,032	187000.0,032	32 mA		<sup>1)</sup> 6000	14000	M
186000.0,05	187000.0,05	50 mA		<sup>1)</sup> 4400	8500	M
186000.0,063	187000.0,063	63 mA		<sup>1)</sup> 3800	6500	M
186000.0,08	187000.0,08	80 mA		<sup>1)</sup> 3200	5000	M
186000.0,1	187000.0,1	100 mA		<sup>1)</sup> 2900	4000	M
186000.0,125	187000.0,125	125 mA		<sup>1)</sup> 22000	27000	F
186000.0,16	187000.0,16	160 mA		<sup>1)</sup> 19000	24000	F
186000.0,2	187000.0,2	200 mA		<sup>1)</sup> 16000	21000	F
186000.0,25	187000.0,25	250 mA		<sup>1)</sup> 14000	18500	F
186000.0,315	187000.0,315	315 mA		<sup>1)</sup> 12000	17000	F
186000.0,4	187000.0,4	400 mA		<sup>1)</sup> 5000	6000	F
186000.0,5	187000.0,5	500 mA		<sup>1)</sup> 2300	2900	F
186000.0,63	187000.0,63	630 mA		<sup>1)</sup> 2000	2700	F
186000.0,8	187000.0,8	800 mA		<sup>1)</sup> 1900	2400	F
186000.1	187000.1	1 A		<sup>1)</sup> 1800	2100	F
186000.1,25	187000.1,25	1,25 A		<sup>1)</sup> 1400	1800	F
186000.1,6	187000.1,6	1,6 A		<sup>1)</sup> 1300	1600	F
186000.2	187000.2	2 A		<sup>1)</sup> 1100	1400	F
186000.2,5	-	2,5 A <sup>2)</sup>		<sup>1)</sup> <sup>3)</sup>	-	F
186000.3,15	-	3,15 A <sup>2)</sup>		<sup>1)</sup> <sup>3)</sup>	-	F
186000.4	-	4 A <sup>2)</sup>		<sup>1)</sup> <sup>3)</sup>	-	F

<sup>1)</sup> 186000: 35 A @ AC 6 kV

Type	Abk. Abbr.	Beschreibung Description
	-	25 Stück / Pieces