

Type
186000

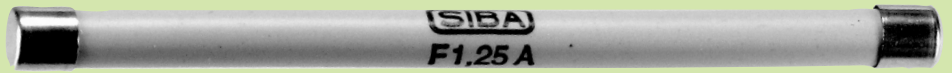

Type
187000

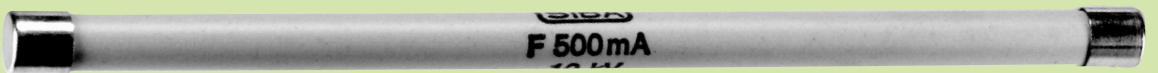

Zeit/Strom-Kennlinien
Time-Current Characteristics

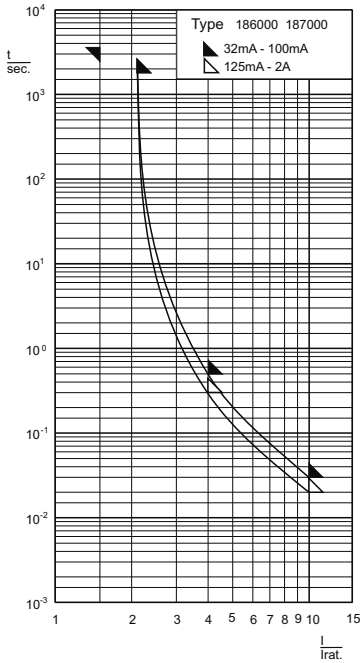

Abmessungen
Dimensions

186000

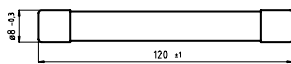

187000

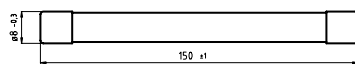

Aufbau / Construction

Keramikrohr / ceramic tube

undurchsichtig / non-transparent

Kontaktkappen / end caps

Messing, vernickelt / brass, nickel-plated

Zubehör / Related Products

Halter / holder

siehe Seite 85 / see page 85

Schmelzeitgrenzwerte / Fusing time limits

Bemessungsstrom Rated Current	1,5 I _n		2,1 I _n		4 I _n		10 I _n	
	min.	max.	min.	max.	min.	max.	min.	max.
32 mA - 100 mA	1 h	-	-	30 min	-	500 ms	-	30 ms
125 mA - 4 A (Type 186000)	1 h	-	-	30 min	-	300 ms	-	20 ms
125 mA - 2 A (Type 187000)	1 h	-	-	30 min	-	300 ms	-	20 ms

DIN 41683 DIN 41684	8 x 120 mm 8 x 150 mm	6 kV 10 kV	M mittelträge / med. time-lag F flink / quick acting
------------------------	--	---------------	---

Artikel-Nr. Article-no.	Artikel-Nr. Article-no.	Bemessungs- strom Rated Current	Bemessungs- Ausschaltvermögen Rated Breaking Capacity	Spannungsfall 186000 Voltage Drop	Spannungs- fall 187000 Voltage Drop	Charakte- ristik Characte- ristics
				mV max.	mV max.	
8 x 120 mm	8 x 150 mm					
186000.0,032	187000.0,032	32 mA		¹⁾ 6000	14000	M
186000.0,05	187000.0,05	50 mA		¹⁾ 4400	8500	M
186000.0,063	187000.0,063	63 mA		¹⁾ 3800	6500	M
186000.0,08	187000.0,08	80 mA		¹⁾ 3200	5000	M
186000.0,1	187000.0,1	100 mA		¹⁾ 2900	4000	M
186000.0,125	187000.0,125	125 mA		¹⁾ 22000	27000	F
186000.0,16	187000.0,16	160 mA		¹⁾ 19000	24000	F
186000.0,2	187000.0,2	200 mA		¹⁾ 16000	21000	F
186000.0,25	187000.0,25	250 mA		¹⁾ 14000	18500	F
186000.0,315	187000.0,315	315 mA		¹⁾ 12000	17000	F
186000.0,4	187000.0,4	400 mA		¹⁾ 5000	6000	F
186000.0,5	187000.0,5	500 mA		¹⁾ 2300	2900	F
186000.0,63	187000.0,63	630 mA		¹⁾ 2000	2700	F
186000.0,8	187000.0,8	800 mA		¹⁾ 1900	2400	F
186000.1	187000.1	1 A		¹⁾ 1800	2100	F
186000.1,25	187000.1,25	1,25 A		¹⁾ 1400	1800	F
186000.1,6	187000.1,6	1,6 A		¹⁾ 1300	1600	F
186000.2	187000.2	2 A		¹⁾ 1100	1400	F
186000.2,5	-	2,5 A ²⁾		¹⁾ ³⁾	-	F
186000.3,15	-	3,15 A ²⁾		¹⁾ ³⁾	-	F
186000.4	-	4 A ²⁾		¹⁾ ³⁾	-	F

¹⁾ 186000: 35 A @ AC 6 kV

Type	Abk. Abbr.	Beschreibung Description
	-	25 Stück / Pieces