

# Proximity Sensors SMT/SME

Product Overview



- Versions for T-slot and C-slot
- Switch output contactless or via reed contacts
- Secured with screw or clamped, insertable in the slot from above or lengthwise
- Suitable for use with energy chains and robots
- Wide range of mounting and connection options
- Free of copper and PTFE

Detailed product information → [www.festo.com/catalog/sm](http://www.festo.com/catalog/sm)

Product Overview							
Design	Type of mounting	Measuring principle	Type	Operating voltage range	Switch output	Switching element function	→ Page/Internet
For T slot	Insertable in the slot from above, flush with the cylinder profile	Magneto-resistive	SMT-8M	10 ... 30 V DC	PNP/NPN	N/O contact N/C contact	164
		Magnetic reed	SME-8M	5 ... 30 V AC/DC	Contacting	N/O contact	165
For C-slot	Insertable in the slot from above, flush with the cylinder profile	Magneto-resistive	SMT-10M	10 ... 30 V DC	PNP	N/O contact	168
		Magnetic reed	SME-10M	5 ... 30 V AC/DC	Contacting, bipolar	N/O contact	169

Contents			
Sensors for T-slot		Sensors for C-slot	
- SMT-8M	→ 164	- SMT-10M	→ 168
- SME-8M	→ 165	- SME-10M	→ 169
- Accessories	→ 166	- Accessories	→ 170

# Proximity Sensors SMT-8M, for T-slot

Technical Data – Magneto-resistive

FESTO

## Technical Data – SMT-8M

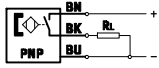

e.g. N/O contact, PNP, with cable

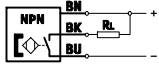

e.g. N/O contact, NPN, with cable

Materials  
Housing: Polyamide  
Cable sheath: Polyurethane

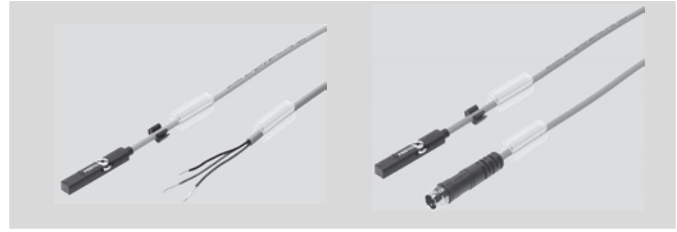

## Technical Data

Type of mounting	Screwed in slot, insertable from above, flush with cylinder profile	
Electrical connection	Cable, 3-wire	Cable with plug, turnable, M8x1, 3-pin
Cable length [m]	0.2 ... 30	
Cable attribute	Standard + Drag chain	
Test conditions	Standard + Drag Chain	
	Drag chain: 5 million cycles, bending radius 75 mm	
	Resistance to bending: To Festo standard; test conditions on request	
Operating voltage range DC [V]	10 ... 30	
Max. output current [mA]	100	
Max. switching capacity DC [W]	3.0	
Protection against short circuit	Pulsed	
Protection against overloading	Yes	
Protection against polarity reversal	For all electrical connections	
Protection class	IP65, IP68	

## Operating and Environmental Conditions

Ambient temperature [°C]	-20 ... +70	
Ambient temperature with flexible cable installation [°C]	-5 ... +70	
CE mark (see declaration of conformity)	In accordance with EU EMC directive	
Certification	c UL us - Listed (OL)	
	C-Tick	

## Materials

Housing	Polyamide; polyurethane; high-alloy stainless steel
Cable sheath	Polyurethane

## Ordering Data

	Switch output	Electrical connection		Cable length [m]	Part No.	Type	LT	
		Cable	Cable with plug, turnable M8x1					
	N/O contact	PNP	3-wire	–	2.5	543867	SMT-8M-PS-24V-K-2,5-OE	1D
			–	3-pin	0.3	543866	SMT-8M-PS-24V-K-0,3-M8D	1D
	NPN	3-wire	–	2.5	543870	SMT-8M-NS-24V-K-2,5-OE	1D	
		–	3-pin	0.3	543871	SMT-8M-NS-24V-K-0,3-M8D	1D	

LT = Lead time

1D typically ships same day/next day

3D typically ships within 3 days

# Proximity Sensors SME-8M, for T-slot

Technical Data – Magnetic reed

FESTO

Technical Data – SME-8M	
<p>e.g. N/O contact, 3-wire, with cable</p> <p>e.g. N/O contact, 3-wire, with plug</p>	<p>Materials Housing: Polyamide Cable sheath: Polyurethane</p>

Technical Data	
Type of mounting	Screwed in slot, insertable from above, flush with cylinder profile
Electrical connection	Cable, 3-wire <span style="float: right;">Cable with plug, turnable, M8x1, 3-pin</span>
Cable length [m]	0.2 ... 10
Cable attribute	Standard + Drag chain
Test conditions	Standard + Drag Chain
	Drag chain: 5 million cycles, bending radius 75 mm
	Resistance to bending: To Festo standard; test conditions on request
Operating voltage range DC [V]	5 ... 30
Operating voltage range AC [V]	5 ... 30
Max. output current [mA]	500
Max. output current in mounting kits [mA]	80
Max. switching capacity DC [W]	10.0
Max. switching capacity AC [VA]	10.0
Max. switching capacity DC in mounting kits [W]	2.4
Max. switching capacity AC in mounting kits [VA]	2.4
Protection against short circuit	No
Protection against overloading	Not available
Protection against polarity reversal	No
Protection class	IP65, IP68

Operating and Environmental Conditions	
Ambient temperature [°C]	-20 ... +70
Ambient temperature with flexible cable installation [°C]	-5 ... +70
CE mark (see declaration of conformity)	In accordance with EU EMC directive
Certification	c UL us - Listed (OL) C-Tick

Materials	
Housing	Polyamide; polyurethane; high-alloy stainless steel
Cable sheath	Polyurethane

Ordering Data							
	Switch output	Electrical connection		Cable length [m]	Part No.	Type	LT
		Cable	Cable with plug, turnable M8x1				
	N/O contact						
	Contacting, bipolar	3-wire	-	2.5	543862	SME-8M-DS-24V-K-2,5-OE	1D
		-	3-pin	0.3	543861	SME-8M-DS-24V-K-0,3-M8D	1D

LT = Lead time      1D typically ships same day/next day      3D typically ships within 3 days

# Proximity Sensors SMT/SME-8, for T-slot

Peripherals Overview

FESTO

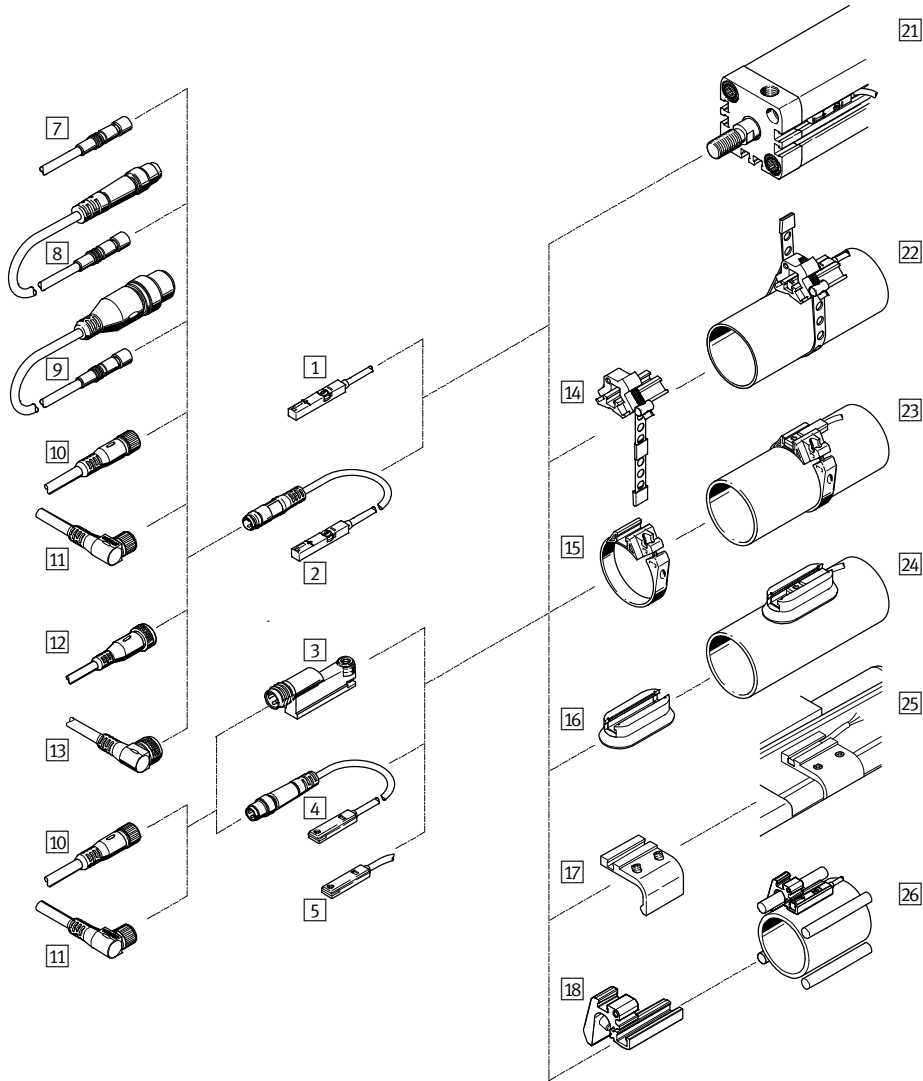

Mounting Attachments and Accessories	
Proximity sensors	
1	SMT/SME-8M-...-OE, with cable
2	SMT/SME-8M-...-M..., with cable and plug
3	SMT/SME-8-SL-..., with plug
4	SMT/SME-8-S-..., with cable and plug
5	SMT/SME-8-K-..., with cable CRSMT-8-K-..., with cable, corrosion-resistant
Connecting cables	
7	NEBU-M5...-5-Q3-LE3
8	NEBU-M5...-1-Q3-M8G3
9	NEBU-M5...-1-Q3-M12G4
10	NEBU-M8G3, SIM-M8-3GD
11	NEBU-M8W3, SIM-M8-3WD
12	NEBU-M12G5, SIM-M12-3GD
13	NEBU-M12W5, SIM-M12-3WD

Mounting Attachments and Accessories	
Mounting kits and accessories	
14	Mounting kit SMBR-8-8/100-S6, heat-resistant
15	Mounting kit SMBR
16	Mounting kit CRSMB, corrosion-resistant
17	Mounting kit SMB-8-FENG
18	Mounting SMBZ-8-... - Clip SMBK-8
Drive units	
21	Drives with T-slot
22	Round cylinders
23	Round cylinders
24	Round cylinders
25	Standard cylinders DNC, DNCB, DNCCE
26	Drives with tie or mounting rod

# Proximity Sensors SMT/SME-8, for T-slot

Accessories



Ordering Data – Connecting Cables				Technical data → Internet: nebu	
	Number of wires	Cable length [m]	Part No.	Type	
M8x1, straight socket					
	3	2.5	541333	NEBU-M8G3-K-2.5-LE3	
	4	2.5	541342	NEBU-M8G4-K-2.5-LE4	

Ordering Data – Mounting Attachments				Technical data → Internet: smbr	
	For Ø	Part No.	Type		
	8	175091	SMBR-8-8		
	10	175092	SMBR-8-10		
	12	175093	SMBR-8-12		
	16	175094	SMBR-8-16		
	20	175095	SMBR-8-20		
	25	175096	SMBR-8-25		

Lead Time LT for all products on this page: **1D** typically ships same day/next day