



Sealtite HFX black:

Robust, halogen-free, very flexible, good flame properties and superior chemical resistant.

Sealtite HFX is a very flexible conduit designed for use in dynamic applications where frequent and erratic movement can take place. During movement and torque stress, the conduit retains its flexibility and integrity even at low operating temperatures, when other conduit's tend to stiffen. The conduit's halogen free, thermoplastic cover displays excellent flame properties and resistance to chemicals. As such, HFX meets the stringent requirements of the rail and subway infrastructure, train signaling, train and metro building, marine, petrochemical and chemical industries as well as the stringent requirements of closed areas like airports, tunnels and subway stations.

Material & Construction:

Construction: Galvanised steel core, square-locked with cord packing, thick smooth thermoplastic cover (Polyurethane). Size 1/4" and from 1.1/2" a fully inter-locked profile is used.

Cover specifications: Polyurethane, lead-free according to RoHS, sunlight and UV resistant, suitable for outside installation. The cover is resistant against oil and grease.
Temperature: -55 °C to +105 °C, intermittent up to +125 °C.
Colour: Black.

Classification according to NEN-EN-IEC 61386:

Compression resistance: Class 4, Heavy (1250 N).
Impact resistance: Class 4, Heavy (6 J).
Tensile strength: Class 4, Heavy (1000 N).
Protection class: IP 67 (dust-proof, water-tight).

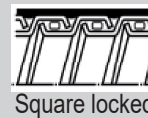

| Sealtite Size (Inch) | Diameter (mm) | | Bending radius (mm) | | Standard carton | | Small carton | | Reels | | Weight (Kg/m) |
|----------------------|---------------|---------|---------------------|---------|-----------------|-------------|--------------|-------------|-------|-------------|---------------|
| | Inside | Outside | Static | Dynamic | Metre | Article No. | Metre | Article No. | Metre | Article No. | |
| 1/4" | 6,4 | 11,5 | 40 | 50 | 30 | 331.006.1 | - | - | - | - | 0,2 |
| 5/16" | 10,1 | 14,4 | 50 | 65 | 30 | 331.010.1 | 10 | 331.010.3 | 250 | 331.010.5 | 0,2 |
| 3/8" | 12,6 | 17,8 | 60 | 85 | 30 | 331.012.1 | 10 | 331.012.3 | 250 | 331.012.5 | 0,3 |
| 1/2" | 16,0 | 21,1 | 75 | 110 | 30 | 331.016.1 | 10 | 331.016.3 | 150 | 331.016.5 | 0,4 |
| 3/4" | 21,0 | 26,4 | 90 | 140 | 30 | 331.020.1 | 10 | 331.020.3 | 120 | 331.020.5 | 0,6 |
| 1" | 26,5 | 33,1 | 120 | 170 | 30 | 331.026.1 | 10 | 331.026.3 | 90 | 331.026.5 | 0,8 |
| 1.1/4" | 35,1 | 41,8 | 135 | 215 | 15 | 331.035.1 | - | - | 60 | 331.035.5 | 1,1 |
| 1.1/2" | 40,3 | 47,8 | 165 | 250 | 15 | 331.040.1 | - | - | - | - | 1,5 |
| 2" | 51,6 | 59,9 | 210 | 300 | 15 | 331.050.1 | - | - | - | - | 2,0 |

* Also available with stainless steel innercore (see chapter 4, type HFI).

The fittings for Sealtite are outlined in chapter 5 (pages 1 till 29).



| Size Sealtite | Inch | 1/4" | 5/16" | 3/8" | 1/2" | 3/4" | 1" | 1 1/4" | 1 1/2" | 2" | 2 1/2" | 3" | 4" |
|---------------|------|---------|---------|-----------|------|------|-----|--------|--------|-----|--------|-----|------|
| Fittings | ISO | M12-M16 | M16-M20 | M16-M20 | M20 | M25 | M32 | M40 | M50 | M63 | M75 | M90 | M105 |
| | PG | 7 | 9 - 11 | 11 - 13,5 | 16 | 21 | 29 | 36 | 42 | 48 | - | - | - |
| | NPT | - | - | 1/2" | 1/2" | 3/4" | 1" | 1 1/4" | 1 1/2" | 2" | 2 1/2" | 3" | 4" |



Anaconda compact fittings, UL & CSA, nickel plated brass, for Anaconda Sealrite.

The compact version nickel plated brass Anaconda fittings can be used with all types of Anaconda Sealrite (except CNP). This Anaconda fitting is a universal fitting with shorter design and lower weight. All ferrules are flanged versions for a better fit. The high quality nickel plating offers excellent corrosion protection in combination with a nice appearance. The compact fittings have UL & CSA approval.

Construction: Nickel plated brass fitting, consisting of 4 parts (counter nut, clamping ring, ferrule and body).

Material: Counter nut and body are nickel plated brass. Clamping ring is made from PA6 and the ferrule is made



from galvanised steel. The O-rings are from NBR rubber (black for ISO and blue for Pg).

Special approvals: UL-514B and CSA C 22.2 (combined UL/CSA file # E 234207).

Suitable for use in hazardous environments according NEC:

- Article 501.10 (B) (2) Class I, Division 2
- Article 502.10 (A) (2) and (B) (2) Class II, Division 1 and 2
- Article 503.10 (A) (3) and (B) Class III, Division 1 and 2

Temperature: -45 °C till +105 °C continuous

Protection class: IP 67 (dust-proof, water-tight)

Colour: Metal

ISO straight fitting, compact, male, nickel plated brass.

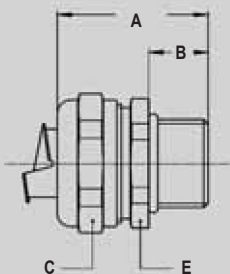

| Thread | Sealrite Size (inch) | Min. Internal Bore (mm) | Dimensions in mm | | | | | Standard Package | Article Number | Weight (Kg/100) |
|-----------|----------------------|-------------------------|------------------|----|----|---|----|------------------|----------------|-----------------|
| | | | A | B | C | D | E | | | |
| M16 x 1,5 | 3/8" | 11,0 | 31 | 10 | 26 | - | 24 | 10 | 712.016.1 | 3,9 |
| M20 x 1,5 | 3/8" | 11,0 | 31 | 10 | 26 | - | 24 | 10 | 712.017.1 | 4,0 |
| M20 x 1,5 | 1/2" | 14,5 | 32 | 10 | 29 | - | 27 | 10 | 712.020.1 | 4,4 |
| M25 x 1,5 | 3/4" | 19,4 | 33 | 10 | 35 | - | 33 | 5 | 712.025.1 | 6,6 |
| M32 x 1,5 | 1" | 24,7 | 36 | 12 | 45 | - | 42 | 5 | 712.032.1 | 11,7 |
| M40 x 1,5 | 1.1/4" | 33,3 | 40 | 13 | 53 | - | 50 | 2 | 712.040.1 | 16,0 |
| M50 x 1,5 | 1.1/2" | 38,0 | 46 | 14 | 62 | - | 58 | 2 | 712.050.1 | 25,3 |
| M63 x 1,5 | 2" | 49,0 | 52 | 16 | 76 | - | 72 | 2 | 712.063.1 | 38,6 |

ISO 45° fitting, compact, male, nickel plated brass.

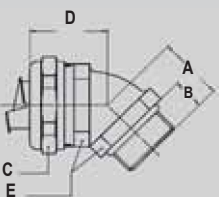

| Thread | Sealrite Size (inch) | Min. Internal Bore (mm) | Dimensions in mm | | | | | Standard Package | Article Number | Weight (Kg/100) |
|-----------|----------------------|-------------------------|------------------|----|----|----|----|------------------|----------------|-----------------|
| | | | A | B | C | D | E | | | |
| M16 x 1,5 | 3/8" | 11,0 | 19 | 10 | 26 | 27 | 22 | 10 | 712.416.1 | 6,3 |
| M20 x 1,5 | 3/8" | 11,0 | 20 | 10 | 26 | 28 | 24 | 10 | 712.417.1 | 7,2 |
| M20 x 1,5 | 1/2" | 14,5 | 21 | 10 | 29 | 30 | 27 | 10 | 712.420.1 | 8,3 |
| M25 x 1,5 | 3/4" | 19,4 | 23 | 10 | 35 | 33 | 33 | 5 | 712.425.1 | 12,8 |
| M32 x 1,5 | 1" | 24,7 | 28 | 12 | 45 | 38 | 42 | 5 | 712.432.1 | 22,5 |

ISO 90° fitting, compact, male, nickel plated brass.



| Thread | Sealtite Size (inch) | Min. Internal Bore (mm) | Dimensions in mm | | | | | Standard Package | Article Number | Weight (Kg/100) |
|-----------|----------------------|-------------------------|------------------|----|----|----|----|------------------|----------------|-----------------|
| | | | A | B | C | D | E | | | |
| M16 x 1,5 | 3/8" | 11,0 | 26 | 10 | 26 | 31 | 22 | 10 | 712.916.1 | 6,6 |
| M20 x 1,5 | 3/8" | 11,0 | 26 | 10 | 26 | 32 | 24 | 10 | 712.917.1 | 7,9 |
| M20 x 1,5 | 1/2" | 14,5 | 28 | 10 | 29 | 34 | 27 | 10 | 712.920.1 | 9,2 |
| M25 x 1,5 | 3/4" | 19,4 | 32 | 10 | 35 | 40 | 33 | 5 | 712.925.1 | 16,2 |
| M32 x 1,5 | 1" | 24,7 | 40 | 12 | 45 | 49 | 42 | 5 | 712.932.1 | 27,8 |
| M40 x 1,5 | 1.1/4" | 33,3 | 46 | 13 | 53 | 53 | 52 | 2 | 712.940.1 | 40,1 |
| M50 x 1,5 | 1.1/2" | 38,0 | 52 | 14 | 62 | 57 | 60 | 2 | 712.950.1 | 57,5 |
| M63 x 1,5 | 2" | 49,0 | 62 | 16 | 76 | 68 | 72 | 2 | 712.963.1 | 90,6 |

Pg straight fitting, compact, male, nickel plated brass.

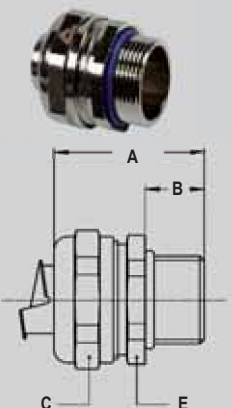

| Thread Pg | Sealtite Size (inch) | Min. Internal Bore (mm) | Dimensions in mm | | | | | Standard Package | Article Number | Weight (Kg/100) |
|-----------|----------------------|-------------------------|------------------|----|----|---|----|------------------|----------------|-----------------|
| | | | A | B | C | D | E | | | |
| Pg 11 | 3/8" | 11,0 | 31 | 10 | 26 | - | 24 | 10 | 710.011.1 | 4,0 |
| Pg 13,5 | 3/8" | 11,0 | 31 | 10 | 26 | - | 24 | 10 | 710.013.1 | 4,2 |
| Pg 16 | 1/2" | 14,5 | 32 | 10 | 29 | - | 27 | 10 | 710.016.1 | 4,5 |
| Pg 21 | 3/4" | 19,4 | 33 | 10 | 35 | - | 33 | 5 | 710.021.1 | 6,5 |
| Pg 29 | 1" | 24,7 | 36 | 12 | 45 | - | 44 | 5 | 710.029.1 | 12,2 |
| Pg 36 | 1.1/4" | 33,3 | 40 | 13 | 53 | - | 52 | 2 | 710.036.1 | 16,4 |
| Pg 42 | 1.1/2" | 38,0 | 46 | 14 | 62 | - | 60 | 2 | 710.042.1 | 26,3 |
| Pg 48 | 2" | 49,0 | 52 | 16 | 76 | - | 72 | 2 | 710.048.1 | 38,6 |

Pg 90° fitting, compact, male, nickel plated brass.



| Thread Pg | Sealtite Size (inch) | Min. Internal Bore (mm) | Dimensions in mm | | | | | Standard Package | Article Number | Weight (Kg/100) |
|-----------|----------------------|-------------------------|------------------|----|----|----|----|------------------|----------------|-----------------|
| | | | A | B | C | D | E | | | |
| Pg 11 | 3/8" | 11,0 | 26 | 10 | 26 | 32 | 24 | 10 | 710.911.1 | 7,7 |
| Pg 13,5 | 3/8" | 11,0 | 26 | 10 | 26 | 32 | 24 | 10 | 710.913.1 | 8,0 |
| Pg 16 | 1/2" | 14,5 | 28 | 10 | 29 | 34 | 27 | 10 | 710.916.1 | 9,2 |
| Pg 21 | 3/4" | 19,4 | 32 | 10 | 35 | 40 | 33 | 5 | 710.921.1 | 15,7 |
| Pg 29 | 1" | 24,7 | 40 | 12 | 45 | 49 | 42 | 5 | 710.929.1 | 28,6 |
| Pg 36 | 1.1/4" | 33,3 | 46 | 13 | 53 | 53 | 52 | 2 | 710.936.1 | 40,1 |
| Pg 42 | 1.1/2" | 38,0 | 52 | 14 | 62 | 57 | 60 | 2 | 710.942.1 | 57,5 |
| Pg 48 | 2" | 49,0 | 62 | 16 | 76 | 68 | 72 | 2 | 710.948.1 | 92,1 |

NPT straight fitting, compact, male, nickel plated brass.

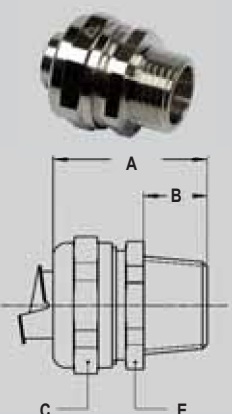

| Thread NPT | Sealtite Size (inch) | Min. Internal Bore (mm) | Dimensions in mm | | | | | Standard Package | Article Number | Weight (Kg/100) |
|------------|----------------------|-------------------------|------------------|----|----|---|----|------------------|----------------|-----------------|
| | | | A | B | C | D | E | | | |
| NPT 1/2" | 3/8" | 11,0 | 35 | 14 | 26 | - | 24 | 10 | 714.012.1 | 4,4 |
| NPT 1/2" | 1/2" | 14,5 | 36 | 14 | 29 | - | 27 | 10 | 714.016.1 | 5,0 |
| NPT 3/4" | 3/4" | 19,4 | 37 | 14 | 35 | - | 33 | 5 | 714.020.1 | 7,0 |
| NPT 1" | 1" | 24,7 | 40 | 16 | 45 | - | 42 | 5 | 714.026.1 | 12,6 |
| NPT 1.1/4" | 1.1/4" | 33,3 | 43 | 16 | 53 | - | 50 | 2 | 714.035.1 | 16,8 |
| NPT 1.1/2" | 1.1/2" | 38,0 | 50 | 18 | 62 | - | 58 | 2 | 714.040.1 | 25,8 |
| NPT 2" | 2" | 49,0 | 56 | 20 | 76 | - | 72 | 2 | 714.050.1 | 41,2 |

ANACONDA
COMPACT
FITTINGS

LIQUID-TIGHT
FITTINGS FOR
SEALTITE
IP 67

NPT 45° fitting, compact, male, nickel plated brass.

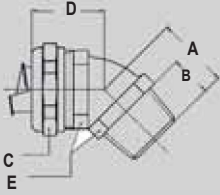

| Thread | Sealtite Size (inch) | Min. Internal Bore (mm) | Dimensions in mm | | | | | Standard Package | Article Number | Weight (Kg/100) |
|----------|----------------------|-------------------------|------------------|----|----|----|----|------------------|----------------|-----------------|
| | | | A | B | C | D | E | | | |
| NPT 1/2" | 3/8" | 11,0 | 24 | 14 | 26 | 28 | 24 | 10 | 714.912.1 | 7,7 |
| NPT 1/2" | 1/2" | 14,5 | 25 | 14 | 29 | 30 | 27 | 10 | 714.916.1 | 8,8 |
| NPT 3/4" | 3/4" | 19,4 | 27 | 14 | 35 | 33 | 33 | 5 | 714.920.1 | 14,5 |
| NPT 1" | 1" | 24,7 | 32 | 16 | 45 | 38 | 42 | 5 | 714.926.1 | 24,0 |

NPT 90° fitting, compact, male, nickel plated brass.

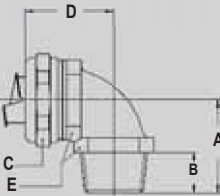

| Thread | Sealtite Size (inch) | Min. Internal Bore (mm) | Dimensions in mm | | | | | Standard Package | Article Number | Weight (Kg/100) |
|------------|----------------------|-------------------------|------------------|----|----|----|----|------------------|----------------|-----------------|
| | | | A | B | C | D | E | | | |
| NPT 1/2" | 3/8" | 11,0 | 30 | 14 | 26 | 32 | 24 | 10 | 714.912.1 | 8,2 |
| NPT 1/2" | 1/2" | 14,5 | 32 | 14 | 29 | 34 | 27 | 10 | 714.916.1 | 9,6 |
| NPT 3/4" | 3/4" | 19,4 | 36 | 14 | 35 | 40 | 33 | 5 | 714.920.1 | 16,7 |
| NPT 1" | 1" | 24,7 | 44 | 16 | 45 | 49 | 42 | 5 | 714.926.1 | 28,3 |
| NPT 1.1/4" | 1.1/4" | 33,3 | 49 | 16 | 53 | 53 | 52 | 2 | 714.935.1 | 41,4 |
| NPT 1.1/2" | 1.1/2" | 38,0 | 56 | 18 | 62 | 57 | 60 | 2 | 714.940.1 | 57,3 |
| NPT 2" | 2" | 49,0 | 66 | 20 | 76 | 68 | 72 | 2 | 714.950.1 | 90,8 |

NPT straight fitting, compact, male, nickel plated brass, including washer and locknut

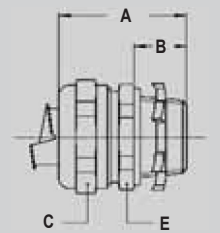

| Thread | Sealtite Size (inch) | Min. Internal Bore (mm) | Dimensions in mm | | | | | Standard Package | Article Number | Weight (Kg/100) |
|------------|----------------------|-------------------------|------------------|----|----|---|----|------------------|----------------|-----------------|
| | | | A | B | C | D | E | | | |
| NPT 1/2" | 3/8" | 11,0 | 35 | 14 | 26 | - | 24 | 10 | 714.012.2 | 4,9 |
| NPT 1/2" | 1/2" | 14,5 | 36 | 14 | 29 | - | 27 | 10 | 714.016.2 | 5,5 |
| NPT 3/4" | 3/4" | 19,4 | 37 | 14 | 35 | - | 33 | 5 | 714.020.2 | 7,8 |
| NPT 1" | 1" | 24,7 | 40 | 16 | 45 | - | 42 | 5 | 714.026.2 | 13,9 |
| NPT 1.1/4" | 1.1/4" | 33,3 | 43 | 16 | 53 | - | 50 | 2 | 714.035.2 | 18,6 |
| NPT 1.1/2" | 1.1/2" | 38,0 | 50 | 18 | 62 | - | 58 | 2 | 714.040.2 | 28,0 |
| NPT 2" | 2" | 49,0 | 56 | 20 | 76 | - | 72 | 2 | 714.050.2 | 44,0 |

NPT 90° fitting, compact, male, nickel plated brass, including washer and locknut

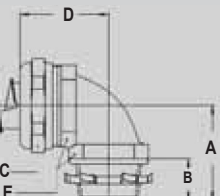

| Thread | Sealtite Size (inch) | Min. Internal Bore (mm) | Dimensions in mm | | | | | Standard Package | Article Number | Weight (Kg/100) |
|------------|----------------------|-------------------------|------------------|----|----|----|----|------------------|----------------|-----------------|
| | | | A | B | C | D | E | | | |
| NPT 1/2" | 3/8" | 11,0 | 30 | 14 | 26 | 32 | 24 | 10 | 714.912.2 | 8,7 |
| NPT 1/2" | 1/2" | 14,5 | 32 | 14 | 29 | 34 | 27 | 10 | 714.916.2 | 10,1 |
| NPT 3/4" | 3/4" | 19,4 | 36 | 14 | 35 | 40 | 33 | 5 | 714.920.2 | 16,6 |
| NPT 1" | 1" | 24,7 | 44 | 16 | 45 | 49 | 42 | 5 | 714.926.2 | 29,6 |
| NPT 1.1/4" | 1.1/4" | 33,3 | 49 | 16 | 53 | 53 | 52 | 2 | 714.935.2 | 43,2 |
| NPT 1.1/2" | 1.1/2" | 38,0 | 56 | 18 | 62 | 57 | 60 | 2 | 714.940.2 | 59,5 |
| NPT 2" | 2" | 49,0 | 66 | 20 | 76 | 68 | 72 | 2 | 714.950.2 | 93,6 |



Anaconda swivel fittings, nickel plated brass, for Anaconda Sealbite.

The swivel version nickel plated brass Anaconda fittings can be used with all types of Anaconda Sealbite (except CNP). This Anaconda fitting is a universal fitting with a special swivel mechanism for a higher tensile strength and a high water proof protection (IP67). All ferrules are turned nickel plated brass versions for a better fit. The high quality nickel plating offers excellent corrosion protection in combination with a nice appearance.



Construction: Nickel plated brass fitting, consisting of 4 parts (counter nut, clamping ring, ferrule and body).

Material: Counter nut and body are nickel plated brass. Clamping ring is made from PA6 and the ferrule is made from nickel plated brass. The O-rings are from NBR rubber (black for ISO).

Temperature: -45 °C till +105 °C continuous

Protection class: IP 67

Colour: Metal

ANACONDA COMPACT FITTINGS

LIQUID-TIGHT FITTINGS FOR SEALBITE IP 67

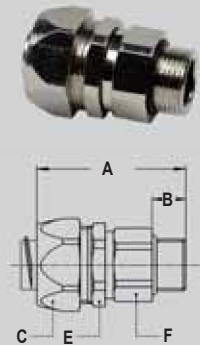

ISO straight swivel fitting, male, nickel plated brass



| Thread | Sealtite Size (inch) | Min. Internal Bore (mm) | Dimensions in mm | | | | | | Standard Package | Article Number | Weight (Kg/100) |
|-----------|-------------------------|----------------------------|------------------|----|----|----|----|----|---------------------|-------------------|--------------------|
| | | | A | B | C | E | F | | | | |
| M16 x 1,5 | 5/16" | 8,3 | 48 | 10 | 26 | 24 | 21 | 10 | 813.015.0 | 8,1 | |
| M16 x 1,5 | 3/8" | 10,4 | 48 | 10 | 26 | 24 | 21 | 10 | 813.016.0 | 8,1 | |
| M20 x 1,5 | 1/2" | 13,8 | 49 | 10 | 29 | 27 | 25 | 10 | 813.020.0 | 10,2 | |
| M25 x 1,5 | 3/4" | 17,4 | 49 | 10 | 35 | 33 | 31 | 5 | 813.025.0 | 13,8 | |
| M32 x 1,5 | 1" | 23,4 | 55 | 12 | 45 | 42 | 38 | 5 | 813.032.0 | 32,5 | |
| M40 x 1,5 | 1.1/4" | 29,4 | 58 | 14 | 54 | 50 | 48 | 2 | 813.040.0 | 53,0 | |
| M50 x 1,5 | 1.1/2" | 36,9 | 65 | 14 | 62 | 58 | 55 | 2 | 813.050.0 | 74,0 | |
| M63 x 1,5 | 2" | 47,9 | 74 | 16 | 76 | 72 | 68 | 2 | 813.063.0 | 130,0 | |

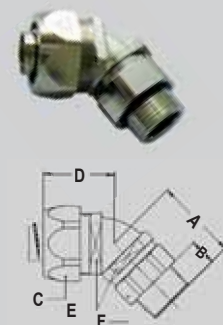

ISO 45° swivel fitting, male, nickel plated brass.



| Thread | Sealtite Size (inch) | Min. Internal Bore (mm) | Dimensions in mm | | | | | | Standard Package | Article Number | Weight (Kg/100) |
|-----------|-------------------------|----------------------------|------------------|----|----|----|----|----|---------------------|-------------------|--------------------|
| | | | A | B | C | D | E | F | | | |
| M16 x 1,5 | 3/8" | 10,4 | 34 | 10 | 26 | 28 | 22 | 21 | 10 | 813.416.0 | 9,5 |
| M20 x 1,5 | 1/2" | 13,8 | 34 | 10 | 29 | 30 | 27 | 25 | 10 | 813.420.0 | 13,5 |
| M25 x 1,5 | 3/4" | 17,4 | 37 | 10 | 35 | 32 | 33 | 31 | 5 | 813.425.0 | 21,5 |
| M32 x 1,5 | 1" | 23,4 | 41 | 12 | 45 | 37 | 42 | 38 | 5 | 813.432.0 | 36,5 |

ISO 90° swivel fitting, male, nickel plated brass

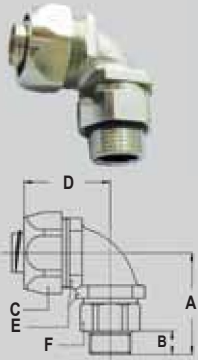

| Thread | Sealtite Size (inch) | Min. Internal Bore (mm) | Dimensions in mm | | | | | | Standard Package | Article Number | Weight (Kg/100) |
|-----------|-------------------------|----------------------------|------------------|----|----|----|----|----|---------------------|-------------------|--------------------|
| | | | A | B | C | D | E | F | | | |
| M16 x 1,5 | 5/16" | 8,3 | 39 | 10 | 26 | 35 | 22 | 21 | 10 | 813.915.0 | 10,8 |
| M16 x 1,5 | 3/8" | 10,4 | 39 | 10 | 26 | 35 | 22 | 21 | 10 | 813.916.0 | 10,8 |
| M20 x 1,5 | 1/2" | 13,8 | 39 | 10 | 29 | 37 | 27 | 25 | 10 | 813.920.0 | 13,2 |
| M25 x 1,5 | 3/4" | 17,4 | 46 | 10 | 35 | 44 | 33 | 31 | 5 | 813.925.0 | 22,8 |
| M32 x 1,5 | 1" | 23,4 | 55 | 12 | 45 | 55 | 42 | 38 | 5 | 813.932.0 | 41,4 |

NPT 45° swivel fitting, male, nickel plated brass

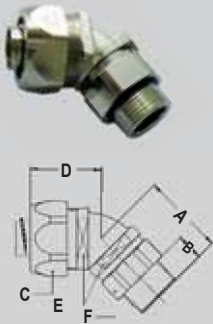

| Thread | Sealtite Size (inch) | Min. Internal Bore (mm) | Dimensions in mm | | | | | | Standard Package | Article Number | Weight (Kg/100) |
|----------|-------------------------|----------------------------|------------------|----|----|----|----|----|---------------------|-------------------|--------------------|
| | | | A | B | C | D | E | F | | | |
| NPT 1/2" | 3/8" | 10,4 | 36 | 12 | 26 | 28 | 22 | 22 | 10 | 819.412.0 | 11,5 |
| NPT 1/2" | 1/2" | 13,8 | 36 | 12 | 29 | 30 | 27 | 25 | 10 | 819.416.0 | 14,0 |
| NPT 3/4" | 3/4" | 17,4 | 39 | 12 | 35 | 32 | 33 | 31 | 5 | 819.420.0 | 22,0 |
| NPT 1" | 1" | 23,4 | 42 | 13 | 45 | 37 | 42 | 38 | 5 | 819.426.0 | 37,0 |

NPT 90° swivel fitting, male, nickel plated brass

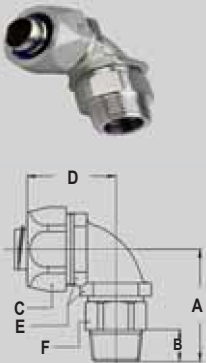

| Thread | Sealtite Size (inch) | Min. Internal Bore (mm) | Dimensions in mm | | | | | | Standard Package | Article Number | Weight (Kg/100) |
|----------|-------------------------|----------------------------|------------------|----|----|----|----|----|---------------------|-------------------|--------------------|
| | | | A | B | C | D | E | F | | | |
| NPT 1/2" | 3/8" | 10,4 | 41 | 12 | 26 | 35 | 22 | 22 | 10 | 819.912.0 | 12,0 |
| NPT 1/2" | 1/2" | 13,8 | 41 | 12 | 29 | 37 | 27 | 25 | 10 | 819.916.0 | 14,0 |
| NPT 3/4" | 3/4" | 17,4 | 48 | 12 | 35 | 44 | 33 | 31 | 5 | 819.920.0 | 23,5 |
| NPT 1" | 1" | 23,4 | 56 | 13 | 45 | 55 | 42 | 38 | 5 | 819.926.0 | 42,0 |

**ANACONDA
COMPACT
FITTINGS**

**LIQUID-TIGHT
FITTINGS FOR
SEALTITE
IP 67**



Anaconda nickel plated brass fittings for Anaconda Sealbite.

The nickel plated brass Anaconda fittings can be used with all types of Anaconda Sealbite (except CNP). This Anaconda fitting is the most used universal fitting and offers great corrosion protection in combination with a nice appearance. Because of the UL & CSA approvals the fittings are also suitable for export projects outside Europe.

Construction: Nickel plated brass fitting, consisting of 4 parts (counter nut, clamping ring, ferrule and body).

Material: Counter nut, body and ferrule are nickel plated brass with exception of size 3/8" till 1" where the ferrule is from galvanised steel. Clamping ring and inserts are made

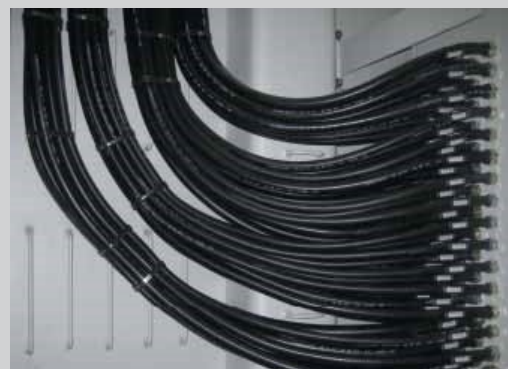

from PA6 (red for ISO metric, blue for Pg and white for NPT).
Special approvals: UL-514B and CSA C 22.2 (combined UL/CSA file # E 234207).

Suitable for use in hazardous environments according NEC:

- Article 501.10 (B) (2) Class I, Division 2
- Article 502.10 (A) (2) and (B) (2) Class II, Division 1 and 2
- Article 503.10 (A) (3) and (B) Class III, Division 1 and 2

Temperature: -45 °C till +105 °C continuous (cable-hose-fittings are -40 °C till +100 °C).

Protection class: IP 67 (dust-proof, water-tight), with cable-hose fittings an IP 68 rate on the switchbox can be obtained. Swivel fittings are limited to IP 65. **Colour:** Metal.

ANACONDA FITTINGS

LIQUID-TIGHT FITTINGS FOR SEALTITE IP 67



ISO straight fitting, male, nickel plated brass.

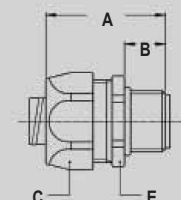

| Thread | Sealtite Size (inch) | Min. Internal Bore (mm) | Dimensions in mm | | | | | Standard Package | Article Number | Weight (Kg/100) |
|-----------|----------------------|-------------------------|------------------|----|----|---|----|------------------|----------------|-----------------|
| | | | A | B | C | D | E | | | |
| M12 x 1,5 | 1/4" | 5,2 | 33 | 10 | 22 | - | 20 | 10 | 812.012.1* | 4,8 |
| M16 x 1,5 | 5/16" | 8,3 | 35 | 12 | 26 | - | 24 | 10 | 812.015.1* | 4,8 |
| M20 x 1,5 | 5/16" | 8,3 | 36 | 13 | 26 | - | 24 | 10 | 812.014.1* | 5,1 |
| M16 x 1,5 | 3/8" | 10,2 | 35 | 12 | 26 | - | 24 | 10 | 812.016.1 | 4,8 |
| M20 x 1,5 | 3/8" | 10,2 | 36 | 13 | 26 | - | 24 | 10 | 812.017.1 | 5,1 |
| M20 x 1,5 | 1/2" | 13,9 | 37 | 13 | 29 | - | 27 | 10 | 812.020.1 | 5,9 |
| M25 x 1,5 | 3/4" | 18,5 | 40 | 15 | 35 | - | 33 | 5 | 812.025.1 | 7,9 |
| M32 x 1,5 | 1" | 23,8 | 46 | 15 | 45 | - | 43 | 5 | 812.032.1 | 17,5 |
| M40 x 1,5 | 1.1/4" | 31,8 | 52 | 16 | 54 | - | 52 | 2 | 812.040.1 | 27,9 |
| M50 x 1,5 | 1.1/2" | 36,8 | 56 | 18 | 63 | - | 60 | 2 | 812.050.1 | 42,3 |
| M63 x 1,5 | 2" | 47,8 | 66 | 20 | 77 | - | 74 | 2 | 812.063.1 | 73,5 |
| M75 x 1,5 | 2.1/2" | 59,0 | 72 | 24 | 95 | - | 90 | 1 | 812.075.1* | 134,4 |

* Fittings for 1/4", 5/16" and 2.1/2" conduit without UL/CSA approval.

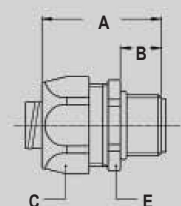

ISO straight fitting, small design, male, nickel plated brass.



| Thread | Sealtite Size (inch) | Min. Internal Bore (mm) | Dimensions in mm | | | | | Standard Package | Article Number | Weight (Kg/100) |
|-----------|----------------------|-------------------------|------------------|----|----|---|----|------------------|----------------|-----------------|
| | | | A | B | C | D | E | | | |
| M12 x 1,5 | 1/4" | 5,2 | 33 | 10 | 19 | - | 17 | 10 | 812.012.2 | 2,8 |
| M16 x 1,5 | 1/4" | 5,2 | 35 | 12 | 19 | - | 19 | 10 | 812.013.2 | 3,4 |
| M12 x 1,5 | 5/16" | 8,3 | 33 | 10 | 22 | - | 20 | 10 | 812.011.2 | 3,6 |
| M16 x 1,5 | 5/16" | 8,3 | 35 | 12 | 22 | - | 20 | 10 | 812.015.2 | 3,8 |
| M20 x 1,5 | 5/16" | 8,3 | 36 | 13 | 22 | - | 24 | 10 | 812.014.2 | 4,2 |

ISO straight fitting, female, nickel plated brass.

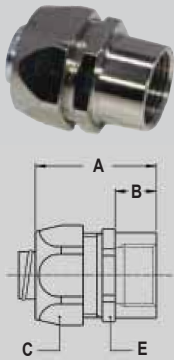

| Thread | Sealtite Size (inch) | Min. Internal Bore (mm) | Dimensions in mm | | | | | Standard Package | Article Number | Weight (Kg/100) |
|-----------|----------------------|-------------------------|------------------|----|----|---|----|------------------|----------------|-----------------|
| | | | A | B | C | D | E | | | |
| M16 x 1,5 | 5/16" | 8,3 | 35 | 12 | 26 | - | 24 | 10 | 812.315.1* | 5,0 |
| M16 x 1,5 | 3/8" | 10,2 | 35 | 12 | 26 | - | 24 | 10 | 812.316.1 | 5,0 |
| M20 x 1,5 | 1/2" | 13,9 | 37 | 13 | 29 | - | 27 | 10 | 812.320.1 | 7,6 |
| M25 x 1,5 | 3/4" | 18,5 | 40 | 15 | 35 | - | 33 | 5 | 812.325.1 | 9,0 |
| M32 x 1,5 | 1" | 23,8 | 46 | 15 | 45 | - | 43 | 5 | 812.332.1 | 18,3 |
| M40 x 1,5 | 1.1/4" | 31,8 | 52 | 16 | 54 | - | 52 | 2 | 812.340.1 | 29,3 |
| M50 x 1,5 | 1.1/2" | 36,8 | 56 | 18 | 63 | - | 60 | 2 | 812.350.1 | 41,2 |
| M63 x 1,5 | 2" | 47,8 | 66 | 20 | 77 | - | 74 | 2 | 812.363.1 | 71,8 |

* Fittings for 5/16" conduit without UL/CSA approval.

ISO 45° fitting, male, nickel plated brass.

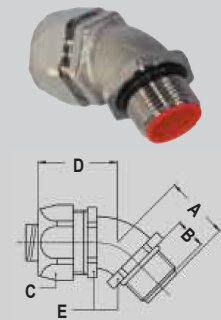

| Thread | Sealtite Size (inch) | Min. Internal Bore (mm) | Dimensions in mm | | | | | Standard Package | Article Number | Weight (Kg/100) |
|-----------|----------------------|-------------------------|------------------|----|----|----|----|------------------|----------------|-----------------|
| | | | A | B | C | D | E | | | |
| M16 x 1,5 | 5/16" | 8,3 | 23 | 12 | 26 | 33 | 22 | 10 | 812.415.1* | 7,3 |
| M20 x 1,5 | 5/16" | 8,3 | 24 | 13 | 26 | 33 | 22 | 10 | 812.414.1* | 7,4 |
| M16 x 1,5 | 3/8" | 10,2 | 23 | 12 | 26 | 33 | 22 | 10 | 812.416.1 | 7,3 |
| M20 x 1,5 | 3/8" | 10,2 | 24 | 13 | 26 | 33 | 22 | 10 | 812.417.1 | 7,4 |
| M20 x 1,5 | 1/2" | 13,9 | 25 | 13 | 29 | 33 | 27 | 10 | 812.420.1 | 10,5 |
| M25 x 1,5 | 3/4" | 18,5 | 30 | 15 | 35 | 36 | 33 | 5 | 812.425.1 | 13,6 |
| M32 x 1,5 | 1" | 23,8 | 34 | 15 | 45 | 46 | 42 | 5 | 812.432.1 | 26,5 |
| M40 x 1,5 | 1.1/4" | 31,8 | 39 | 16 | 54 | 54 | 51 | 2 | 812.440.1 | 44,9 |
| M50 x 1,5 | 1.1/2" | 36,8 | 45 | 18 | 63 | 59 | 60 | 2 | 812.450.1 | 67,5 |
| M63 x 1,5 | 2" | 47,8 | 53 | 20 | 77 | 71 | 74 | 2 | 812.463.1 | 128,0 |

* Fittings for 5/16" conduit without UL/CSA approval.

ISO 90° fitting, male, nickel plated brass.

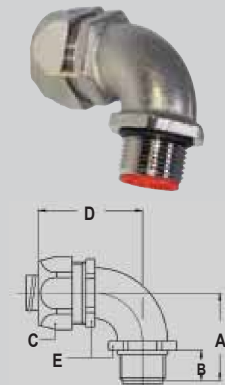

| Thread | Sealtite Size (inch) | Min. Internal Bore (mm) | Dimensions in mm | | | | | Standard Package | Article Number | Weight (Kg/100) |
|-----------|----------------------|-------------------------|------------------|----|----|----|----|------------------|----------------|-----------------|
| | | | A | B | C | D | E | | | |
| M16 x 1,5 | 5/16" | 8,3 | 32 | 12 | 26 | 42 | 22 | 10 | 812.915.1* | 8,2 |
| M20 x 1,5 | 5/16" | 8,3 | 33 | 13 | 26 | 42 | 22 | 10 | 812.914.1* | 8,4 |
| M16 x 1,5 | 3/8" | 10,2 | 32 | 12 | 26 | 42 | 22 | 10 | 812.916.1 | 8,2 |
| M20 x 1,5 | 3/8" | 10,2 | 33 | 13 | 26 | 42 | 22 | 10 | 812.917.1 | 8,4 |
| M20 x 1,5 | 1/2" | 13,9 | 36 | 13 | 29 | 43 | 27 | 10 | 812.920.1 | 12,6 |
| M25 x 1,5 | 3/4" | 18,5 | 43 | 15 | 35 | 48 | 33 | 5 | 812.925.1 | 19,2 |
| M32 x 1,5 | 1" | 23,8 | 48 | 15 | 45 | 59 | 42 | 5 | 812.932.1 | 31,6 |
| M40 x 1,5 | 1.1/4" | 31,8 | 57 | 16 | 54 | 68 | 51 | 2 | 812.940.1 | 56,1 |
| M50 x 1,5 | 1.1/2" | 36,8 | 63 | 18 | 63 | 78 | 60 | 2 | 812.950.1 | 85,3 |
| M63 x 1,5 | 2" | 47,8 | 74 | 20 | 77 | 96 | 74 | 2 | 812.963.1 | 139,8 |

* Fittings for 5/16" conduit without UL/CSA approval.

**ANACONDA
FITTINGS**

**LIQUID-TIGHT
FITTINGS FOR
SEALTITE
IP 67**

ISO cable-hose fitting, male, nickel plated brass.

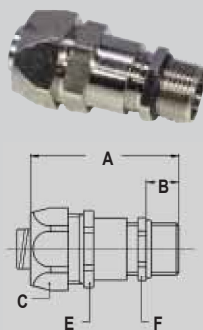

| Thread ISO | Sealtite Size (inch) | Clamping Range (mm) | Dimensions in mm | | | | | Standard Package | Article Number | Weight (Kg/100) |
|---------------|-------------------------|------------------------|------------------|----|----|----|----|---------------------|-------------------|--------------------|
| | | | A | B | C | E | F | | | |
| M16 x 1,5 | 5/16" | 4 - 8 | 57 | 12 | 26 | 24 | 18 | 10 | 812.715.2 | 5,2 |
| M16 x 1,5 | 3/8" | 4 - 8 | 57 | 12 | 26 | 24 | 18 | 10 | 812.716.1 | 7,8 |
| M20 x 1,5 | 3/8" | 6 - 10,2 | 57 | 12 | 26 | 24 | 22 | 10 | 812.717.1 | 9,5 |
| M20 x 1,5 | 1/2" | 6 - 12 | 59 | 12 | 29 | 27 | 22 | 10 | 812.720.1 | 9,7 |
| M25 x 1,5 | 1/2" | 10 - 13,9 | 62 | 12 | 29 | 27 | 27 | 10 | 812.722.1 | 11,7 |
| M32 x 1,5 | 3/4" | 13 - 18 | 70 | 15 | 35 | 33 | 34 | 5 | 812.728.1 | 20,2 |
| M40 x 1,5 | 1" | 18 - 23,5 | 83 | 15 | 45 | 43 | 43 | 2 | 812.735.1 | 32,6 |
| M40 x 1,5 | 1.1/4" | 22 - 31,5 | 96 | 15 | 54 | 52 | 43 | 2 | 812.740.1 | 46,0 |
| M50 x 1,5 | 1.1/4" | 22 - 31,8 | 96 | 15 | 54 | 52 | 55 | 2 | 812.745.1 | 60,0 |

ISO, EMC cable-hose fitting, male, nickel plated brass.

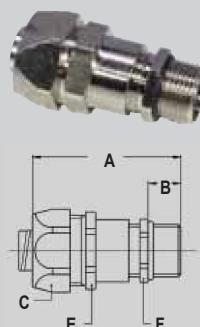

| Thread ISO | Sealtite Size (inch) | Clamping Range (mm) | Dimensions in mm | | | | | Standard Package | Article Number | Weight (Kg/100) |
|---------------|-------------------------|------------------------|------------------|----|----|----|----|---------------------|-------------------|--------------------|
| | | | A | B | C | E | F | | | |
| M16 x 1,5 | 5/16" | 4 - 8 | 57 | 12 | 26 | 24 | 18 | 10 | 812.615.2 | 5,2 |
| M16 x 1,5 | 3/8" | 4 - 8 | 57 | 12 | 26 | 24 | 18 | 10 | 812.616.1 | 7,8 |
| M20 x 1,5 | 3/8" | 6 - 10,2 | 57 | 12 | 26 | 24 | 22 | 10 | 812.617.1 | 9,5 |
| M20 x 1,5 | 1/2" | 6 - 12 | 59 | 12 | 29 | 27 | 22 | 10 | 812.620.1 | 9,7 |
| M25 x 1,5 | 1/2" | 10 - 13,9 | 62 | 12 | 29 | 27 | 27 | 5 | 812.622.1 | 11,7 |
| M32 x 1,5 | 3/4" | 13 - 18 | 70 | 15 | 35 | 33 | 34 | 5 | 812.628.1 | 19,6 |
| M40 x 1,5 | 1" | 18 - 23,8 | 83 | 15 | 45 | 43 | 43 | 2 | 812.635.1 | 35,4 |

ISO cable-hose fitting, with extended clamping range, male, nickel plated brass.

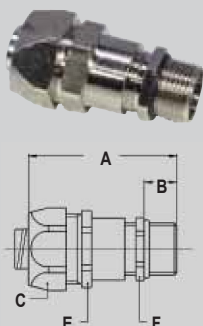

| Thread ISO | Sealtite Size (inch) | Clamping Range (mm) | Dimensions in mm | | | | | Standard Package | Article Number | Weight (Kg/100) |
|---------------|-------------------------|------------------------|------------------|----|----|----|----|---------------------|-------------------|--------------------|
| | | | A | B | C | E | F | | | |
| M16 x 1,5 | 3/8" | 3 - 10,2 | 64 | 12 | 26 | 24 | 20 | 10 | 812.716.2 | 8,2 |
| M20 x 1,5 | 1/2" | 7 - 13,9 | 64 | 12 | 29 | 27 | 24 | 10 | 812.720.2 | 10,2 |
| M25 x 1,5 | 3/4" | 9 - 18,0 | 77 | 15 | 35 | 33 | 30 | 5 | 812.725.2 | 17,0 |
| M32 x 1,5 | 1" | 13 - 23,8 | 88 | 15 | 45 | 43 | 40 | 5 | 812.732.2 | 31,0 |
| M40 x 1,5 | 1.1/4" | 20 - 31,8 | 102 | 15 | 54 | 52 | 50 | 2 | 812.740.2 | 54,6 |
| M50 x 1,5 | 1.1/2" | 21 - 36,8 | 106 | 18 | 63 | 60 | 58 | 2 | 812.750.2 | 76,6 |
| M63 x 1,5 | 2" | 27 - 44,0 | 116 | 18 | 77 | 74 | 68 | 2 | 812.763.2 | 116,6 |

Multiple seals for cable hose fittings with extended range.



| Thread ISO | Sealtite Size (inch) | number of holes x diam. (mm) | Dimensions in mm | | | | | Standard Package | Article Number | Weight (Kg/100) |
|---------------|-------------------------|------------------------------------|------------------|---|---|---|---|---------------------|-------------------|--------------------|
| | | | A | B | C | E | F | | | |
| M20 x 1,5 | 1/2" | 3 x 4,0 | - | - | - | - | - | 100 | 785.234.0 | - |
| M20 x 1,5 | 1/2" | 3 x 5,0 | - | - | - | - | - | 100 | 785.235.0 | - |
| M20 x 1,5 | 1/2" | 4 x 3,0 | - | - | - | - | - | 100 | 785.243.0 | - |
| M20 x 1,5 | 1/2" | 4 x 4,0 | - | - | - | - | - | 100 | 785.244.0 | - |
| M25 x 1,5 | 3/4" | 2 x 7,0 | - | - | - | - | - | 100 | 785.327.0 | - |
| M25 x 1,5 | 3/4" | 3 x 6,6 | - | - | - | - | - | 100 | 785.336.6 | - |
| M25 x 1,5 | 3/4" | 3 x 8,0 | - | - | - | - | - | 100 | 785.338.0 | - |
| M32 x 1,5 | 1" | 3 x 7,5 | - | - | - | - | - | 100 | 785.437.5 | - |
| M32 x 1,5 | 1" | 4 x 8,0 | - | - | - | - | - | 100 | 785.448.0 | - |
| M32 x 1,5 | 1" | 6 x 5,0 | - | - | - | - | - | 100 | 785.465.0 | - |
| M32 x 1,5 | 1" | 6 x 6,0 | - | - | - | - | - | 100 | 785.466.0 | - |

* Other (not mentioned types) are available on request. The multiple seals will be delivered separately.

ANACONDA
FITTINGS

LIQUID-TIGHT
FITTINGS FOR
SEALTITE
IP 67

Pg straight fitting, male, nickel plated brass.

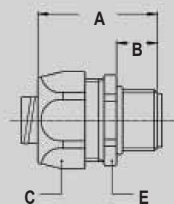

| Thread | Sealtite Size (inch) | Min. Internal Bore (mm) | Dimensions in mm | | | | | Standard Package | Article Number | Weight (Kg/100) |
|---------|----------------------|-------------------------|------------------|----|----|---|----|------------------|----------------|-----------------|
| | | | A | B | C | D | E | | | |
| Pg 7 | 1/4" | 5,2 | 33 | 10 | 22 | - | 20 | 10 | 810.007.1* | 3,0 |
| Pg 9 | 5/16" | 8,3 | 35 | 12 | 26 | - | 24 | 10 | 810.009.1* | 4,8 |
| Pg 11 | 5/16" | 8,3 | 35 | 12 | 26 | - | 24 | 10 | 810.012.1* | 5,6 |
| Pg 13,5 | 5/16" | 8,3 | 35 | 12 | 26 | - | 24 | 10 | 810.014.1* | 5,6 |
| Pg 9 | 3/8" | 10,2 | 35 | 12 | 26 | - | 24 | 10 | 810.010.1 | 4,8 |
| Pg 11 | 3/8" | 10,2 | 35 | 12 | 26 | - | 24 | 10 | 810.011.1 | 5,6 |
| Pg 13,5 | 3/8" | 10,2 | 35 | 12 | 26 | - | 24 | 10 | 810.013.1 | 5,6 |
| Pg 16 | 1/2" | 13,9 | 37 | 13 | 29 | - | 27 | 10 | 810.016.1 | 6,3 |
| Pg 21 | 3/4" | 18,5 | 40 | 15 | 35 | - | 33 | 5 | 810.021.1 | 8,4 |
| Pg 29 | 1" | 23,8 | 46 | 15 | 45 | - | 43 | 5 | 810.029.1 | 25,0 |
| Pg 36 | 1.1/4" | 31,8 | 52 | 16 | 54 | - | 52 | 2 | 810.036.1 | 34,6 |
| Pg 42 | 1.1/2" | 36,8 | 56 | 18 | 63 | - | 60 | 2 | 810.042.1 | 47,2 |
| Pg 48 | 2" | 47,8 | 66 | 20 | 77 | - | 74 | 2 | 810.048.1 | 72,0 |

* Fittings for 1/4" and 5/16" conduit without UL/CSA approval.

Pg straight fitting, small design, male, nickel plated brass.

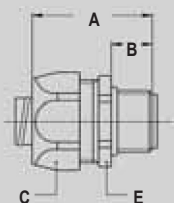

| Thread | Sealtite Size (inch) | Min. Internal Bore (mm) | Dimensions in mm | | | | | Standard Package | Article Number | Weight (Kg/100) |
|--------|----------------------|-------------------------|------------------|----|----|---|----|------------------|----------------|-----------------|
| | | | A | B | C | D | E | | | |
| Pg 7 | 1/4" | 5,2 | 33 | 10 | 19 | - | 17 | 10 | 810.007.2 | 2,8 |
| Pg 9 | 5/16" | 8,3 | 35 | 12 | 22 | - | 20 | 10 | 810.009.2 | 3,8 |

Pg straight fitting, female, nickel plated brass.

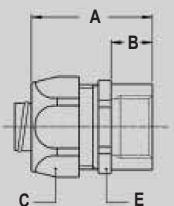

| Thread | Sealtite Size (inch) | Min. Internal Bore (mm) | Dimensions in mm | | | | | Standard Package | Article Number | Weight (Kg/100) |
|---------|----------------------|-------------------------|------------------|----|----|---|----|------------------|----------------|-----------------|
| | | | A | B | C | D | E | | | |
| Pg 11 | 5/16" | 8,3 | 35 | 12 | 26 | - | 24 | 10 | 810.312.1* | 5,3 |
| Pg 13,5 | 5/16" | 8,3 | 35 | 12 | 26 | - | 24 | 10 | 810.314.1* | 5,3 |
| Pg 11 | 3/8" | 10,2 | 35 | 12 | 26 | - | 24 | 10 | 810.311.1 | 5,3 |
| Pg 13,5 | 3/8" | 10,2 | 35 | 12 | 26 | - | 24 | 10 | 810.313.1 | 5,3 |
| Pg 16 | 1/2" | 13,9 | 37 | 13 | 29 | - | 27 | 10 | 810.316.1 | 6,3 |
| Pg 21 | 3/4" | 18,5 | 40 | 15 | 35 | - | 33 | 5 | 810.321.1 | 9,3 |
| Pg 29 | 1" | 23,8 | 46 | 15 | 45 | - | 43 | 5 | 810.329.1 | 20,7 |
| Pg 36 | 1.1/4" | 31,8 | 52 | 16 | 54 | - | 52 | 2 | 810.336.1 | 29,3 |
| Pg 42 | 1.1/2" | 36,8 | 56 | 18 | 63 | - | 60 | 2 | 810.342.1 | 43,2 |
| Pg 48 | 2" | 47,8 | 66 | 20 | 77 | - | 74 | 2 | 810.348.1 | 74,8 |

* Fittings for 5/16" conduit without UL/CSA approval.

ANACONDA FITTINGS

LIQUID-TIGHT FITTINGS FOR SEALTITE IP 67

ANACONDA FITTINGS

LIQUID-TIGHT FITTINGS FOR SEALTITE IP 67

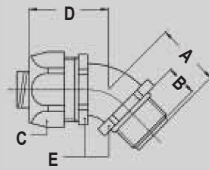

Pg 45° fitting, male, nickel plated brass.



| Thread | Sealtite Size (inch) | Min. Internal Bore (mm) | Dimensions in mm | | | | | Standard Package | Article Number | Weight (Kg/100) |
|---------|----------------------|-------------------------|------------------|----|----|----|----|------------------|----------------|-----------------|
| | | | A | B | C | D | E | | | |
| Pg 11 | 5/16" | 8,3 | 23 | 12 | 26 | 33 | 22 | 10 | 810.412.1* | 8,1 |
| Pg 13,5 | 5/16" | 8,3 | 23 | 12 | 26 | 33 | 22 | 10 | 810.414.1* | 8,1 |
| Pg 11 | 3/8" | 10,2 | 23 | 12 | 26 | 33 | 22 | 10 | 810.411.1 | 8,1 |
| Pg 13,5 | 3/8" | 10,2 | 23 | 12 | 26 | 33 | 22 | 10 | 810.413.1 | 8,1 |
| Pg 16 | 1/2" | 13,9 | 25 | 13 | 29 | 33 | 27 | 10 | 810.416.1 | 11,6 |
| Pg 21 | 3/4" | 18,5 | 30 | 15 | 35 | 36 | 33 | 5 | 810.421.1 | 15,3 |
| Pg 29 | 1" | 23,8 | 34 | 15 | 45 | 46 | 42 | 5 | 810.429.1 | 31,5 |
| Pg 36 | 1.1/4" | 31,8 | 39 | 16 | 54 | 54 | 51 | 2 | 810.436.1 | 53,2 |
| Pg 42 | 1.1/2" | 36,8 | 45 | 18 | 63 | 59 | 60 | 2 | 810.442.1 | 78,5 |
| Pg 48 | 2" | 47,8 | 53 | 20 | 77 | 71 | 74 | 2 | 810.448.1 | 132,0 |

* Fittings for 5/16" conduit without UL/CSA approval.

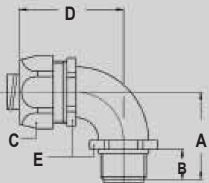

Pg 90° fitting, male, nickel plated brass.



| Thread | Sealtite Size (inch) | Min. Internal Bore (mm) | Dimensions in mm | | | | | Standard Package | Article Number | Weight (Kg/100) |
|---------|----------------------|-------------------------|------------------|----|----|----|----|------------------|----------------|-----------------|
| | | | A | B | C | D | E | | | |
| Pg 11 | 5/16" | 8,3 | 32 | 12 | 26 | 42 | 22 | 10 | 810.912.1* | 8,9 |
| Pg 13,5 | 5/16" | 8,3 | 32 | 12 | 26 | 42 | 22 | 10 | 810.914.1* | 8,9 |
| Pg 11 | 3/8" | 10,2 | 32 | 12 | 26 | 42 | 22 | 10 | 810.911.1 | 8,9 |
| Pg 13,5 | 3/8" | 10,2 | 32 | 12 | 26 | 42 | 22 | 10 | 810.913.1 | 8,9 |
| Pg 16 | 1/2" | 13,9 | 36 | 13 | 29 | 43 | 27 | 10 | 810.916.1 | 15,3 |
| Pg 21 | 3/4" | 18,5 | 43 | 15 | 35 | 48 | 33 | 5 | 810.921.1 | 21,6 |
| Pg 29 | 1" | 23,8 | 48 | 15 | 45 | 59 | 42 | 5 | 810.929.1 | 35,3 |
| Pg 36 | 1.1/4" | 31,8 | 57 | 16 | 54 | 68 | 51 | 2 | 810.936.1 | 62,5 |
| Pg 42 | 1.1/2" | 36,8 | 63 | 18 | 63 | 78 | 60 | 2 | 810.942.1 | 88,1 |
| Pg 48 | 2" | 47,8 | 74 | 20 | 77 | 96 | 74 | 2 | 810.948.1 | 141,9 |

* Fittings for 5/16" conduit without UL/CSA approval.

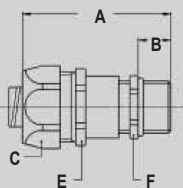

Pg cable-hose fitting, male, nickel plated brass.



| Thread | Sealtite Size (inch) | Clamping Range (mm) | Dimensions in mm | | | | | Standard Package | Article Number | Weight (Kg/100) |
|---------|----------------------|---------------------|------------------|----|----|----|----|------------------|----------------|-----------------|
| | | | A | B | C | E | F | | | |
| Pg 9 | 5/16" | 4 - 8 | 55 | 10 | 26 | 24 | 17 | 10 | 810.709.1 | 7,8 |
| Pg 9 | 3/8" | 5 - 8 | 55 | 10 | 26 | 24 | 20 | 10 | 810.712.1 | 7,8 |
| Pg 11 | 3/8" | 5 - 10 | 55 | 10 | 26 | 24 | 20 | 10 | 810.711.1 | 9,5 |
| Pg 13,5 | 1/2" | 6 - 12 | 57 | 10 | 29 | 27 | 22 | 10 | 810.715.1 | 9,7 |
| Pg 16 | 1/2" | 10 - 13,9 | 60 | 10 | 29 | 27 | 24 | 10 | 810.716.1 | 11,7 |
| Pg 21 | 3/4" | 13 - 18 | 67 | 12 | 35 | 33 | 30 | 5 | 810.721.1 | 19,6 |
| Pg 29 | 1" | 18 - 23,8 | 80 | 12 | 45 | 43 | 40 | 5 | 810.729.1 | 35,4 |

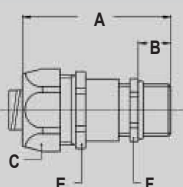

Pg, EMC cable-hose fitting, male, nickel plated brass.



| Thread | Sealtite Size (inch) | Clamping Range (mm) | Dimensions in mm | | | | | Standard Package | Article Number | Weight (Kg/100) |
|---------|----------------------|---------------------|------------------|----|----|----|----|------------------|----------------|-----------------|
| | | | A | B | C | E | F | | | |
| Pg 9 | 5/16" | 4 - 8 | 55 | 10 | 26 | 24 | 17 | 10 | 810.609.1 | 7,8 |
| Pg 9 | 3/8" | 5 - 8 | 55 | 10 | 26 | 24 | 20 | 10 | 810.612.1 | 7,8 |
| Pg 11 | 3/8" | 5 - 10 | 55 | 10 | 26 | 24 | 20 | 10 | 810.611.1 | 9,5 |
| Pg 13,5 | 1/2" | 6 - 12 | 57 | 10 | 29 | 27 | 22 | 10 | 810.615.1 | 9,7 |
| Pg 16 | 1/2" | 10 - 13,9 | 60 | 10 | 29 | 27 | 24 | 10 | 810.616.1 | 11,7 |
| Pg 21 | 3/4" | 13 - 18 | 67 | 12 | 35 | 33 | 30 | 5 | 810.621.1 | 19,6 |
| Pg 29 | 1" | 18 - 23,8 | 80 | 12 | 45 | 43 | 40 | 5 | 810.629.1 | 35,4 |



NPT straight fitting, male, nickel plated brass.

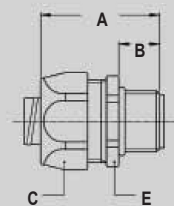

| Thread NPT | Sealtite Size (inch) | Min. Internal Bore (mm) | Dimensions in mm | | | | | Standard Package | Article Number | Weight (Kg/100) |
|---------------|-------------------------|----------------------------|------------------|----|----|---|----|---------------------|-------------------|--------------------|
| | | | A | B | C | D | E | | | |
| 1/2" NPT | 5/16" | 8,3 | 35 | 12 | 26 | - | 24 | 10 | 814.011.1* | 5,6 |
| 1/2" NPT | 3/8" | 10,2 | 35 | 12 | 26 | - | 24 | 10 | 814.012.1 | 5,6 |
| 1/2" NPT | 1/2" | 13,9 | 37 | 13 | 29 | - | 27 | 10 | 814.016.1 | 6,2 |
| 3/4" NPT | 3/4" | 18,5 | 40 | 15 | 35 | - | 33 | 5 | 814.020.1 | 8,9 |
| 1" NPT | 1" | 23,8 | 46 | 15 | 45 | - | 43 | 5 | 814.026.1 | 25,0 |
| 1.1/4" NPT | 1.1/4" | 31,8 | 52 | 16 | 54 | - | 52 | 2 | 814.035.1 | 40,0 |
| 1.1/2" NPT | 1.1/2" | 36,8 | 56 | 18 | 63 | - | 60 | 2 | 814.040.1 | 43,8 |
| 2" NPT | 2" | 47,8 | 66 | 20 | 77 | - | 74 | 2 | 814.050.1 | 73,5 |

* Fittings for 1/4" and 5/16" conduit without UL/CSA approval.



NPT 45° fitting, male, nickel plated brass.

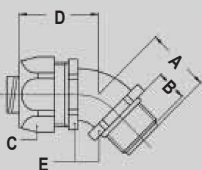

| Thread NPT | Sealtite Size (inch) | Min. Internal Bore (mm) | Dimensions in mm | | | | | Standard Package | Article Number | Weight (Kg/100) |
|---------------|-------------------------|----------------------------|------------------|----|----|----|----|---------------------|-------------------|--------------------|
| | | | A | B | C | D | E | | | |
| 1/2" NPT | 5/16" | 8,3 | 23 | 12 | 26 | 33 | 22 | 10 | 814.411.1* | 7,9 |
| 1/2" NPT | 3/8" | 10,2 | 23 | 12 | 26 | 33 | 22 | 10 | 814.412.1 | 7,9 |
| 1/2" NPT | 1/2" | 13,9 | 25 | 13 | 29 | 33 | 27 | 10 | 814.416.1 | 10,7 |
| 3/4" NPT | 3/4" | 18,5 | 30 | 15 | 35 | 36 | 33 | 5 | 814.420.1 | 15,7 |
| 1" NPT | 1" | 23,8 | 34 | 15 | 45 | 46 | 42 | 5 | 814.426.1 | 31,8 |
| 1.1/4" NPT | 1.1/4" | 31,8 | 39 | 16 | 54 | 54 | 51 | 2 | 814.435.1 | 54,2 |
| 1.1/2" NPT | 1.1/2" | 36,8 | 45 | 18 | 63 | 59 | 60 | 2 | 814.440.1 | 78,5 |
| 2" NPT | 2" | 47,8 | 53 | 20 | 77 | 71 | 74 | 2 | 814.450.1 | 132,0 |

* Fittings for 5/16" conduit without UL/CSA approval.



NPT 90° fitting, male, nickel plated brass.

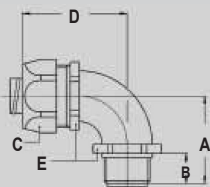

| Thread NPT | Sealtite Size (inch) | Min. Internal Bore (mm) | Dimensions in mm | | | | | Standard Package | Article Number | Weight (Kg/100) |
|---------------|-------------------------|----------------------------|------------------|----|----|----|----|---------------------|-------------------|--------------------|
| | | | A | B | C | D | E | | | |
| 1/2" NPT | 5/16" | 8,3 | 32 | 12 | 26 | 42 | 22 | 10 | 814.911.1* | 13,3 |
| 1/2" NPT | 3/8" | 10,2 | 32 | 12 | 26 | 42 | 22 | 10 | 814.912.1 | 13,3 |
| 1/2" NPT | 1/2" | 13,9 | 36 | 13 | 29 | 43 | 27 | 10 | 814.916.1 | 14,6 |
| 3/4" NPT | 3/4" | 18,5 | 43 | 15 | 35 | 48 | 33 | 5 | 814.920.1 | 22,0 |
| 1" NPT | 1" | 23,8 | 48 | 15 | 45 | 59 | 42 | 5 | 814.926.1 | 31,7 |
| 1.1/4" NPT | 1.1/4" | 31,8 | 57 | 16 | 54 | 68 | 51 | 2 | 814.935.1 | 62,5 |
| 1.1/2" NPT | 1.1/2" | 36,8 | 63 | 18 | 63 | 78 | 60 | 2 | 814.940.1 | 89,1 |
| 2" NPT | 2" | 47,8 | 74 | 20 | 77 | 96 | 74 | 2 | 814.950.1 | 141,9 |

* Fittings for 5/16" conduit without UL/CSA approval.



NPT cable-hose fitting, male, nickel plated brass.

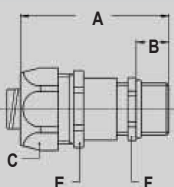

| Thread NPT | Sealtite Size (inch) | Clamping Range (mm) | Dimensions in mm | | | | | Standard Package | Article Number | Weight (Kg/100) |
|---------------|-------------------------|------------------------|------------------|----|----|----|----|---------------------|-------------------|--------------------|
| | | | A | B | C | E | F | | | |
| 3/8" NPT | 5/16" | 4 - 8 | 60 | 15 | 26 | 24 | 17 | 10 | 814.709.1 | 7,8 |
| 3/8" NPT | 3/8" | 4 - 8 | 60 | 15 | 26 | 24 | 17 | 10 | 814.710.1 | 7,8 |
| 1/2" NPT | 3/8" | 6 - 10,2 | 57 | 13 | 26 | 24 | 22 | 10 | 814.712.1 | 11,7 |
| 1/2" NPT | 1/2" | 6 - 12 | 59 | 13 | 29 | 27 | 22 | 10 | 814.715.1 | 11,7 |
| 3/4" NPT | 3/4" | 13 - 18 | 68 | 13 | 35 | 33 | 30 | 5 | 814.721.1 | 19,6 |

NPT straight fitting, female, nickel plated brass.

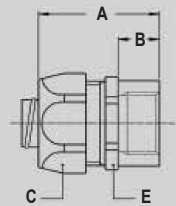

| Thread | Sealtite Size (inch) | Min. Internal Bore (mm) | Dimensions in mm | | | | | Standard Package | Article Number | Weight (Kg/100) |
|------------|-------------------------|----------------------------|------------------|----|----|---|----|---------------------|-------------------|--------------------|
| | | | A | B | C | D | E | | | |
| 1/2" NPT | 5/16" | 8,3 | 37 | 13 | 26 | - | 24 | 10 | 814.311.1* | 5,3 |
| 1/2" NPT | 3/8" | 10,2 | 37 | 13 | 26 | - | 24 | 10 | 814.312.1 | 5,3 |
| 1/2" NPT | 1/2" | 13,9 | 37 | 13 | 29 | - | 27 | 10 | 814.316.1 | 6,2 |
| 3/4" NPT | 3/4" | 18,5 | 40 | 15 | 35 | - | 33 | 5 | 814.320.1 | 9,0 |
| 1" NPT | 1" | 23,8 | 46 | 15 | 45 | - | 43 | 5 | 814.326.1 | 20,7 |
| 1.1/4" NPT | 1.1/4" | 31,8 | 52 | 16 | 54 | - | 52 | 2 | 814.335.1 | 29,3 |
| 1.1/2" NPT | 1.1/2" | 36,8 | 56 | 18 | 63 | - | 60 | 2 | 814.340.1 | 43,8 |
| 2" NPT | 2" | 47,8 | 66 | 20 | 77 | - | 74 | 2 | 814.350.1 | 73,3 |

* Fittings for 5/16" conduit without UL/CSA approval.

Grounding ferrule, nickel plated brass.



| Thread | Sealtite Size (inch) | Min. Internal Bore (mm) | Dimensions in mm | | | | | Standard Package | Article Number | Weight (Kg/100) |
|--------|-------------------------|----------------------------|------------------|---|---|---|---|---------------------|-------------------|--------------------|
| | | | A | B | C | D | E | | | |
| - | 1/4" | 5,2 | - | - | - | - | - | 10 | 815.006.0 | 0,4 |
| - | 5/16" | 8,3 | - | - | - | - | - | 10 | 815.010.0 | 0,8 |
| - | 3/8" | 10,2 | - | - | - | - | - | 10 | 815.011.3 | 0,6 |
| - | 1/2" | 13,9 | - | - | - | - | - | 10 | 815.016.3 | 0,8 |
| - | 3/4" | 18,5 | - | - | - | - | - | 5 | 815.021.3 | 1,4 |
| - | 1" | 23,8 | - | - | - | - | - | 5 | 815.029.3 | 2,8 |
| - | 1.1/4" | 31,8 | - | - | - | - | - | 2 | 815.036.3 | 6,0 |
| - | 1.1/2" | 36,8 | - | - | - | - | - | 2 | 815.042.3 | 6,8 |
| - | 2" | 47,8 | - | - | - | - | - | 2 | 815.048.3 | 8,8 |

Grounding ferrule, zinc plated steel.



| Thread | Sealtite Size (inch) | Min. Internal Bore (mm) | Dimensions in mm | | | | | Standard Package | Article Number | Weight (Kg/100) |
|--------|-------------------------|----------------------------|------------------|---|---|---|---|---------------------|-------------------|--------------------|
| | | | A | B | C | D | E | | | |
| - | 3/8" | 10,2 | - | - | - | - | - | 10 | 815.011.0 | 0,4 |
| - | 1/2" | 13,9 | - | - | - | - | - | 10 | 815.016.0 | 0,6 |
| - | 3/4" | 18,5 | - | - | - | - | - | 5 | 815.021.0 | 0,8 |
| - | 1" | 23,8 | - | - | - | - | - | 5 | 815.029.0 | 1,4 |

Neoprene Sealing gasket for ISO



| Thread | Thread | Thread | Dimensions in mm | | | | | Standard Package | Article Number | Weight (Kg/100) |
|-----------|--------|--------|------------------|---|----|----|---|---------------------|-------------------|--------------------|
| | | | A | B | C | D | E | | | |
| M16 x 1,5 | - | - | 1,2 | - | 20 | 14 | - | 100 | 815.416.0 | 0,03 |
| M20 x 1,5 | - | - | 1,2 | - | 24 | 18 | - | 100 | 815.420.0 | 0,03 |
| M25 x 1,5 | - | - | 1,2 | - | 30 | 23 | - | 50 | 815.425.0 | 0,05 |
| M32 x 1,5 | - | - | 1,2 | - | 40 | 30 | - | 50 | 815.432.0 | 0,11 |
| M40 x 1,5 | - | - | 1,2 | - | 48 | 38 | - | 50 | 815.440.0 | 0,15 |
| M50 x 1,5 | - | - | 1,2 | - | 58 | 48 | - | 50 | 815.450.0 | 0,19 |
| M63 x 1,5 | - | - | 1,2 | - | 75 | 61 | - | 50 | 815.463.0 | 0,33 |

ANACONDA
FITTINGS

ACCESSORIES



Anaconda compact fittings, UL & CSA, stainless steel AISI-304, for Anaconda Sealrite.

The compact version stainless steel Anaconda fittings can be used with all types of Anaconda Sealrite (except CNP). This Anaconda fitting is a universal fitting with shorter design and lower weight. All ferrules are flanged versions for a better fit. Because the fitting and ferrule are made from Stainless steel AISI-304 they offer an excellent corrosion protection in combination with a nice appearance. The compact fittings have UL & CSA approval.

Construction: Stainless steel AISI-304, consisting of 4 parts (counter nut, clamping ring, ferrule and body).

Material: Counter nut, body and ferrule are stainless steel

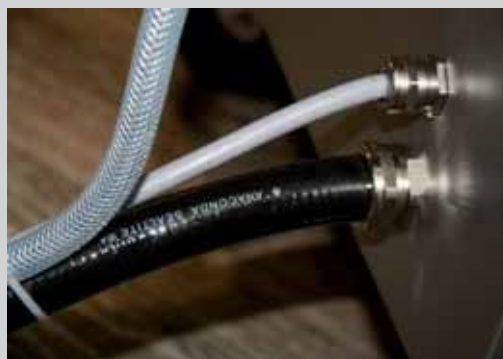

AISI-304. Clamping ring is made from PA6. The O-rings are from NBR rubber (black for ISO and blue for Pg).

Special approvals: UL-514B and CSA C 22.2 (combined UL/CSA file # E 234207).

Suitable for use in hazardous environments according NEC:

- Article 501.10 (B) (2) Class I, Division 2
- Article 502.10 (A) (2) and (B) (2) Class II, Division 1 and 2
- Article 503.10 (A) (3) and (B) Class III, Division 1 and 2

Temperature: -45 °C till +105 °C continuous

Protection class: IP 67 (dust-proof, water-tight)

Colour: Metal

ISO straight fitting, compact, stainless steel AISI-304

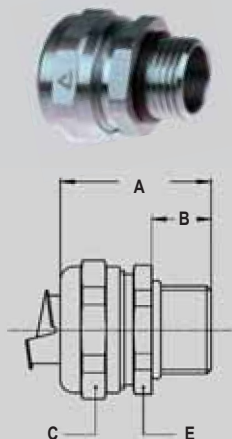

| Thread | Sealrite Size (inch) | Min. Internal Bore (mm) | Dimensions in mm | | | | | Standard Package | Article Number | Weight (Kg/100) |
|-----------|----------------------|-------------------------|------------------|----|----|---|----|------------------|----------------|-----------------|
| | | | A | B | C | D | E | | | |
| M16 x 1,5 | 3/8" | 11,0 | 31 | 10 | 26 | - | 24 | 10 | 712.016.9 | 3,9 |
| M20 x 1,5 | 3/8" | 11,0 | 31 | 10 | 26 | - | 24 | 10 | 712.017.9 | 4,0 |
| M20 x 1,5 | 1/2" | 14,5 | 32 | 10 | 29 | - | 27 | 10 | 712.020.9 | 4,4 |
| M25 x 1,5 | 3/4" | 19,4 | 33 | 10 | 35 | - | 33 | 5 | 712.025.9 | 6,6 |
| M32 x 1,5 | 1" | 24,7 | 36 | 12 | 45 | - | 42 | 5 | 712.032.9 | 11,7 |
| M40 x 1,5 | 1.1/4" | 33,3 | 40 | 13 | 53 | - | 50 | 2 | 712.040.9 | 16,0 |
| M50 x 1,5 | 1.1/2" | 38,0 | 46 | 14 | 62 | - | 58 | 2 | 712.050.9 | 25,3 |
| M63 x 1,5 | 2" | 49,0 | 52 | 16 | 76 | - | 72 | 2 | 712.063.9 | 38,6 |

ISO 90° fitting, compact, male, stainless steel AISI-304



| Thread | Sealrite Size (inch) | Min. Internal Bore (mm) | Dimensions in mm | | | | | Standard Package | Article Number | Weight (Kg/100) |
|-----------|----------------------|-------------------------|------------------|----|----|----|----|------------------|----------------|-----------------|
| | | | A | B | C | D | E | | | |
| M16 x 1,5 | 3/8" | 11,0 | 26 | 10 | 26 | 31 | 22 | 10 | 712.916.9 | 6,6 |
| M20 x 1,5 | 3/8" | 11,0 | 26 | 10 | 26 | 32 | 24 | 10 | 712.917.9 | 7,9 |
| M20 x 1,5 | 1/2" | 14,5 | 28 | 10 | 29 | 34 | 27 | 10 | 712.920.9 | 9,2 |
| M25 x 1,5 | 3/4" | 19,4 | 32 | 10 | 35 | 40 | 33 | 5 | 712.925.9 | 16,2 |
| M32 x 1,5 | 1" | 24,7 | 40 | 12 | 45 | 49 | 42 | 5 | 712.932.9 | 27,8 |
| M40 x 1,5 | 1.1/4" | 33,3 | 46 | 13 | 53 | 53 | 52 | 2 | 712.940.9 | 40,1 |
| M50 x 1,5 | 1.1/2" | 38,0 | 52 | 14 | 62 | 57 | 60 | 2 | 712.950.9 | 57,5 |
| M63 x 1,5 | 2" | 49,0 | 62 | 16 | 76 | 68 | 72 | 2 | 712.963.9 | 90,6 |

**NPT straight fitting, compact, male,
stainless steel AISI-304**

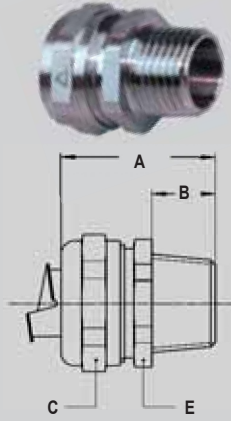

| Thread NPT | Sealtite Size (inch) | Min. Internal Bore (mm) | Dimensions in mm | | | | | Standard Package | Article Number | Weight (Kg/100) |
|---------------|-------------------------|----------------------------|------------------|----|----|---|----|---------------------|-------------------|--------------------|
| | | | A | B | C | D | E | | | |
| NPT 1/2" | 3/8" | 11,0 | 35 | 14 | 26 | - | 24 | 10 | 714.012.9 | 4,4 |
| NPT 1/2" | 1/2" | 14,5 | 36 | 14 | 29 | - | 27 | 10 | 714.016.9 | 5,0 |
| NPT 3/4" | 3/4" | 19,4 | 37 | 14 | 35 | - | 33 | 5 | 714.020.9 | 7,0 |
| NPT 1" | 1" | 24,7 | 40 | 16 | 45 | - | 42 | 5 | 714.026.9 | 12,6 |
| NPT 1.1/4" | 1.1/4" | 33,3 | 43 | 16 | 53 | - | 50 | 2 | 714.035.9 | 16,8 |
| NPT 1.1/2" | 1.1/2" | 38,0 | 50 | 18 | 62 | - | 58 | 2 | 714.040.9 | 25,8 |
| NPT 2" | 2" | 49,0 | 56 | 20 | 76 | - | 72 | 2 | 714.050.9 | 41,2 |

**NPT 90° fitting, compact, male, stainless
steel AISI-304.**

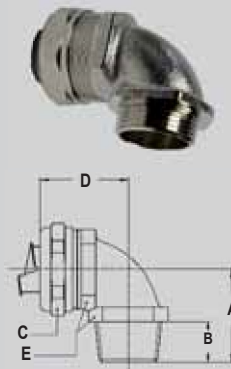

| Thread NPT | Sealtite Size (inch) | Min. Internal Bore (mm) | Dimensions in mm | | | | | Standard Package | Article Number | Weight (Kg/100) |
|---------------|-------------------------|----------------------------|------------------|----|----|----|----|---------------------|-------------------|--------------------|
| | | | A | B | C | D | E | | | |
| NPT 1/2" | 3/8" | 11,0 | 30 | 14 | 26 | 32 | 24 | 10 | 714.912.9 | 8,2 |
| NPT 1/2" | 1/2" | 14,5 | 32 | 14 | 29 | 34 | 27 | 10 | 714.916.9 | 9,6 |
| NPT 3/4" | 3/4" | 19,4 | 36 | 14 | 35 | 40 | 33 | 5 | 714.920.9 | 16,7 |
| NPT 1" | 1" | 24,7 | 44 | 16 | 45 | 49 | 42 | 5 | 714.926.9 | 28,3 |
| NPT 1.1/4" | 1.1/4" | 33,3 | 49 | 16 | 53 | 53 | 52 | 2 | 714.935.9 | 41,4 |
| NPT 1.1/2" | 1.1/2" | 38,0 | 56 | 18 | 62 | 57 | 60 | 2 | 714.940.9 | 57,3 |
| NPT 2" | 2" | 49,0 | 66 | 20 | 76 | 68 | 72 | 2 | 714.950.9 | 90,8 |

**NPT straight fitting, compact, male, stainless
steel AISI-304, including washer and locknut**

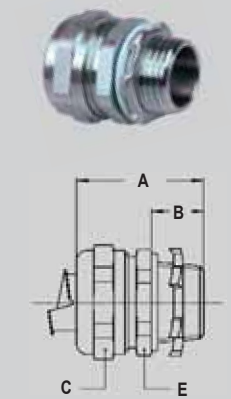

| Thread NPT | Sealtite Size (inch) | Min. Internal Bore (mm) | Dimensions in mm | | | | | Standard Package | Article Number | Weight (Kg/100) |
|---------------|-------------------------|----------------------------|------------------|----|----|---|----|---------------------|-------------------|--------------------|
| | | | A | B | C | D | E | | | |
| NPT 1/2" | 3/8" | 11,0 | 35 | 14 | 26 | - | 24 | 10 | 714.012.92 | 4,9 |
| NPT 1/2" | 1/2" | 14,5 | 36 | 14 | 29 | - | 27 | 10 | 714.016.92 | 5,5 |
| NPT 3/4" | 3/4" | 19,4 | 37 | 14 | 35 | - | 33 | 5 | 714.020.92 | 7,8 |
| NPT 1" | 1" | 24,7 | 40 | 16 | 45 | - | 42 | 5 | 714.026.92 | 13,9 |
| NPT 1.1/4" | 1.1/4" | 33,3 | 43 | 16 | 53 | - | 50 | 2 | 714.035.92 | 18,6 |
| NPT 1.1/2" | 1.1/2" | 38,0 | 50 | 18 | 62 | - | 58 | 2 | 714.040.92 | 28,0 |
| NPT 2" | 2" | 49,0 | 56 | 20 | 76 | - | 72 | 2 | 714.050.92 | 44,0 |

**NPT 90° fitting, compact, male, stainless
steel AISI-304, including washer and locknut**

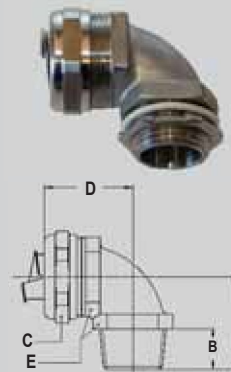

| Thread NPT | Sealtite Size (inch) | Min. Internal Bore (mm) | Dimensions in mm | | | | | Standard Package | Article Number | Weight (Kg/100) |
|---------------|-------------------------|----------------------------|------------------|----|----|----|----|---------------------|-------------------|--------------------|
| | | | A | B | C | D | E | | | |
| NPT 1/2" | 3/8" | 11,0 | 30 | 14 | 26 | 32 | 24 | 10 | 714.912.92 | 8,7 |
| NPT 1/2" | 1/2" | 14,5 | 32 | 14 | 29 | 34 | 27 | 10 | 714.916.92 | 10,1 |
| NPT 3/4" | 3/4" | 19,4 | 36 | 14 | 35 | 40 | 33 | 5 | 714.920.92 | 16,6 |
| NPT 1" | 1" | 24,7 | 44 | 16 | 45 | 49 | 42 | 5 | 714.926.92 | 29,6 |
| NPT 1.1/4" | 1.1/4" | 33,3 | 49 | 16 | 53 | 53 | 52 | 2 | 714.935.92 | 43,2 |
| NPT 1.1/2" | 1.1/2" | 38,0 | 56 | 18 | 62 | 57 | 60 | 2 | 714.940.92 | 59,5 |
| NPT 2" | 2" | 49,0 | 66 | 20 | 76 | 68 | 72 | 2 | 714.950.92 | 93,6 |

**ANACONDA
COMPACT
FITTINGS**

**LIQUID-TIGHT
FITTINGS FOR
SEALTITE
IP 67**



Grounding ferrule, stainless steel AISI-304



| Thread | Sealtite Size (inch) | Min. Internal Bore (mm) | Dimensions in mm | | | | | Standard Package | Article Number | Weight (Kg/100) |
|--------|-------------------------|----------------------------|------------------|---|---|---|---|---------------------|-------------------|--------------------|
| | | | A | B | C | D | E | | | |
| - | 3/8" | 11,0 | - | - | - | - | - | 50 | 815.011.5 | 0,4 |
| - | 1/2" | 14,5 | - | - | - | - | - | 50 | 815.016.5 | 0,5 |
| - | 3/4" | 19,4 | - | - | - | - | - | 25 | 815.021.5 | 0,7 |
| - | 1" | 24,7 | - | - | - | - | - | 25 | 815.029.5 | 1,1 |
| - | 1.1/4" | 33,3 | - | - | - | - | - | 10 | 815.036.5 | 1,5 |
| - | 1.1/2" | 38,0 | - | - | - | - | - | 10 | 815.042.5 | 2,1 |
| - | 2" | 49,0 | - | - | - | - | - | 10 | 815.048.5 | 3,2 |



Lock nuts, stainless steel (AISI-304), ISO.



| Thread ISO | Sealtite Size (inch) | Min. Internal Bore (mm) | Dimensions in mm | | | | | Standard Package | Article Number | Weight (Kg/100) |
|---------------|-------------------------|----------------------------|------------------|---|----|---|---|---------------------|-------------------|--------------------|
| | | | A | B | C | D | E | | | |
| M16 x 1,5 | - | - | 2,8 | - | 19 | - | - | 50 | 880.116.9 | 0,5 |
| M20 x 1,5 | - | - | 3,5 | - | 24 | - | - | 50 | 880.120.9 | 0,7 |
| M25 x 1,5 | - | - | 3,5 | - | 30 | - | - | 25 | 880.125.9 | 1,1 |
| M32 x 1,5 | - | - | 4,5 | - | 35 | - | - | 25 | 880.132.9 | 2,4 |
| M40 x 1,5 | - | - | 4,5 | - | 45 | - | - | 5 | 880.140.9 | 3,6 |
| M50 x 1,5 | - | - | 5,5 | - | 55 | - | - | 5 | 880.150.9 | 5,4 |
| M63 x 1,5 | - | - | 6,0 | - | 70 | - | - | 5 | 880.163.9 | 6,2 |



NPT locknut, stainless steel AISI-304



| Thread | Sealtite Size (inch) | Min. Internal Bore (mm) | Dimensions in mm | | | | | Standard Package | Article Number | Weight (Kg/100) |
|------------|-------------------------|----------------------------|------------------|---|---|---|---|---------------------|-------------------|--------------------|
| | | | A | B | C | D | E | | | |
| NPT 1/2" | 1/2" | - | - | - | - | - | - | 100 | 880.316.9 | 0,5 |
| NPT 3/4" | 3/4" | - | - | - | - | - | - | 50 | 880.320.9 | 0,8 |
| NPT 1" | 1" | - | - | - | - | - | - | 50 | 880.326.9 | 1,3 |
| NPT 1.1/4" | 1.1/4" | - | - | - | - | - | - | 20 | 880.335.9 | 1,8 |
| NPT 1.1/2" | 1.1/2" | - | - | - | - | - | - | 20 | 880.340.9 | 2,2 |
| NPT 2" | 2" | - | - | - | - | - | - | 20 | 880.350.9 | 2,8 |



NPT flat seal, NBR Rubber



| Thread | Sealtite Size (inch) | Min. Internal Bore (mm) | Dimensions in mm | | | | | Standard Package | Article Number | Weight (Kg/100) |
|------------|-------------------------|----------------------------|------------------|---|---|---|---|---------------------|-------------------|--------------------|
| | | | A | B | C | D | E | | | |
| NPT 1/2" | 1/2" | - | - | - | - | - | - | 50 | 815.616.0 | 0,03 |
| NPT 3/4" | 3/4" | - | - | - | - | - | - | 25 | 815.620.0 | 0,05 |
| NPT 1" | 1" | - | - | - | - | - | - | 25 | 815.626.0 | 0,11 |
| NPT 1.1/4" | 1.1/4" | - | - | - | - | - | - | 10 | 815.635.0 | 0,15 |
| NPT 1.1/2" | 1.1/2" | - | - | - | - | - | - | 10 | 815.640.0 | 0,19 |
| NPT 2" | 2" | - | - | - | - | - | - | 10 | 815.650.0 | 0,33 |



Anaconda stainless steel fittings for Anaconda Sealtite.

The stainless steel Anaconda fittings can be used with all types of Anaconda Sealtite (except CNP). These fittings are available in AISI-304 and AISI-316 and offer superior corrosion resistance. These stainless steel Anaconda fittings are mostly used in the off-shore, chemical and food industry. Because of the UL & CSA approvals the fittings are also suitable for export projects outside Europe.

Material & Construction:

Construction: Stainless steel (AISI-304) fitting, consisting of 4 parts (counter nut, clamping ring, ferrule and body).

Material: Counter nut and body are stainless steel (AISI-304) and the ferrule is from nickel plated brass. Clamping

ring and insert are from PA6 (red for ISO metric, blue for Pg and white for NPT).

Special approvals: UL-514B and CSA C 22.2 (combined UL/CSA file # E 234207).

Suitable for use in hazardous environments according NEC:

- Article 501.10 (B) (2) Class I, Division 2

- Article 502.10 (A) (2) and (B) (2) Class II, Division 1 and 2

- Article 503.10 (A) (3) and (B) Class III, Division 1 and 2

Temperature: -45 °C till +105 °C continuous (cable-hose-fittings are -40 °C till +100 °C).

Protection class: IP 67 (dust-proof, water-tight), with cable-hose fittings an IP 68 rate on the switchbox can be obtained.

Colour: Metal.

ANACONDA COMPACT FITTINGS

LIQUID-TIGHT FITTINGS FOR SEALTITE IP 67

ISO straight fitting, male, stainless steel (AISI-304).

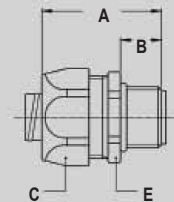

| Thread ISO | Sealtite Size (inch) | Min. Internal Bore (mm) | Dimensions in mm | | | | | Standard Package | Article Number | Weight (Kg/100) |
|---------------|-------------------------|----------------------------|------------------|----|----|---|----|---------------------|-------------------|--------------------|
| | | | A | B | C | D | E | | | |
| M16 x 1,5 | 5/16" | 8,3 | 35 | 12 | 27 | - | 24 | 10 | 812.015.9* | 4,8 |
| M20 x 1,5 | 5/16" | 8,3 | 36 | 13 | 27 | - | 24 | 10 | 812.014.9* | 5,1 |
| M16 x 1,5 | 3/8" | 10,2 | 35 | 12 | 27 | - | 24 | 10 | 812.016.9 | 4,8 |
| M20 x 1,5 | 3/8" | 10,2 | 36 | 13 | 27 | - | 24 | 10 | 812.017.9 | 5,1 |
| M20 x 1,5 | 1/2" | 13,9 | 37 | 13 | 30 | - | 27 | 10 | 812.020.9 | 5,9 |
| M25 x 1,5 | 3/4" | 18,5 | 40 | 15 | 36 | - | 36 | 5 | 812.025.9 | 7,9 |
| M32 x 1,5 | 1" | 23,8 | 46 | 15 | 46 | - | 46 | 5 | 812.032.9 | 17,5 |
| M40 x 1,5 | 1.1/4" | 31,8 | 52 | 16 | 54 | - | 52 | 2 | 812.040.9 | 27,9 |

* Fittings for 5/16" conduit without UL/CSA approval.

ISO 45° fitting, male, stainless steel (AISI-304).

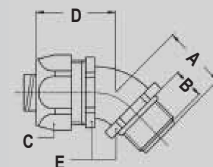

| Thread ISO | Sealtite Size (inch) | Min. Internal Bore (mm) | Dimensions in mm | | | | | Standard Package | Article Number | Weight (Kg/100) |
|---------------|-------------------------|----------------------------|------------------|----|----|----|----|---------------------|-------------------|--------------------|
| | | | A | B | C | D | E | | | |
| M16 x 1,5 | 5/16" | 8,3 | 23 | 12 | 27 | 33 | 22 | 10 | 812.415.9* | 7,3 |
| M20 x 1,5 | 5/16" | 8,3 | 24 | 13 | 27 | 33 | 22 | 10 | 812.414.9* | 7,4 |
| M16 x 1,5 | 3/8" | 10,2 | 23 | 12 | 27 | 33 | 22 | 10 | 812.416.9 | 7,3 |
| M20 x 1,5 | 3/8" | 10,2 | 24 | 13 | 27 | 33 | 22 | 10 | 812.417.9 | 7,4 |
| M20 x 1,5 | 1/2" | 13,9 | 25 | 13 | 30 | 33 | 27 | 10 | 812.420.9 | 10,5 |
| M25 x 1,5 | 3/4" | 18,5 | 30 | 15 | 36 | 36 | 33 | 5 | 812.425.9 | 13,6 |

* Fittings for 5/16" conduit without UL/CSA approval.

**ISO 90° fitting, male, stainless steel
(AISI-304).**

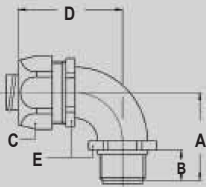

| Thread | Sealtite | Min. Internal | Dimensions in mm | | | | | Standard | Article | Weight |
|-----------|-------------|---------------|------------------|----|----|----|----|----------|------------|----------|
| ISO | Size (inch) | Bore (mm) | A | B | C | D | E | Package | Number | (Kg/100) |
| M16 x 1,5 | 5/16" | 8,3 | 32 | 12 | 27 | 42 | 22 | 10 | 812.915.9* | 8,2 |
| M20 x 1,5 | 5/16" | 8,3 | 33 | 13 | 27 | 42 | 22 | 10 | 812.914.9* | 8,4 |
| M16 x 1,5 | 3/8" | 10,2 | 32 | 12 | 27 | 42 | 22 | 10 | 812.916.9 | 8,2 |
| M20 x 1,5 | 3/8" | 10,2 | 33 | 13 | 27 | 42 | 22 | 10 | 812.917.9 | 8,4 |
| M20 x 1,5 | 1/2" | 13,9 | 36 | 13 | 30 | 43 | 27 | 10 | 812.920.9 | 12,6 |
| M25 x 1,5 | 3/4" | 18,5 | 43 | 15 | 36 | 48 | 33 | 5 | 812.925.9 | 19,2 |

* Fittings for 5/16" conduit without UL/CSA approval..

**ISO cable-hose fitting, male, stainless steel
(AISI-304).**

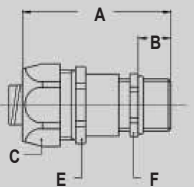

| Thread | Sealtite | Clamping | Dimensions in mm | | | | | Standard | Article | Weight |
|-----------|-------------|------------|------------------|----|----|----|----|----------|------------|----------|
| ISO | Size (inch) | Range (mm) | A | B | C | E | F | Package | Number | (Kg/100) |
| M16 x 1,5 | 5/16" | 4 - 8 | 57 | 12 | 27 | 24 | 18 | 10 | 812.715.9* | 7,8 |
| M16 x 1,5 | 3/8" | 4 - 8 | 57 | 12 | 27 | 24 | 18 | 10 | 812.716.9 | 7,8 |
| M20 x 1,5 | 3/8" | 6 - 10,2 | 57 | 12 | 27 | 24 | 22 | 10 | 812.717.9 | 9,5 |
| M20 x 1,5 | 1/2" | 6 - 12 | 59 | 12 | 30 | 27 | 22 | 10 | 812.720.9 | 9,7 |

* Fittings for 5/16" conduit..

**Pg straight fitting, male, stainless steel
(AISI-304).**

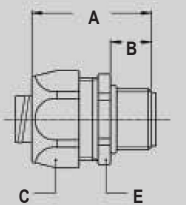

| Thread | Sealtite | Min. Internal | Dimensions in mm | | | | | Standard | Article | Weight |
|---------|-------------|---------------|------------------|----|----|---|----|----------|------------|----------|
| Pg | Size (inch) | Bore (mm) | A | B | C | D | E | Package | Number | (Kg/100) |
| Pg 11 | 5/16" | 8,3 | 35 | 12 | 27 | - | 24 | 10 | 810.012.9* | 5,6 |
| Pg 13,5 | 5/16" | 8,3 | 35 | 12 | 27 | - | 24 | 10 | 810.014.9* | 5,6 |
| Pg 11 | 3/8" | 10,2 | 35 | 12 | 27 | - | 24 | 10 | 810.011.9 | 5,6 |
| Pg 13,5 | 3/8" | 10,2 | 35 | 12 | 27 | - | 24 | 10 | 810.013.9 | 5,6 |
| Pg 16 | 1/2" | 13,9 | 37 | 13 | 30 | - | 27 | 10 | 810.016.9 | 6,3 |
| Pg 21 | 3/4" | 18,5 | 40 | 15 | 36 | - | 36 | 5 | 810.021.9 | 8,4 |
| Pg 29 | 1" | 23,8 | 46 | 15 | 46 | - | 46 | 5 | 810.029.9 | 25,0 |
| Pg 36 | 1.1/4" | 31,8 | 52 | 16 | 54 | - | 52 | 2 | 810.036.9 | 34,6 |
| Pg 42 | 1.1/2" | 36,8 | 56 | 18 | 63 | - | 60 | 2 | 810.042.9 | 47,2 |
| Pg 48 | 2" | 47,8 | 66 | 20 | 77 | - | 74 | 2 | 810.048.9 | 72,0 |

* Fittings for 5/16" conduit without UL/CSA approval..

**Pg 90° fitting, male, stainless steel
(AISI-304).**

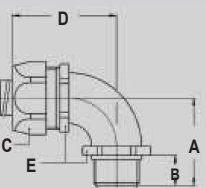

| Thread | Sealtite | Min. Internal | Dimensions in mm | | | | | Standard | Article | Weight |
|--------|-------------|---------------|------------------|----|----|----|----|----------|------------|----------|
| Pg | Size (inch) | Bore (mm) | A | B | C | D | E | Package | Number | (Kg/100) |
| Pg 11 | 5/16" | 8,3 | 32 | 12 | 27 | 42 | 22 | 10 | 810.912.9* | 8,9 |
| Pg 11 | 3/8" | 10,2 | 32 | 12 | 27 | 42 | 22 | 10 | 810.911.9 | 8,9 |
| Pg 16 | 1/2" | 13,9 | 36 | 13 | 30 | 43 | 27 | 10 | 810.916.9 | 15,3 |
| Pg 21 | 3/4" | 18,5 | 43 | 15 | 36 | 48 | 33 | 5 | 810.921.9 | 21,6 |
| Pg 29 | 1" | 23,8 | 48 | 15 | 46 | 50 | 42 | 5 | 810.929.9 | 35,3 |

* Fittings for 5/16" conduit without UL/CSA approval..

NPT straight fitting, male, stainless steel (AISI-304).

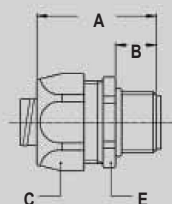

| Thread | Sealtite Size (inch) | Min. Internal Bore (mm) | Dimensions in mm | | | | | Standard Package | Article Number | Weight (Kg/100) |
|----------|----------------------|-------------------------|------------------|----|----|---|----|------------------|----------------|-----------------|
| | | | A | B | C | D | E | | | |
| 1/2" NPT | 5/16" | 8,3 | 37 | 13 | 27 | - | 24 | 10 | 814.011.9* | 5,6 |
| 1/2" NPT | 3/8" | 10,2 | 37 | 13 | 27 | - | 24 | 10 | 814.012.9 | 5,6 |
| 1/2" NPT | 1/2" | 13,9 | 37 | 13 | 30 | - | 27 | 10 | 814.016.9 | 6,2 |
| 3/4" NPT | 3/4" | 18,5 | 40 | 15 | 36 | - | 36 | 5 | 814.020.9 | 8,9 |
| 1" NPT | 1" | 23,8 | 46 | 15 | 46 | - | 46 | 5 | 814.026.9 | 25,0 |

* Fittings for 5/16" conduit without UL/CSA approval.

NPT 45° fitting, male, stainless steel (AISI-304).

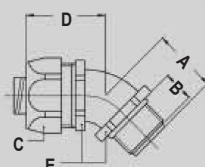

| Thread | Sealtite Size (inch) | Min. Internal Bore (mm) | Dimensions in mm | | | | | Standard Package | Article Number | Weight (Kg/100) |
|----------|----------------------|-------------------------|------------------|----|----|----|----|------------------|----------------|-----------------|
| | | | A | B | C | D | E | | | |
| 1/2" NPT | 5/16" | 8,3 | 25 | 13 | 27 | 33 | 22 | 10 | 814.411.9* | 7,9 |
| 1/2" NPT | 3/8" | 10,2 | 25 | 13 | 27 | 33 | 22 | 10 | 814.412.9 | 7,9 |
| 1/2" NPT | 1/2" | 13,9 | 25 | 13 | 30 | 33 | 27 | 10 | 814.416.9 | 10,7 |
| 3/4" NPT | 3/4" | 18,5 | 30 | 15 | 36 | 36 | 33 | 5 | 814.420.9 | 15,7 |

* Fittings for 5/16" conduit without UL/CSA approval.

NPT 90° fitting, male, stainless steel (AISI-304).

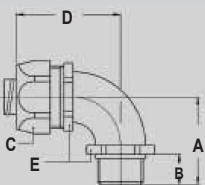

| Thread | Sealtite Size (inch) | Min. Internal Bore (mm) | Dimensions in mm | | | | | Standard Package | Article Number | Weight (Kg/100) |
|----------|----------------------|-------------------------|------------------|----|----|----|----|------------------|----------------|-----------------|
| | | | A | B | C | D | E | | | |
| 1/2" NPT | 5/16" | 8,3 | 36 | 13 | 27 | 43 | 22 | 10 | 814.911.9* | 13,3 |
| 1/2" NPT | 3/8" | 10,2 | 36 | 13 | 27 | 43 | 22 | 10 | 814.912.9 | 13,3 |
| 1/2" NPT | 1/2" | 13,9 | 36 | 13 | 30 | 43 | 27 | 10 | 814.916.9 | 14,6 |
| 3/4" NPT | 3/4" | 18,5 | 43 | 15 | 36 | 48 | 33 | 5 | 814.920.9 | 22,0 |
| 1" NPT | 1" | 23,8 | 48 | 15 | 46 | 59 | 42 | 5 | 814.926.9 | 31,7 |

* Fittings for 5/16" conduit without UL/CSA approval.

Grounding ferrule, nickel plated brass.



| Thread | Sealtite Size (inch) | Min. Internal Bore (mm) | Dimensions in mm | | | | | Standard Package | Article Number | Weight (Kg/100) |
|--------|----------------------|-------------------------|------------------|---|---|---|---|------------------|----------------|-----------------|
| | | | A | B | C | D | E | | | |
| - | 5/16" | 8,3 | - | - | - | - | - | 10 | 815.010.0 | 0,8 |
| - | 3/8" | 10,2 | - | - | - | - | - | 10 | 815.011.3 | 0,6 |
| - | 1/2" | 13,9 | - | - | - | - | - | 10 | 815.016.3 | 0,8 |
| - | 3/4" | 18,5 | - | - | - | - | - | 5 | 815.021.3 | 1,4 |
| - | 1" | 23,8 | - | - | - | - | - | 5 | 815.029.3 | 2,8 |
| - | 1.1/4" | 31,8 | - | - | - | - | - | 2 | 815.036.3 | 6,0 |
| - | 1.1/2" | 36,8 | - | - | - | - | - | 2 | 815.042.3 | 6,8 |
| - | 2" | 47,8 | - | - | - | - | - | 2 | 815.048.3 | 8,8 |

ANACONDA
SEALTITE®
SPECIAL

LIQUID-TIGHT
FITTINGS FOR
SEALTITE
IP 67



Anaconda compact fittings, UL & CSA, stainless steel AISI-316, for Anaconda Sealrite.

The compact version stainless steel Anaconda fittings can be used with all types of Anaconda Sealrite (except CNP). This Anaconda fitting is a universal fitting with shorter design and lower weight. All ferrules are flanged versions for a better fit. Because the fitting and ferrule are made from Stainless steel AISI-316 they offer an excellent corrosion protection in combination with a nice appearance. The compact fittings have UL & CSA approval.

Construction: Stainless steel AISI-316, consisting of 4 parts (counter nut, clamping ring, ferrule and body).

Material: Counter nut, body are stainless steel AISI-316



and ferrule are stainless steel AISI-304. Clamping ring is made from PA6. The O-rings are from NBR rubber.

Special approvals: UL-514B and CSA C 22.2 (combined UL/CSA file # E 234207).

Suitable for use in hazardous environments according NEC:

- Article 501.10 (B) (2) Class I, Division 2

- Article 502.10 (A) (2) and (B) (2) Class II, Division 1 and 2

- Article 503.10 (A) (3) and (B) Class III, Division 1 and 2

Temperature: -45 °C till +105 °C continuous

Protection class: IP 67 (dust-proof, water-tight)

Colour: Metal

ISO straight fitting, compact, stainless steel AISI-316

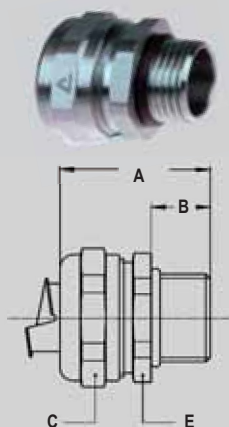

| Thread | Sealrite Size (inch) | Min. Internal Bore (mm) | Dimensions in mm | | | | | Standard Package | Article Number | Weight (Kg/100) |
|-----------|----------------------|-------------------------|------------------|----|----|---|----|------------------|----------------|-----------------|
| | | | A | B | C | D | E | | | |
| M16 x 1,5 | 3/8" | 11,0 | 31 | 10 | 26 | - | 24 | 10 | 712.116.9 | 3,9 |
| M20 x 1,5 | 3/8" | 11,0 | 31 | 10 | 26 | - | 24 | 10 | 712.117.9 | 4,0 |
| M20 x 1,5 | 1/2" | 14,5 | 32 | 10 | 29 | - | 27 | 10 | 712.120.9 | 4,4 |
| M25 x 1,5 | 3/4" | 19,4 | 33 | 10 | 35 | - | 33 | 5 | 712.125.9 | 6,6 |
| M32 x 1,5 | 1" | 24,7 | 36 | 12 | 45 | - | 42 | 5 | 712.132.9 | 11,7 |
| M40 x 1,5 | 1.1/4" | 33,3 | 40 | 13 | 53 | - | 50 | 2 | 712.140.9 | 16,0 |
| M50 x 1,5 | 1.1/2" | 38,0 | 46 | 14 | 62 | - | 58 | 2 | 712.150.9 | 25,3 |
| M63 x 1,5 | 2" | 49,0 | 52 | 16 | 76 | - | 72 | 2 | 712.163.9 | 38,6 |

ISO 90° fitting, compact, male, stainless steel AISI-316

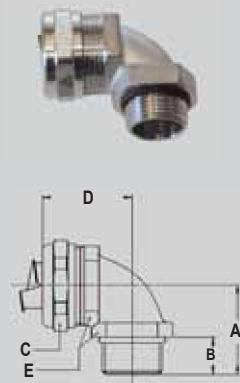

| Thread | Sealrite Size (inch) | Min. Internal Bore (mm) | Dimensions in mm | | | | | Standard Package | Article Number | Weight (Kg/100) |
|-----------|----------------------|-------------------------|------------------|----|----|----|----|------------------|----------------|-----------------|
| | | | A | B | C | D | E | | | |
| M16 x 1,5 | 3/8" | 11,0 | 26 | 10 | 26 | 31 | 22 | 10 | 712.516.9 | 6,6 |
| M20 x 1,5 | 3/8" | 11,0 | 26 | 10 | 26 | 32 | 24 | 10 | 712.517.9 | 7,9 |
| M20 x 1,5 | 1/2" | 14,5 | 28 | 10 | 29 | 34 | 27 | 10 | 712.520.9 | 9,2 |
| M25 x 1,5 | 3/4" | 19,4 | 32 | 10 | 35 | 40 | 33 | 5 | 712.525.9 | 16,2 |
| M32 x 1,5 | 1" | 24,7 | 40 | 12 | 45 | 49 | 42 | 5 | 712.532.9 | 27,8 |
| M40 x 1,5 | 1.1/4" | 33,3 | 46 | 13 | 53 | 53 | 52 | 2 | 712.540.9 | 40,1 |
| M50 x 1,5 | 1.1/2" | 38,0 | 52 | 14 | 62 | 57 | 60 | 2 | 712.550.9 | 57,5 |
| M63 x 1,5 | 2" | 49,0 | 62 | 16 | 76 | 68 | 72 | 2 | 712.563.9 | 90,6 |

**NPT straight fitting, compact, male,
stainless steel AISI-316**

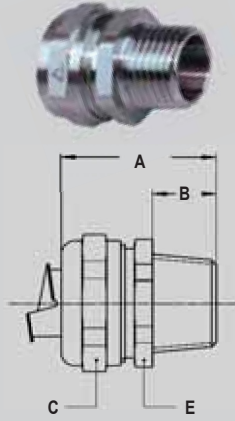

| Thread NPT | Sealtite Size (inch) | Min. Internal Bore (mm) | Dimensions in mm | | | | | Standard Package | Article Number | Weight (Kg/100) |
|---------------|-------------------------|----------------------------|------------------|----|----|---|----|---------------------|-------------------|--------------------|
| | | | A | B | C | D | E | | | |
| NPT 1/2" | 3/8" | 11,0 | 35 | 14 | 26 | - | 24 | 10 | 714.112.9 | 4,4 |
| NPT 1/2" | 1/2" | 14,5 | 36 | 14 | 29 | - | 27 | 10 | 714.116.9 | 5,0 |
| NPT 3/4" | 3/4" | 19,4 | 37 | 14 | 35 | - | 33 | 5 | 714.120.9 | 7,0 |
| NPT 1" | 1" | 24,7 | 40 | 16 | 45 | - | 42 | 5 | 714.126.9 | 12,6 |
| NPT 1.1/4" | 1.1/4" | 33,3 | 43 | 16 | 53 | - | 50 | 2 | 714.135.9 | 16,8 |
| NPT 1.1/2" | 1.1/2" | 38,0 | 50 | 18 | 62 | - | 58 | 2 | 714.140.9 | 25,8 |
| NPT 2" | 2" | 49,0 | 56 | 20 | 76 | - | 72 | 2 | 714.150.9 | 41,2 |

**NPT 90° fitting, compact, male, stainless
steel AISI-316**

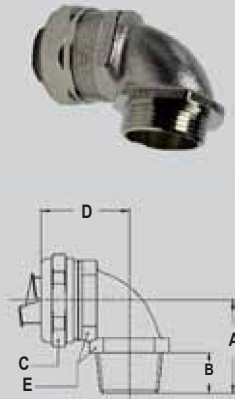

| Thread NPT | Sealtite Size (inch) | Min. Internal Bore (mm) | Dimensions in mm | | | | | Standard Package | Article Number | Weight (Kg/100) |
|---------------|-------------------------|----------------------------|------------------|----|----|----|----|---------------------|-------------------|--------------------|
| | | | A | B | C | D | E | | | |
| NPT 1/2" | 3/8" | 11,0 | 30 | 14 | 26 | 32 | 24 | 10 | 714.512.9 | 8,2 |
| NPT 1/2" | 1/2" | 14,5 | 32 | 14 | 29 | 34 | 27 | 10 | 714.516.9 | 9,6 |
| NPT 3/4" | 3/4" | 19,4 | 36 | 14 | 35 | 40 | 33 | 5 | 714.520.9 | 16,7 |
| NPT 1" | 1" | 24,7 | 44 | 16 | 45 | 49 | 42 | 5 | 714.526.9 | 28,3 |
| NPT 1.9/4" | 1.1/4" | 33,3 | 49 | 16 | 53 | 53 | 52 | 2 | 714.535.9 | 41,4 |
| NPT 1.9/2" | 1.1/2" | 38,0 | 56 | 18 | 62 | 57 | 60 | 2 | 714.540.9 | 57,3 |
| NPT 2" | 2" | 49,0 | 66 | 20 | 76 | 68 | 72 | 2 | 714.550.9 | 90,8 |

**NPT straight fitting, compact, male,
stainless steel AISI-316 (incl. locknut)**

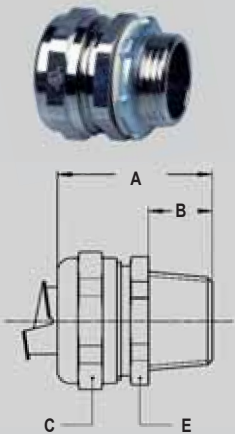

| Thread NPT | Sealtite Size (inch) | Min. Internal Bore (mm) | Dimensions in mm | | | | | Standard Package | Article Number | Weight (Kg/100) |
|---------------|-------------------------|----------------------------|------------------|----|----|---|----|---------------------|-------------------|--------------------|
| | | | A | B | C | D | E | | | |
| NPT 1/2" | 3/8" | 11,0 | 35 | 14 | 26 | - | 24 | 10 | 714.112.92 | 4,9 |
| NPT 1/2" | 1/2" | 14,5 | 36 | 14 | 29 | - | 27 | 10 | 714.116.92 | 5,5 |
| NPT 3/4" | 3/4" | 19,4 | 37 | 14 | 35 | - | 33 | 5 | 714.120.92 | 7,8 |
| NPT 1" | 1" | 24,7 | 40 | 16 | 45 | - | 42 | 5 | 714.126.92 | 13,9 |
| NPT 1.1/4" | 1.1/4" | 33,3 | 43 | 16 | 53 | - | 50 | 2 | 714.135.92 | 18,6 |
| NPT 1.1/2" | 1.1/2" | 38,0 | 50 | 18 | 62 | - | 58 | 2 | 714.140.92 | 28,0 |
| NPT 2" | 2" | 49,0 | 56 | 20 | 76 | - | 72 | 2 | 714.150.92 | 44,0 |

**ANACONDA
SEALTITE®
SPECIAL**

**LIQUID-TIGHT
FITTINGS FOR
SEALTITE
IP 67**

NPT 90° fitting, compact, male, stainless steel AISI-316 (incl. locknut)

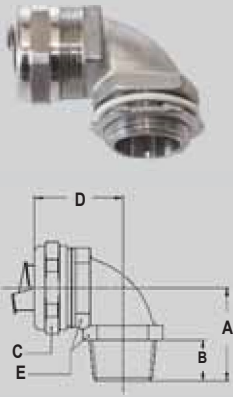

| Thread | Sealtite Size (inch) | Min. Internal Bore (mm) | Dimensions in mm | | | | | Standard Package | Article Number | Weight (Kg/100) |
|------------|----------------------|-------------------------|------------------|----|----|----|----|------------------|----------------|-----------------|
| | | | A | B | C | D | E | | | |
| NPT 1/2" | 3/8" | 11,0 | 30 | 14 | 26 | 32 | 24 | 10 | 714.512.92 | 8,7 |
| NPT 1/2" | 1/2" | 14,5 | 32 | 14 | 29 | 34 | 27 | 10 | 714.516.92 | 10,1 |
| NPT 3/4" | 3/4" | 19,4 | 36 | 14 | 35 | 40 | 33 | 5 | 714.520.92 | 16,7 |
| NPT 1" | 1" | 24,7 | 44 | 16 | 45 | 49 | 42 | 5 | 714.526.92 | 29,6 |
| NPT 1.9/4" | 1.1/4" | 33,3 | 49 | 16 | 53 | 53 | 52 | 2 | 714.535.92 | 43,2 |
| NPT 1.9/2" | 1.1/2" | 38,0 | 56 | 18 | 62 | 57 | 60 | 2 | 714.540.92 | 59,5 |
| NPT 2" | 2" | 49,0 | 66 | 20 | 76 | 68 | 72 | 2 | 714.550.92 | 93,6 |

Grounding ferrule, stainless steel AISI-304



| Thread | Sealtite Size (inch) | Min. Internal Bore (mm) | Dimensions in mm | | | | | Standard Package | Article Number | Weight (Kg/100) |
|--------|----------------------|-------------------------|------------------|---|---|---|---|------------------|----------------|-----------------|
| | | | A | B | C | D | E | | | |
| - | 3/8" | 11,0 | - | - | - | - | - | 50 | 815.011.5 | 0,4 |
| - | 1/2" | 14,5 | - | - | - | - | - | 50 | 815.016.5 | 0,5 |
| - | 3/4" | 19,4 | - | - | - | - | - | 25 | 815.021.5 | 0,7 |
| - | 1" | 24,7 | - | - | - | - | - | 25 | 815.029.5 | 1,1 |
| - | 1.1/4" | 33,3 | - | - | - | - | - | 10 | 815.036.5 | 1,5 |
| - | 1.1/2" | 38,0 | - | - | - | - | - | 10 | 815.042.5 | 2,1 |
| - | 2" | 49,0 | - | - | - | - | - | 10 | 815.048.5 | 3,2 |

Grounding ferrule, stainless steel AISI-316.



| Thread | Sealtite Size (inch) | Min. Internal Bore (mm) | Dimensions in mm | | | | | Standard Package | Article Number | Weight (Kg/100) |
|--------|----------------------|-------------------------|------------------|---|---|---|---|------------------|----------------|-----------------|
| | | | A | B | C | D | E | | | |
| - | 3/8" | 10,2 | - | - | - | - | - | 10 | 815.011.9 | 0,6 |
| - | 1/2" | 13,9 | - | - | - | - | - | 10 | 815.016.9 | 0,8 |
| - | 3/4" | 18,5 | - | - | - | - | - | 5 | 815.021.9 | 1,4 |
| - | 1" | 23,8 | - | - | - | - | - | 5 | 815.029.9 | 2,8 |

**ANACONDA
SEALTITE®
SPECIAL**

**LIQUID-TIGHT
FITTINGS FOR
SEALTITE
IP 67**



**ANACONDA
SEALTITE®
SPECIAL**

**LIQUID-TIGHT
FITTINGS FOR
SEALTITE
IP 67**



Anaconda stainless steel AISI-316 fittings for Anaconda Sealtite.

The stainless steel AISI-316 Anaconda fittings can be used with all types of Anaconda Sealtite (except CNP) and offer the highest corrosion resistance. These stainless steel Anaconda fittings are mostly used in the off-shore, chemical and food industry. Because of the UL & CSA approvals the fittings are also suitable for export projects outside Europe.

Material & Construction:

Construction: Stainless steel (AISI-316) fitting, consisting of 4 parts (counter nut, clamping ring, ferrule and body).

Material: Counter nut and body are stainless steel (AISI-316) and the ferrule is from nickel plated brass. Clamping

ring and insert are from PA6 (red for ISO metric and white for NPT).

Special approvals: UL-514B and CSA C 22.2 (combined UL/CSA file # E 234207).

Suitable for use in hazardous environments according NEC:

- Article 501.10 (B) (2) Class I, Division 2
- Article 502.10 (A) (2) and (B) (2) Class II, Division 1 and 2
- Article 503.10 (A) (3) and (B) Class III, Division 1 and 2

Temperature: -45 °C till +105 °C continuous.

Protection class: IP 67 (dust-proof, water-tight).

Colour: Metal.

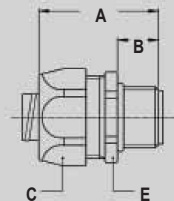

ISO straight fitting, male, stainless steel (AISI-316).



| Thread | Sealtite Size (inch) | Min. Internal Bore (mm) | Dimensions in mm | | | | | Standard Package | Article Number | Weight (Kg/100) |
|-----------|----------------------|-------------------------|------------------|----|----|---|----|------------------|----------------|-----------------|
| | | | A | B | C | D | E | | | |
| M16 x 1,5 | 3/8" | 10,2 | 35 | 12 | 26 | - | 24 | 10 | 812.116.9 | 4,8 |
| M20 x 1,5 | 1/2" | 13,9 | 37 | 13 | 29 | - | 27 | 10 | 812.120.9 | 5,9 |
| M25 x 1,5 | 3/4" | 18,5 | 40 | 15 | 35 | - | 33 | 5 | 812.125.9 | 7,9 |
| M32 x 1,5 | 1" | 23,8 | 46 | 15 | 45 | - | 43 | 5 | 812.132.9 | 17,5 |

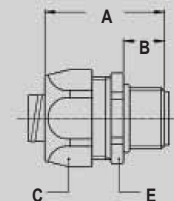

Pg straight fitting, male, stainless steel (AISI-316).



| Thread | Sealtite Size (inch) | Min. Internal Bore (mm) | Dimensions in mm | | | | | Standard Package | Article Number | Weight (Kg/100) |
|--------|----------------------|-------------------------|------------------|----|----|---|----|------------------|----------------|-----------------|
| | | | A | B | C | D | E | | | |
| Pg 16 | 1/2" | 13,9 | 37 | 13 | 30 | - | 27 | 10 | 810.116.9 | 6,3 |
| Pg 21 | 3/4" | 18,5 | 40 | 15 | 36 | - | 36 | 5 | 810.121.9 | 8,4 |
| Pg 29 | 1" | 23,8 | 46 | 15 | 46 | - | 46 | 5 | 810.129.9 | 25,0 |

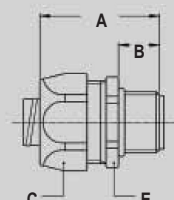

NPT straight fitting, male, stainless steel (AISI-316).



| Thread | Sealtite Size (inch) | Min. Internal Bore (mm) | Dimensions in mm | | | | | Standard Package | Article Number | Weight (Kg/100) |
|----------|----------------------|-------------------------|------------------|----|----|---|----|------------------|----------------|-----------------|
| | | | A | B | C | D | E | | | |
| 1/2" NPT | 3/8" | 10,2 | 35 | 12 | 26 | - | 24 | 10 | 814.112.9 | 5,6 |
| 1/2" NPT | 1/2" | 13,9 | 37 | 13 | 29 | - | 27 | 10 | 814.116.9 | 6,2 |
| 3/4" NPT | 3/4" | 18,5 | 40 | 15 | 35 | - | 33 | 5 | 814.120.9 | 8,9 |
| 1" NPT | 1" | 23,8 | 46 | 15 | 45 | - | 43 | 5 | 814.126.9 | 25,0 |

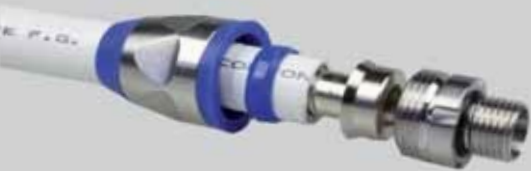

Anaconda Hygienic Design, stainless steel AISI-316 “food fitting” for Anaconda Sealтите.

Anaconda hygienically designed, stainless steel food fittings can be used with all types of Anaconda Sealтите conduits (except CNP). These stainless fittings are designed with rounded corners and have a smooth contourless profile to minimise the risk of bacteria deposits and to promote easy cleaning. They display excellent resistance to corrosion.

Material & Construction:

Construction: Stainless steel (AISI-316) fitting, consisting of 6 parts (lower seal, counter nut, upper seal, clamping ring, ferrule and body).

Material: Counter nut and body are stainless steel (AISI-316) and the ferrule is from nickel plated brass. Clamping



ring is from PA6. The blue rubber is made of TPE in accordance with FDA-CFR 21.

Special approvals: Special TPE seals, halogen-free, specially formulated for food and beverage applications per FDA guideline CFR 21.

Temperature: -45 °C till +105 °C continuous.

Protection class: IP 68 according EN 60529, IP69K according DIN 40050-9 (till 40 Bar high pressure).

Colour: Metal.

ISO straight food grade fitting, male, stainless steel (AISI-316).

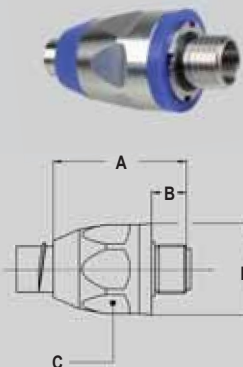

| Thread ISO | Sealtite Size (inch) | Min. Internal Bore (mm) | Dimensions in mm | | | | | | Standard Package | Article Number | Weight (Kg/100) |
|---------------|-------------------------|----------------------------|------------------|----|----|---|----|----|---------------------|-------------------|--------------------|
| | | | A | B | C | D | F | | | | |
| M16 x 1,5 | 3/8" | 10,4 | 48 | 12 | 27 | - | 31 | 10 | 832.016.9 | 6,6 | |
| M20 x 1,5 | 1/2" | 13,8 | 50 | 13 | 30 | - | 34 | 10 | 832.020.9 | 8,0 | |
| M25 x 1,5 | 3/4" | 18,5 | 57 | 15 | 36 | - | 41 | 5 | 832.025.9 | 11,8 | |
| M32 x 1,5 | 1" | 23,8 | 68 | 15 | 46 | - | 53 | 5 | 832.032.9 | 22,8 | |
| M40 x 1,5 | 1.1/4" | 31,8 | 75 | 16 | 54 | - | 62 | 2 | 832.040.9 | 34,2 | |
| M50 x 1,5 | 1.1/2" | 36,8 | 81 | 18 | 63 | - | 70 | 1 | 832.050.9 | 38,6 | |
| M63 x 1,5 | 2" | 47,8 | 88 | 20 | 77 | - | 85 | 1 | 832.063.9 | 76,6 | |

**ANACONDA
SEALTITE®
SPECIAL**

**LIQUID-TIGHT
FITTINGS FOR
SEALTITE
IP 68**



Anaconda swivel fittings, stainless steel AISI-316 , for Anaconda Sealtite.

The swivel version stainless steel AISI-316 Anaconda fittings can be used with all types of Anaconda Sealtite (except CNP). This Anaconda fitting is a universal fitting with a special swivel mechanism for a higher tensile strength and a high water proof protection (IP67). All ferrules are turned nickel plated brass versions for a better fit. The high quality stainless steel AISI-316 offers a superb corrosion protection in combination with a nice appearance.



Construction: Stainless steel AISI-316 fitting, consisting of 4 parts (counter nut, clamping ring, ferrule and body).

Material: Counter nut and body are stainless steel AISI-316. Clamping ring is made from PA6 and the ferrule is made from nickel plated brass. The O-rings are from NBR rubber (black for ISO).

Temperature: -45 °C till +105 °C continuous

Protection class: IP 67

Colour: Metal

ANACONDA COMPACT FITTINGS

LIQUID-TIGHT FITTINGS FOR SEALTITE IP 67

NPT 45° swivel fitting, male, stainless steel (AISI-316).

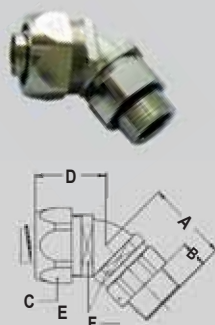

| Thread | Sealtite Size (inch) | Min. Internal Bore (mm) | Dimensions in mm | | | | | | Standard Package | Article Number | Weight (Kg/100) |
|----------|----------------------|-------------------------|------------------|----|----|----|----|----|------------------|----------------|-----------------|
| | | | A | B | C | D | E | F | | | |
| NPT 1/2" | 3/8" | 10,4 | 36 | 12 | 27 | 28 | 22 | 22 | 10 | 819.212.9 | 11,5 |
| NPT 1/2" | 1/2" | 13,8 | 36 | 12 | 30 | 30 | 27 | 25 | 10 | 819.216.9 | 14,0 |
| NPT 3/4" | 3/4" | 17,4 | - | 12 | 36 | - | - | - | 5 | 838.220.9 | 22,0 |
| NPT 1" | 1" | 23,4 | - | 13 | 46 | - | - | - | 5 | 838.226.9 | 37,0 |

NPT 90° swivel fitting, male, stainless steel (AISI-316).



| Thread | Sealtite Size (inch) | Min. Internal Bore (mm) | Dimensions in mm | | | | | | Standard Package | Article Number | Weight (Kg/100) |
|----------|----------------------|-------------------------|------------------|----|----|----|----|----|------------------|----------------|-----------------|
| | | | A | B | C | D | E | F | | | |
| NPT 1/2" | 3/8" | 10,4 | 41 | 12 | 27 | 35 | 22 | 22 | 10 | 819.512.9 | 12,0 |
| NPT 1/2" | 1/2" | 13,8 | 41 | 12 | 30 | 37 | 27 | 25 | 10 | 819.516.9 | 14,0 |
| NPT 3/4" | 3/4" | 17,4 | - | 12 | 36 | - | - | - | 5 | 838.520.9 | 23,5 |
| NPT 1" | 1" | 23,4 | - | 13 | 46 | - | - | - | 5 | 838.526.9 | 42,0 |



Anaconda hygienic design, mirror-polished “elbow food fitting” for Anaconda Sealтите.

Anaconda hygienically designed mirror polished elbow fittings can be used with all types of Anaconda Sealтите (except CNP) and offer a high corrosion resistance. Because of the special mirror-polished treatment these fittings are specifically smooth and give a good protection especially for the pharmaceutical and food industry. The mirror polished treatment reduces the risk of bacterial formation and permits easy cleaning.



Material & Construction:

Construction: Nickel plated brass fitting, consisting of 4 parts (counter nut, clamping ring, ferrule and body).

Material: Counter nut, body and ferrule are nickel plated brass with exception of size 3/8” till 1” where the ferrule is from galvanised steel. Clamping ring and inserts are made from PA6 red for ISO metric.

Temperature: -45 °C till +105 °C continuous.

Protection class: IP 67 (dust-proof, water-tight).

Colour: Metal.

**ANACONDA
SEALTITE®
SPECIAL**



ISO 90° fitting, male, mirror-polished nickel plated brass.

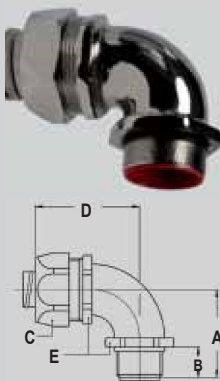

| Thread | Sealtite Size (inch) | Min. Internal Bore (mm) | Dimensions in mm | | | | | Standard Package | Article Number | Weight (Kg/100) |
|-----------|----------------------|-------------------------|------------------|----|----|----|----|------------------|----------------|-----------------|
| | | | A | B | C | D | F | | | |
| M16 x 1,5 | 5/16" | 8,3 | 32 | 12 | 26 | 42 | 22 | 10 | 818.915.1 | 8,2 |
| M20 x 1,5 | 5/16" | 8,3 | 33 | 13 | 26 | 42 | 22 | 10 | 818.914.1 | 8,4 |
| M16 x 1,5 | 3/8" | 10,2 | 32 | 12 | 26 | 42 | 22 | 10 | 818.916.1 | 8,2 |
| M20 x 1,5 | 3/8" | 10,2 | 33 | 13 | 26 | 42 | 22 | 10 | 818.917.1 | 8,4 |
| M20 x 1,5 | 1/2" | 13,9 | 36 | 13 | 29 | 43 | 27 | 10 | 818.920.1 | 12,6 |
| M25 x 1,5 | 3/4" | 18,5 | 43 | 15 | 35 | 48 | 33 | 5 | 818.925.1 | 19,2 |
| M32 x 1,5 | 1" | 23,8 | 48 | 15 | 45 | 59 | 42 | 5 | 818.932.1 | 31,6 |

**LIQUID-TIGHT
FITTINGS FOR
SEALTITE
IP 66**

ISO 90° fitting, compact, male, nickel plated brass.

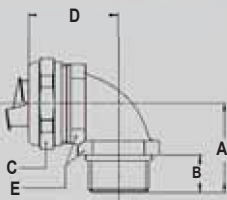

| Thread | Sealtite Size (inch) | Min. Internal Bore (mm) | Dimensions in mm | | | | | Standard Package | Article Number | Weight (Kg/100) |
|-----------|----------------------|-------------------------|------------------|----|----|----|----|------------------|----------------|-----------------|
| | | | A | B | C | D | E | | | |
| M40 x 1,5 | 1.1/4" | 33,3 | 46 | 13 | 53 | 53 | 52 | 2 | 712.940.1 | 40,1 |
| M50 x 1,5 | 1.1/2" | 38,0 | 52 | 14 | 62 | 57 | 60 | 2 | 712.950.1 | 57,5 |
| M63 x 1,5 | 2" | 49,0 | 62 | 16 | 76 | 68 | 72 | 2 | 712.963.1 | 90,6 |