

## MV9H330-11Y-M20



- Steel rod
- Long life
- Metal enclosure
- free of silicon
- 1 Cable entry M 20 x 1.5
- Lever can be transposed by 180°
- Suitable for low actuating speeds
- proved in power station applications
- 40 mm x 76 mm x 40 mm ( basic component)
- Continuous adjustment of lever position 360°
- Actuator head can be repositioned in steps 4 x 90°

### Data

#### Ordering data

Product type description	MV9H 330-11Y
Article number (order number)	101168056
EAN (European Article Number)	4030661220352
eCl@ss number, Version 9.0	27-27-06-01

#### Certifications

Certificates	cULus EAC DNV GL
--------------	------------------------

#### General data

Product name	330 rod lever 9H
Standards	EN 60947-5-1
Active principle	mechanical
Enclosure material	Cast iron
Enclosure coating material	painting
Material of the contacts, electrical	Silver
Material of the rod	Steel
Gross weight	342 g

## General data - Features

Number of openers	1
Number of shutters	1

## Mechanical data

Actuating element	Rod lever
Mechanical life, minimum	30,000,000 Operations
Contact opening	2 x 0.5 mm
Actuating speed, minimum	1 mm/min
Actuating torque	0.505 Nm
Repeat accuracy of switching points	0.02

## Mechanical data - Connection technique

Terminal Connector	Screw connection
Cable section, minimum	1.5 mm <sup>2</sup>
Cable section, maximum	2.5 mm <sup>2</sup>
Note (Cable section)	All indications about the cable section are including the conductor ferrules.
Wire cross-section	13 AWG

## Mechanical data - Dimensions

Height of sensor	376 mm
Length of sensor	40 mm
Width of sensor	40 mm
Diameter of the Rod	4 mm

## Ambient conditions

Protection class	IP 65 to IEC/EN 60529
Ambient temperature, minimum	-30 °C
Ambient temperature, maximum	+90 °C
Resistance to shock	50 g / 6 ms

## Ambient conditions - Insulation value

Rated impulse withstand voltage	4 kV
---------------------------------	------

## Electrical data

Thermal test current	6 A
Utilisation category AC-15	230 VAC
Utilisation category AC-15	2.5 A
Switching element	NO contact, NC contact
Note (Switching element)	galvanically separated contact bridges

Switching principle	Snap switch element
Bounce duration, maximum	43,221 ms
Switchover time, maximum	10 ms

## Ordering code

Product type description:

M(1) 330-11Y-(2)-(3)

(1)

<b>S</b>	Plunger S
<b>2S</b>	Telescopic plunger 2S
<b>R</b>	Roller plunger R
<b>K</b>	Offset roller lever K
<b>3K</b>	Angle roller lever 3K
<b>3S</b>	Side plunger 3S
<b>3R</b>	Side roller plunger 3R
<b>AF</b>	Spring rod lever AF
<b>4D</b>	Fork roller level 4D
<b>8H</b>	Roller lever 8H
<b>7H</b>	Roller lever 7H
<b>10H</b>	Rod lever 10H
<b>H</b>	Roller lever H
<b>4H</b>	Spring rod lever on shaft 4H
<b>2H</b>	Leaf spring lever 2H
<b>3H</b>	Roller lever 3H
<b>9H</b>	Rod lever 9H
<b>6H</b>	Leaf spring lever 6H

(2)

<b>without</b>	without LED switching conditions display
<b>G24</b>	with LED switching conditions display

(3)

<b>AuNi</b>	Gold-nickel alloy contacts
<b>1164</b>	Splined shaft and lever available with 10° tothing
<b>1366</b>	For temperatures up to +160°C

## Pictures

## Product picture (catalogue individual photo)



ID: km330f18

| 134,7 kB | .png | 74.083 x 274.461 mm - 210 x 778  
Pixel - 72 dpi

| 248,3 kB | .jpg | 26.649 x 98.769 mm - 320 x 1186  
Pixel - 305 dpi

| 324,5 kB | .jpg | 123.825 x 458.964 mm - 351 x 1301  
Pixel - 72 dpi

## Dimensional drawing basic component

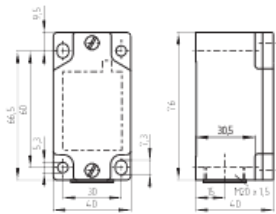

ID: 1m330g01

| 28,1 kB | .jpg | 112.889 x 79.022 mm - 320 x 224  
Pixel - 72 dpi

| 24,6 kB | .cdr |

| 4,0 kB | .png | 74.083 x 51.858 mm - 210 x 147 Pixel  
- 72 dpi

| 107,3 kB | .jpg | 352.778 x 247.297 mm - 1000 x 701  
Pixel - 72 dpi

## Switch travel diagram



ID: km330s02

| 24,7 kB | .jpg | 112.889 x 67.381 mm - 320 x 191  
Pixel - 72 dpi

| 1,4 kB | .png | 74.083 x 52.564 mm - 210 x 149 Pixel  
- 72 dpi

## Diagram



ID: k1o1sk07

| 12,5 kB | .jpg | 112.889 x 46.919 mm - 320 x 133  
Pixel - 72 dpi

| 17,3 kB | .cdr |

## Operating principle



ID: 235hz03

| 15,5 kB | .cdr |

### Dimensional drawing actuator

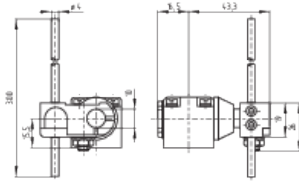

ID: 1m330b18

| 97,8 kB | .jpg | 352.778 x 248.003 mm - 1000 x 703

Pixel - 72 dpi

| 8,4 kB | .png | 74.083 x 52.211 mm - 210 x 148 Pixel  
- 72 dpi

K.A. Schmersal GmbH & Co. KG, Möddinghofe 3, D-42279 Wuppertal

The details and data referred to have been carefully checked. Images may diverge from original. Further technical data can be found in the manual. Technical amendments and errors possible.

Generated on 05.06.2020 11:10:50