

Profibus-DP



Fig.	PIN assignment	Type	Use	Order code	Suitable for encoders
		M12-straight coupling, 5 pins for PROFIBUS-DP cables	Profibus	05.BMWS 8151-8.5	5858, 5860, 5868, 5878, 5888, 9080
		M12-straight connector, 5 pins for PROFIBUS-DP cables	Profibus	05.BMSWS 8151-8.5	5858, 5860, 5868, 5878, 5888, 9080
		M12-right angle coupling, 5 pins for PROFIBUS-DP cables	Profibus	05.BMWS 8251-8.5	5858, 5860, 5868, 5878, 5888, 9080
		M12-right angle connector, 5 pins for PROFIBUS-DP cables	Profibus	05.BMSWS 8251-8.5	5858, 5860, 5868, 5878, 5888, 9080

Characteristics:

Materials:

Body and contact carrier: brass (CuZn), nickel-plated surface

Contact surface: alloy (CuSnZs)

Coupling nuts: nickel-plated brass

Cross section for connector: 0.75 mm², screwed

Temperature: -40 ... +85 °C

Protection acc. to EN 60529: IP 67

Rated voltage/contact: 30 V AC/36 V DC

Rated current/contact: 4 A

Connection diagram:

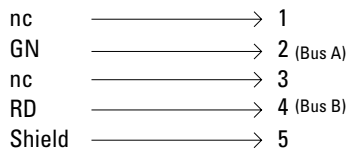

Connection diagram:

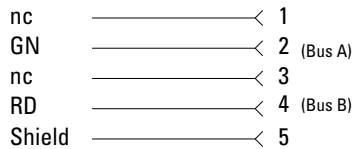

Connector:

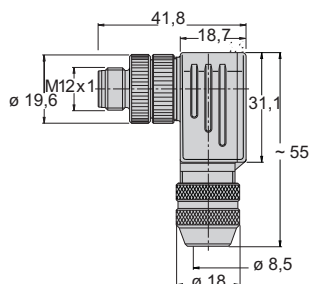
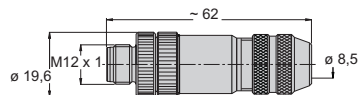

Coupling:

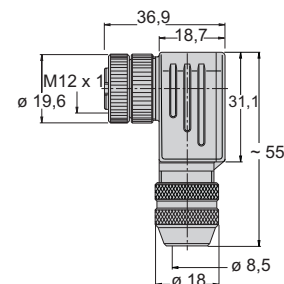
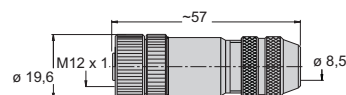

Round connectors series M23x1 female



- Wide choice of connectors
- 9 pins, 12 pins and 17 pins
- Robust construction, metal body
- Pin sockets can be supplied wired clockwise or counter clockwise
- Coupling thread for cables \varnothing 5.5 – 10.5 mm

Round connectors

Order description:

12-pin plug connector
Pin socket assignment cw
Standard-M23-connector
Order code 8.0000.5012.0000
 (Mating connector, suitable for 8.0000.5015.0001)

PIN-assignment:



Dimensions:

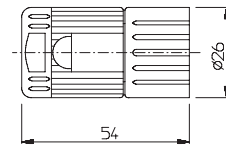

12-pin plug connector
 Pin socket assignment ccw

Order code 8.0000.5012.0001

(Mating connector, suitable for 8.0000.5015.0002)

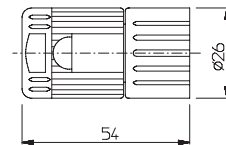
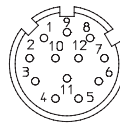

12 pin-coupling
 Pin socket assignment cw

Order code 8.0000.5016.0000

(Mating connector, suitable for 8.0000.5011.0000)

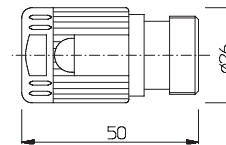
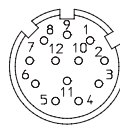

12 pin-coupling
 Pin socket assignment ccw

Order code 8.0000.5016.0001

(Mating connector, suitable for 8.0000.5011.0001)

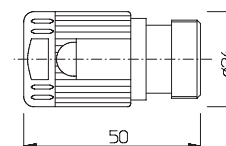
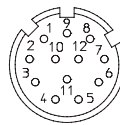

17-pin plug connector
 Pin socket assignment ccw

Order code 8.0000.5042.0000

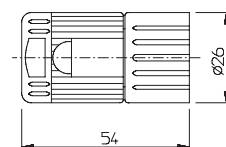
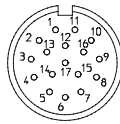

17-pin coupling
 Pin socket assignment ccw

Order code 8.0000.5046.0000

(Mating connector, suitable for 8.0000.5041.0000)

