

REVISIONS				
REV. SYM.	E.C.O. NUMBER	DESCRIPTION	BY DATE	APP'D DATE
1		ORIGINAL RELEASE	DC 5-12-95	DD 5-12-95

**UNCONTROLLED DOCUMENT
WILL NOT BE UPDATED**

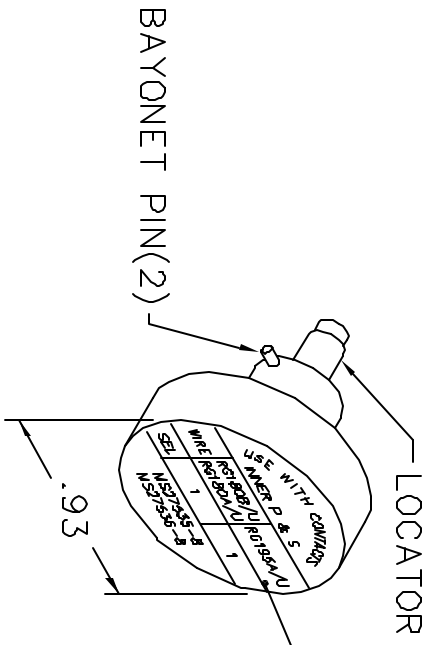
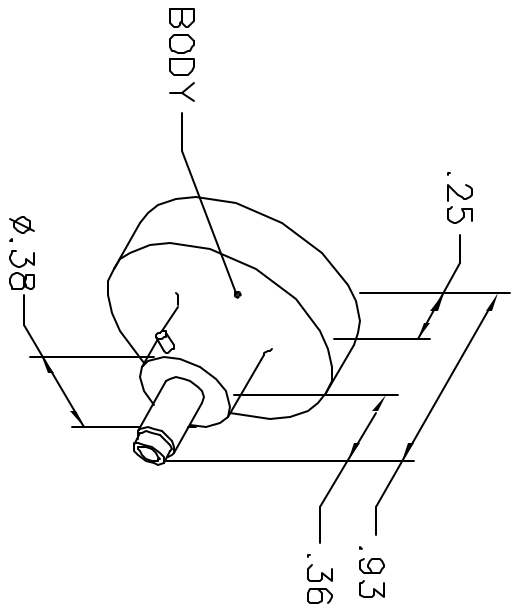

USE WITH CONTACTS			
INNER P & S			
WIRE	RG180B/U	RG195A/U	
SEL	1	1	
	MS275335-8	MS275336-8	

NOTE: FOR USE WITH DANIELS CRIMP TOOLS
ACCOMMODATING "K" SERIES POSITIONERS

LOCATOR	ADDITIONAL FEATURES
HOLE DIMENSIONS	$\perp \phi .078$
	$\perp .024$

RESTRICTED & CONFIDENTIAL

CONFIDENTIAL PROPERTY OF DANIELS MANUFACTURING CORP. NOT TO BE DISCLOSED TO OTHERS, REPRODUCED OR USED FOR ANY OTHER PURPOSE, EXCEPT AS AUTHORIZED IN WRITING BY DANIELS MANUFACTURING. MUST BE RETURNED TO DANIELS MANUFACTURING CORP. ON COMPLETION OF ORDER OR OTHER PURPOSE FOR WHICH LENT.

DO NOT SCALE DRAWING

DRN.	DC	DATE	5-12-95
CHK'D.	DD	DATE	5-12-95
APP'D.		DATE	
APP'D.		DATE	
<p>NOTE: THIS DRAWING IS AN OUTLINE DRAWING OF THE RESPECTIVE DMC PART NUMBER INDICATED. ACTUAL DMC PART NUMBER IS DRAWING NUMBER WITHOUT THE "-ENV" SUFFIX.</p>			
TITLE		ENVELOPE DRAWING POSITIONER	
WHERE USED: AFMB		M22520/2-31	
SIZE	SCALE	CAD P/N	K406-ENV
A	NTS		
POSTING		DWG. NO.	K406-ENV
		SHEET	1 OF 1
		REV.	1



DANIELS MANUFACTURING CORP.
ORLANDO, FLORIDA
CAGE 11851