

NH000 gG 100A/500V



Specifications

ETI Code	004181214
Description	NH000 gG 100A/500V
Weight	120
Level	Fuse links NH gG up to AC 690V
Rated current (A)	100
Type	NH
Size	NH000
Characteristics	gG
Rated AC voltage (V)	500
Indicator	Combination fuse status indicator
Breaking capacity AC (kA)	120
Power dissipation (W)	6,6
Standards	IEC 60269-1, IEC 60269-2
Operating joule integral (A2s)	141.000
Prearcing joule integral (A2s)	25.000
Application	For cable protection
Application	For cable protection
Prearcing joule integral (A2s)	25.000
Power dissipation (W)	6,6
Operating joule integral (A2s)	141.000
Indicator	Combination fuse status indicator
Breaking capacity AC (kA)	120
Standards	IEC 60269-1, IEC 60269-2

Online product page [🔗](#)

Other documentation



[Technical data catalogue](#)
[3D Model](#)
[EU declaration](#)



ETIM international classification

Application	For cable protection
Voltage type	
Nominal rated current	100A
Nominal rated voltage	V
Rated switching capacity	kA
Construction size	NH000
Type of fuse status indicator	Combination fuse status indicator

Breaking capacity	120
Max. rated operation voltage Ue AC	500
Rated voltage AC	500
Insulated metal gripping lugs (IMGL)	

Melting energy characteristics

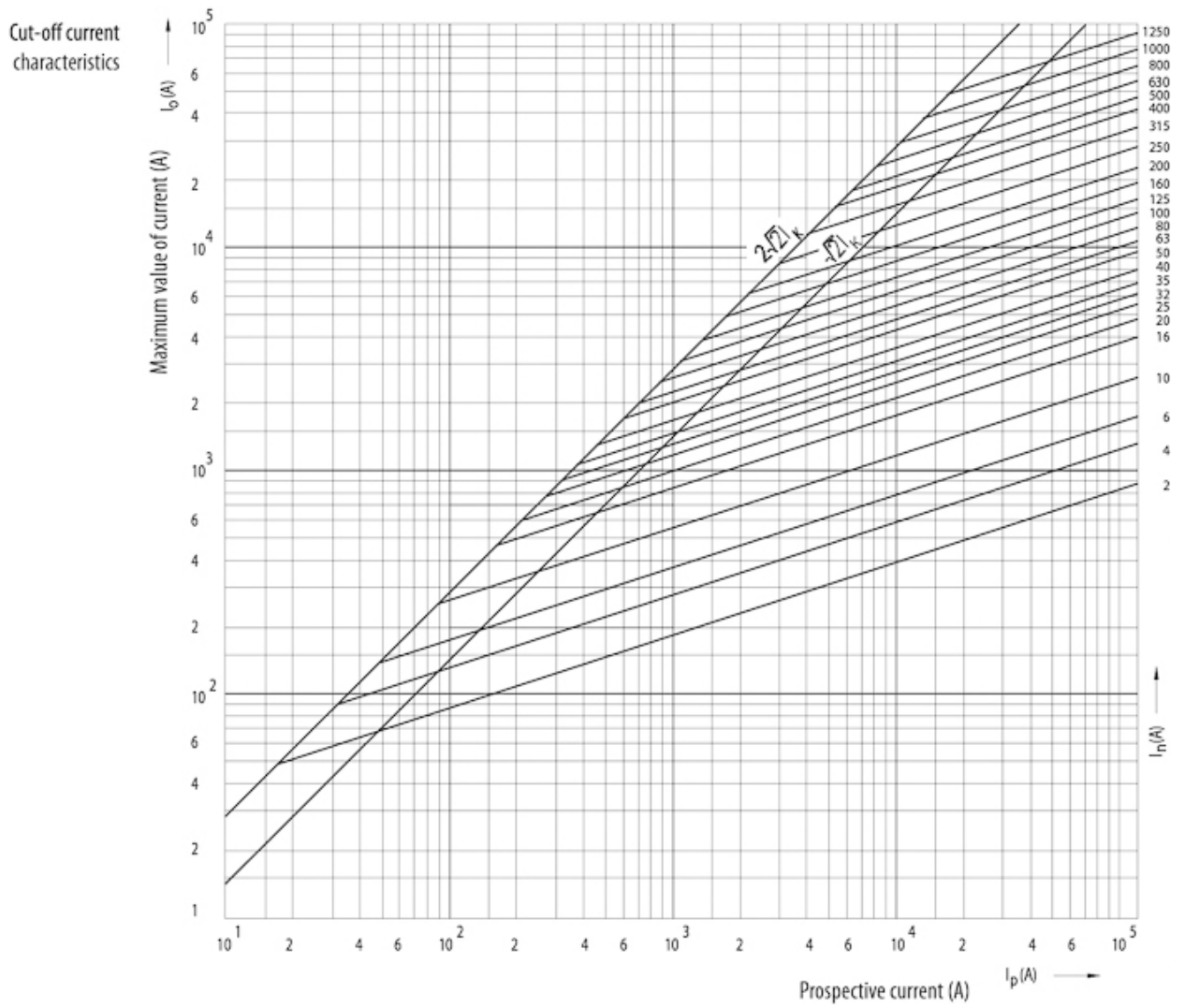

Time current characteristics



Dimension drawing

	A	B	C	D	E	F	G	H	I	J	K	
NV00C	79	53	47	35	15	21	52	7,5			6	kombi
NV00C I	79	53	47	35	15	21	52	7,5			6	kombi
NV00	79	53	47	35	15	28	56	12			6	kombi
NV00 I	79	53	47	35	15	28	56	12			6	kombi
NV0	125	68	65	35	15	28	56	12			6	kombi
NV1C	135	68	65	40	15	28	61	12			6	kombi
NV1C I	135	68	65	40	15	28	61	12			6	kombi
NV1	135	72	65	40	20	46	65	14			6	kombi
NV1 I	135	72	65	40	20	46	65	14			6	kombi
NV2C	150	72	65	48	20	46	73	14			6	kombi
NV2C I	150	72	65	48	20	46	73	14			6	kombi
NV2	150	72	65	48	26	54	73	14			6	kombi
NV2 I	150	72	65	48	26	54	73	14			6	kombi
NV3C	150	72	65	60	26	54	84	14			6	kombi
NV3	150	72	65	60	33	65	84	14			6	kombi
NV4	200	75	66	87	50	100	121	24	150	16	8	
NV4a	200	99	87	85	50	95	121	27			6	
NV4a SI*	200	99	87	85	50	95	121	27			6	
NV1/1000V	155	90	87	40	20	45	59	9			6	

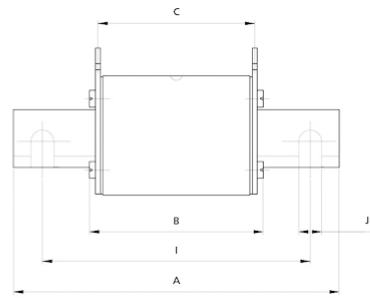

	Striker pin			
	K	L	M	S1
00C	0	20.7	16.7	7.5
00	0	20.7	16.7	7.5
1	13.7	19.7	25	12
2	16.2	27.4	25	12
3	17	35.6	25	12
4a	24	49	25	12

