

CRM25

SINGLE PHASE CAPACITORS



U _e	Hz	U _{MAX1}
230V	50/60	250V
400V	50/60	440V
460V	50/60	500V
550V	50/60	600V
690V	50/60	750V
750V	50/60	825V
850V	50/60	900V

Generalities

- Metallic case with protection degree IP00 (other on request)
- An inside overpressure protection system
- Resin or oil impregnation

All components inside these products are compliant with Safety Regulations.



CRM25
CRM25 3In

TECHNICAL CHARACTERISTICS

Rated voltage	U _e = 230 ÷ 850V
Rated frequency	50/60Hz
Max current overload I _n	1.3xI _n (CRM25)
Max voltage overload V _n	3xI _n (CRM25 3In)
Insulating voltage	1.1xV _n
	3/15kV
	U _e ≤ 660V
Temperature range	-25/D
Capacitance tolerance	-5÷+10%
Terminal voltage test	2.15xV _n per 10 sec.
Structural typology	metallized polypropylene (CRM25)
	bimetalized paper (series CRM25 3In)
Capacitors standards	CEI EN 60831-1/2

	CODE	RATED VOLTAGE	MAX. VOLTAGE	POWER	POWER	CAPACITANCE	DIMENSIONS
		U _e (V)	U _{MAX} (V)	50Hz (kvar)	60Hz (kvar)	(µF)	
CRM25	CRM25-11B-0,41-230	230	250	0.41	0.5	25	1
	CRM25-11B-0,83-230	230	250	0.83	1	50	2
	CRM25-11A-1,66-230	230	250	1.66	2	100	4
	CRM25-11A-0,83-400	400	440	0.83	1	16.6	1
	CRM25-11B-1,04-400	400	440	1.04	1.25	20.7	1
	CRM25-11C-1,66-400	400	440	1.66	2	33.3	3
	CRM25-11B-2,08-400	400	440	2.08	2.5	41.4	3
	CRM25-11A-3,33-400	400	440	3.33	4	66.6	4
	CRM25-11A-4,16-400	400	440	4.16	5	82.7	4
	CRM25-11B-0,83-460	460	500	0.83	1	12.5	2
	CRM25-11B-1,66-460	460	500	1.66	2	25	3
	CRM25-11B-3,33-460	460	500	3.33	4	50	4
	CRM25-11B-3,72-460	460	500	3.72	4.5	56	4
	CRM25-11B-0,83-550	550	600	0.83	1	8.7	1
	CRM25-11A-1,66-550	550	600	1.66	2	17.5	2
CRM25-11A-3,33-550	550	600	3.33	4	35	4	
CRM25 3In	CRM25-11A-2,5-400	400	440	2.5	3	50	4
	CRM25-11A-2,5-460	460	500	2.5	3	37	4
	CRM25-11A-2,5-550	550	600	2.5	3	26	4
	CRM25-11A-2,5-690	690	750	2.5	3	16.7	4
	CRM25-11A-2,5-750	750	825	2.5	3	14.2	4
CRM25-11A-2,5-850	850	900	2.5	3	11	4	

1 Maximum allowed value according to CEI EN 60831-1 art. 20.1



U _e	Hz	U _{MAX1}
230V	50/60	250V
400V	50/60	440V
415V	50/60	450V
440V	50/60	480V
460V	50/60	500V
525V	50/60	580V

Generalities

- Metallic case with protection degree IP20
- An inside overpressure protection system
- Resin impregnation (oil impregnation on request)

All components inside these products are compliant with Safety Regulations.



CRT



CRT
Reinforced Dielectric

TECHNICAL CHARACTERISTICS

Rated voltage	U _e = 230 ÷ 525V
Rated frequency	50/60Hz
Max current overload I _n	1.3xI _n
Max voltage overload V _n	1.1xV _n
Insulating voltage	3/15kV U _e ≤ 660V
Temperature range	-25/D
Capacitance tolerance	-5 ÷ +10%
Terminal voltage test	2.15xV _n per 10 sec.
Dielectric	metallized polypropylene
Capacitors standards	CEI EN 60831-1/2

CODE	RATED VOLTAGE	MAX. VOLTAGE	POWER 50Hz (kvar)	POWER 60Hz (kvar)	CAPACITANCE (µF)	DIMENSIONS
	U _e (V)	U _{MAX} (V)				
CRT-78N-2.5-230	230	250	2.5	3	3x50	11
CRT-80N-5-230	230	250	5	6	3x100	13
CRT-81N-7.5-230	230	250	7.5	9	3x150	14
CRT-82N-10-230	230	250	10	12 ²	3x200	15
CRT-78N-2.5-400	400	440	2.5	3	3x16.5	11
CRT-78N-5-400	400	440	5	6	3x33	11
CRT-79N-7.5-400	400	440	7.5	9	3x50	12
CRT-80N-10-400	400	440	10	12	3x66	13
CRT-81N-12.5-400	400	440	12.5	15	3x83	14
CRT-82N-15-400	400	440	15	18	3x100	15
CRT-82N-20-400	400	440	20	24 ²	3x133	15
CRT-85N-25-400	400	440	25	30 ²	3x166	16



	CODE	RATED VOLTAGE U _e (V)	MAX. VOLTAGE U _{MAX} (V)	POWER 50Hz (kvar)	POWER 60Hz (kvar)	CAPACITANCE (μF)	DIMENSIONS
CRT	CRT-78N-2.5-415	415	450	2.5	3	3x15.5	11
	CRT-78N-5-415	415	450	5	6	3x31	13
	CRT-79N-7.5-415	415	450	7.5	9	3x46	12
	CRT-80N-10-415	415	450	10	12	3x62	13
	CRT-81N-12.5-415	415	450	12.5	15	3x77	14
	CRT-82N-15-415	415	450	15	18	3x92	15
	CRT-82N-20-415	415	450	20	24 ²	3x123	15
	CRT-85N-25-415	415	450	25	30 ²	3x154	16
	CRT-86N-30-415	415	450	30	36	3x185	18
	CRT-78N-2.5-440	440	480	2.5	3	3x14	11
	CRT-78N-5-440	440	480	5	6	3x27.5	13
	CRT-79N-7.5-440	440	480	7.5	9	3x41	12
	CRT-80N-10-440	440	480	10	12	3x55	13
	CRT-81N-12.5-440	440	480	12.5	15	3x68.5	14
	CRT-82N-15-440	440	480	15	18	3x82	15
	CRT-82N-20-440	440	480	20	24 ²	3x110	15
	CRT-85N-25-440	440	480	25	30 ²	3x137	16
	CRT-78N-5-460	460	500	5	6	3x12.5	11
	CRT-79N-7.5-460	460	500	7.5	9	3x25	11
	CRT-80N-10-460	460	500	10	12	3x37.5	12
	CRT-81N-12.5-460	460	500	12.5	15	3x50	13
	CRT-82N-15-460	460	500	15	18	3x63	14
	CRT-82N-20-460	460	500	20	24 ²	3x75	15
	CRT-85N-25-460	460	500	25	30 ²	3x100	15
	CRT-78N-5-460	460	500	5	6	3x125.4	16
	CRT-78N-2.5-525	525	580	2.5	3	3x9.5	11
	CRT-78N-5-525	525	580	5	6	3x19	13
	CRT-79N-7.5-525	525	580	7.5	9	3x29	12
	CRT-80N-10-525	525	580	10	12	3x38.5	13
	CRT-81N-12.5-525	525	580	12.5	15	3x48	14
	CRT-82N-15-525	525	580	15	18	3x58	15
	CRT-82N-20-525	525	580	20	24	3x77	15
CRT-85N-25-525	525	580	25	30	3x96	16	
CRT Reinforced Dielectric	CRT-78N-2.5-415RD	415	450	2.5	3	3x15.5	11
	CRT-78N-5-415RD	415	450	5	6	3x31	11
	CRT-80N-7.5-415RD	415	450	7.5	9	3x46	13
	CRT-81N-10-415RD	415	450	10	12	3x62	14
	CRT-82N-12.5-415RD	415	450	12.5	15	3x77	15
	CRT-85N-12.5-415RD	415	450	12.5	15	3x77	16
	CRT-82N-15-415RD	415	450	15	18	3x92	15
	CRT-85N-15-415RD	415	450	15	18	3x92	16
	CRT-84N-20-415RD	415	450	20	24 ²	3x123	17
	CRT-86N-25-415RD	415	450	25	30 ²	3x154	18

1 Maximum allowed value according to CEI EN 60831-1 art. 20.1
2 Temperature range -40/B

DIMENSIONS

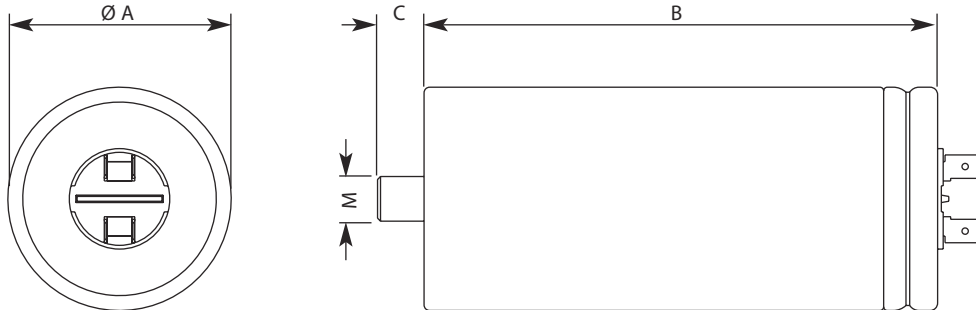

DRAWING	Ø A	B	C	M
1	40	103	10	8
2	45	128	10	8
3	55	128	12.5	12
4	60	138	12.5	12

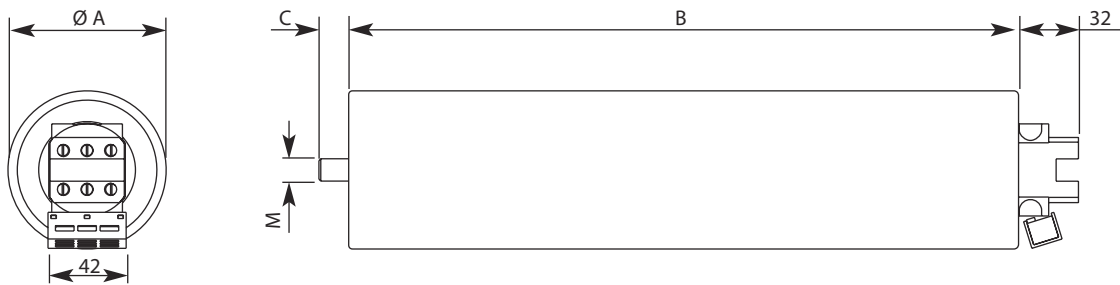

DRAWING	Ø A	B	C	M
11	75	210	16	12
12	75	247	16	12
13	85	247	16	12
14	85	285	16	12
15	85	360	16	12
16	100	295	16	12
17	100	370	16	12
18	120	305	16	12

Dimensions in mm