

Pushbutton Switches

Sub-Miniature



Specifications:

Contact rating	: Dependent upon contact material
Mechanical life	: 50,000 make-and-break cycles
Maximum contact resistance	: 20mΩ initial at 2 to 4V DC 100mA for both silver and gold plated contacts
Minimum insulation resistance	: 1,000MΩ
Dielectric strength	: 1,000V RMS at sea level
Operating temperature	: -30°C to +85°C

Materials:

Case	: Diallyl phthalate (DAP)
Plunger	: Thermoplastic Polyester-black
Bushing	: Brass, Nickel Plated
Housing	: Stainless steel
Contact	: Silver or Gold Plated
Terminal	: Brass, Silver Plated
Terminal support	: Brass, Tin Plated

Switch Function

Number of Poles	Model Number	Switch Function		Connected Terminals / Schematic	
		Position 1	Position 2	Position 1	Position 2
SP	T Ô8BS8	ON	MOM	2-1 	2-3
	T Ô8BS9	OFF	MOM	Open	1-3
DP	T Ô8MD9	OFF	MOM	Open	1-3, 4-6

MOM = Momentary



Pushbutton Switches

Sub-Miniature



Pole Options

SPDT

MC8MS9P1B05M1QE

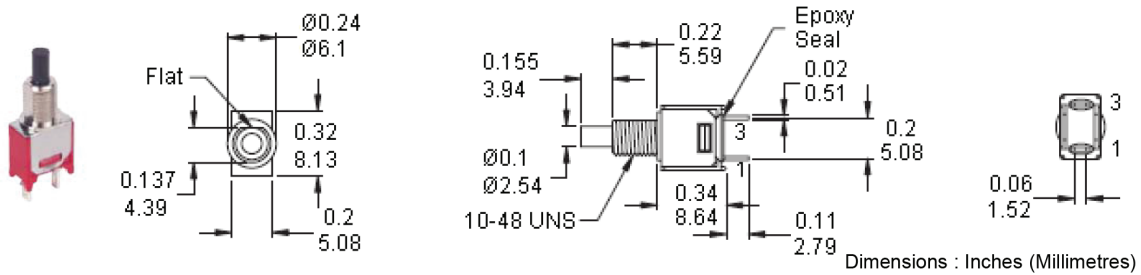

SPDT

MC8MS8P1B05M1QES

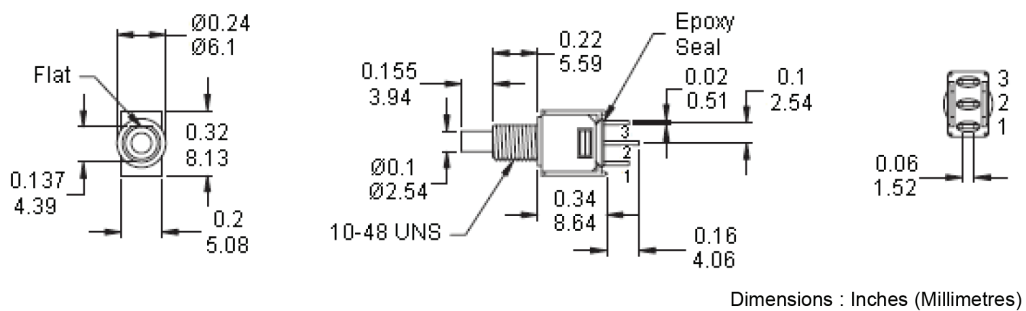

SPST

MC8MS9P1B06M6RES

PC Mounting

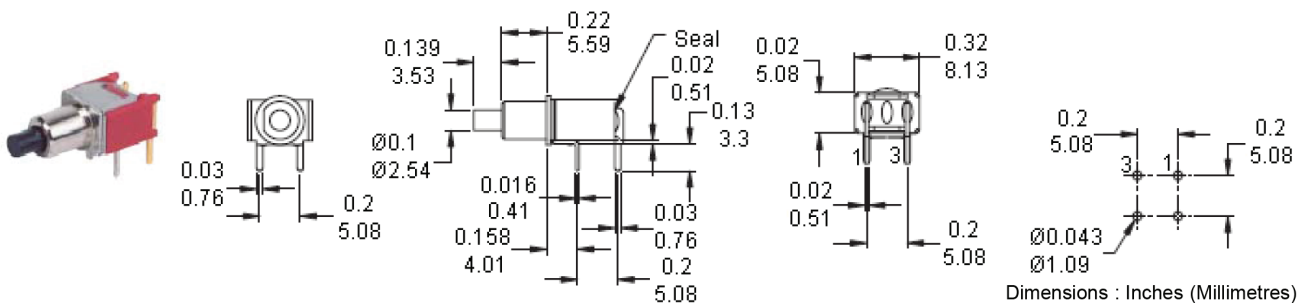

SPST

MC8MS9P1B06M7QES

PC Mounting

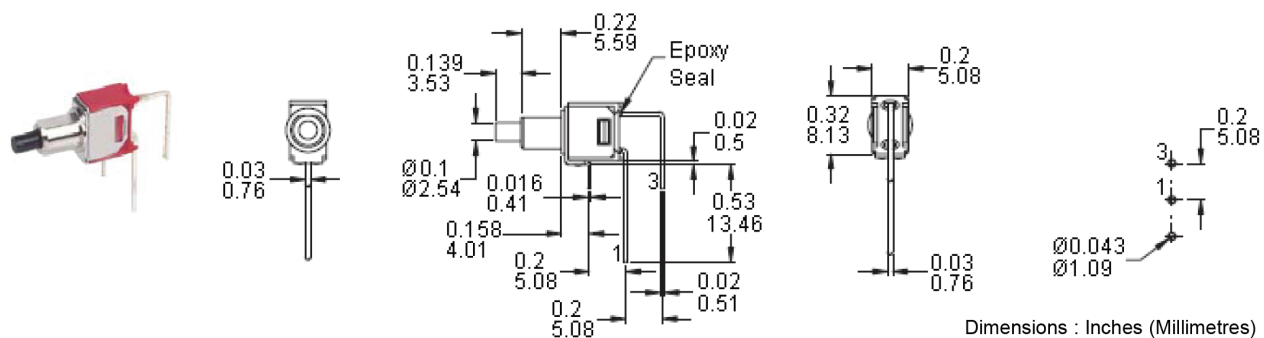

Pushbutton Switches

Sub-Miniature



SPDT

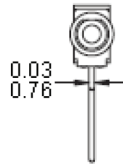

MC8MS8P1B06M7QES

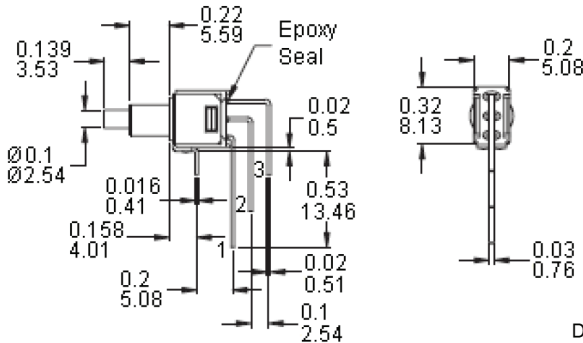

PC Mounting

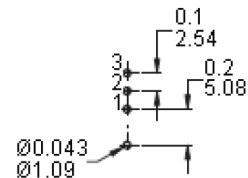

Dimensions : Inches (Millimetres)

SPST

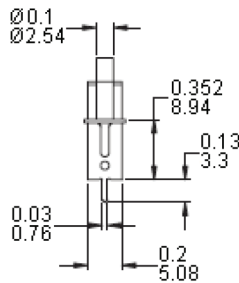

MC8MS9P1B06VS2QES

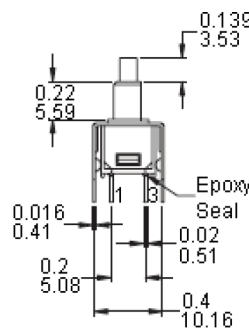

PC Mounting

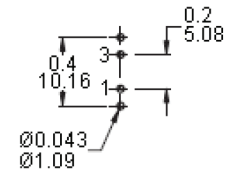

Dimensions : Inches (Millimetres)

SPDT

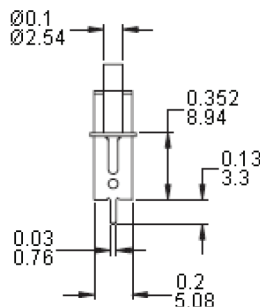

MC8MS9P1B06VS2QES

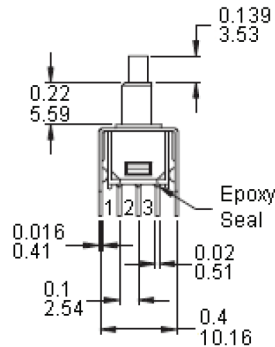

PC Mounting

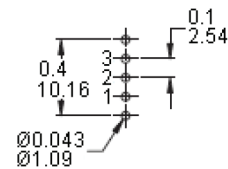

Dimensions : Inches (Millimetres)

Switch Function

Number of Poles	Model Number	Switch Function		Connected Terminals / Schematic	
		Position 1	Position 2	Position 1	Position 2
SP	MC8MSL	ON	ON	2-1 NC 1 • 2 (Comm) • 3 NO	2-3 NC 1 • 2 (Comm) • 3 NO



Pushbutton Switches

Sub-Miniature



Pole Options

SPDT

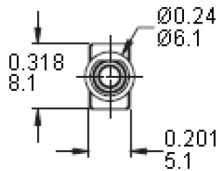

MC8MSLP1B05M1QES-5

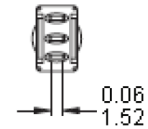
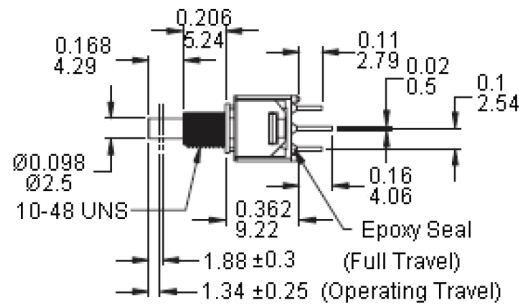

Dimensions : Inches (Millimetres)

SPDT

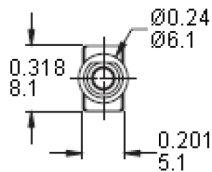

MC8MSLP1B05M2QES

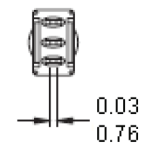
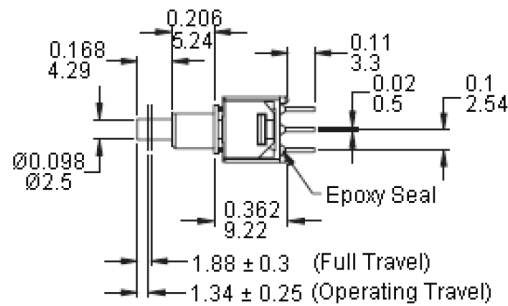

Dimensions : Inches (Millimetres)

SPDT

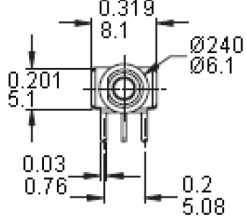

MC8MSLP1B06M6RES

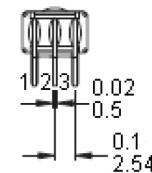
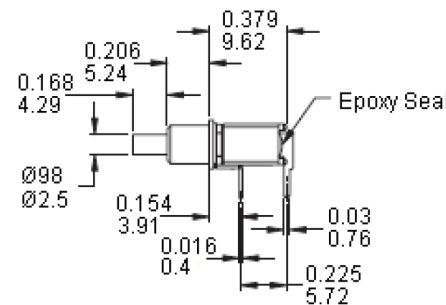

PC Mounting

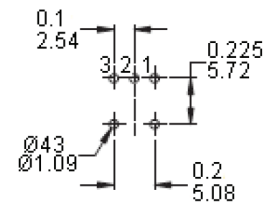

Dimensions : Inches (Millimetres)

SPDT

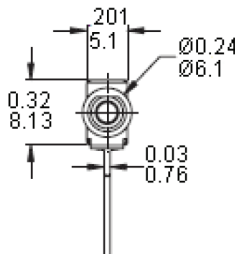

MC8MSLP1B06M7QES

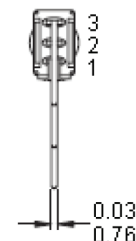
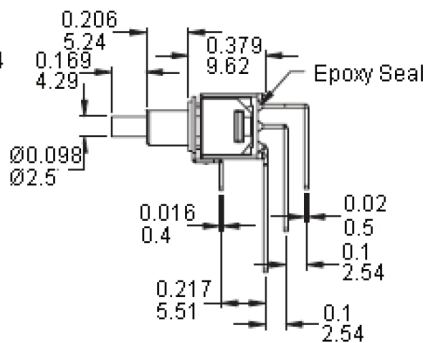

PC Mounting

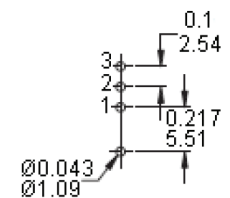

Dimensions : Inches (Millimetres)

Pushbutton Switches

Sub-Miniature



SPDT

MC8MSLP1B06VS2QES

PC Mounting

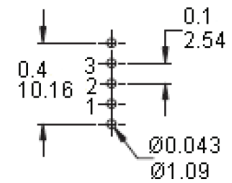
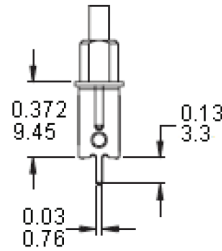
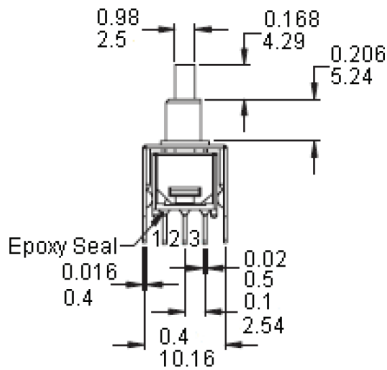

Dimensions : Inches (Millimetres)

AP1

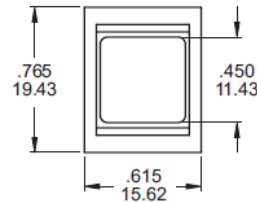
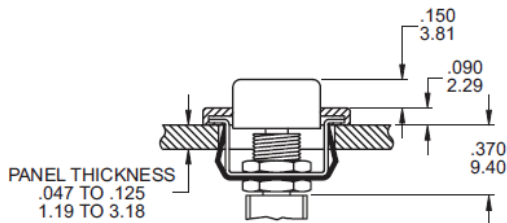

PANEL MOUNTING

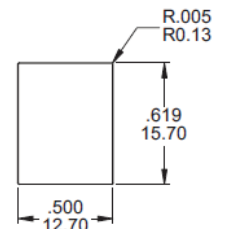

Part No. Shown : 8MS9AP1M1QE

Dimensions : Inches (Millimetres)

Bushing Options

B05 THD

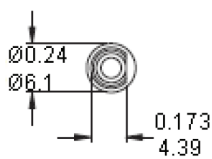

B06 NON-THD

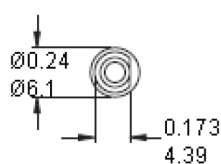

B10

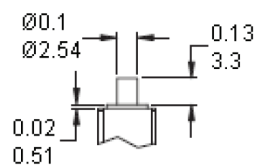
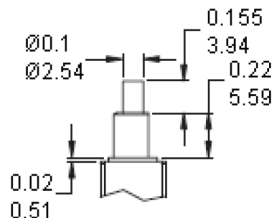
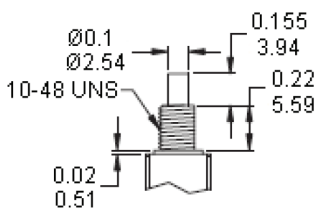
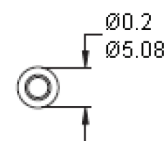

Dimensions : Inches (Millimetres)



Pushbutton Switches

Sub-Miniature



Termination Options

M1 Solder LUG

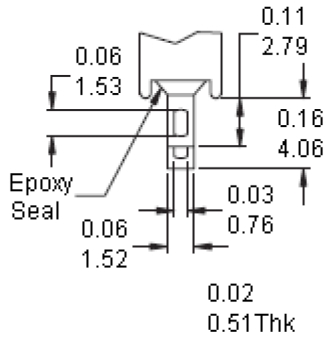

M2 PC Mounting

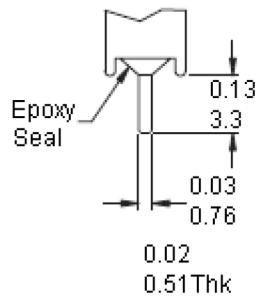

Dimensions : Inches (Millimetres)

Other Termination Options

M6 = Right Angle PC Mount

M7 = Right Angle PC Mount

VS2 = Vertical Bracket PC Mount

Bushing Options

B05 THD

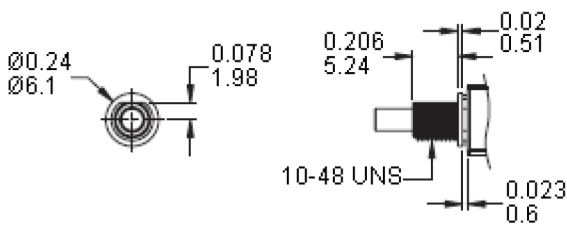

Dimensions : Inches (Millimetres)

B06 NON-THD

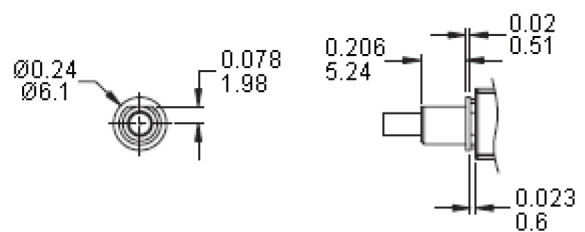

Dimensions : Inches (Millimetres)

Termination Options

M1 Solder LUG

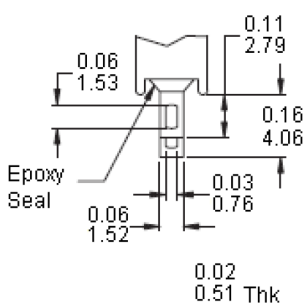

Dimensions : Inches (Millimetres)

M2 PC Mounting

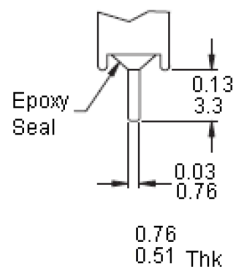

Dimensions : Inches (Millimetres)



Pushbutton Switches

Sub-Miniature



Other Termination Options

M6 = Right Angle PC Mount

M7 = Right Angle PC Mount

VS2 = Vertical Bracket PC Mount

Contact Material Options

	Contact Plating	Terminal Plating	Ratings
Q	Silver	Q = Silver	3 Amperes with resistant load at 120V ac or 28 V dc 1 Ampere with resistant load at 250 V ac
R	Gold	R = Gold	0.4 Volt - Amperes (VA) maximum at 20 V maximum (ac or dc)

Soldering Process:

Manual soldering : Use soldering iron of 30 watts, controlled at 350°C approximately 5 seconds while applying solder

Wave soldering : Recommended soldering temperature : 260 ±5°C

Duration of solder immersion : Maximum 5 seconds (PCB is 1.6 mm in thickness)

Part Number Table

Description	Part Number
Switch, SPDT, Off-MOM, Solder	MC8MS9P1B05M1QE
Switch, SPDT, On-MOM, Solder	MC8MS8P1B05M1QES
Switch, DPDT, Off-MOM, PCB	MC8MD9P1B10M2RES
Switch, SPST, Off-MOM, Right / Angle	MC8MS9P1B06M6RES
Switch, DPDT, Off-MOM, Right / Angle	MC8MD9P1B10M6RES
Switch, SPST, Off-MOM, Vert Right / Angle	MC8MS9P1B06M7QES
Switch, SPDT, On-MOM, Vert Right / Angle	MC8MS8P1B06M7QES
Switch, SPST, Off-MOM, V-Bracket	MC8MS9P1B06VS2QES
Switch, SPDT, On-MOM, V-Bracket	MC8MS8P1B06VS2QES
Switch, SPDT, Off-MOM, Solder	MC8MS9AP122M1QES
Switch, SPDT, On-On, Solder	MC8MSLP1B05M1QES-5
Switch, SPDT, On-On, PCB	MC8MSLP1B06M2QES
Switch, SPDT, On-On, Right / Angle	MC8MSLP1B06M6RES
Switch, SPDT, On-On, Vert Right / Angle	MC8MSLP1B06M7QES
Switch, SPDT, On-On, V-Bracket	MC8MSLP1B06VS2QES

www.element14.com

www.farnell.com

www.newark.com



Pushbutton Switches

Sub-Miniature



Part Number Explanation:

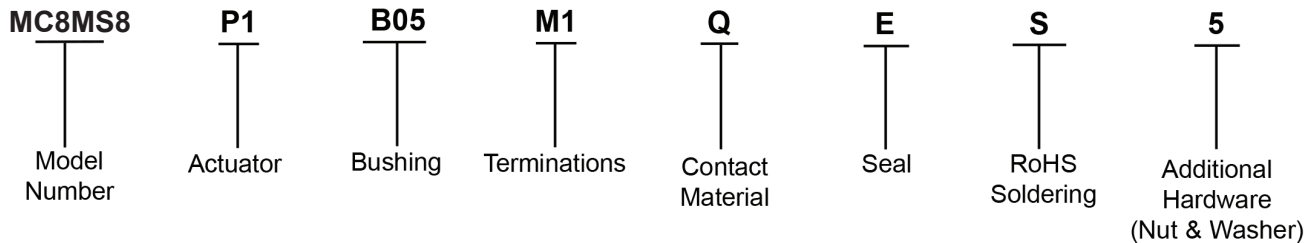

- | | |
|--------------------------------|--|
| Model Number | : 8MS8 = On-Mom, 8MS9 = Off-Mom and 8MSL = On-On |
| Actuator | : P1 = 3.94 high |
| Bushing | : B05 = 5.59 high, flat (thd), B06 = 5.59 high, flat (non-thd) and B10 = 3.30 high |
| Frame Colour / Actuator Colour | : 22 = Black (Standard) |
| Terminations | : M1 = Solder Lug, M2 = PC thru-hole, M6 = Right angle, PC thru-hole, M7 = Vertical right angle, PC thru-hole and VS2 = 8.94 high, V-bracket |
| Contact Material | : Q = Silver, R = Gold |
| Seal | : E = Epoxy (std) |
| RoHS Soldering | : S = RoHS and Lead Free |

Important Notice : This data sheet and its contents (the "Information") belong to the members of the Premier Farnell group of companies (the "Group") or are licensed to it. No licence is granted for the use of it other than for information purposes in connection with the products to which it relates. No licence of any intellectual property rights is granted. The Information is subject to change without notice and replaces all data sheets previously supplied. The Information supplied is believed to be accurate but the Group assumes no responsibility for its accuracy or completeness, any error in or omission from it or for any use made of it. Users of this data sheet should check for themselves the Information and the suitability of the products for their purpose and not make any assumptions based on information included or omitted. Liability for loss or damage resulting from any reliance on the Information or use of it (including liability resulting from negligence or where the Group was aware of the possibility of such loss or damage arising) is excluded. This will not operate to limit or restrict the Group's liability for death or personal injury resulting from its negligence. Multicomp is the registered trademark of the Group. © Premier Farnell plc 2012.