

# Rotary Switches Type 07R

## Horizontal

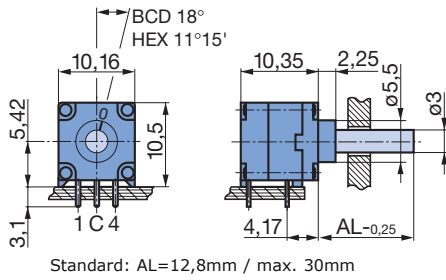

## Front-panel operation

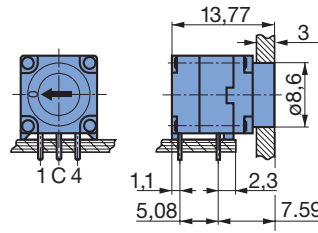

## Drilling diagram View from component side

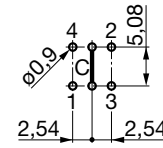

## Horizontal for panel mounting

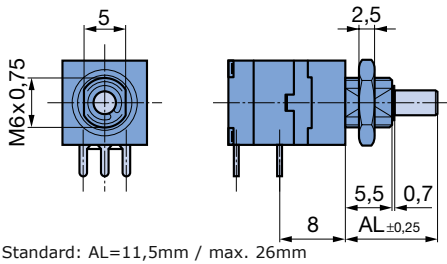

Panel mounting waterproof  
O-Ring and nut supplied

## Front-panel cut out

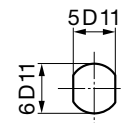

## Vertical

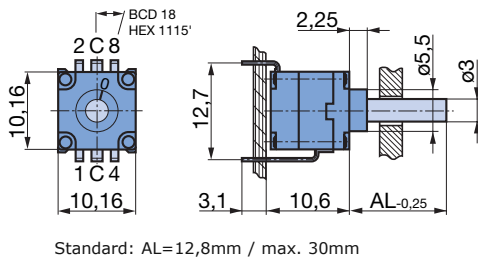

## Drilling diagram View from component side

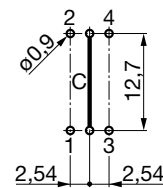

## Vertical for panel mounting

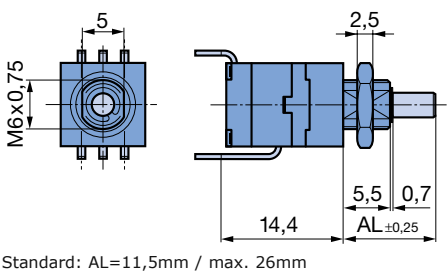

Panel mounting waterproof  
O-Ring and nut supplied

## Front-panel cut out

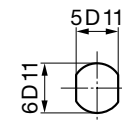

## Description

Rotary switch in horizontal or vertical version.  
Operation by screwdriver or stainless steel shaft (knob).  
Precise position indexing and long life performance.

Sealed and washable.

Solid tinned terminals  
(0,4 x 0,7 mm)

Terminations for direct mounting on  
circuit boards 2.54 mm (0.1") pitch

Indexing positions, end stop  
4 positions with indexing angle 36°,  
additional 0 (inactive) position  
available on request

Leadfree reflow version available  
on request

# Rotary Switches Type 07R

## Technical information

### Mechanical data

*Indexing mechanism*  
36°

*Switching torque*  
2,2 Ncm ± 25%  
(standard)  
3,5 Ncm ± 25%  
(on request)

*Admissible moment of the end-stop*  
45 Ncm

*Panel mounting*  
admissible torque max. 100 Ncm

*Temperature range*  
Storage temperature:  
- 40 °C to + 85 °C  
Operating temperature:  
- 25 °C to + 85 °C

*Life*  
> 40000 switching cycles  
(> 320000 switching positions)

### Material data

*Case*  
high quality temperature-resistant  
thermoplastic

*Spindle-shaft*  
stainless steel

*Insulation*  
high quality thermoplastic

*Contact parts*  
alloy copper > 3 µm gold plated

### Soldering data

*Handsoldering*  
Plastic wafer ≤ 5 s/≤ 260 °C

*Machine soldering*  
Wave ≤ 5 s/≤ 260 °C  
Reflow (THR) ≤ 5 s/≤ 260 °C  
(on request)  
Lead free reflow (on request)

### Electrical data

*Application data*  
Voltage < 42 V

*Switching capacity*  
5 VA

*Switching voltage (resistive load)*  
≤ 42 V

*Switching current (resistive load)*  
≤ 0,2 A

*Test voltage at 50 Hz/1 min*  
≥ 500 V ~

*Insulation resistance at 500 V*  
= 1 min  
≥ 10<sup>11</sup> Ω

*Contact resistance*

< 50 mΩ in new condition

### Various

*Assembled in clean room*  
Class 100 000, US Federal Standard

Sealed and washable

*IP protection degree*  
up to IP 68 (2bar) sealable

## Ordering option

To order a special option please use the order form.  
Please specify your requirements and fax it to your local contact or to Elma.

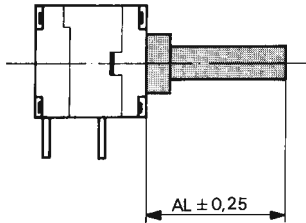

## Special shaft length

Please state length AL (see diagram) measured from mounting face when ordering (max. AL = 30 mm)  
Specify spindle length on order form.

## Panel mounting / waterproof version M6 x 0.75

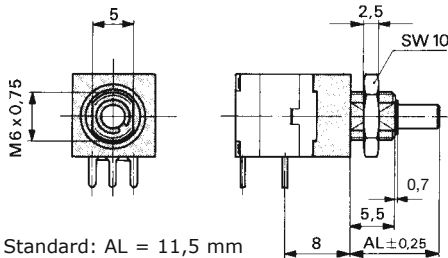

This standard option made of die cast allows central mounting plus shaft and panel seal. Shaft diameter is 3 mm.  
Max. admissible tightening torque for nuts 100 Ncm

*Order examples*  
ZB  
ZB/WD (for waterproof option)

Waterproof up to 2 bar (IP 68)

Please complete order form.

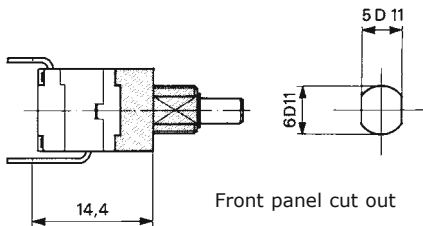

Panel mounting waterproof  
O-Ring and nut supplied

## Adjustable stops

Adjustable stops can be set during assembly only.  
Please complete order form.

## Special types of shaft

Specially machined shafts are available. For orders a sketch or drawing is required.  
Please specify dimensions on order form.

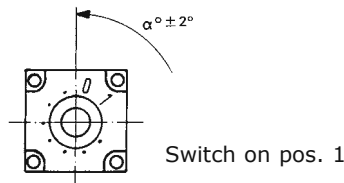
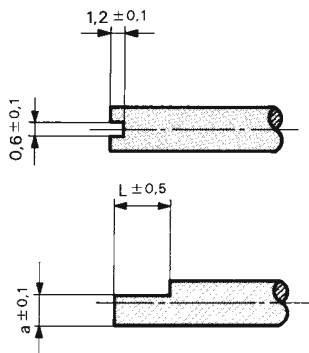

## Shortened bushing

Please state dimension B  
Dimension B = min. 3,5 mm / max. 5,5 mm  
Specify dimensions on order form.

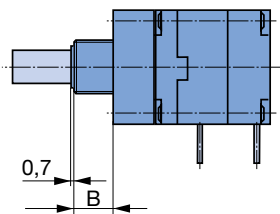

# Ordering code to Type 07R

This code specifies the function of the switch.

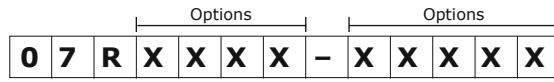

Switch type

- 0 = horizontal (screwdriver actuation)
- 1 = horizontal with shaft
- 2 = vertical (screwdriver actuation)
- 3 = vertical with shaft
- 4 = horizontal FKS  
(Front panel operation)

- 2 = 2 positions (1-2)
- 3 = 3 positions (1-3)
- 4 = 4 positions (1-4)
- 5 = 5 positions (on request, 0-4)

- 1 = 1 pole beginning at position 0  
(on request)
- 2 = 1 poles beginning at position 1  
(standard)

- 3 = shorting
- 4 = non-shorting

- 000 = Standard AL 12,8
- XXX = AL (shaft length)  
z. B. AL 10,5 mm = 105

- 00 = Standard
- 20 = ZB (panel mounting)
- 30 = ZB / WD  
(panel mounting / waterproof)

- = Standard
- V = Anti-static package
- T = 3,5 Ncm torque
- S = 3,5 Ncm torque and  
anti-static package

- AL = Shaft length
- ZB = Panel mounting
- WD = Waterproof
- FKS = Front-panel operation

