

GENERAL CHARACTERISTICS

Instruments operate by a spring-supported paddle with magnetic triggering of a micro switch.

- * good repeatability
- * low pressure loss
- * dirt resistant
- * hermetic separation of electrical and hydraulic components
- * high switch capability

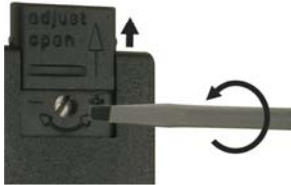

Female thread G3/8 to G2 brass/stainless steel



UM3K-015GM065

TECHNICAL DATA

	G	Type	PN bar	Qmax. recom. l/min H ₂ O	adjustable range l/min H ₂ O	H mm	L mm	X mm	weight kg
brass	G 3/8	UM3K-010GM055	25	10	4 - 5.5	87	50	10	0.35
	G 1/2	UM3K-015GM070	25	20	5.5 - 7	87	50	10	0.35
	G 3/4	UM3K-020GM100	25	40	7.5 - 10	88	50	12	0.35
	G 1	UM3K-025GM180	25	60	14 - 18	92	50	12	0.40
	G 1 1/4	UM3K-032GM300	25	80	22 - 30	96	50	12	0.55
	G 1 1/2	UM3K-040GM500	25	100	37 - 50	99	50	12	0.60
	G 2	UM3K-050GM930	25	150	67 - 93	108	50	12	1.00
stainless steel	G 3/8	UM3K-010GK055	25	10	4 - 5.5	87	50	10	0.40
	G 1/2	UM3K-015GK070	25	20	5.5 - 7	87	50	10	0.41
	G 3/4	UM3K-020GK100	25	40	7.5 - 10	88	50	12	0.35
	G 1	UM3K-025GK180	25	60	14 - 18	92	50	12	0.45
	G 1 1/4	UM3K-032GK300	25	80	22 - 30	96	50	12	0.55
	G 1 1/2	UM3K-040GK500	25	100	37 - 50	99	50	12	0.70
	G 2	UM3K-050GK930	25	150	67 - 93	108	50	12	1.00

Adjustable range is indicated for horizontally decreasing flow.

tolerance	±15% of full scale
media temperature	max. 110°C
average pressure loss	0.01bar at Qmax.
hysteresis	depending on switch value minimum 0.7 l/min.

MATERIALS

	UM3K-...GM	UM3K-...GK
housing	brass Ms58 nickel plated	stainless steel 1.4305
body	brass Ms58 nickel plated	stainless steel 1.4571
paddle	stainless steel 1.4301 ; 1.4571	stainless steel 1.4301 ; 1.4571
spring	stainless steel 1.4310	stainless steel 1.4310
magnet	oxyd 300	oxyd 300
seal	NBR	viton

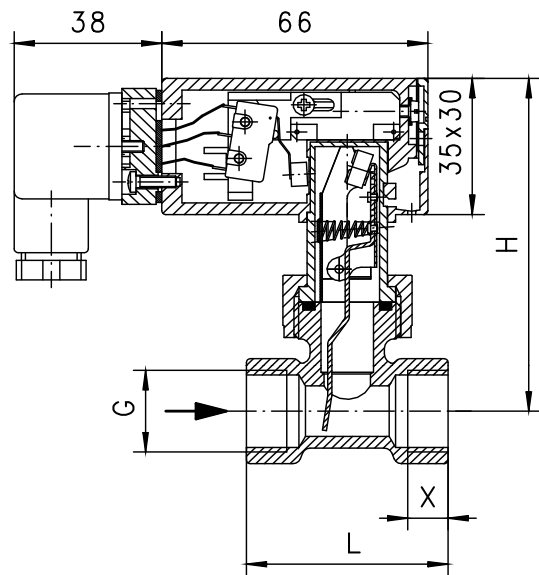

ELECTRICAL DATA

micro switch - wiring 0.371 change over
250 V AC 5 A
plug DIN 43650-A
protection class 2
protection class IP 65

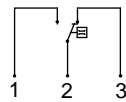

OBASIC
Programme options

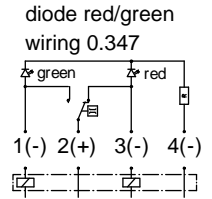
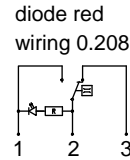
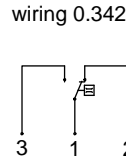

MOUNTING POSITION

Installation position may influence switch value.

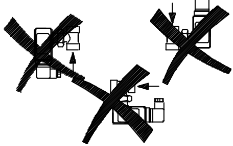

METERING SUBSTANCES

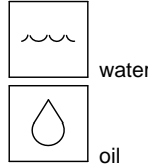

NOMENCLATURE

For combinations see table "technical data"

UM3K-	10	G	M	050		basic type specification
	10				●	nominal diameter DN 10 - G3/8
	15				●	nominal diameter DN 15 - G1/2
	20				●	nominal diameter DN 20 - G3/4
	25				●	nominal diameter DN 25 - G1
	32				●	nominal diameter DN 32 - G1 1/4
	40				●	nominal diameter DN 40 - G1 1/2
	50				●	nominal diameter DN 50 - G2
		G			●	female thread
			M		●	brass design
			K		●	stainless steel design
				055	●	Verstellbereich H ₂ O horizontal 4 - 5.5 l/min
				070	●	Verstellbereich H ₂ O horizontal 5.5 - 7 l/min
				100	●	Verstellbereich H ₂ O horizontal 7.5 - 10 l/min
				018	●	Verstellbereich H ₂ O horizontal 14 - 18 l/min
				300	●	Verstellbereich H ₂ O horizontal 22 - 30 l/min
				500	●	Verstellbereich H ₂ O horizontal 37 - 50 l/min
				930	●	Verstellbereich H ₂ O horizontal 67 - 93 l/min
Programme option BASIC					○	wiring 0.208 - diode red integrated in plug DIN 43650-A wiring 0.347 - diode red/green integrated in plug DIN 43650-A wiring 0.342 gold-plated micro switch 125 V AC / 30 V DC / 100mA
Special option VARIO					□	setting / adjustable ranges for oil or gas contact for locking plug M12x1, 4-pole minimal flow range

IMPORTANT FOR YOUR ORDER

- Please indicate flow direction, metering substance and adjustable range with your order.
- With viscous liquids please indicate viscosity, temperature and metering substance (adjustable range on request)
- With gaseous media indicate pressure (relative or absolute), temperature and metering substance (adjustable range on request)

HONSBERG COMBINATION SYSTEM

connection types for UM3K

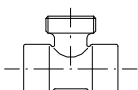

female thread
brass
stainless steel

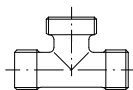

male thread
brass
POM



**welding, soldering
glue socket**
brass, stainless steel, PVC



solder fitting
copper

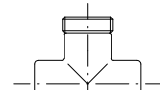

glue fitting
PVC

All technical changes reserved

IBASIC Standard ○BASIC Programme option □VARIO Special option ⊕ PLUS Accessories

X not recommendable