

## Wall mounted cases - *epcase*

### Cable eye

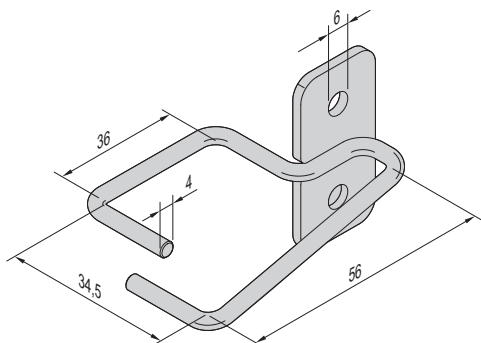

01505051

- For cable fixing/ducting laterally on the panel slide mounts

#### Delivery comprises

Item	Qty	Description
1	4	Cable eye, St, 4 mm, zinc-plated
2	1	Assembly kit

#### Order Information

Description	Part no.
Cable eye	21236-102

### Cable support rail

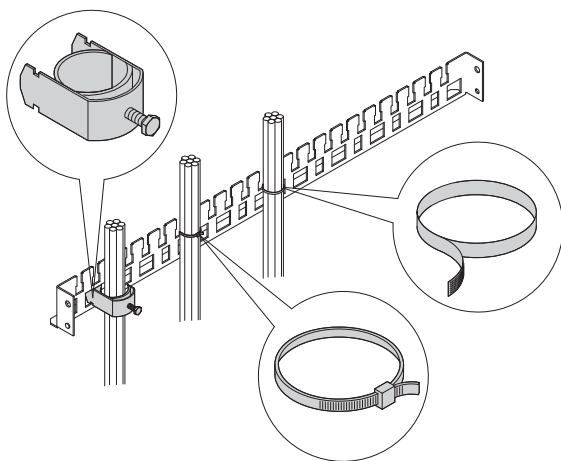

01505052

- For strain relief or cable ducting on rear

- Height-adjustable in 25 mm increments

#### Delivery comprises

Item	Qty	Description
1	1	Cable support rail, St, 1.5 mm, RAL 7035
2	1	Assembly kit

#### Order Information

Description	Part no.
Cable support rail	21236-090
<b>Cable shell</b> for cable bundle 30 ... 34 mm, PU 10 pieces	20114-728
<b>Cable tie</b> 92 mm x 2.5 mm, PU 25 pieces	20118-351
<b>Velcro strip</b> Polyethylen/Polyamide, black, length 300 mm, PU 10 pieces	20118-624

#### Note

- A cable support rail is already supplied with the 19" wall mounted case

### Short slide rail

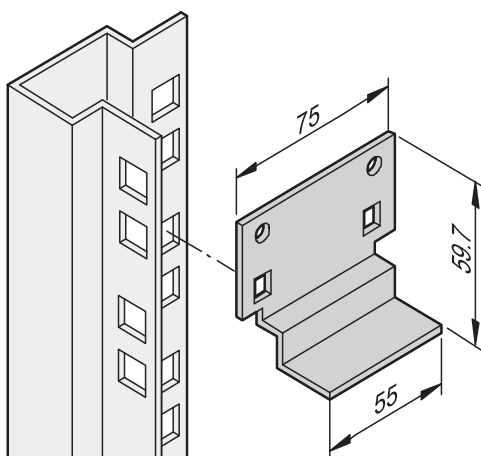

sc96xxxx

- Support for heavy 19" chassis
- To attach on 19" slide mounts
- Static load-carrying capacity max. 15 kg per pair

#### Delivery comprises

Item	Qty	Description
1	2 / 10	Short slide rail, St, 1.5 mm, finish AlZn
2	1	Assembly kit

#### Order Information

Description	Qty/PU	Part no.
Short slide rail	2	23130-094
Short slide rail	10	23130-095



For further information [www.schroff.biz/oneclick](http://www.schroff.biz/oneclick)  
oneClick search code = Part no.