

Reduction factor = 1
 10 mm embeddable
 Resistant to welding

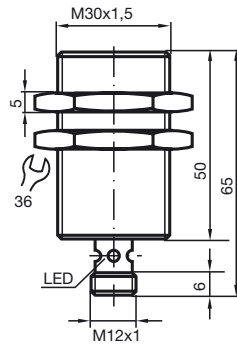

General specifications	
Switching element function	PNP Make function
Rated operating distance s_n	10 mm
Installation	embeddable
Assured operating distance s_a	0 ... 8.1 mm
Reduction factor r_{Al}	1
Reduction factor r_{Cu}	1
Reduction factor r_{V2A}	1
Nominal ratings	
Operating voltage U_B	10 ... 30 V
Switching frequency f	0 ... 50 Hz
Hysteresis H	$\leq 10\%$
Reverse polarity protection	Protected against reverse polarity
Short-circuit protection	pulsing
Voltage drop U_d	≤ 3 V
Operating current I_L	0 ... 200 mA
Off-state current I_r	0 ... 0.5 mA typ. 0.1 μ A at 25 °C
No-load supply current I_0	≤ 15 mA
Constant magnetic field B	100 mT
Alternating magnetic field B	100 mT
Indication of the switching state	Multihole-LED, yellow
Standard conformity	
Standards	IEC / EN 60947-5-2:2004
Ambient conditions	
Ambient temperature	-25 ... 70 °C (248 ... 343 K)
Mechanical specifications	
Connection type	V1-connector
Housing material	brass, teflon coated
Sensing face	PTFE (Teflon)
Protection degree	IP67

Connection type:

