

PCB terminal blocks and plug-in connectors for power electronics - COMBICON power

PC 16 series plug-in connectors up to 16 mm²

Vertical header up to 76 A with male contact

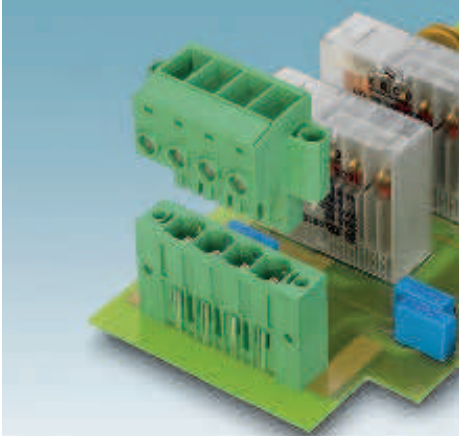

- Vertical PCV 6-16 header for use in combination with all PC 6 and PC 16 plugs
- PCB/PCB connections using IPC 16 headers
- Threaded flange G1F (also for screw connection on the PCB or in the device)
- CS-IPC 16/6 for anti-rotation protection during assembly

Notes:
In accordance with DIN EN 61984, COMBICON connectors have no switching power. During designated use, they must not be plugged in or disconnected when carrying voltage or under load.
COMBICON select Possible combinations for plug-in connectors can be found in COMBICON select at www.phoenixcontact.net/catalog or starting on page 360.
Mounting screw for PCV 6-16/...-G1F-10,16: sheet metal screw ISO 1481-ST 2,9 C. Screw connection only permitted prior to soldering.
1) Please observe the derating curves and laboratory data sheets. Derating curves for other possible combinations are available on request.



Without threaded flange



Accessories		
For all types	Type	Page
	Keying profile CP-PC RD Order No. 1701967	38
	Keying pin CS-IPC 16/6 Order No. 1970016	38
	Marker strips SK 5,0 WH:REEL Order No. 0805221	845

Dimensional drawing

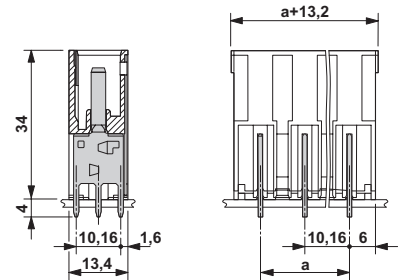

Drilling diagram

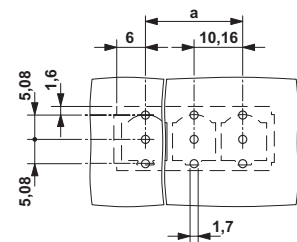

Technical data

Technical data according to IEC/DIN VDE				
Rated current / conductor cross section	[A] / [mm ²]	76 ¹⁾ / -		
Rated insulation voltage for pollution degree 2	[V]	1000		
Pitch	[mm]	10.16		
Insulation coordination				
Surge voltage category / pollution degree		III / 3	III / 2	II / 2
Rated insulation voltage	[V]	1000	1000	1000
Rated surge voltage	[kV]	6	8	8
Approval data (UL/CUL)	Use Group	B	C	D
Nominal voltage	[V]	300	300	600
Nominal current	[A]	66	66	5
Connection capacity AWG	AWG	-	-	-
Approval data (CSA)	Use Group	B	C	D
Nominal voltage	[V]	-	-	-
Nominal current	[A]	-	-	-
Connection capacity AWG	AWG	-	-	-
General data				
Type of insulation material / insulation material group		PA / I		
Inflammability class according to UL 94		V0		
Drill hole diameter / pin dimensions	[mm]	1.7 / 1 x 1.2 mm		

Ordering data

No. of pos.	Dim. a [mm]	Type	Order No.	Pcs. / Pkt.
10.16 mm pitch, color: green				
2	10.16	PCV 6-16/ 2-G1-10,16	1998784	50
3	20.32	PCV 6-16/ 3-G1-10,16	1998797	50
4	30.48	PCV 6-16/ 4-G1-10,16	1998807	50
5	40.64	PCV 6-16/ 5-G1-10,16	1998810	50
6	50.80	PCV 6-16/ 6-G1-10,16	1998823	50
7	60.96	PCV 6-16/ 7-G1-10,16	1998836	50
8	71.12	PCV 6-16/ 8-G1-10,16	1998849	50
9	81.28	PCV 6-16/ 9-G1-10,16	1998852	50

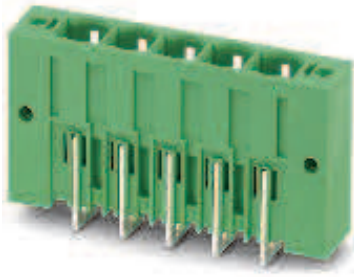

With threaded flange



Dimensional drawing

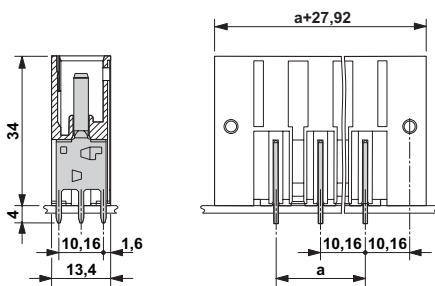

Drilling diagram

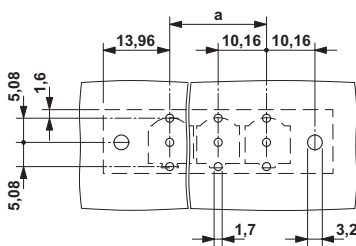

Ordering data

Type	Order No.	Pcs. / Pkt.
10.16 mm pitch, color: green		
PCV 6-16/ 2-G1F-10,16	1998865	50
PCV 6-16/ 3-G1F-10,16	1998878	50
PCV 6-16/ 4-G1F-10,16	1998881	50
PCV 6-16/ 5-G1F-10,16	1998894	50
PCV 6-16/ 6-G1F-10,16	1998904	50
PCV 6-16/ 7-G1F-10,16	1998917	50
PCV 6-16/ 8-G1F-10,16	1998920	50
PCV 6-16/ 9-G1F-10,16	1996414	50