

1- stage filter for 3-phase systems

**Description**

- 3 phase line filter with standard attenuation
- Available as high voltage filter (up to 520 VAC)
- Very high symmetrical and asymmetrical attenuation loss
- In the frequency range from 10kHz up to 300MHz

Standards

- IEC 60939
- UL 1283
- EN 133 200

Approvals

- VDE License Number: 40004666 + 40004673

Applications

- Voltage rating 480 - 520 VAC for world wide acceptance
- Protection against interference voltage from the mains
- For standard and industrial applications
- Qualified for use in equipment according IEC/EN 60950

References

[General Product Information](#)

Weblinks

[Approvals](#), [RoHS](#), [CHINA-RoHS](#), [e-Store](#), [SCHURTER-Stock-Check](#), [Distributor-Stock-Check](#)

Technical Data

Rated Current	6 - 1100A @ Ta 40°C
Rated Voltage	480 - 520 VAC, 50/60 Hz
Approval for	6 - 1100A @ Ta 40 °C / 520VAC; 50Hz
Leakage Current	industrial < 5 mA (440V / 50Hz)
Dielectric Strength for 480 VAC	2.25kVDC between L-L 3kVDC between L-PE
Dielectric Strength for 520 VAC	2.25 between L-L 4 between L-PE Test voltage (2 sec)
Number of Filter Stages	1
Weight	0.9 - 47 kg
Material: Housing	Metal
Sealing Compound	UL 94V-0

Mounting	Screw-on mounting on chassis from top
Terminal	Screw Clamp
Operating Temperature [°C]	-25°C to 100°C
Climatic Category	25/100/21 acc. to IEC 60068-1
Degree of Protection	IP 20 acc. to IEC 60529
Protection Class	Suitable for appliances with protection class I acc. to IEC 61140
MTBF	> 200'000h acc. to MIL-HB-217 F

Dimensions

Case 24-3

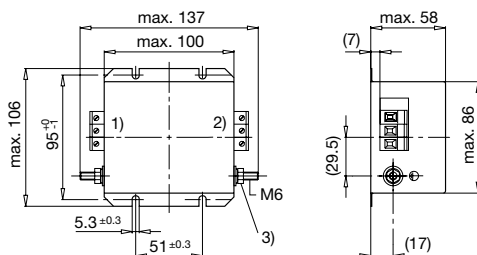

Case 31-3

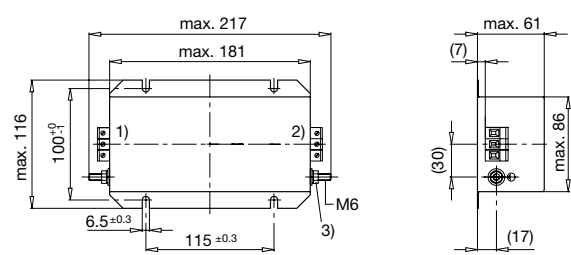

- 1) Line
- 2) Load
- 3) Tightening torque 3...4 Nm

Case 32-3

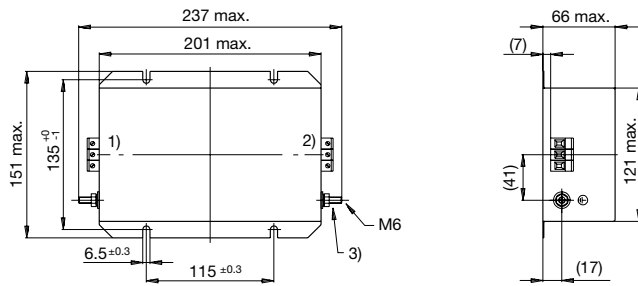

Case 32-7

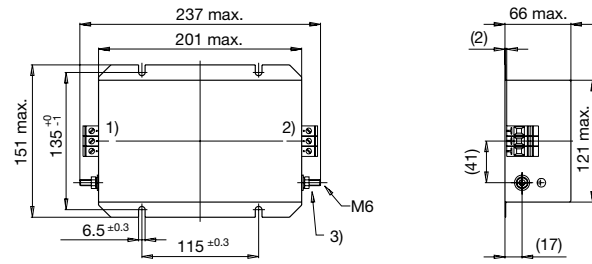

Case 32-C

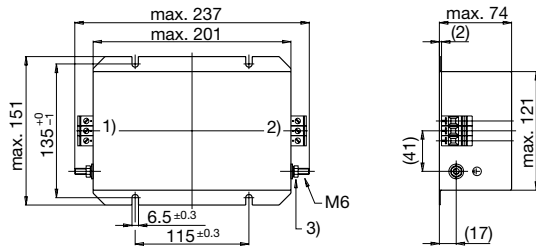

Case 34-3

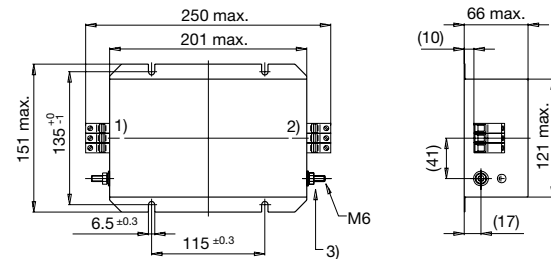

Case 34-C

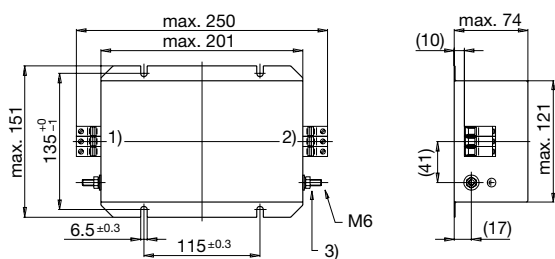

Case 37-3

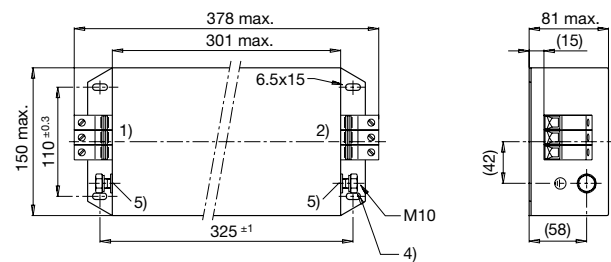

- 1) Line
- 2) Load
- 3) Tightening torque 3...4 Nm
- 4) Tightening torque 10...17 Nm
- 5) Do not unscrew lock-nut

Case 53-3

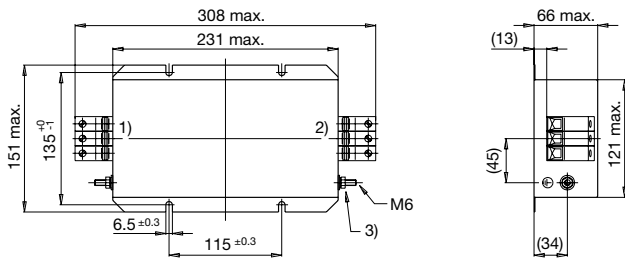

Case 54-3

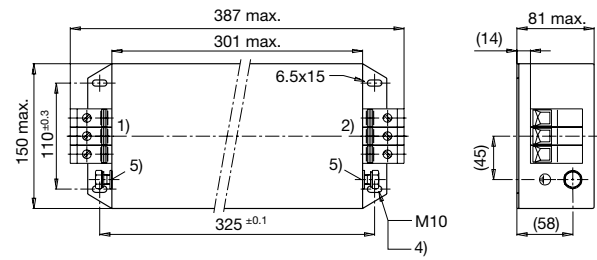

- 1) Line
- 2) Load
- 3) Tightening torque 3...4 Nm
- 4) Tightening torque 10...17 Nm
- 5) Do not unscrew lock-nut

Case 55-3

Case 56-3

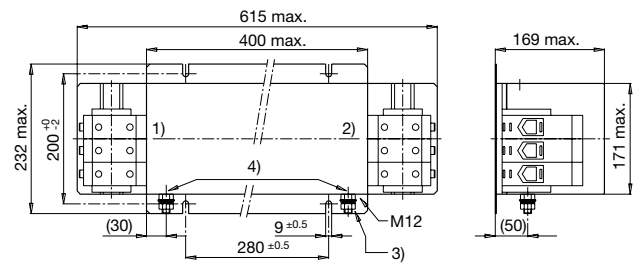
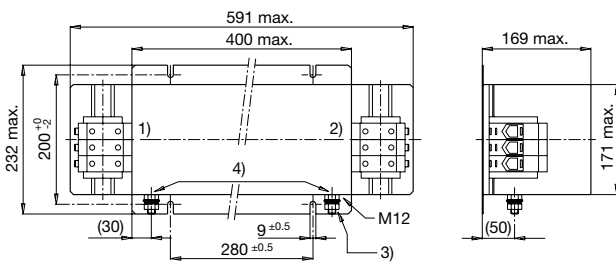

Case 57

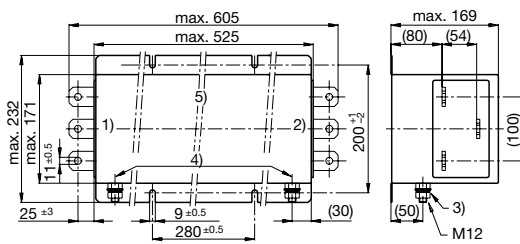

Case 74

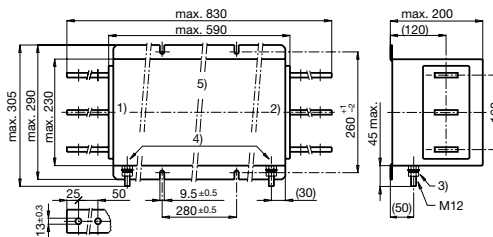

- 1) Line
- 2) Load
- 3) Tightening torque 14...30 Nm
- 4) Do not unscrew lock-nut
- 5) Current plates 720 mm² (60x12)

Technical data to the filter components

Rated Current [A]	Characteristic	Rated Voltage [VAC]	L [mH]	C1 [μF]	C2 [μF]	C3 [nF]	C4 [nF]	C5 [μF]	C6 [μF]	R1 [MΩ]	R2 [MΩ]	R3 [MΩ]	R4 [MΩ]
110	High voltage filter	520	0.7	4.5	1.1	50	50	4.5	1.1	2	1	1	2
110	Excellent attenuation	480	0.7	6.6	1	47	100	6.6	1	2.2	1	1	2.2
1100	High voltage filter	520	0.12	11	1.1	50	-	22	1.1	2	0.5	0.25	2
16	Excellent attenuation	480	6	1.0	-	100	10	2.2	-	-	-	1	1
16	High voltage filter	520	6	1.5	-	50	11	1.5	-	2	1	1	2
180	High voltage filter	520	0.4	4.5	1.1	50	50	4.5	1.1	2	1	1	2
180	Excellent attenuation	480	0.4	6.6	1	47	100	6.6	1	2.2	1	1	2.2
25	High voltage filter	520	3	3	1.1	50	11	3	1.1	2	1	1	2
25	High attenuation	480	2.4	4.4	1	10	47	4.4	1	2.2	-	1	2
25	Excellent attenuation	480	3	4.4	1	10	47	4.4	1	2.2	1	1	2.2
250	High voltage filter	520	0.3	7.5	1.1	50	50	7.5	1.1	2	1	1	2
250	Excellent attenuation	480	0.3	11	1	100	100	11	1	2.2	0.5	0.5	2.2
340	High voltage filter	520	0.2	7.5	1.1	50	50	15	1.1	2	1	1	2
340	Excellent attenuation	480	0.2	11	1	100	100	22	1	2.2	0.33	0.33	2.2
36	High voltage filter	520	2	3	1.1	50	11	3	1.1	2	1	1	2
36	High attenuation	480	1.5	4.4	1	10	47	4.4	1	2.2	-	1	2
36	Excellent attenuation	480	2	4.4	1	10	47	4.4	1	2.2	1	1	2.2
450	Excellent attenuation	480	0.2	11	1	100	100	22	1	2.2	0.33	0.33	2.2
50	High voltage filter	520	1	3	1.1	50	11	3	1.1	2	1	1	2
50	High attenuation	480	1	4.4	1	10	100	4.4	1	2.2	-	1	2
550	Excellent attenuation	480	0.2	11	1	100	100	22	1	2.2	0.33	0.33	2.2
6	Excellent attenuation	480	10	1.0	-	100	10	2.2	-	-	-	1	1
64	High voltage filter	520	0.6	3	1.1	50	11	3	1.1	2	1	1	2
64	High attenuation	480	0.6	4.4	1	10	100	4.4	1	2.2	-	1	2
8	Excellent attenuation	480	10	1.0	-	100	10	2.2	-	-	-	1	1
80	High voltage filter	520	1	4.5	1.1	50	50	4.5	1.1	2	1	1	2
80	Excellent attenuation	480	1	6.6	1	47	100	6.6	1	2.2	1	1	2.2

Diagrams

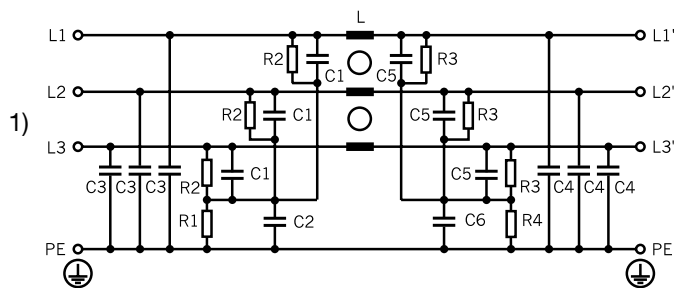

1) Power Line

Attenuation Loss

Industrial Version

--- differential mode ____ common mode

6A (FMAC-0924-0610)

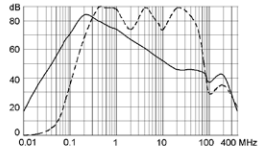

8A (FMAC-0931-0810)

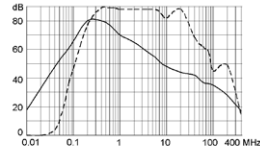

16A (FMAC-0931-1610)
16A (FMAC-0932-1610)

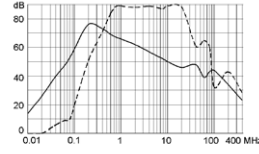

16A (FMAC-0931-1612I)

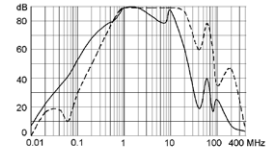

25A (FMAC-0932-2510)

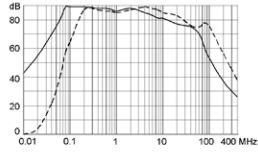

25A (FMAC-0932-2510L)

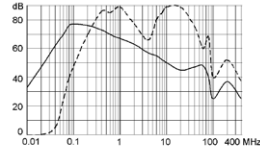

25A (FMAC-0932-2512I)

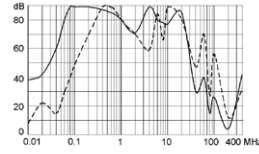

36A (FMAC-0934-3610)

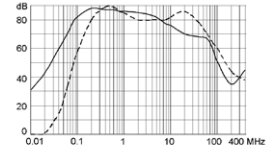

36A (FMAC-0932-3610L)

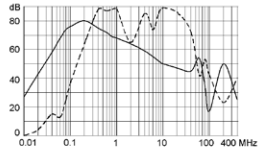

36A (FMAC-0932-3612I)

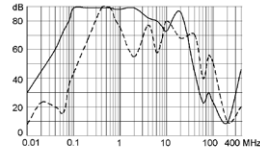

50A (FMAC-0934-5010)

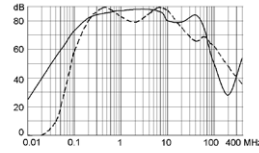

50A (FMAC-0934-5010L)

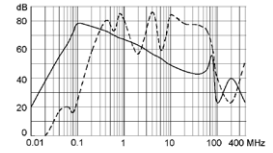

50A (FMAC-0934-5012I)

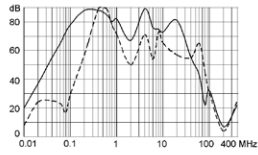

64A (FMAC-0953-6410)

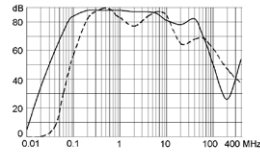

64A (FMAC-0934-6410L)

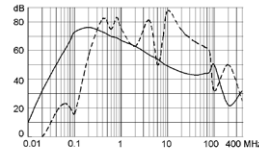

64A (FMAC-0953-6412I)

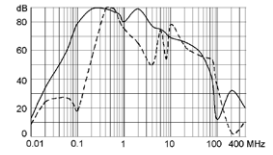

80A (FMAC-0937-8010)

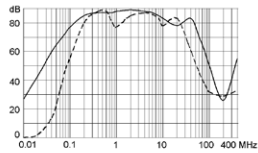

80A (FMAC-0937-8012I)

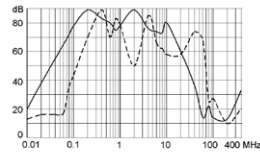

110A (FMAC-0954-H110)

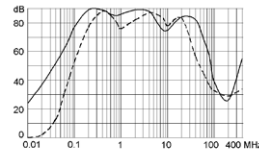

110A (FMAC-0954-H112I)

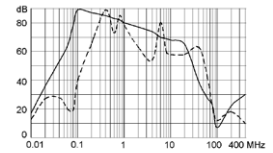

180A (FMAC-0955-H210)

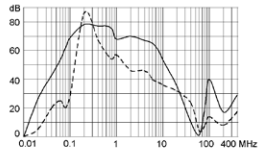

180A (FMAC-0955-H212I)

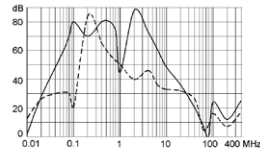

250A (FMAC-0956-H310)

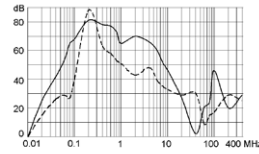

250A (FMAC-0956-H312I)

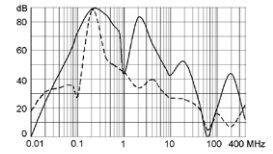

340A (FMAC-0956-H410)

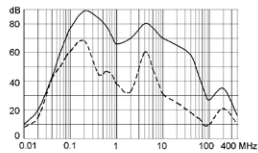

340A (FMAC-0956-H412I)

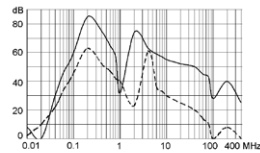

450A (FMAC-0957-H550)

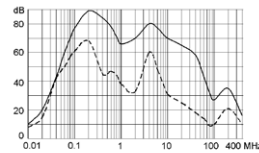

550A (FMAC-0957-H650)

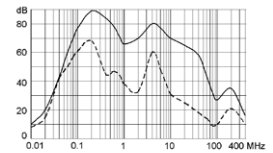

1100A (FMAC-0974-K152I)

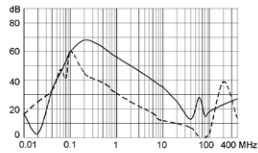

Variants

[Distributor-Stock-Check](#) | [SCHURTER-Stock-Check](#) | [e-Store](#)

Rated Current [A]	Characteristic	Rated Voltage [VAC]	P _{loss} [W]	Leakage Current [mA] ¹⁾	Contact Resistance [mΩ]	Weight [kg]	Screw clamps [mm ²] ²⁾	Case	Order Number
110	Excellent attenuation	480	27.23	167	0.75	7.5	50	54-3	FMAC-0954-H110
110	High voltage filter	520	27.23	179	0.75	7.45	50	54-3	FMAC-0954-H112I
1100	High voltage filter	520	80	182	0.022	47	(A)	74	FMAC-0974-K152I
16	Excellent attenuation	480	8.83	40	11.5	1.8	4	31-3	FMAC-0931-1610
16	Excellent attenuation	480	8.83	40	11.5	2.8	4	32-3	FMAC-0932-1610
16	High voltage filter	520	8.83	26	11.5	1.8	4	31-3	FMAC-0931-1612I
180	Excellent attenuation	480	36	167	0.37	22	95	55-3	FMAC-0955-H210
180	High voltage filter	520	36	179	0.37	23	95	55-3	FMAC-0955-H212I
25	Excellent attenuation	480	8.25	156	4.4	3.4	6	32-7	FMAC-0932-2510
25	High attenuation	480	9.86	156	5.26	3.5	4	32-7	FMAC-0932-2510L
25	High voltage filter	520	8.25	172	4.4	3.35	6	32-7	FMAC-0932-2512I
250	Excellent attenuation	480	36	175	0.2	23.7	240	56-3	FMAC-0956-H310
250	High voltage filter	520	36	185	0.2	25	240	56-3	FMAC-0956-H312I
340	Excellent attenuation	480	45	176	0.13	27	240	56-3	FMAC-0956-H410
340	High voltage filter	520	45	188	0.13	30	240	56-3	FMAC-0956-H412I
36	Excellent attenuation	480	12.91	156	3.32	3.5	6	34-3	FMAC-0934-3610
36	High attenuation	480	10.55	156	2.71	3.75	6	32-C	FMAC-0932-3610L
36	High voltage filter	520	12.91	172	3.32	3.3	6	34-3	FMAC-0934-3612I
450	Excellent attenuation	480	40	176	0.06	33	(B)	57	FMAC-0957-H550
50	Excellent attenuation	480	9.75	160	1.3	3.4	6	34-3	FMAC-0934-5010
50	High attenuation	480	12.63	160	1.68	3.6	6	34-C	FMAC-0934-5010L
50	High voltage filter	520	9.75	172	1.3	3.35	6	34-3	FMAC-0934-5012I
550	Excellent attenuation	480	45	176	0.046	32	(B)	57	FMAC-0957-H650
6	Excellent attenuation	480	2.48	40	23	0.9	4	24-3	FMAC-0924-0610
64	Excellent attenuation	480	13.52	160	1.1	3.9	25	53-3	FMAC-0953-6410
64	High attenuation	480	18.23	160	1.48	4.2	6	34-C	FMAC-0934-6410L
64	High voltage filter	520	13.52	172	1.1	3.8	25	53-3	FMAC-0953-6412I
8	Excellent attenuation	480	5.38	40	28	1.8	4	31-3	FMAC-0931-0810
80	Excellent attenuation	480	22.6	167	1.17	7	25	37-3	FMAC-0937-8010
80	High voltage filter	520	22.6	179	1.17	7.28	25	37-3	FMAC-0937-8012I

2) Maximum conductor cross section (wire gauge) to be used; a comparative table for AWG and mm² values can be found in the general product information www.schurter.com/emc_info

1) Worst case leakage current acc. to IEC60950 - Annex G4 (situation with two interrupted lines). Nominal leakage current acc. to IEC60950 - 5.2.5. can be found in section technical data.

6A version: packing unit 2 pcs.

(A): Connecting straps for M12

(B): Connecting straps for M10

Packaging unit 1 Pcs