



3 year guarantee Patented



# MYO

## Lamp operation Fonctionnement de votre lampe

### Switching on & off / Allumer, éteindre

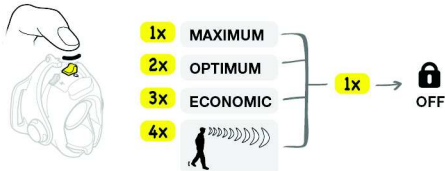

### BOOST



### Optical system / Système optique

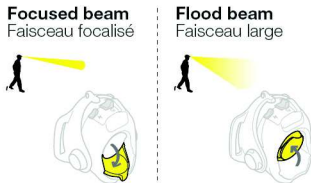

175 g

IPX4

Individual functioning test

Water resistant

Only AA x 3 (1,2V - 1,5V)

### Compliant to Energy-related Products Directive (ErP) 2009/125/EC

- Instant full light
- Colour temperature: 6000-7000K
- Nominal beam angle: 13° sharp angle / 65° broad angle
- Number of switching cycles before premature failure: 13000 mini.

### Powerful multi-beam headlamp intended for endurance-oriented outdoor activities, with STANDARD LIGHTING and CONSTANT LIGHTING technology.

Lampe frontale multifaisceau et puissante, dédiée aux activités outdoor d'endurance, avec technologie STANDARD LIGHTING et CONSTANT LIGHTING.

PETZL.COM



Latest version



Other languages



Product Experience

PETZL  
F-38920 Crolles  
PETZL.COM  
ISO 9001  
© Petzl



Sustaining our Community  
Au service de la Communauté  
FONDATION-PETZL.ORG



Recycled paper



### LED risk group 2 - IEC 62471

Do not stare at operating lamp. May be harmful to the eyes.

Ne regardez pas fixement le faisceau de la lampe de face. Peut être dangereux pour les yeux.

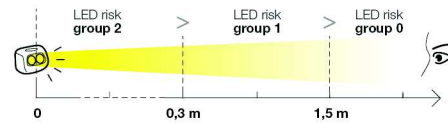

### Nomenclature

Nomenclature

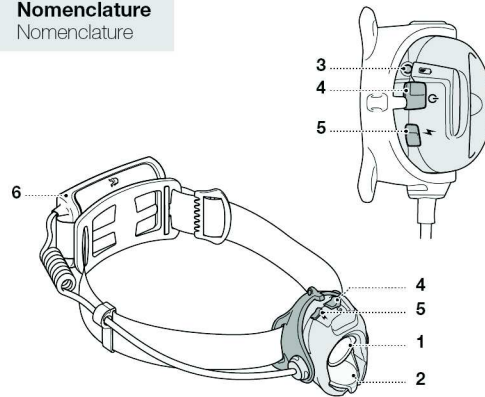

### Lighting performance - burn time

Performances d'éclairage - autonomie

	Lighting Mode	Beam Type	Beam Distance	Burn Time
CONSTANT LIGHTING	1	20 lumens	30 m	40 h
	2	30 lumens	35 m	30 h
	3	40 lumens	40 m	19 h
	ECONOMIC*	60 lumens	50 m	13 h
	5	80 lumens	55 m	9 h
	OPTIMUM*	110 lumens	65 m	5 h
	7	120 lumens	70 m	4 h
	8	150 lumens	80 m	3 h
	9	170 lumens	90 m	2 h
STANDARD LIGHTING	MAXIMUM*	280 lumens	105 m	50 h
	BOOST	370 lumens		
Reserve	3 lumens		50 h	

(\*) PETZL initial configuration / Configuration initiale PETZL

### Spare parts / Pièces de rechange

Headlamps Elastic straps  
Elastique lampes frontales

E04999

## Programming Programmation

1. Turn on the lamp in the mode to be configured  
Allumer la lampe dans le mode à configurer

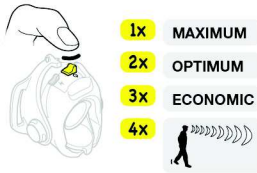

2. Accessing program mode  
Accès au réglage



3. Brightness selection  
Choix du niveau de puissance

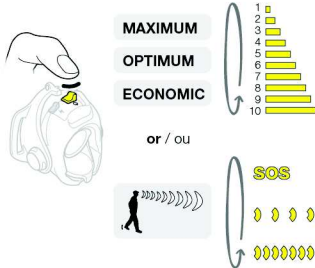

4. Saving your settings  
Enregistrement



## Battery charge indicator Témoin de charge des piles

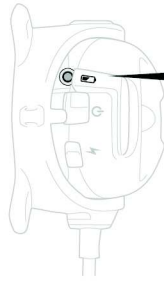

GREEN 30 - 100 %  
YELLOW 10 - 30 %  
RED < 10 %

## TOPSTRAP

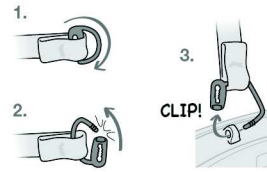

## Installing the batteries Installation des piles

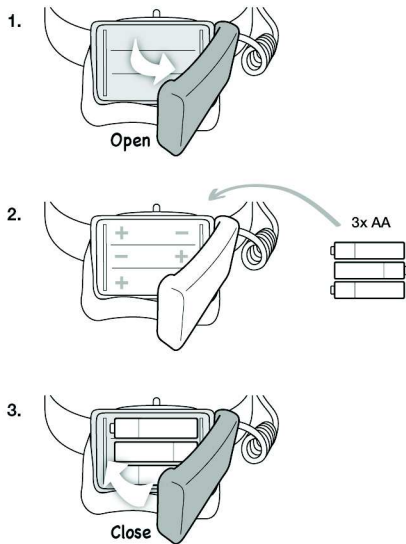

## General info on Petzl lamps and batteries Généralités lampes et batteries Petzl

### A. Rechargeable battery precautions Précautions batterie rechargeable



### B. Lamp precautions / Précautions lampes



### C. Cleaning - Drying / Nettoyage - Séchage



### D. Storage - Transport Stockage - transport



### E. Protecting the environment Protection de l'environnement



### F. Modifications - Repairs Modifications - Réparations



### G. FAQ - Contact Questions - Contact

