

| | | | |
|------|------|-------------|-------------|
| LTR. | REV. | DESCRIPTION | DATE |
| | A | FIRST ISSUE | 2011. 3. 23 |

L±3%

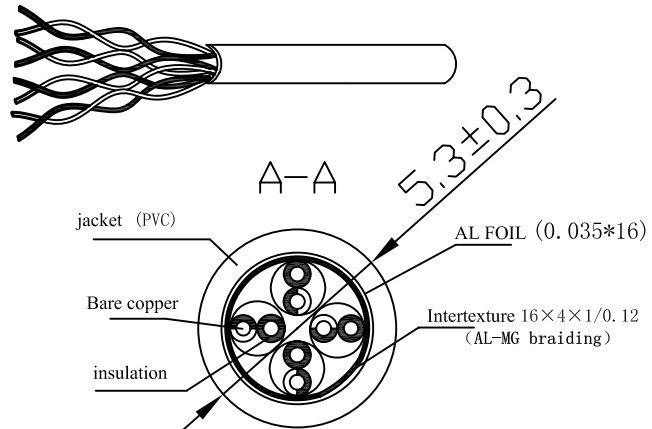
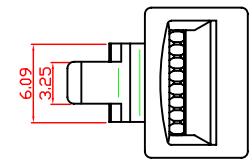
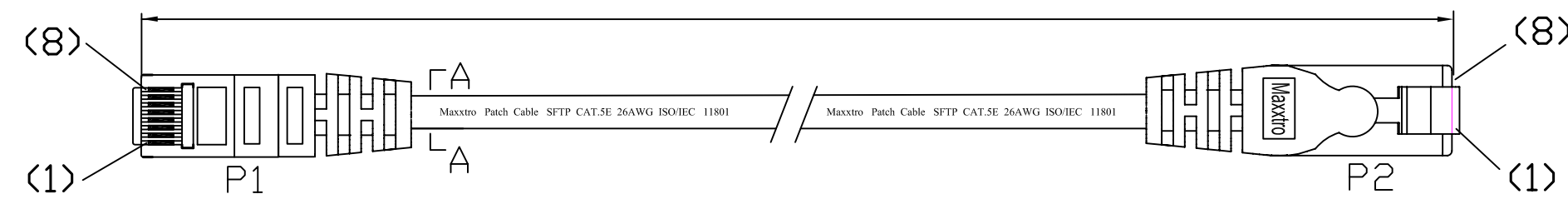

Connecting

| P1 | 568B COLOR | P2 |
|----|------------|----|
| 1 | WH/ORG | 1 |
| 2 | ORG | 2 |
| 3 | WH/GRN | 3 |
| 4 | BLU | 4 |
| 5 | WH/BLU | 5 |
| 6 | GRN | 6 |
| 7 | WH/BWN | 7 |
| 8 | BWN | 8 |

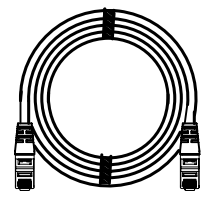

| ITEM No. | LENGTH | PVC COLOR | PACKING |
|----------|---------------|-------------|---------|
| 102081 | 7500 ± 150MM | BLUE 567# | ZB-L |
| 102131 | 20000 ± 400MM | YELLOW 361# | ZB-XL |

SPECIFICATIONS:

1. CONDUCTOR:
 - 1.1 CONDUCTORS: 26AWG 7*0.155±0.015mm
 - 1.2 CONDUCTOR INSULATION COLOR CODING: ONE WHITE/ORANGE, ONE ORANGE, ONE WHITE/GREEN, ONE GREEN, ONE BLUE, ONE WHITE/BLUE, ONE WHITE/BROWN, ONE BROWN.
2. CABLE JACKET
 - 2.1 PRINTING ON THE JACKET: Maxxtro Patch Cable SFTP CAT.5E 26AWG ISO/IEC 11801
3. CABLE ASSEMBLY
 - 3.1 SEE SECTION A-A FOR DIMENSIONS
 - 3.2 CABLE TIE: Assorted upon request
 - 3.3 WIRING T568B COLOR
 - 3.4 CONTACT PLUG: RJ45 8P8CS 15u pc UL 94V-2
4. CABLE JACKET COLOR: GY 687#; RED 172#; BLUE 567#; YELLOW 361#; GREEN 273#; BLACK 063#; WHITE 461#; ORANGE 760#; PINK 171#; PURPLE 964#
5. LENGTH: L±3%mm

| | | | | | | |
|------------|--------|-------------|-------------|------------------------|------|-------|
| | | | | Maxxtro® | | |
| REMARK/NO | CHA/NO | SIGNATURE | DATE | | | |
| DRAWN BY | Morgan | | | SIGN | REV. | SCALE |
| CHECKED BY | 宋巧 | | | | A | |
| AUDITED BY | 缪传友 | APPROVED BY | 祁玉军 | | | |
| CRAFT | | DATE | 2011. 3. 23 | PAGE OF | | |
| | | | | SFTP CAT5e CABLE 26AWG | | |