

Miniature Pushbutton Switches snap action



Specifications:

Contact rating:	125 V AC, 3 A 30 V DC, 1 A / 12 V DC, 2 A / 6 V DC, 3 A
Contact resistance:	< 10 mΩ
Insulation resistance:	> 1000 MΩ at 500 V DC
Dielectric strength:	1000 V, 50 Hz for the duration of 1 minute
Operating temperature:	-20 °C to +80 °C
Mechanical life:	minimum 100 000 operations
Contacts:	coin silver (common contact copper alloy, silver-plated) also available gold-plated version B, see page 4
Terminals:	solder tags, copper alloy silver-plated
Case material:	phenol resin, black
Mounting:	bushing M 6 x 0.75 with locking plate, key 9 mm
Soldering conditions:	hand-soldering – max.: 60 W, 3 sec, 420 °C

Accessories:

Buttons	∅ (height 8 mm)		∅ (height 10 mm)	
	orange	10 mm	KM 403	15 mm
blue	10 mm	KM 404	15 mm	KM 604
black	10 mm	KM 405	15 mm	KM 605
green	10 mm	KM 406	15 mm	KM 606
grey	10 mm	KM 407	15 mm	KM 607
yellow	10 mm	KM 408	15 mm	KM 608
red	10 mm	KM 409	15 mm	KM 609
white	10 mm	KM 410	15 mm	KM 610

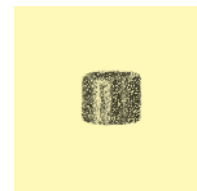

Covers

M 6 x 0.75	
Brass, chromium-plated	CO 106
Brass, black, matt finish	CO 106 S

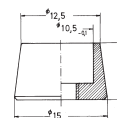



Miniature Pushbutton Switches snap action

Models: Switching functions

SPDT

MPS 103 F on – mom

measures: a = 1.5, b = 15^{±1}
travel 1,0

MPS 103 D on – on

measures: a = 2.5, b = 16^{±1}
travel 2,5

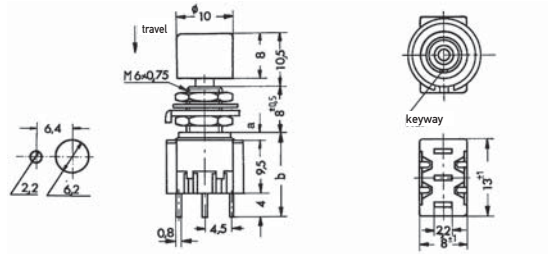

DPDT

MPS 203 R on – mom

measures: a = 1.5, b = 15^{±1}
travel 1.0

MPS 203 N on – on

measures: a = 2.5, b = 16^{±1}
travel 2.5

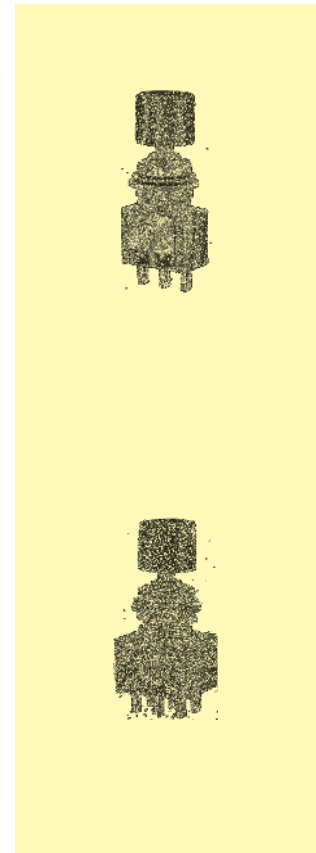
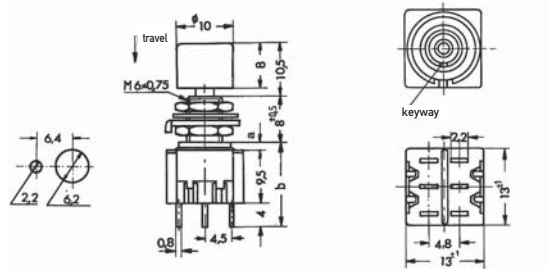

Circuit diagram:

