

PCB terminal blocks and plug-in connectors for power electronics - COMBICON power

PCB terminal blocks with screw connection

MKDSP 25 series up to 35 mm²

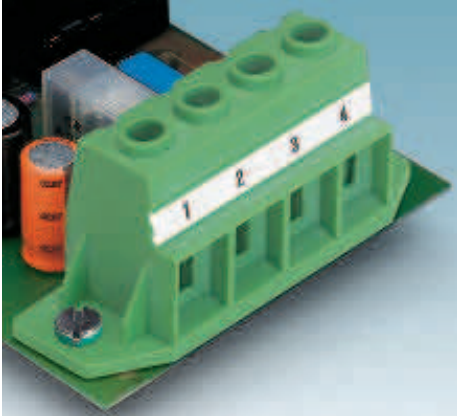

- High-capacity PCB terminal blocks with a screw connection up to 35 mm² conductor cross section and a current carrying capacity of 125 A
- Unlimited 600 V UL approval
- Integrated test connection
- Version with mounting flange (-F) for safe mounting in the device
- Single-pos. version with left-sided mounting flange (-FL)
- Integrated protective guide

Notes:
1) Please observe the current carrying capacity curves and laboratory data sheets. Other current carrying capacity curves are available on request.
2) 2.5 Nm = 25 mm ² 4.5 Nm = 35 mm ²

Accessories		
For all types	Type	Page
	Test plug MPS	855
	Reducing plug RPS Order No. 0201647	855
	Screwdriver SZS 1,0 x 6,5 Order No. 1205079	
	Marker strips SK 10,0 WH:REEL Order No. 0812188	845
	Zack marker strip ZBF 15: UNBEDRUCKT	849

Current carrying capacity curve

Type: MKDSP 25/...-15,00
Tested in accordance with DIN EN 60512-5-2:2003-01
Reduction factor = 1
No. of positions: 5

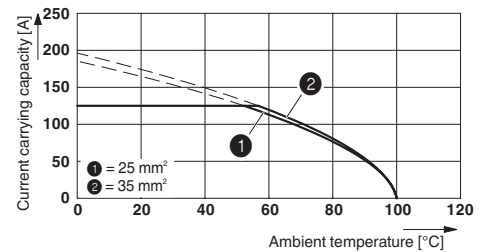

Technical data	MKDSP 25/...	MKDSP 25/...-F	MKDSP 25/...-FL	No. of pos.	Dim. a [mm]
Technical data according to IEC/DIN VDE					
Rated current / conductor cross section [A] / [mm ²]	125 ¹⁾ / 35	125 ¹⁾ / 35	125 ¹⁾ / 35	1	
Rated insulation voltage for pollution degree 2 [V]	1000	1000	1000	2	15.00
Pitch [mm]	15	15	15	3	30.00
Connection capacity				4	45.00
Solid / stranded [mm ²] / [mm ²] / AWG	0.5 - 35 / 0.5 - 25 / 20 - 2	0.5 - 35 / 0.5 - 25 / 20 - 2	0.5 - 35 / 0.5 - 25 / 20 - 2	5	60.00
Stranded with ferrules without plastic sleeve [mm ²]	1 - 25	1 - 25	1 - 25	6	75.00
Stranded with ferrules with plastic sleeve [mm ²]	1.5 - 25	1.5 - 25	1.5 - 25	7	90.00
Multi-conductor connection capacity (two conductors with the same cross section)				8	105.00
Solid / stranded [mm ²]	0.5 - 6 / 0.5 - 6	0.5 - 6 / 0.5 - 6	0.5 - 6 / 0.5 - 6	9	120.00
Stranded with ferrules without plastic sleeve [mm ²]	0.5 - 4	0.5 - 4	0.5 - 4		
Stranded with TWIN ferrule with plastic sleeve [mm ²]	0.5 - 6	0.5 - 6	0.5 - 6		
Insulation coordination					
Surge voltage category / pollution degree	III / 3 III / 2 II / 2	III / 3 III / 2 II / 2	III / 3 III / 2 II / 2		
Rated insulation voltage [V]	1000 1000 1000	1000 1000 1000	1000 1000 1000		
Rated surge voltage [kV]	8 8 8	8 8 8	8 8 8		
Approval data (UL/CUL) Use Group	B C D	B C D	B C D		
Nominal voltage [V]	600 600 -	600 600 -	600 600 -		
Nominal current [A]	115 115 -	115 115 -	115 115 -		
Connection capacity AWG	20 - 2 20 - 2 -	20 - 2 20 - 2 -	20 - 2 20 - 2 -		
Approval data (CSA) Use Group	B C D	B C D	B C D		
Nominal voltage [V]	- - -	- - -	- - -		
Nominal current [A]	- - -	- - -	- - -		
Connection capacity AWG	- - -	- - -	- - -		
General data					
Stripping length [mm]	18	18	18		
Screw thread	M5	M5	M5		
Tightening torque [Nm]	2.5 - 4.5 ²⁾	2.5 - 4.5 ²⁾	2.5 - 4.5 ²⁾		
Type of insulation material / insulation material group	PA / I	PA / I	PA / I		
Inflammability class according to UL 94	V0	V0	V0		
Drill hole diameter / pin dimensions [mm]	1.6 / 1.2 x 1.2 mm	1.6 / 1.2 x 1.2 mm	1.6 / 1.2 x 1.2 mm		

PCB terminal blocks and plug-in connectors for power electronics - COMBICON power

PCB terminal blocks with screw connection

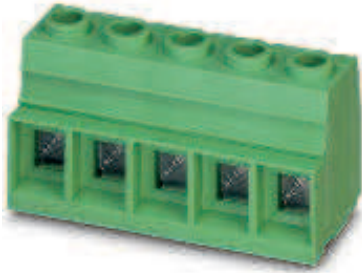

Without mounting flange, 600 V UL approval



With mounting flange, 600 V UL approval



Single PCB terminal block with mounting flange, left, 600 V UL approval



Dimensional drawing

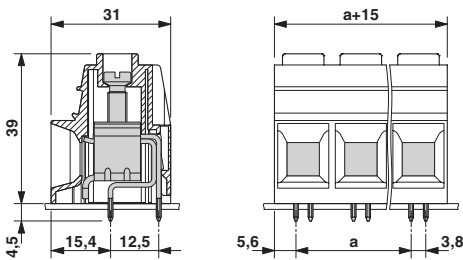

Drilling diagram

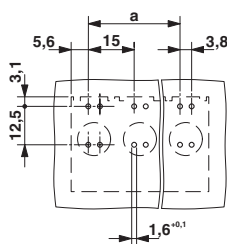

Dimensional drawing

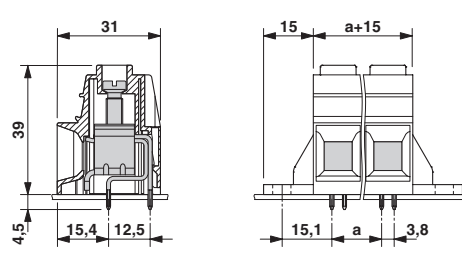

Drilling diagram

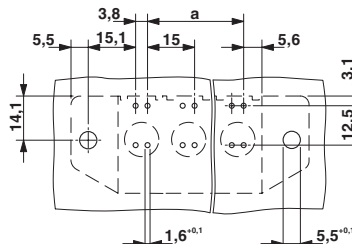

Dimensional drawing

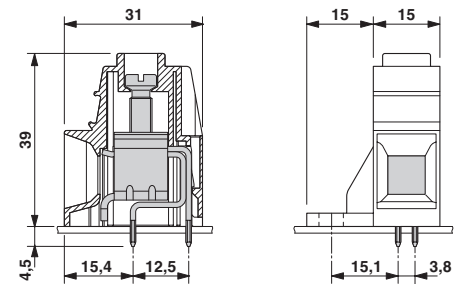

Drilling diagram

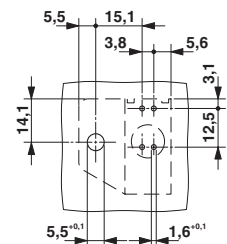

Ordering data

Type	Order No.	Pcs. / Pkt.
15 mm pitch, color: green		
MKDSP 25/ 2-15,00	1932588	25
MKDSP 25/ 3-15,00	1932591	25
MKDSP 25/ 4-15,00	1932601	25
MKDSP 25/ 5-15,00	1932614	25
MKDSP 25/ 6-15,00	1932627	25
MKDSP 25/ 7-15,00	1932630	25
MKDSP 25/ 8-15,00	1932643	25
MKDSP 25/ 9-15,00	1932656	25

Ordering data

Type	Order No.	Pcs. / Pkt.
15 mm pitch, color: green		
MKDSP 25/ 2-15,00-F	1932494	25
MKDSP 25/ 3-15,00-F	1932504	25
MKDSP 25/ 4-15,00-F	1932517	25
MKDSP 25/ 5-15,00-F	1932520	25
MKDSP 25/ 6-15,00-F	1932533	25
MKDSP 25/ 7-15,00-F	1932546	25
MKDSP 25/ 8-15,00-F	1932559	25
MKDSP 25/ 9-15,00-F	1932562	25

Ordering data

Type	Order No.	Pcs. / Pkt.
15 mm pitch, color: green		
MKDSP 25/ 1-15,00-FL	1932575	25