

### Cable Tie Anchor Mounts

Cable ties may be inserted from any of the four sides of the CTAM. This feature allows the mount to be placed either parallel or perpendicular to the wires.

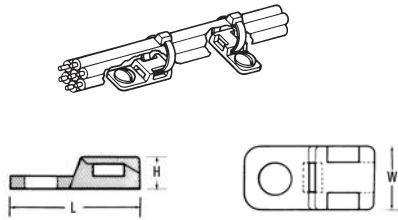

Material Data	
Material	<b>Polyamide 6.6 (PA66)</b>
Operating Temperature	<b>-40 °F to +185 °F (-40 °C to +85 °C) continuous</b>
Flammability	<b>UL94 V2</b>



#### Product Selection

Article No.	Part No.	Type	Cable Tie Series	Mounting	Width (W)	Length (L)	Height (H)	Color	Pkg. Qty.
					in. (mm)	in. (mm)	in. (mm)		
151-31103	<b>CTAM110C2</b>	CTAM1	T18 - T50	#8 screw	.400" (10.16)	.800" (20.32)	.200" (5.08)	White	100
151-31106	<b>CTAM110M4</b>	CTAM1			.400" (10.16)	.800" (20.32)	.200" (5.08)	White	1000
151-31101	<b>CTAM10C2</b>	CTAM1			.400" (10.16)	.800" (20.32)	.200" (5.08)	Black	100
151-00287	<b>CTAM10M4</b>	CTAM1			.400" (10.16)	.800" (20.32)	.200" (5.08)	Black	1000
151-31203	<b>CTAM210C2</b>	CTAM2		#10 screw	.400" (10.16)	.800" (20.32)	.200" (5.08)	White	100
151-31205	<b>CTAM210M4</b>	CTAM2			.400" (10.16)	.800" (20.32)	.200" (5.08)	White	1000
151-31201	<b>CTAM20C2</b>	CTAM2			.400" (10.16)	.800" (20.32)	.200" (5.08)	Black	100
151-31202	<b>CTAM20M4</b>	CTAM2			.400" (10.16)	.800" (20.32)	.200" (5.08)	Black	1000

Dimensions are approximate and subject to technical changes. Use **Part No.** for ordering and **Type** for specification purposes.

### Cable Tie Anchor Plates

These plates have slotted mounting holes to provide for easier alignment of mount and bundles. Once aligned, they are fastened securely by tightening the applied screw. The CTAP2 allows an additional screw for maximum stability. Both plates are used perpendicularly to the wire bundle.

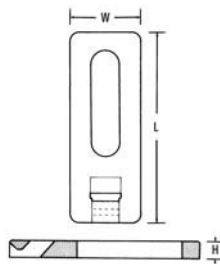

Material Data	
Material	<b>Polyamide 6.6 (PA66)</b>
Operating Temperature	<b>-40 °F to +185 °F (-40 °C to +85 °C) continuous</b>
Flammability	<b>UL94 V2</b>



#### Product Selection

Article No.	Part No.	Type	Cable Tie Series	Mounting	Width (W)	Length (L)	Height (H)	Color	Pkg. Qty.
					in. (mm)	in. (mm)	in. (mm)		
151-30100	<b>CTAP110C2</b>	CTAP1	T18 - T50	#10 screw	.50" (12.7)	1.34" (34.04)	.15" (3.81)	White	100
151-00288	<b>CTAP110M4</b>	CTAP1			.50" (12.7)	1.34" (34.04)	.15" (3.81)	White	1000
151-00289	<b>CTAP10C2</b>	CTAP1			.50" (12.7)	1.34" (34.04)	.15" (3.81)	Black	100
151-00290	<b>CTAP10M4</b>	CTAP1			.50" (12.7)	1.34" (34.04)	.15" (3.81)	Black	1000
151-30200	<b>CTAP210C2</b>	CTAP2			.50" (12.7)	2.13" (54.1)	.14" (3.5)	White	100
151-00308	<b>CTAP210H4</b>	CTAP2			.50" (12.7)	2.13" (54.1)	.14" (3.5)	White	500
151-00291	<b>CTAP20C2</b>	CTAP2			.50" (12.7)	2.13" (54.1)	.14" (3.5)	Black	100
151-00292	<b>CTAP20M4</b>	CTAP2			.50" (12.7)	2.13" (54.1)	.14" (3.5)	Black	500

Dimensions are approximate and subject to technical changes. Use **Part No.** for ordering and **Type** for specification purposes.