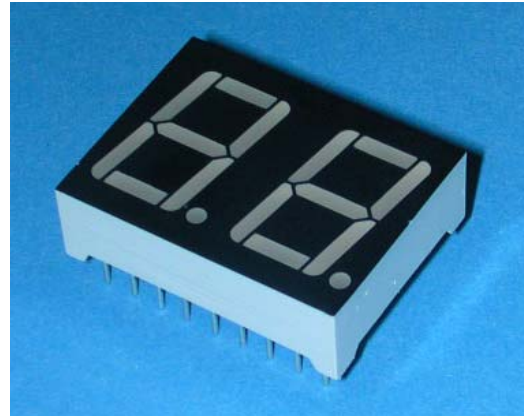

Technical Data Sheet
0.56" Dual Digit Displays**ELD-512SURWB/S530-A3****■ Features :**

- Industrial standard size.
- Low power consumption.
- Categorized for luminous intensity.
- Pb free

■ Descriptions :

- The ELD-512 series is a large 14.22mm (0.56")high seven segment display designed for viewing distances up to 7 meters.
- These displays provide excellent reliability in bright ambient light.
- These devices are made with white segments and black surface.

**■ Applications :**

- Audio equipment
- Instrument panels
- Digital read out display

| PART NO. | Chip | |
|----------------------|----------|---------------|
| | Material | Emitted Color |
| ELD-512SURWB/S530-A3 | AlGaInP | Hyper Red |



Technical Data Sheet
0.56" Dual Digit Displays

ELD-512SURWB/S530-A3

Package Dimensions

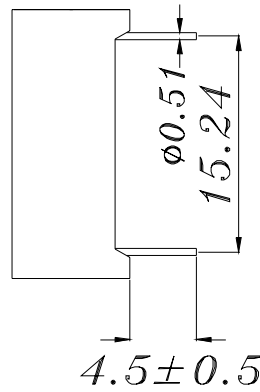
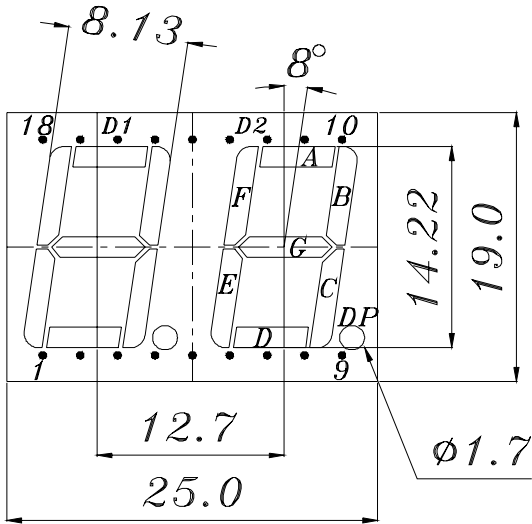

- COMMON ANODE
- 1 CATHODE E D1
 - 2 CATHODE D D1
 - 3 CATHODE C D1
 - 4 CATHODE DP D1
 - 5 CATHODE E D2
 - 6 CATHODE D D2
 - 7 CATHODE G D2
 - 8 CATHODE C D2
 - 9 CATHODE DP D2
 - 10 CATHODE B D2
 - 11 CATHODE A D2
 - 12 CATHODE F D2
 - 13 COMMON ANODE D2
 - 14 COMMON ANODE D1
 - 15 CATHODE B D1
 - 16 CATHODE A D1
 - 17 CATHODE G D1
 - 18 CATHODE F D1

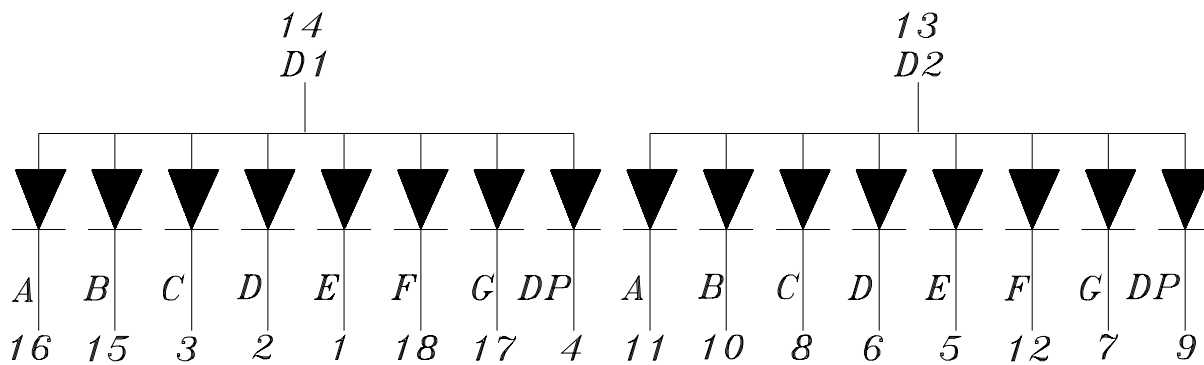
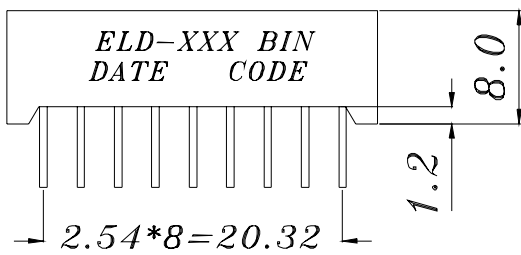

Notes: 1.All dimensions are in millimeters, tolerance is 0.25mm unless otherwise noted.

2.Above specification may be changed without notice.

Supplier will reserve authority on material change for above specification.

**Technical Data Sheet
0.56" Dual Digit Displays****ELD-512SURWB/S530-A3**

■ Absolute maximum ratings at Ta = 25°C :

| Parameter | Symbol | Rating | Unit |
|--|-----------------------|-------------|------|
| Reverse Voltage | V _R | 5 | V |
| Forward Current | I _F | 25 | mA |
| Operating Temperature | T _{opr} | -40 to +85 | °C |
| Storage Temperature | T _{stg} | -40 to +100 | °C |
| Soldering Temperature | T _{sol} | 260 ± 5 | °C |
| Electrostatic Discharge | ESD | 2000 | V |
| Power Dissipation | P _d | 60 | mW |
| Peak Forward Current(Duty 1/10 @ 1KHz) | I _F (Peak) | 160 | mA |

■ Electronic optical characteristics :

| Parameter | | Symbol | Min. | Typ. | Max. | Unit | Condition |
|------------------------------|-------------------|----------------|------|------|------|------|----------------------|
| Luminous Intensity | Per segment | I _v | ---- | 4.0 | ---- | mcd | I _F =2mA |
| | | | 7.8 | 15.0 | ---- | | I _F =10mA |
| | Per decimal point | | ---- | 1.2 | ---- | mcd | I _F =2mA |
| | | | 2.5 | 4.5 | ---- | | I _F =10mA |
| Peak Wavelength | | λ _p | ---- | 632 | ---- | nm | I _F =20mA |
| Dominant Wavelength | | λ _d | ---- | 624 | ---- | nm | I _F =20mA |
| Spectrum Radiation Bandwidth | | Δλ | ---- | 20 | ---- | nm | I _F =20mA |
| Forward Voltage | | V _F | ---- | 2.0 | 2.4 | V | I _F =20mA |
| Reverse Current | | I _R | ---- | ---- | 100 | μA | V _R =5V |



Technical Data Sheet
0.56" Dual Digit Displays

ELD-512SURWB/S530-A3

Typical Electro-Optical Characteristic Curves:

(SUR)

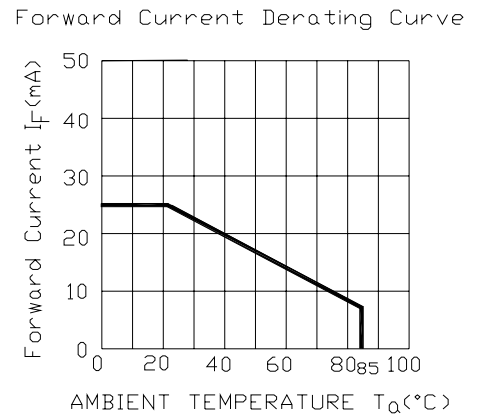
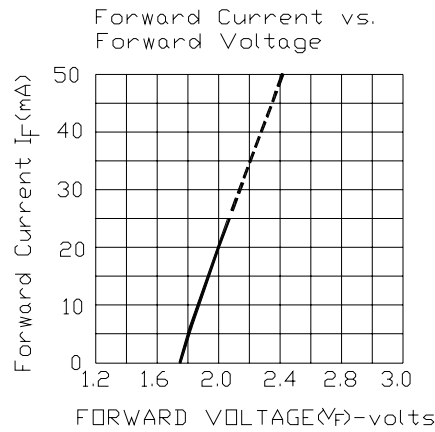
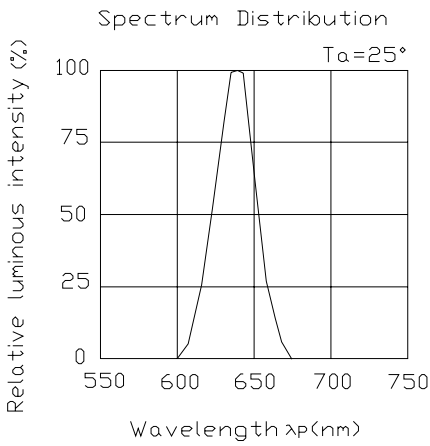

**Technical Data Sheet**
0.56" Dual Digit Displays**ELD-512SURWB/S530-A3****Reliability test items and conditions:**

| NO | Item | Test Conditions | Test Hours/Cycle | Sample Size | Ac/Re |
|----|----------------------------------|---|------------------|-------------|-------|
| 1 | Solder Heat | TEMP : 260°C ± 5 °C | 5 SEC | 76 PCS | 0/1 |
| 2 | Temperature Cycle | H : +85°C 30min ∫ 5 min L : -55°C 30min | 50 CYCLE | 76 PCS | 0/1 |
| 3 | Thermal Shock | H : +100°C 5min ∫ 10 sec L : -10°C 5min | 50 CYCLE | 76 PCS | 0/1 |
| 4 | High Temperature Storage | TEMP : 100°C | 1000 HRS | 76 PCS | 0/1 |
| 5 | Low Temperature Storage | TEMP : -55°C | 1000 HRS | 76 PCS | 0/1 |
| 6 | DC Operating Life | IF = 10 mA | 1000 HRS | 76 PCS | 0/1 |
| 7 | High Temperature / High Humidity | 85°C/85% RH | 1000 HRS | 76 PCS | 0/1 |