

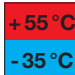



BR 35 Signal Tower





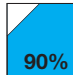



- modular design with six different coloured elements and six different mounting methods for an infinite number of combinations
- high level of protection against electric shock
- light is intensified by the prismatic arrangement inside the impact- and heat-resistant, dustproof polycarbonate globes and is clearly visible from all sides
- sophisticated design and only 35 mm in cross-section
- the BR 35 is the crowning glory on machinery and production lines
- suitable for electronic manufacturing, laboratories, medicine technology and all other indoor applications
- under both technological and economical aspects, the ideal solution for any application
- design patent 9706583.8; utility model registration No. 297 168 67.3

			
Protective system (not for sound module)	With LED	With bulb	Relative humidity

Technical data:

Rated voltages	230V AC, 24V DC, 12V DC / 12-24V AC/DC LED		
Lamp	DC: BA9 S, max. 4W AC: BA9 S, 3W		
Optional	LED lamps		
No. of modules	max. 4		
Colours	 red  yellow  amber  green  clear  blue		
Electrical terminal	cable, 50 cm (19.6"), for tube mounting only		
Diameter	35 mm (1.4"), square-shaped		
Dimensions	L1	L2	L3
single-stage	228 (9.0")	228 (9.0")	210 (8.3")
2-stages	276 (10.8")	276 (10.8")	258 (10.1")
3-stages	324 (12.7")	324 (12.7")	306 (12.0")
4-stages	372 (14.6")	372 (14.6")	354 (13.9")

Plastic or metal bracket optional! * 24VDC + 12VDC

For using the BR 35 with sounder, please be aware, that the upper stage needs to be rebuilt from a light to a sounder stage. i.e.: In case you need a red + green + sounder lamp, please order a 3-stage lamp plus a sounder kit.

Ready for connection:



Accessories:

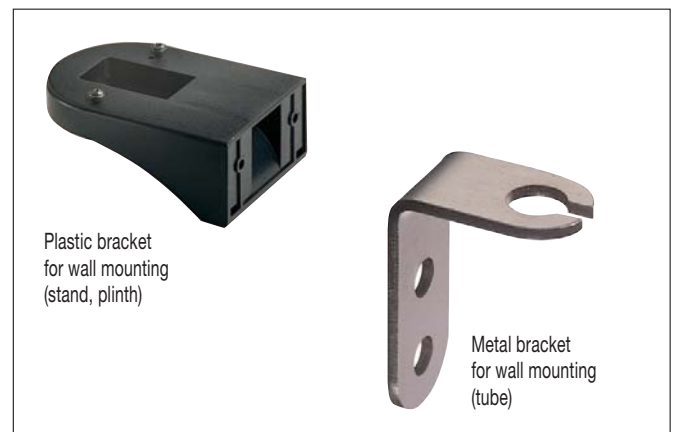

Mounting stand

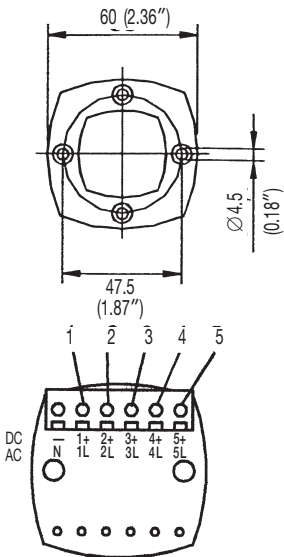
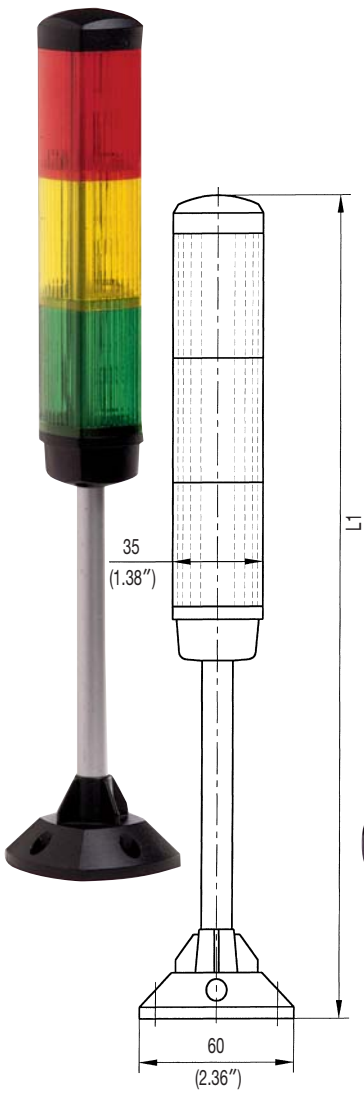

Plinth mounting

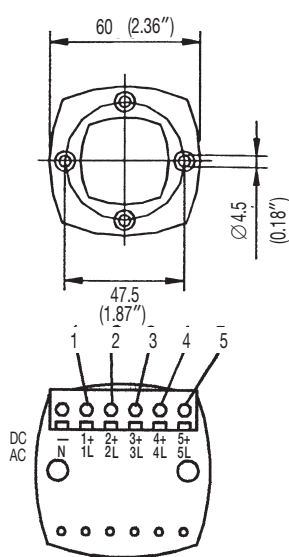
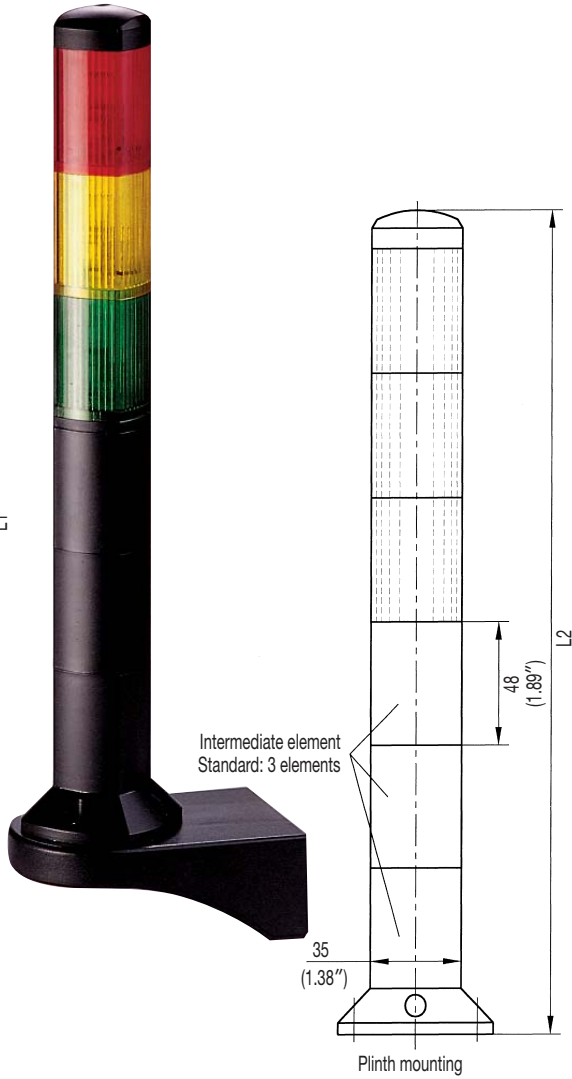

Tube mounting

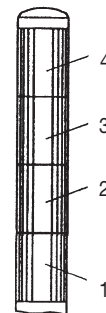
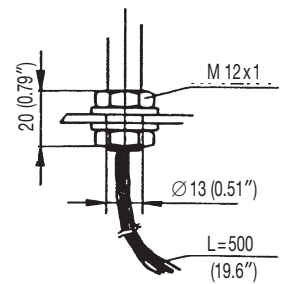
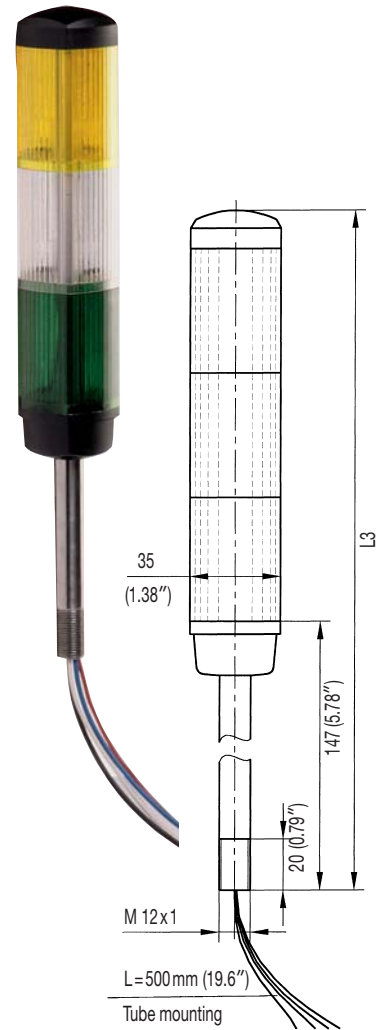

- Colours of cable
- 1 = grey
 - 2 = red
 - 3 = blue
 - 4 = green
 - /N = black



How to order:

Product description	Order designation	Order No.
for stand mounting:		
single-stage	24 V DC	BR 35-1-S
	115 V AC	BR 35-1-S
	230 V AC	BR 35-1-S
2 stages	24 V DC	BR 35-2-S
	115 V AC	BR 35-2-S
	230 V AC	BR 35-2-S
3 stages	24 V DC	BR 35-3-S
	115 V AC	BR 35-3-S
	230 V AC	BR 35-3-S
4 stages	24 V DC	BR 35-4-S
	115 V AC	BR 35-4-S
	230 V AC	BR 35-4-S
fixed colour sequence: A (top) = red B (middle) = yellow C (bottom) = green		
3 stages	24 V DC	BR 35-3-S
	115 V AC	BR 35-3-S
	230 V AC	BR 35-3-S
for plinth mounting:		
single-stage	24 V DC	BR 35-1-P
	115 V AC	BR 35-1-P
	230 V AC	BR 35-1-P
2 stages	24 V DC	BR 35-2-P
	115 V AC	BR 35-2-P
	230 V AC	BR 35-2-P
3 stages	24 V DC	BR 35-3-P
	115 V AC	BR 35-3-P
	230 V AC	BR 35-3-P
4 stages	24 V DC	BR 35-4-P
	115 V AC	BR 35-4-P
	230 V AC	BR 35-4-P
for tube mounting:		
single-stage	24 V DC	BR 35-1-T
	115 V AC	BR 35-1-T
	230 V AC	BR 35-1-T
2 stages	24 V DC	BR 35-2-T
	115 V AC	BR 35-2-T
	230 V AC	BR 35-2-T
3 stages	24 V DC	BR 35-3-T
	115 V AC	BR 35-3-T
	230 V AC	BR 35-3-T
4 stages	24 V DC	BR 35-4-T
	115 V AC	BR 35-4-T
	230 V AC	BR 35-4-T
5-stage versions on request		
LED LIGHT BULBS		
white	12 V DC / 24 V DC	BR 35-LED
yellow	12 V DC / 24 V DC	BR 35-LED
red	12 V DC / 24 V DC	BR 35-LED
green	12 V DC / 24 V DC	BR 35-LED
blue	12 V DC / 24 V DC	BR 35-LED
ACCESSORIES		
Mounting bracket (ABS) for stand mounting or plinth mounting	BR 35-W	282 35 20 0 020
Mounting bracket (metal) for tube mounting	BR 35-A	282 35 20 0 010
Assembly kit sounder module		282 35 80 8 000
SPARE PARTS		
Light bulbs for BR 35 (kit 5 pieces)	12 V DC / 4 W	BR 35 BA 9 s
	24 V DC / 4 W	BR 35 BA 9 s
	110 V AC / 3 W	BR 35 BA 9 s
	230 V AC / 3 W	BR 35 BA 9 s
Light filter for BR 35 (available colours: clear, yellow, amber, red, green, blue)		

How to order:

<p>Mounting stand</p> <p>Sample order: 3 stages BR 35 with mounting stand 24 V DC with colour sequence: A = red B = yellow C = green</p> <p>Order No. 220 80 80 3 000</p>	<p>Plinth mounting</p> <p>Sample order: 3 stages BR 35 with plinth mounting 230 V AC with colour sequence: A = red B = yellow C = green</p> <p>Order No. 220 81 10 3 000</p>	<p>Tube mounting</p> <p>Sample order: 3 stages BR 35 with tube mounting 24 V DC with colour sequence: A = yellow B = clear C = green</p> <p>Order No. 220 82 80 3 000</p>
--	---	--