

## Consolidation point Installation solutions from a single supplier

Bachmann's new system for under-floor distribution and installation, based on the MUTO (multi-user terminal outlet) concept, offers a coherent and simple installation solution that brings power and data to the desktop.

The consolidation points for power and data are linked to the floor distributor in the conventional way. Floor outlets and desktop power strips from the Bachmann Facility range complete the installation kit. After the consolidation point the floor outlet allows power and data to be conveyed with ease to the workstation. This dispenses with complicated and inflexible installations such as traditional floor box systems.

Thanks to the "open-office cabling", CP and MUTO concepts the network installation is flexible, future-proof and at the same time cost-optimised. The combination of power and data connections can be found in various Bachmann FACILITY SOLUTIONS. They thus offer a user-focused unit providing all necessary connections.

In the complete Bachmann catalogue you can also find various desktop power strips for mounting on top of or fitting into office workstation desks. All versions can be configured as required and supplied ready for use.

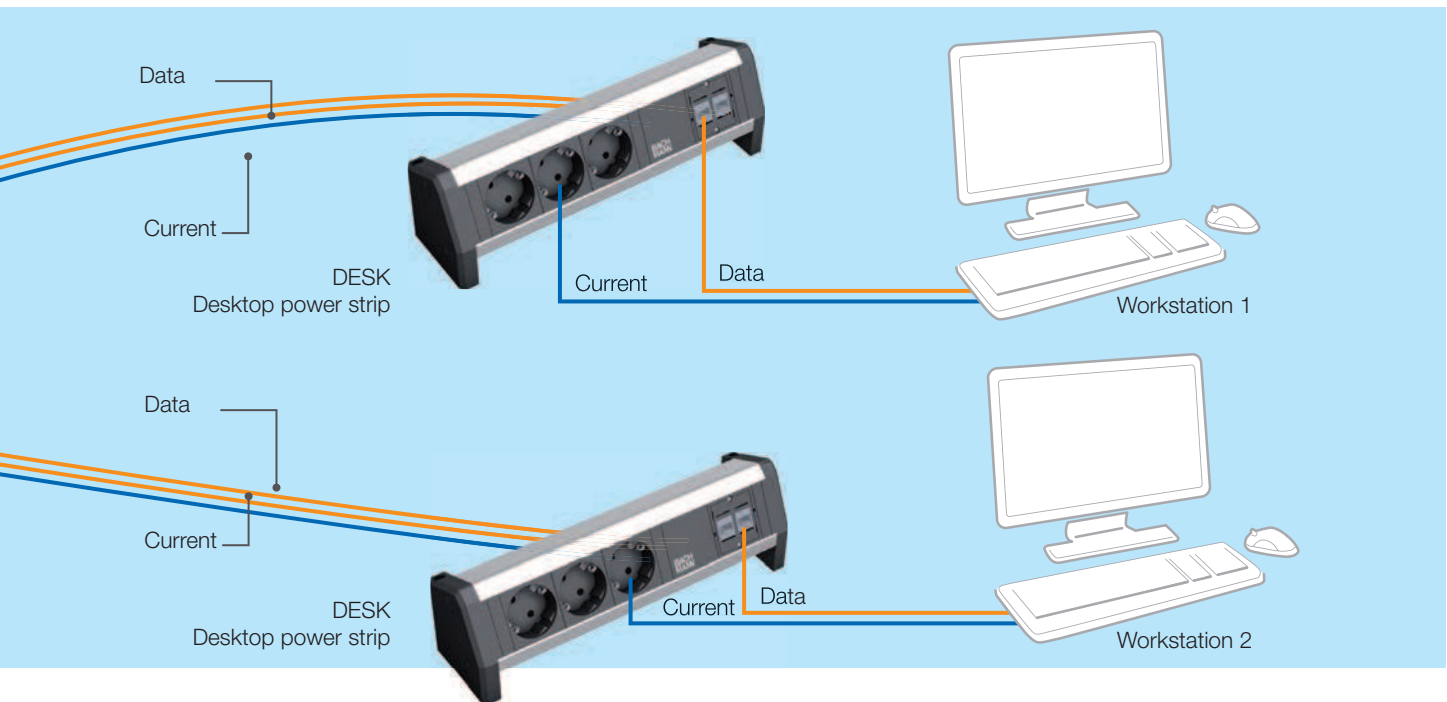

**CP mounting**

- Robust steel plate mounting for CPs
- Mountings with secure, tool-free clip-in and release mechanism
- Anchors firmly on the floor with integrated screw-on brackets
- Mountings with extra step protection of approx. 200 kg incl. CP unit
- Raised position of CP units for greater protection in case of minor ingress of water



**CP power**

- Power CP is fully wired and electrically tested at the factory
- Power connections with connector systems by Wieland (Gesis GST); Wago (Winsta) versions available on request
- Other connector systems can be fitted if required
- Time-optimised on-site installation
- Future-proof thanks to flexible structure



**CP data**

- CP data - flexible and modular based on custom modules
- Various manufacturers' systems can be integrated
- Easy to install and future-proof thanks to modular structure
- Should a change be necessary, only the data connector unit is changed
- Mounting and unit remain unchanged
- Additional strain relief for data connection can be provided with cable ties



Consolidation point units for power

- Fully wired and electrically tested
- With Wieland GST18i3 plug-in connector

Art. no. | Version

**Consolidation point units for power**

Short

919.2000	· 6-way GST18i3 socket, black, 1-phase · Power input: GST18i3
919.2001	· 2 x 3-way GST18i3 socket, 2-phase · Sockets in black and red · Power input: GST18i3

**Consolidation point units for power**

Long

919.2002	· 12-way GST18i3 socket, black, 1-phase · Power input: GST18i3
919.2003	· 2 x 6-way GST18i3 socket, 2-phase · Sockets in black and red · Power input: GST18i3
919.2004	· 3 x 4-way GST18i3 socket, 3-phase · Sockets in black, red and grey · Power input: 3x GST18i3 socket
919.2005	· 3 x 4-way GST18i3 socket, 3-phase · Sockets in red, black and grey · Power input is via the end cap with rewirable terminal to allow connection by user



Consolidation point units for data

- Without power, to integrate with Bachmann custom modules
- Anodised aluminium profile

Art. no. | Version

**C Consolidation point units for data**

912.000	· 3 x custom modules, empty · Short: 217 mm
912.001	· 6 x custom modules, empty · Long: 356 mm



Consolidation point mounting

- Colour black similar to RAL 9005
- Mounting, steel plate

Art. no. | Version

**Consolidation point mounting**

**L x W x H: 295 x 85 x 65 mm**

919.1100	· Short (for units with 3 modules)
----------	------------------------------------

**Consolidation point mounting**

**L x W x H: 435 x 85 x 65 mm**

919.1101	· Long (for units with 6 modules)
----------	-----------------------------------



Floor outlet for dry-maintained floors

---

Outlet for dry-maintained floors (raised and false floors) from 24 mm thickness for the cable outlet from the sub-floor (consolidation point) to the power strip on the desk. The outlet features a very simple universal fixing. With one rotation of each of the two eccentric Allen bolts in the outer ring the outlet is anchored firmly into the floor, yet can easily be removed again if required. Two flaps, each of which can be opened to a position independent of the other, allow cabling to be routed out from the floor. The flaps can be snap-fastened in open positions, thus preventing cables becoming bent and possibly damaged. If required the flaps can be rotated through 130° with the inner ring. Textile-fibre sleeves or cable management systems from the Bachmann range can be docked to the outlet flaps. If the outlet is no longer used, the flaps can be lowered and used as a blank cover that can be stepped on.

- Exit point/ground outlet for power supply lines and data lines
- Fits in raised floors with thicknesses from 24 mm
- For hole diameter 112 mm
- Simple fixing mechanism with Allen bolts
- 2 flaps, rotatable though approx. 130°, for cable outlet
- Material: polyamide (halogen-free)

Art. no. | Version

**Exit point/ground outlet**

**similar to RAL 9005**

919.1000 | · Black similar to RAL 9005

