

BARdolino Aluminium-Profile high

- high quality aluminium profile, anodised
- flexibly useable as surface-mounted, ground or luminaire profile
- seamless integration into the architecture possible
- in combination with an opal white cover and compatible LEDlight flex, a homogenous light distribution can be achieved
- RAL powder coating on request



Please refer to the notes on expansion and assembly at the end of the data sheet!

ALUMINIUM PROFILE

	62399101	62399102	62399103	62399105
Length	1000 mm	2010 mm	3020 mm	5030 mm
Width	18,4 mm			
Height	19,7 mm			
Material	Aluminium EN AW 6060			
Finish	anodised			
Weight	263 gr	526 gr	789 gr	1315 gr

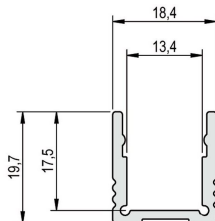

COVER

	62399301	62399311	62399351	62399361	62399371	62399401
Description	cover opal white, PMMA, for a homogenous and glare-free light distribution	cover opal white, PMMA, walkable up to 500 kg, break-proof/impact resistant	cover reflector, opal white, PMMA, for up to 20% more effective lumen yield more effective lumen yield	cover high, opal white, PMMA, 180°, for an allround homogenous light distribution	cover satined, PMMA, for a diffused light distribution and concealment of the technology	cover clear, PMMA, for maximum light yield and protection of the LED strip
Material	PMMA					
Transmission in %	69			85		92
Fire protection class	B2 DIN4102					
Length	1000 mm					
Width	14,8 mm		18,4 mm		14,8 mm	
Height	8 mm		15,1 mm	17,8 mm	8 mm	
Weight	45 gr	50 gr	69 gr	89 gr	45 gr	

For other lengths please replace the last digit of the article number by: 2 = 2.01m / 3 = 3.02m / 5 = 5.03m



END CAPS

	62398606	62398613	62399369	62399608
Description	1x BARdolino end cap high, aluminium, with drill hole M8x1 thread for cable (Ø 3.5 - 5.5mm), incl. 2 screws, thickness: 3mm (e.g. for cable connection)	2x BARdolino end cap high, aluminium, incl. 4 screws, thickness: 3mm	2x BARdolino end caps frosted for plastic cover high 180°	1x BARdolino end cap high, aluminium, with 90° wall clip, incl. 2 screws
Material	Aluminium		Plastics	Aluminium
Length	3 mm		2 mm	1,5 mm
Width	18,4 mm			
Height	19,7 mm		13 mm	19,7 mm
Weight	2 gr	6 gr	1 gr	2 gr



MOUNTING CLIPS

	50990090	50990091	50990190	50990191	50990291
Description	2x mounting clips, incl. screws, suitable for profiles of the BARdolino family	2x mounting clips 45°, incl. screws, suitable for profiles of the BARdolino family	mounting clip set, incl. 2 holding clips + 2 screws, 306 stainless steel, high holding force, suitable for profiles of the BARdolino family	2x mounting clips pivoted, incl. screws, suitable for profiles of the BARdolino family	1x metal connector, suitable for profiles of the BARdolino family
Material	304 stainless steel				
Length	12 mm		14 mm	18,8 mm	60 mm
Width	19,3 mm	15,4 mm	20,81 mm	32,3 mm	19,5 mm
Height	8 mm	18,6 mm	9,1 mm	22,4 mm	6,2 mm
Weight	2 gr		4 gr	17 gr	5 gr



Please note that the materials aluminum and PMMA can expand when the temperature changes vary greatly. With a temperature change of 20°C the expansion difference can be up to 1.2 mm per meter! This is no deficiency of the product but a normal physical process.

Installation note: If you directly install two aluminum profiles edge to edge (without end caps), please pay attention during installation, that you don't glue the LED strip directly over the joint, since the profiles at temperature fluctuations - especially at large lengths - will expand/contract (s. section 1) and then the LED tape may be damaged. At joints the LED strip has to be cut at the marked positions and reconnected with flexible solder bridges with corresponding expansion reserve (min. 5mm).