

## RAFIX 16 - Emergency stop pushbutton, square collar, illuminated

**1.30.074.501/0304**

Only use universal contact blocks with momentary function.



### General information

Actuator	mushroom
Color of mushroom	translucent red
Form of collar	square

### Dimensions

Collar dimensions	24.95 x 24.95 mm
Collar dimensions	24.95 x 24.95 mm
Overall height	19.3 mm
Mounting depth	44.7 mm
Mounting hole	16.2 mm

### Mechanical design

Mounting	ring nut
Contact function	latching
Contact arrangement	according to contact block
Illumination	yes
Reset	counterclockwise or clockwise rotation

### Mechanical characteristics

Robustness max.	100 N
Robustness	acc. to IEC 60947-5-5

### Other specifications

Operating life (operations)	30,000 cycle
Degree of protection from front side	IP65 (DIN EN 60529)
Operation temperature min.	-25 °C
Ambient temp. operating max. without lamp / LED	+70 °C
Ambient temp. operating max. with lamp /LED	+55 °C
Storage temperature min.	-40 °C
Storage temperature max.	+85 °C
Environmental resistance	acc. to IEC 60068-2-14, -30, -33 and -78
Corresponding to CE Ma-Dir. 89/392	yes
Dupe-proof acc. to DIN EN ISO 13850	no
ROHS compliant	yes
REACH compliant	yes

## Panel cut-out

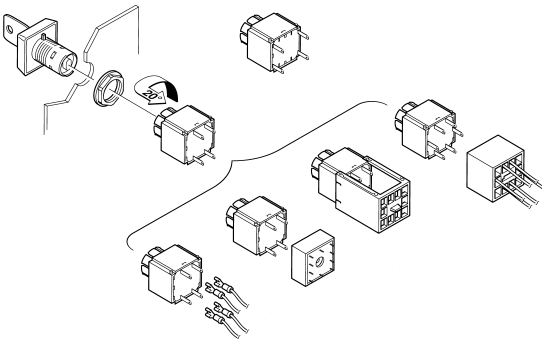
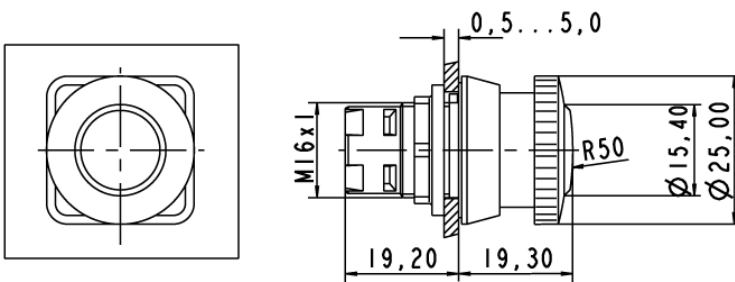

# Mouser Electronics

Authorized Distributor

Click to View Pricing, Inventory, Delivery & Lifecycle Information:

RAFI:

[1.30.074.501/0304](#)