

# ATEN Control System

## VK112EU 12-button Keypad (EU, 2 Gang)

- The VK112EU is a fully-customizable 12-button keypad designed for use with the ATEN Control System. The keypad provides an interface to control devices in a room from a standard wall mounted faceplate. Created with flexibility in mind, the 2-gang keypad can be laid out in 125 different combinations of 6 to 12 buttons that snap together as easy as Lego's. By connecting to the VK2100/VK1100 Control Box over a LAN, users will find it's effortless using VK6000 software to configure the desired control of any connected device from the keypad. With the buttons ready to go, you have instant and smart control of the facilities from a keypad or keypads that can manage any device in the room. The VK112EU is an affordable solution, perfect to serve as the primary interface in meeting rooms, or as secondary device control in classrooms and conference centers.



**Note:** This model is also available in black color – Part number: VK112EU1, which is a built-to-order product. To place an order, please contact your regional ATEN representative.

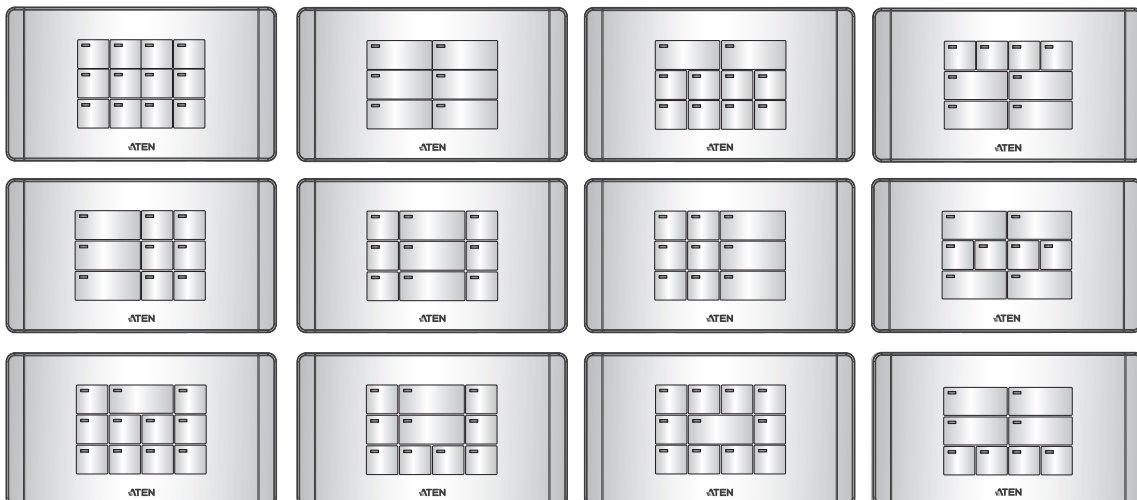

Custom button placement on the keypad can be set in 125 different combinations of 6 to 12 buttons. The example above shows the 12 most commonly used.

## Features

- Key pad - provides physical connection to the ATEN Control System
- Fully customizable with 125 layout combinations of 6 to 12 buttons
- Available in black or white color
- System LED indicators for quick connection status check
- Dual-color button LEDs for clear indication and visibility in dark environments
- Easy ID pairing with Control Box for Ethernet communication
- Up to 8 keypads connect to a single Control Box for future scalability
- Versatile modes support flexible behavior settings for each button
- Intuitive web GUI for easy keypad configuration
- Redundant power supplies with Power over Ethernet (PoE) and DC power
- Button engraving service

## Highlights

<b>Fully Customizable with Ease</b>	<p>The VK112EU's customizability allows system integrators to fulfill diverse applications with ease. The hardware supports two button sizes that can form 125 layout combinations of 6 to 12 buttons, while the VK6000 software provides versatile modes for each button: normal, toggle, press and release, and long press. The keypad mode and status can be synchronized with other keypads on the same network. Furthermore, the swappable buttons allow the keypad layout to be changed even when it's online and mounted to the wall. This superior flexibility facilitates system integrators who need to quickly answer to customer requirements and changes that are demanded.</p>
<b>Single Cable Installation</b>	<p>The VK112EU's LAN port supports Power over Ethernet (PoE) that allows both data and electric power to be transmitted over one single Ethernet cable, eliminating the need of an extra power source and extra wiring. For applications that require a direct electrical supply, the VK112EU can also be powered via a 5 VDC power adapter.</p>
<b>No Complicated IP Setup</b>	<p>Ethernet-based solutions normally involve configuring complicated IP and network settings before you can access a device. With our ID concept implemented into ATEN products, all IP and network settings are auto-configured for the VK112EU and other ATEN Control Box peripherals (sold separately). Simply pair the ID number of the keypad with the ID number of the Control Box and the network setting is completed!</p>

## Installation Setup

### Set Keypad Layout

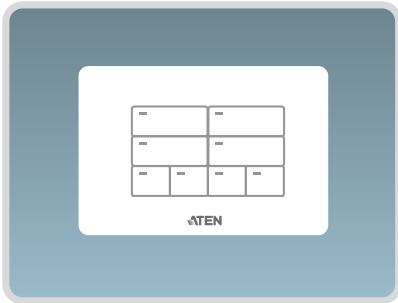

### Pair with Control Box

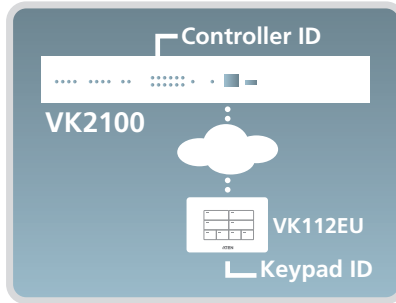

### Configure Settings

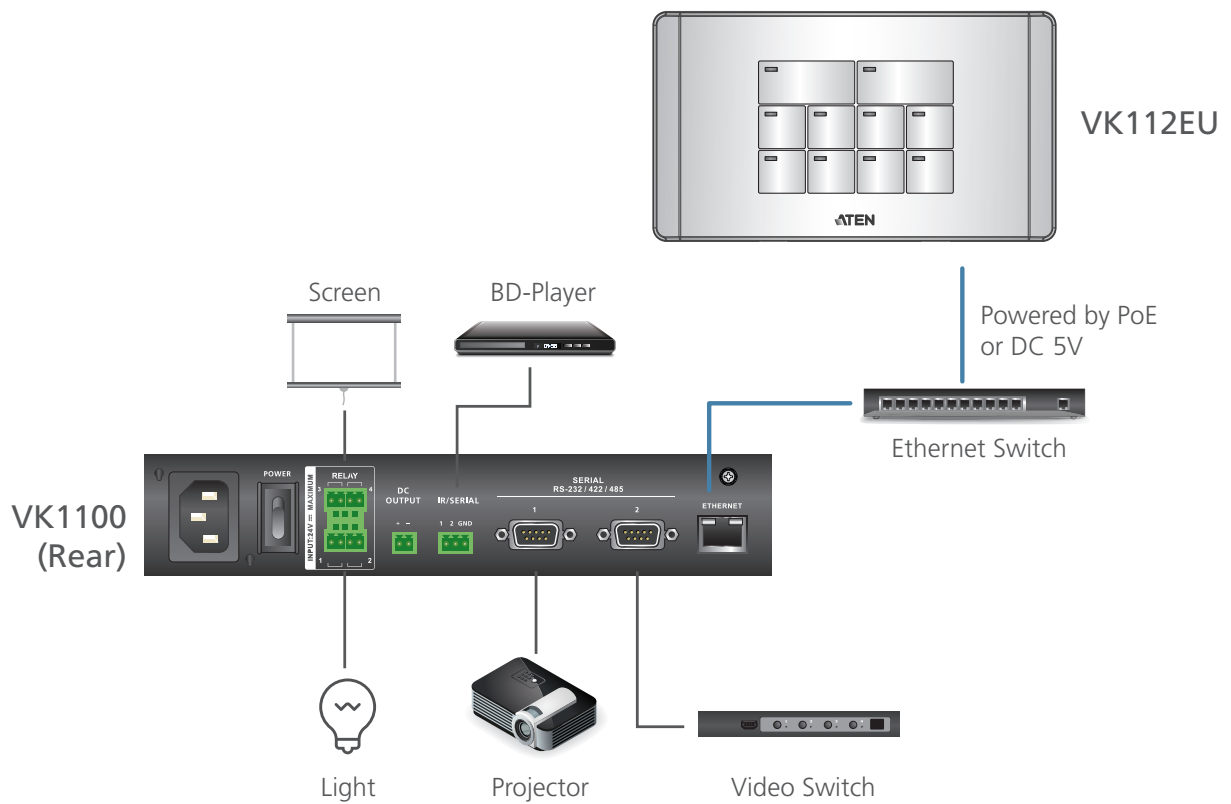

## Specifications

Function	VK112EU
<b>Interfaces</b>	
Ethernet	<ul style="list-style-type: none"> <li>• 1 x RJ-45 Female, 10/100Base-T</li> <li>• Supported Protocol: ICMP, TCP/IP, DHCP, HTTPS</li> <li>• DHCP-enabled. The following default IP settings will be used if no IP is assigned within 30 seconds: IP: 192.168.0.60 Subnet Mask: 255.255.255.0</li> </ul>
Keypad Layout	6~12 buttons customizable in 125 keypad layouts
<b>Switches</b>	
Controller ID	1 x 16-segment Switch
Keypad ID	1 x 8-segment Switch
<b>Reset Button</b>	1 x Semi-recessed Pushbutton
<b>Power</b>	
Consumption	DC5V: 1.25W (adapter); DC48V: 1.56W (PoE, PoE 802.3 AF/AT compatibility)
<b>Environmental</b>	
Operating Temperature	0° to 50° C
Storage Temperature	-20° to 60° C
Humidity	0 - 80% RH, Non-Condensing
<b>Physical Properties</b>	
Housing	Plastic
Weight	0.17 kg
Dimensions (L x W x H)	8.32 x 14.76 x 4.80 cm
Faceplate Dimension (L x W x H)	8.62 x 15.12 x 0.92 cm

Product information is subject to change without prior notice.

### ATEN International Co., Ltd.

3F., No.125, Sec. 2, Datong Rd., Sijhih District., New Taipei City 221, Taiwan  
 Phone: 886-2-8692-6789 Fax: 886-2-8692-6767  
 www.aten.com E-mail: marketing@aten.com

Publish Date: 07/2020 V3.0



© Copyright 2020 ATEN® International Co., Ltd.  
 ATEN and the ATEN logo are trademarks of ATEN International Co., Ltd.  
 All rights reserved. All other trademarks are the property of their respective owners.