

VARIODRIVE-Motor

VD-1-43.10



- 1-phase, 2-core reluctance motor as external rotor version.
- EC technology.
- Dynamically balanced rotor with 4-pole, plastic-bonded ferrite magnet.
- Determination of rotor position via Hall sensor.
- Commutation electronics fully integrated in the motor.
- Load-dependent speed setting via connection voltage.
- Customer-specific winding layout and / or motor part sets available on request.

Nominal Data

Type		VD-1-43.10	...504	...508
Nominal voltage (U_{BN})	V DC	24 (12 ... 28)	12	24 (12 ... 25)
Nominal speed (n_N)	min ⁻¹	4 000	3 800	3 450
Nominal torque (M_N)	mNm	18	11	19.5
Nominal current (I_{BN})	A	0.55	0.7	0.5
Nominal output power (P_N)	W	7.5	4.4	7.0
Free-running speed (n_I)	min ⁻¹	7 000	5 250	6 300
Free-running current (I_{BL})	A	0.18	0.3	0.15
Induced voltage (U_{imax})	V/1000min ⁻¹	3.7	2.19	4.0
Average starting torque	mNm	70	50	50
Max. starting current	A	2.5	3.0	1.5
Rotor moment of inertia (J_R)	kgm ² x10 ⁻⁶	40	40	40
Thermal resistance (R_{Th})	K/W	4.5	5,0	5,0
Protection class		IP 00	IP 00	IP 00
Ambient temperature range (T_U)	°C	0 ... +40	0 ... +40	0 ... +40
Motor mass (m)	kg	0.24	0.24	0.24
Order No.	Clockwise rotation	937 4310 500	937 4310 504	937 4310 508
Order No.	Counterclockwise rotation	937 4310 550	-	-

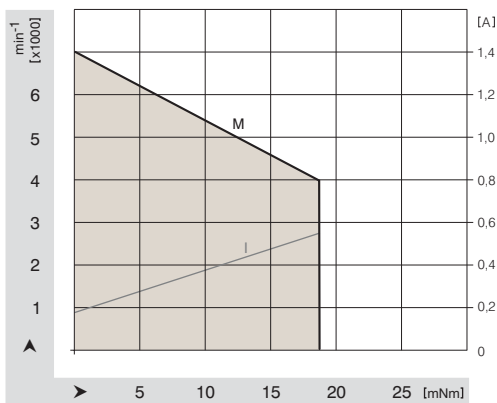
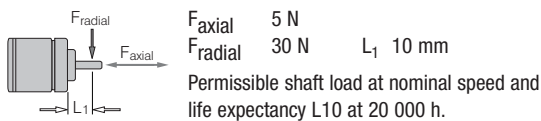

Electrical connection:
 Electrical connection via 2 single leads, AWG 22, TR 64, 300 mm long with stripped and tinned ends.
 + = red - = blue

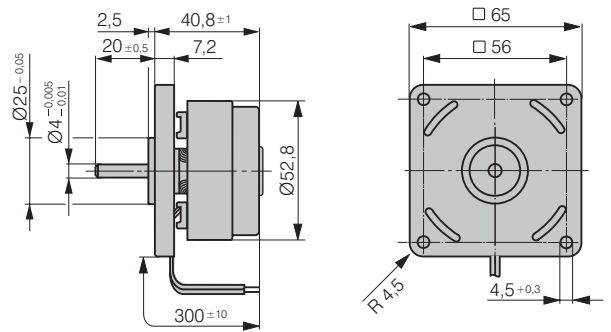

Type 504 / 508: VARIODRIVE with round flange

