

HAND HELD CASES

IP67 Handheld Enclosures

IP67 waterproofed enclosures, stylish design with chamfered edge and made from flame-resistant ABS (UL94-V0)

- Manufactured in ABS UL94-V0
- Available in black or white
- Rubber (TPE) sides provide a soft touch feel and extra protection (five colours available)
- Seven types - plain (no battery), x4 AAA, x3 AAA, x2 AAA x4 AA, x3 AA and x2 AA
- Suitable for various hand-held apparatus, such as measuring instruments, inspection machines, transmitters and medical equipment

SPECIFICATION

Material	Base & lid ABS UL94-V0
Operating temperature	-10°C to +60°C
Standard colours	Black or white
Standard unit includes	Base, lid, sides, gasket & screws

TAKACHI PART NO.	LENGTH	WIDTH	HEIGHT	DESCRIPTION
WH145-20-F4-BB	146mm	88mm	20mm	x4 AAA batt comp
WH145-20-F4-BL	146mm	88mm	20mm	x4 AAA batt comp
WH145-20-F4-BN	146mm	88mm	20mm	x4 AAA batt comp
WH145-20-F4-BR	146mm	88mm	20mm	x4 AAA batt comp
WH145-20-F4-BY	146mm	88mm	20mm	x4 AAA batt comp
WH145-20-F4-WB	146mm	80mm	20mm	x4 AAA batt comp
WH145-20-F4-WL	146mm	80mm	20mm	x4 AAA batt comp
WH145-20-F4-WN	146mm	80mm	20mm	x4 AAA batt comp
WH145-20-F4-WR	146mm	80mm	20mm	x4 AAA batt comp
WH145-20-F4-WY	146mm	80mm	20mm	x4 AAA batt comp
WH145-20-N-BB	146mm	88mm	20mm	Plain
WH145-20-N-BL	146mm	88mm	20mm	Plain
WH145-20-N-BN	146mm	88mm	20mm	Plain
WH145-20-N-BR	146mm	88mm	20mm	Plain
WH145-20-N-BY	146mm	88mm	20mm	Plain
WH145-20-N-WB	146mm	80mm	20mm	Plain
WH145-20-N-WL	146mm	80mm	20mm	Plain
WH145-20-N-WN	146mm	80mm	20mm	Plain
WH145-20-N-WR	146mm	80mm	20mm	Plain
WH145-20-N-WY	146mm	80mm	20mm	Plain

TAKACHI PART NO.	LENGTH	WIDTH	HEIGHT	DESCRIPTION
WH145-25-M2-BB	146mm	88mm	25mm	x2 AA batt comp
WH145-25-M2-BL	146mm	88mm	25mm	x2 AA batt comp
WH145-25-M2-BN	146mm	88mm	25mm	x2 AA batt comp
WH145-25-M2-BR	146mm	88mm	25mm	x2 AA batt comp
WH145-25-M2-BY	146mm	88mm	25mm	x2 AA batt comp
WH145-25-M2-WB	146mm	80mm	25mm	x2 AA batt comp
WH145-25-M2-WL	146mm	80mm	25mm	x2 AA batt comp
WH145-25-M2-WN	146mm	80mm	25mm	x2 AA batt comp
WH145-25-M2-WR	146mm	80mm	25mm	x2 AA batt comp
WH145-25-M2-WY	146mm	80mm	25mm	x2 AA batt comp
WH145-25-M3-BB	146mm	88mm	25mm	x3 AA batt comp
WH145-25-M3-BL	146mm	88mm	25mm	x3 AA batt comp
WH145-25-M3-BN	146mm	88mm	25mm	x3 AA batt comp
WH145-25-M3-BR	146mm	88mm	25mm	x3 AA batt comp
WH145-25-M3-BY	146mm	88mm	25mm	x3 AA batt comp
WH145-25-M3-WB	146mm	80mm	25mm	x3 AA batt comp
WH145-25-M3-WL	146mm	80mm	25mm	x3 AA batt comp
WH145-25-M3-WN	146mm	80mm	25mm	x3 AA batt comp
WH145-25-M3-WR	146mm	80mm	25mm	x3 AA batt comp
WH145-25-M3-WY	146mm	80mm	25mm	x3 AA batt comp
WH145-25-N-BB	146mm	88mm	25mm	Plain
WH145-25-N-BL	146mm	88mm	25mm	Plain
WH145-25-N-BN	146mm	88mm	25mm	Plain
WH145-25-N-BR	146mm	88mm	25mm	Plain
WH145-25-N-BY	146mm	88mm	25mm	Plain
WH145-25-N-WB	146mm	80mm	25mm	Plain
WH145-25-N-WL	146mm	80mm	25mm	Plain
WH145-25-N-WN	146mm	80mm	25mm	Plain
WH145-25-N-WR	146mm	80mm	25mm	Plain
WH145-25-N-WY	146mm	80mm	25mm	Plain

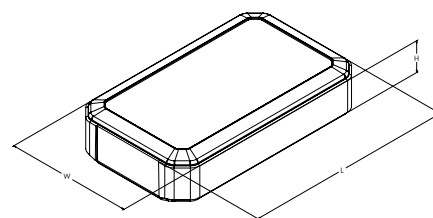
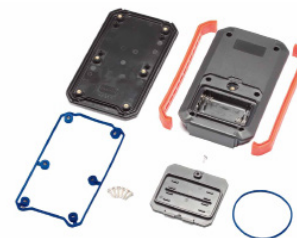

HAND HELD CASES

IP67 Handheld Enclosures

TAKACHI PART NO.	LENGTH	WIDTH	HEIGHT	DESCRIPTION
WH145-33-M2-BB	146mm	88mm	33mm	x2 AA batt comp
WH145-33-M2-BL	146mm	88mm	33mm	x2 AA batt comp
WH145-33-M2-BN	146mm	88mm	33mm	x2 AA batt comp
WH145-33-M2-BR	146mm	88mm	33mm	x2 AA batt comp
WH145-33-M2-BY	146mm	88mm	33mm	x2 AA batt comp
WH145-33-M2-WB	146mm	80mm	33mm	x2 AA batt comp
WH145-33-M2-WL	146mm	80mm	33mm	x2 AA batt comp
WH145-33-M2-WN	146mm	80mm	33mm	x2 AA batt comp
WH145-33-M2-WR	146mm	80mm	33mm	x2 AA batt comp
WH145-33-M2-WY	146mm	80mm	33mm	x2 AA batt comp
WH145-33-M3-BB	146mm	88mm	33mm	x3 AA batt comp
WH145-33-M3-BL	146mm	88mm	33mm	x3 AA batt comp
WH145-33-M3-BN	146mm	88mm	33mm	x3 AA batt comp
WH145-33-M3-BR	146mm	88mm	33mm	x3 AA batt comp
WH145-33-M3-BY	146mm	88mm	33mm	x3 AA batt comp
WH145-33-M3-WB	146mm	80mm	33mm	x3 AA batt comp
WH145-33-M3-WL	146mm	80mm	33mm	x3 AA batt comp
WH145-33-M3-WN	146mm	80mm	33mm	x3 AA batt comp
WH145-33-M3-WR	146mm	80mm	33mm	x3 AA batt comp
WH145-33-M3-WY	146mm	80mm	33mm	x3 AA batt comp
WH145-33-N-BB	146mm	88mm	33mm	Plain
WH145-33-N-BL	146mm	88mm	33mm	Plain
WH145-33-N-BN	146mm	88mm	33mm	Plain
WH145-33-N-BR	146mm	88mm	33mm	Plain
WH145-33-N-BY	146mm	88mm	33mm	Plain
WH145-33-N-WB	146mm	80mm	33mm	Plain
WH145-33-N-WL	146mm	80mm	33mm	Plain
WH145-33-N-WN	146mm	80mm	33mm	Plain
WH145-33-N-WR	146mm	80mm	33mm	Plain
WH145-33-N-WY	146mm	80mm	33mm	Plain

TAKACHI PART NO.	LENGTH	WIDTH	HEIGHT	DESCRIPTION
WH125-20-F2-BB	126mm	79mm	20mm	x2 AAA batt comp
WH125-20-F2-BG	126mm	79mm	20mm	x2 AAA batt comp
WH125-20-F2-BL	126mm	79mm	20mm	x2 AAA batt comp
WH125-20-F2-BR	126mm	79mm	20mm	x2 AAA batt comp
WH125-20-F2-BY	126mm	79mm	20mm	x2 AAA batt comp
WH125-20-F2-WB	126mm	79mm	20mm	x2 AAA batt comp
WH125-20-F2-WG	126mm	79mm	20mm	x2 AAA batt comp
WH125-20-F2-WL	126mm	79mm	20mm	x2 AAA batt comp
WH125-20-F2-WR	126mm	79mm	20mm	x2 AAA batt comp
WH125-20-F2-WY	126mm	79mm	20mm	x2 AAA batt comp
WH125-20-F3-BB	126mm	79mm	20mm	x3 AAA batt comp
WH125-20-F3-BG	126mm	79mm	20mm	x3 AAA batt comp
WH125-20-F3-BL	126mm	79mm	20mm	x3 AAA batt comp
WH125-20-F3-BR	126mm	79mm	20mm	x3 AAA batt comp
WH125-20-F3-BY	126mm	79mm	20mm	x3 AAA batt comp
WH125-20-F3-WB	126mm	79mm	20mm	x3 AAA batt comp
WH125-20-F3-WG	126mm	79mm	20mm	x3 AAA batt comp
WH125-20-F3-WL	126mm	79mm	20mm	x3 AAA batt comp
WH125-20-F3-WR	126mm	79mm	20mm	x3 AAA batt comp
WH125-20-F3-WY	126mm	79mm	20mm	x3 AAA batt comp
WH125-20-N-BB	126mm	79mm	20mm	Plain
WH125-20-N-BG	126mm	79mm	20mm	Plain
WH125-20-N-BL	126mm	79mm	20mm	Plain
WH125-20-N-BR	126mm	79mm	20mm	Plain
WH125-20-N-BY	126mm	79mm	20mm	Plain
WH125-20-N-WB	126mm	79mm	20mm	Plain
WH125-20-N-WL	126mm	79mm	20mm	Plain
WH125-20-N-WN	126mm	79mm	20mm	Plain
WH125-20-N-WR	126mm	79mm	20mm	Plain
WH125-20-N-WY	126mm	79mm	20mm	Plain

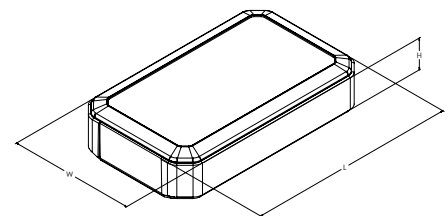
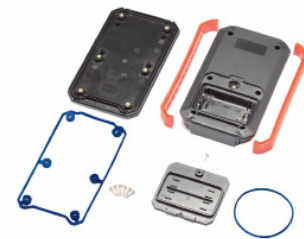

HAND HELD CASES

IP67 Handheld Enclosures

TAKACHI PART NO.	LENGTH	WIDTH	HEIGHT	DESCRIPTION
WH125-28-F2-BB	126mm	79mm	28mm	x2 AAA batt comp
WH125-28-F2-BG	126mm	79mm	28mm	x2 AAA batt comp
WH125-28-F2-BL	126mm	79mm	28mm	x2 AAA batt comp
WH125-28-F2-BR	126mm	79mm	28mm	x2 AAA batt comp
WH125-28-F2-BY	126mm	79mm	28mm	x2 AAA batt comp
WH125-28-F2-WB	126mm	79mm	28mm	x2 AAA batt comp
WH125-28-F2-WG	126mm	79mm	28mm	x2 AAA batt comp
WH125-28-F2-WL	126mm	79mm	28mm	x2 AAA batt comp
WH125-28-F2-WR	126mm	79mm	28mm	x2 AAA batt comp
WH125-28-F2-WY	126mm	79mm	28mm	x2 AAA batt comp
WH125-28-F3-BB	126mm	79mm	28mm	x3 AAA batt comp
WH125-28-F3-BG	126mm	79mm	28mm	x3 AAA batt comp
WH125-28-F3-BL	126mm	79mm	28mm	x3 AAA batt comp
WH125-28-F3-BR	126mm	79mm	28mm	x3 AAA batt comp
WH125-28-F3-BY	126mm	79mm	28mm	x3 AAA batt comp
WH125-28-F3-WB	126mm	79mm	28mm	x3 AAA batt comp
WH125-28-F3-WG	126mm	79mm	28mm	x3 AAA batt comp
WH125-28-F3-WL	126mm	79mm	28mm	x3 AAA batt comp
WH125-28-F3-WR	126mm	79mm	28mm	x3 AAA batt comp
WH125-28-F3-WY	126mm	79mm	28mm	x3 AAA batt comp
WH125-28-N-BB	126mm	79mm	28mm	Plain
WH125-28-N-BG	126mm	79mm	28mm	Plain
WH125-28-N-BL	126mm	79mm	28mm	Plain
WH125-28-N-BR	126mm	79mm	28mm	Plain
WH125-28-N-BY	126mm	79mm	28mm	Plain
WH125-28-N-WB	126mm	79mm	28mm	Plain
WH125-28-N-WG	126mm	79mm	28mm	Plain
WH125-28-N-WL	126mm	79mm	28mm	Plain
WH125-28-N-WR	126mm	79mm	28mm	Plain
WH125-28-N-WY	126mm	79mm	28mm	Plain

TAKACHI PART NO.	LENGTH	WIDTH	HEIGHT	DESCRIPTION
WH170-25-M4-BB	171mm	95mm	25mm	4xAA batt comp
WH170-25-M4-BG	171mm	95mm	25mm	4xAA batt comp
WH170-25-M4-BL	171mm	95mm	25mm	4xAA batt comp
WH170-25-M4-BR	171mm	95mm	25mm	4xAA batt comp
WH170-25-M4-BY	171mm	95mm	25mm	4xAA batt comp
WH170-25-M4-WB	171mm	95mm	25mm	4xAA batt comp
WH170-25-M4-WG	171mm	95mm	25mm	4xAA batt comp
WH170-25-M4-WL	171mm	95mm	25mm	4xAA batt comp
WH170-25-M4-WR	171mm	95mm	25mm	4xAA batt comp
WH170-25-M4-WY	171mm	95mm	25mm	4xAA batt comp
WH170-25-N-BB	171mm	95mm	25mm	Plain
WH170-25-N-BG	171mm	95mm	25mm	Plain
WH170-25-N-BL	171mm	95mm	25mm	Plain
WH170-25-N-BR	171mm	95mm	25mm	Plain
WH170-25-N-BY	171mm	95mm	25mm	Plain
WH170-25-N-WB	171mm	95mm	25mm	Plain
WH170-25-N-WG	171mm	95mm	25mm	Plain
WH170-25-N-WL	171mm	95mm	25mm	Plain
WH170-25-N-WR	171mm	95mm	25mm	Plain
WH170-25-N-WY	171mm	95mm	25mm	Plain

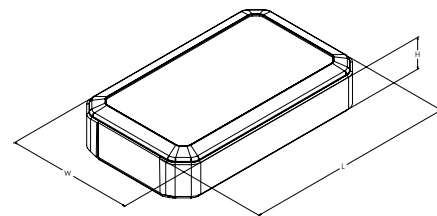
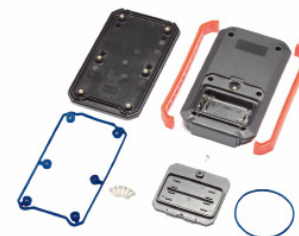

HAND HELD CASES

IP67 Handheld Enclosures

TAKACHI PART NO.	LENGTH	WIDTH	HEIGHT	DESCRIPTION
WH170-33-M4-WB	171mm	95mm	33mm	4xAA batt comp
WH170-33-M4-WG	171mm	95mm	33mm	4xAA batt comp
WH170-33-M4-WL	171mm	95mm	33mm	4xAA batt comp
WH170-33-M4-WR	171mm	95mm	33mm	4xAA batt comp
WH170-33-M4-WY	171mm	95mm	33mm	4xAA batt comp
WH170-33-M4-WB	171mm	95mm	33mm	4xAA batt comp
WH170-33-M4-WG	171mm	95mm	33mm	4xAA batt comp
WH170-33-M4-WL	171mm	95mm	33mm	4xAA batt comp
WH170-33-M4-WR	171mm	95mm	33mm	4xAA batt comp
WH170-33-M4-WY	171mm	95mm	33mm	4xAA batt comp
WH170-33-N-BB	171mm	95mm	33mm	Plain
WH170-33-N-BG	171mm	95mm	33mm	Plain
WH170-33-N-BL	171mm	95mm	33mm	Plain
WH170-33-N-BR	171mm	95mm	33mm	Plain
WH170-33-N-BY	171mm	95mm	33mm	Plain
WH170-33-N-BB	171mm	95mm	33mm	Plain
WH170-33-N-BG	171mm	95mm	33mm	Plain
WH170-33-N-BL	171mm	95mm	33mm	Plain
WH170-33-N-Bx	171mm	95mm	33mm	Plain
WH170-33-N-Bx	171mm	95mm	33mm	Plain

TAKACHI



B= Black rubber corners



L= Blue rubber corners



R= Red rubber corners



Y= Yellow rubber corners



G= Grey rubber corners



B= Black rubber corners



L= Blue rubber corners



R= Red rubber corners



Y= Yellow rubber corners



G= Grey rubber corners