

COMPOSTI DA UNITÀ BASE PIÙLENTE ESTRAIBILE O FISSA ■
COMPOSED OF A BASIC UNIT AND LENS REMOVABLE OR FIXED

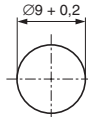

Foro ■ Hole
Ø 9 mm + 0,20 mm

Spessore pannello ■ Panel thickness
0,8/2 mm



TB/09/SA

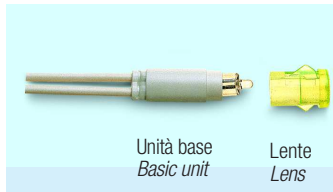
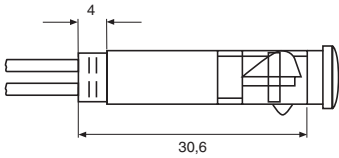

Tensione di funzionamento	⊕ Incandescenza: 6/12/24 V	⊕ Neon e fluorescenza: 110/250/400 V
Corpo e lente	In policarbonato	
Terminali	TB/09/SA	Cavetti PVC, sezione 0,50 mm ² , lunghezza filo 220 mm, spellatura 6 mm
	TBF/09/SA	Faston maschio 6,3x0,8 mm e 4,8x0,8 mm
Colore lente	Incandescenza: rosso, arancio, trasparente, giallo- verde, verde, blu	Neon: rosso, arancio, trasparente, giallo-verde Fluorescenza: verde
Varie	Cavetti con lunghezza richiesta - con terminali aggraffati - al silicone - con terminali ravvivati Lente estraibile Resistenza antiluminiscenza	

TBF/09/SA

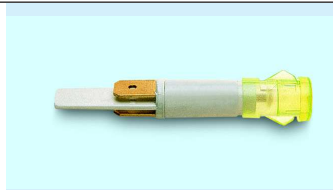
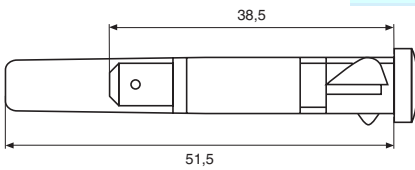

Working voltage - VAC	⊕ Incandescence: 6/12/24 V	⊕ Neon and fluorecence: 110/250/400 V
Body and lens:	Polycarbonate	
Wire ends	TB/09/SA	PVC sheath wire cross, section 0,50 mm ² , wires lenght 220 mm, lenght of stripped wires end 6 mm
	TBF/09/SA	Male faston 6,3x0,8 mm and 4,8x0,8 mm
Lens colour	Incandescence: red, orange, transparent, yellow-green (light green), green, blue	Neon: red, orange, transparent, yellow-green (light green) Fluorescent: green
Variants	Cables: lenght to customer's requirements - with clamped connectors - silicone - insulated - tinned ends Removable lens Anti-luminescence resistor	



LENTI AUTOBLOCCANTI ■ SELF-LOCKING LENS

DL 2

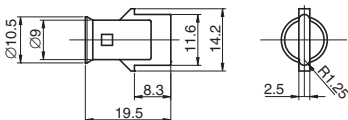

SA 1

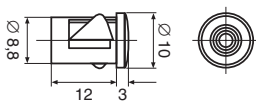

SA 2

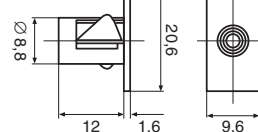

SA 3

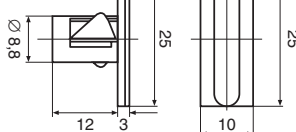

SA 4

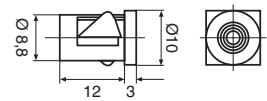

SA 5

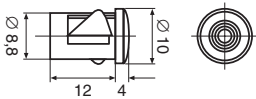

SA 6

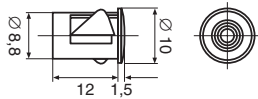

SA 7

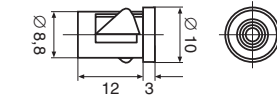

SA 8

