

PCB Terminal Blocks

3.5mm, 3.81mm pitch



SPECIFICATION:

Material

Screws	M2.0 Steel, Zinc Plated
Pin Header	Copper Alloy, Tin Plated
Housing	PA66, UL94V-0
Clamp	Brass, Ni Plated

Electrical

Standard	UL	IEC
Rated Voltage	300V	250V
Rated Current	15A	15A
Wire Range	28-16AWG	0.08-1.5mm ²
Contact Resistance	20mΩ	
Insulation Resistance	500MΩ/DC500V	
Withstand Voltage	AC2000V/1Min	

Mechanical

Temperature Range	-40°C~+105°C
Torque	0.4Nm(3.54Lb.in)
Strip Length	4-5mm

Size

Pitch	3.5mm(.138"), 3.81mm(.150")
Poles	2P-10P

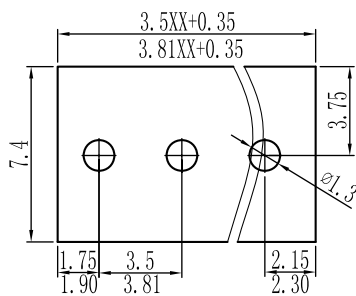

P.C.B. LAYOUT

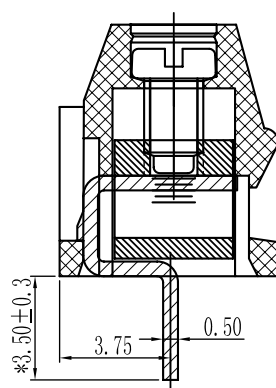
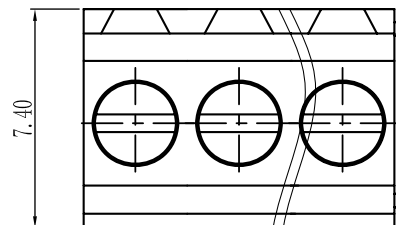

SECTION: A-A

