

PCB Terminal Blocks

5.0mm pitch



SPECIFICATION:

Material

Screws	M2.5 Steel, Zinc Plated	
Pin Header	Brass, Tin Plated	
Housing	PA66, UL94V-0	
Clamp	Brass, Ni Plated	

Electrical

Standard	UL	IEC
Rated Voltage	300V	250V
Rated Current	15A	18A
Wire Range	22-14AWG	0.34-1.5mm ²
Contact Resistance	20mΩ	
Insulation Resistance	500MΩ/DC500V	
Withstand Voltage	AC2000V/1Min	

Mechanical

Temperature Range	-40°C~+105°C	
Max. Soldering	+250°C for 5 sec	
Strip Length	4-4.5mm	
Torque	0.4Nm (3.6Lb.in)	

Size

Pitch	5.0mm (.197")	
Poles	2P-6P	

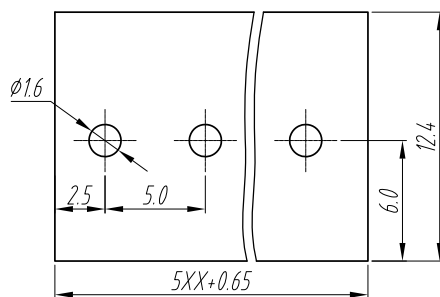

P.C.B. LAYOUT

